



ASSEMBLY INSTRUCTIONS

COASTER FINE FURNITURE



Fine Furniture for every stage of life

123153
Dining Side Chair

ITEM:123153



ASSEMBLY INSTRUCTIONS

ASSEMBLY TIPS:

1. Remove hardware from box and sort by size.
2. Please check to see that all hardware and parts are present prior to start of assembly.
3. Please follow attached instructions in the same sequence as numbered to assure fast & easy assembly.



WARNING!

1. Don't attempt to repair or modify parts that are broken or defective. Please contact the store immediately.
2. This product is for home use only and not intended for commercial establishments.



ASSEMBLY TIME

15 MINUTES

PARTS IDENTIFICATION

A	LEG FRAME		2PCS
B	BOTTOM RAIL		1PC
C	FRONT RAIL		1PC
D	BACK RAIL		1PC
E	SEAT AND BACK		1PC

HARDWARE IDENTIFICATION

1	SHORT BOLT (Ø1/4" x 9/16" - BLK)		14PCS
2	LONG BOLT (Ø 1/4" x 1-3/8" - BLK)		2PCS
3	LOCK WASHER (Ø1/4" x 10mm - BLK)		16PCS
4	FLAT WASHER (Ø1/4" x 10mm - BLK)		16PCS
5	ALLEN WRENCH (M4 - 64mm - BLK)		1PC

NOTE:

Quantities shown are for one chair.

ITEM: **123153**



ASSEMBLY INSTRUCTIONS
STEP 1

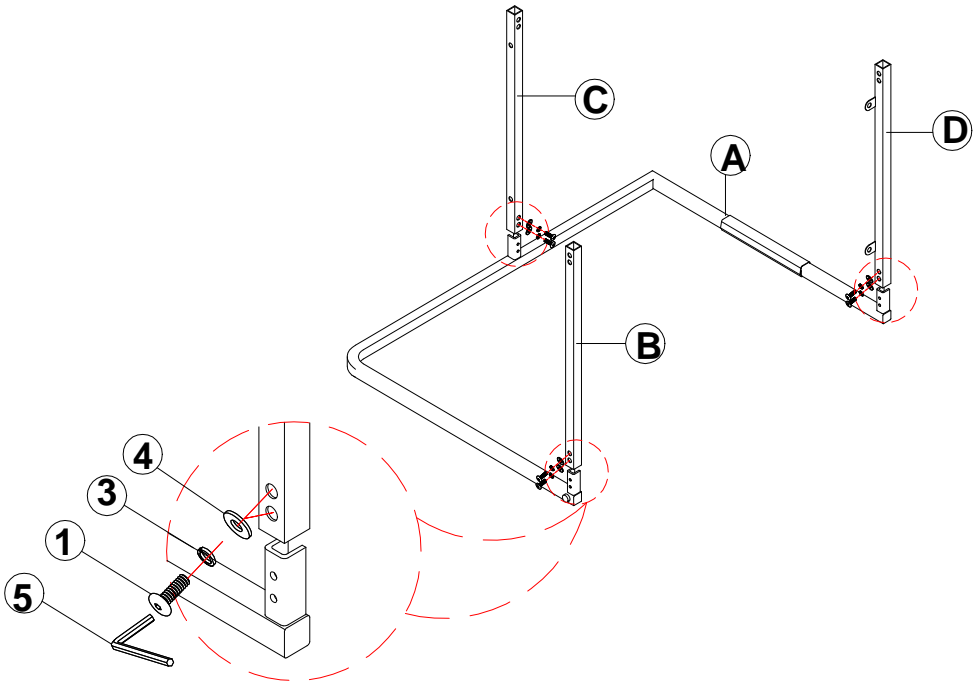

STEP 2

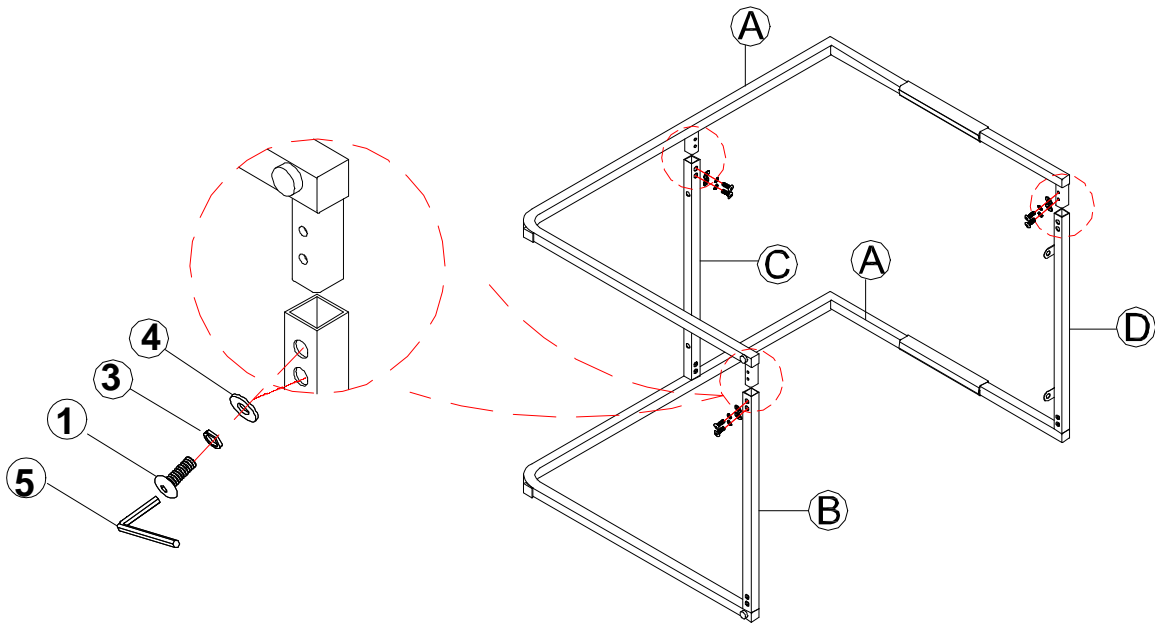

ITEM: **123153**

ASSEMBLY INSTRUCTIONS
STEP 3

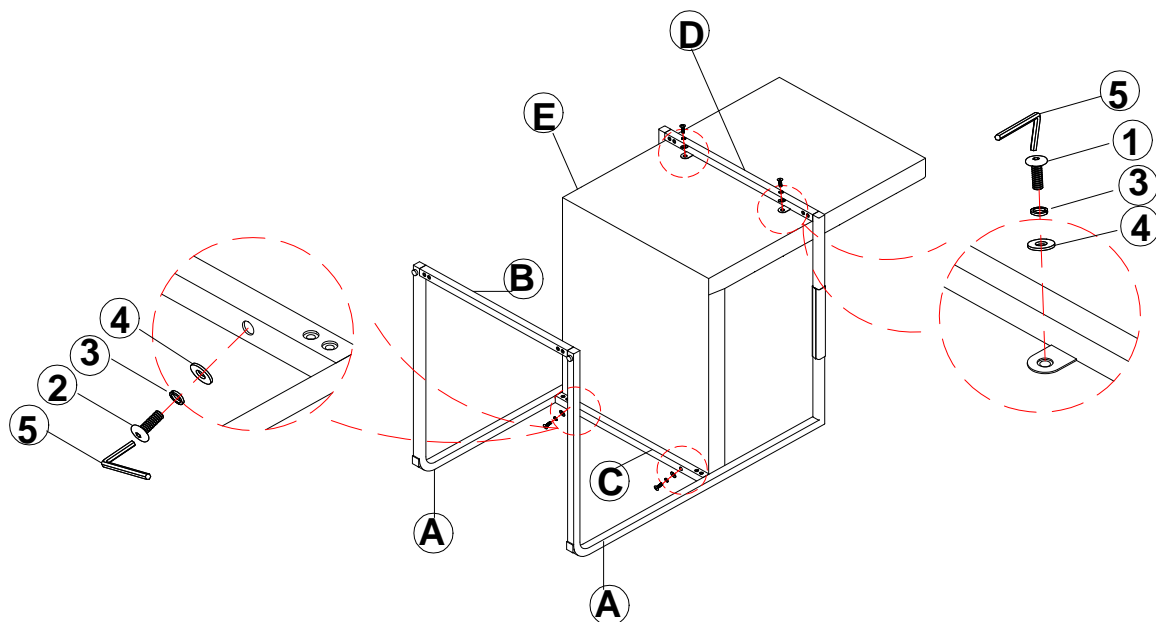

STEP 4
COMPLETE

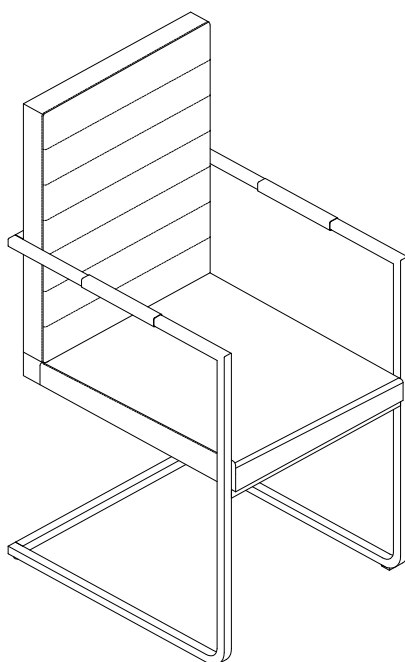

ITEM:123153

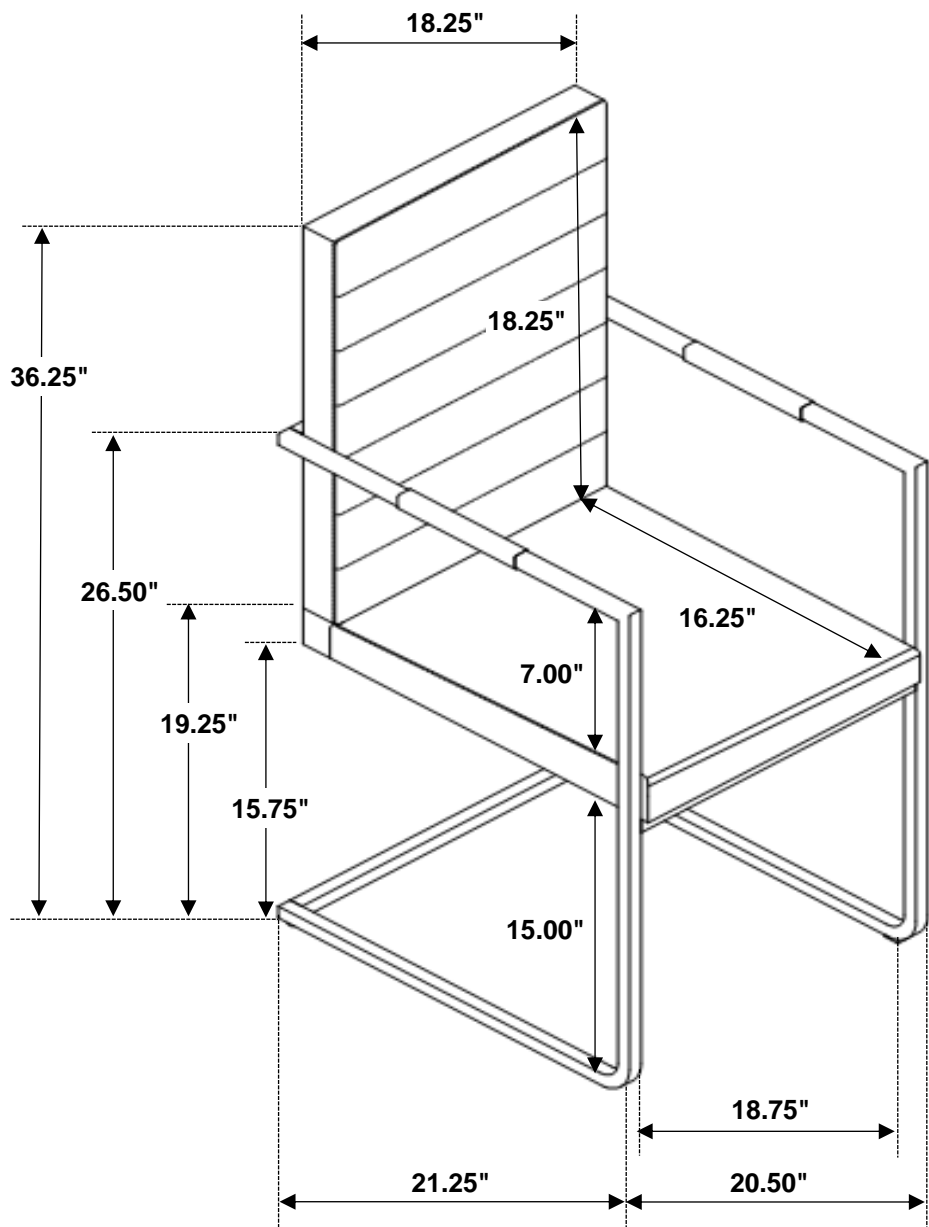

Note: Dimension tolerance $\pm 5\%$