

Fashion Bed Group

A Division of Leggett & Platt Incorporated
5950 West 51st Street - Chicago, IL 60638

Parts List For Fenton

BED CARTON

(7) HEADBOARD PANEL

(8) FOOTBOARD PANEL

PART #321901 HARDWARE BAG FOR BED
ATTACHMENT TO FRAME

- (1) 1/4-20 2" COUNTERSUNK ALLEN HEAD SCREW(4)
- (2) 1/4-20 1" FLAT ALLEN HEAD SCREW(4)
- (3) 1/4-20 HEX NUT(4)
- (4) 5/8" OD FLAT WASHER(8)
- (5) ALLEN WRENCH
- (9) PLASTIC GLIDE(4)#150940000
- (6) LEG EXTENSION #321903158(2) BUTTER PECAN FINISH
OR #321903161(2) BLACK WALNUT FINISH
OR #321905 (2) GOLDEN FROST
OR #321906 (2) TARNISH COPPER
OR #321907 (2) PUMICE / GOLD B.

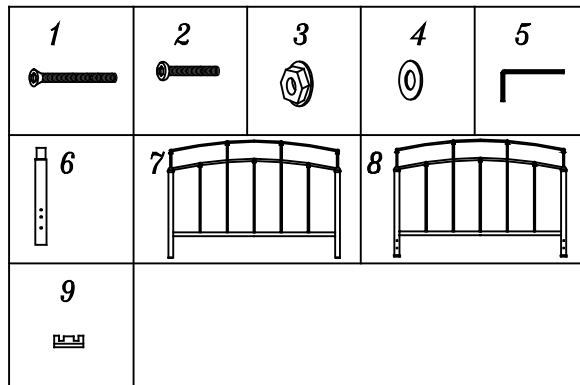

PRODUCT FULLY ASSEMBLED

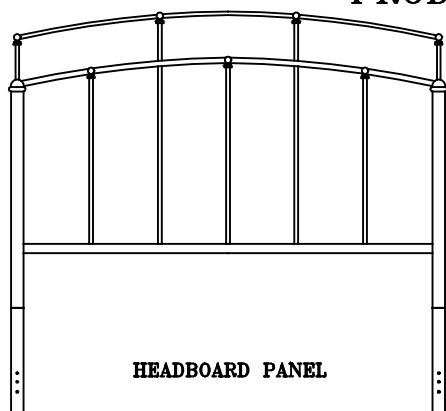

HEADBOARD PANEL

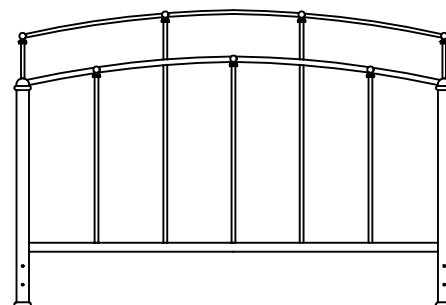

FOOTBOARD PANEL

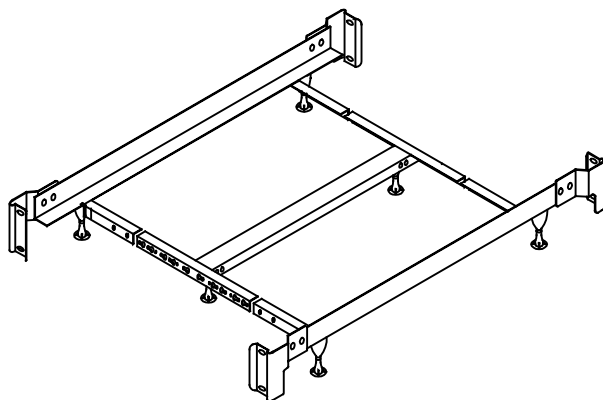

QUEEN - KING FRAME FULLY ASSEMBLED

NOTE: SEE INSTRUCTIONS INCLUDED IN FRAME CARTON
FOR FRAME ASSEMBLY

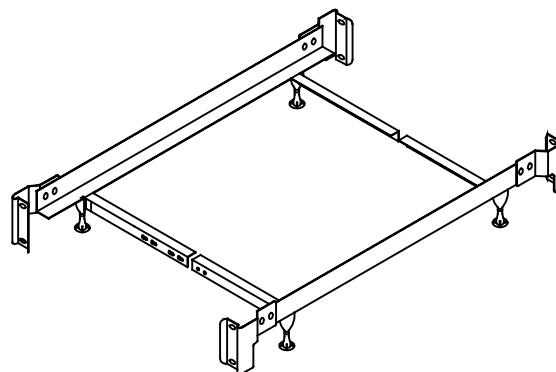

TWIN - FULL FRAME FULLY ASSEMBLED

NOTE: SEE INSTRUCTIONS INCLUDED IN FRAME CARTON
FOR FRAME ASSEMBLY

FOR ASSISTANCE IN ASSEMBLY ONLY OF THIS
PRODUCT. CALL OUR HELP DESK AT
1-800-324-3415, BETWEEN 8:30 AM & 4:30 PM
CENTRAL TIME MONDAY THRU FRIDAY. PLEASE
HAVE THE STYLE NUMBER AVAILABLE BEFORE YOU
CALL. (STYLE # OR NAME CAN BE FOUND ON
PACKING CARTON OR SALES RECEIPT.)
OUR PRODUCT IS INSPECTED TO ENSURE IT IS IN
GOOD CONDITION. IF YOUR FURNITURE APPEARS
TO HAVE BEEN DAMAGED IN SHIPMENT OR YOU
ARE IN NEED OF REPLACEMENT PARTS PLEASE
CONTACT THE DEALER FROM WHOM YOU
PURCHASED THE PRODUCT.

Instruction Sheet

SAVE ALL PACKAGING MATERIALS UNTIL PRODUCT IS FULLY ASSEMBLED. HARDWARE AND SMALL PIECES MAY NOT BE SEEN AND BE ACCIDENTALLY DISCARDED WITH PACKAGING MATERIALS.

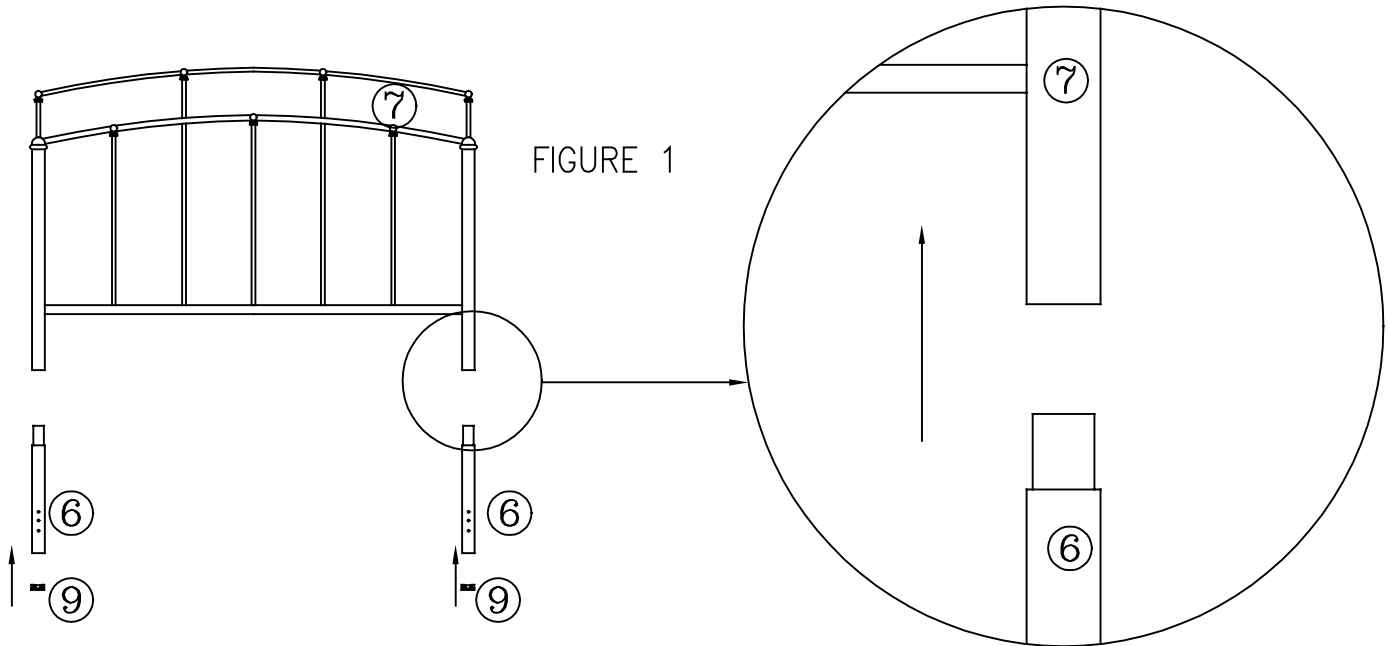

FIGURE 1

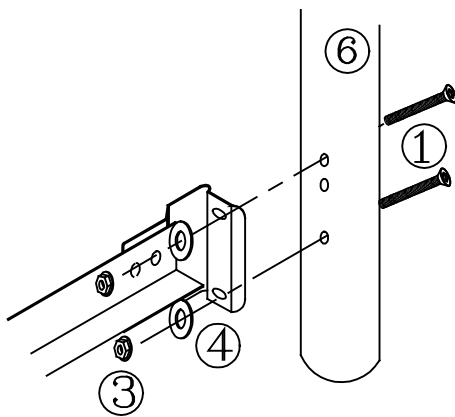

FIGURE 2

Step 1

- Insert plastic glide (9) into bottom of leg extensions (6) and footboard (8) posts. (See Figure 1)
- Align top reduction of extension legs (6) with bottom of headboard posts. (See Figure 1) Make sure the 3 holes on extension legs are perpendicular to headboard panel.
- Now carefully insert extension legs (6) into bottom of headboard (7) posts.

Step 2

- Place headboard and frame in desired location in room.
- Place 2 screws (1) through holes located in leg (6). (See Figure 2)
- Align bed frame bracket over screws.
- Place a flat washer (4) first and then a nut (3) on each screw. Hand-tighten, DO NOT TIGHTEN screws all the way.
- Repeat on other side of headboard.
- Tighten all screws securely using the Allen wrench.

Step 3

- Position footboard panel and align holes in the post (8) with holes in the frame bracket. (See figure 3)
- Place flat washer (4) on each screw (2). Insert through bracket and into post. Hand-tighten, DO NOT TIGHTEN screws all the way.
- Repeat on other side of footboard panel.
- Tighten all screws securely using the Allen wrench.

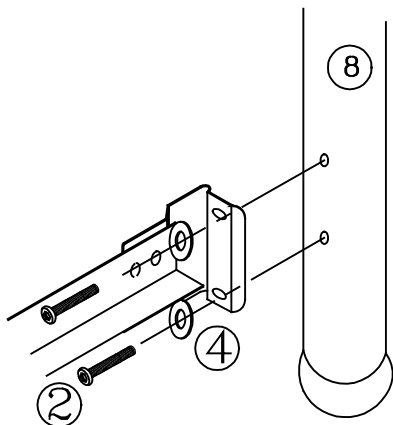

FIGURE 3