

VITARA

Models / Modelos	VLUF1401ESE VLUF1701ESE VLUF1401EWE VLUF1701EWE
REFRIGERATOR / FREEZER REFRIGERADOR / CONGELADOR	INSTRUCTION MANUAL MANUAL DE INSTRUCCIONES

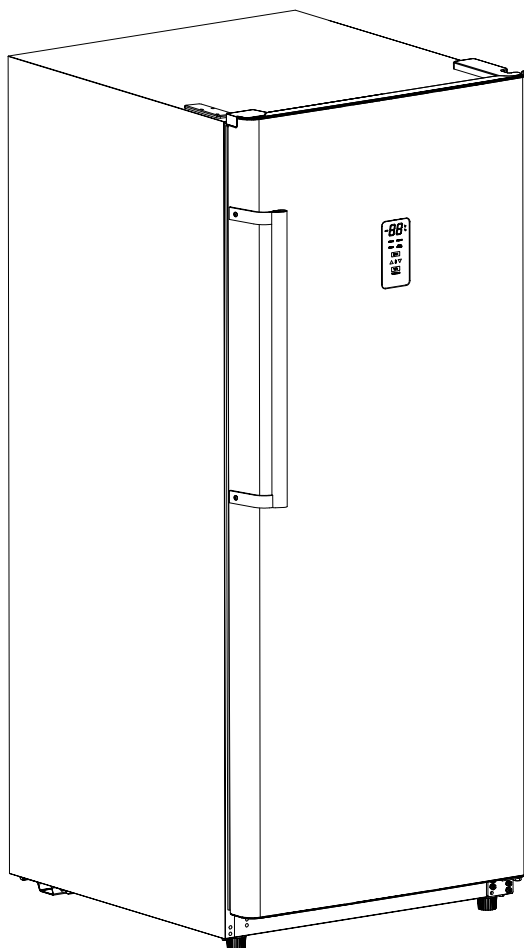

(Actual design / color may vary)

BEFORE USE, PLEASE READ AND FOLLOW ALL SAFETY RULES AND OPERATING INSTRUCTIONS.



Important Safety Information

READ AND FOLLOW ALL SAFETY INSTRUCTIONS

SAFETY REQUIREMENTS

DANGER: Risk of fire or explosion. Flammable refrigerant used. Do not puncture refrigerant tubing.

- Do not use mechanical devices to defrost refrigerator.
- Ensure that servicing is done by factory authorized service personnel, to minimize product damage or safety issues.

WARNING: Keep ventilation openings, in the appliance enclosure or in the built-in structure, clear of obstruction.

WARNING: Do not use mechanical devices or other means to accelerate the defrosting process, other than those recommended by the manufacturer.

WARNING: Do not damage the refrigerant circuit.

WARNING: Do not use electrical appliances inside the food storage compartments of the appliance, unless they are of the type recommended by the manufacturer.

CAUTION: Risk of fire or explosion. Flammable refrigerant used.

- Consult repair manual or owner's guide before attempting to service this product. All safety precautions must be followed.
- Dispose of properly in accordance with federal or local regulations.
- Follow handling instructions carefully.

CAUTION: Children should be supervised to ensure that they do not play with the appliance.

DANGER: Risk of child entrapment. Before throwing away an old appliance:

- Remove the door or lid.
- Leave shelves in place so that children may not easily climb inside.

SAFETY REQUIREMENTS

This appliance is not intended for use by persons (including children) whose physical, sensory or mental capabilities may be different or reduced, or who lack experience or knowledge, unless such persons receive supervision or training to operate the appliance by a person responsible for their safety.

Do not store explosive substances such as aerosol cans with a flammable propellant in this appliance

This appliance is intended to be used in household and similar applications such as

- staff kitchen areas in shops, offices and other working environments;
- farm houses and by clients in hotels, motels and other residential type environments;
- bed and breakfast type environments;
- catering and similar non-retail applications.

NOTE If the manufacturer wants to limit the use of the appliance to less than the above, this has to be clearly stated in the instructions.

GROUNDING INSTRUCTIONS

This appliance must be grounded. Grounding reduces the risk of electrical shock by providing an escape wire for the electrical current.

This appliance has a cord that has a grounding wire with a 3-prong plug. The power cord must be plugged into an outlet that is properly grounded. If the outlet is a 2-prong wall outlet, it must be replaced with a properly grounded 3-prong wall outlet. The serial rating plate indicates the voltage and frequency the appliance is designed for.

WARNING - Improper use of the grounding plug can result in a risk of electric shock. Consult a qualified electrician or service agent if the grounding instructions are not completely understood, or if doubt exists as to whether the appliance is properly grounded.

Do not connect your appliance to extension cords or together with another appliance in the same wall outlet. Do not splice the power cord. Do not under any circumstances cut or remove the third ground prong from the power cord. Do not use extension cords or ungrounded (two prongs) adapters.

If the power supply cord is damaged, it must be replaced by the manufacturer, its service agent or similar qualified person in order to avoid hazard.

SAVE THESE INSTRUCTIONS!

INSTALLATION INSTRUCTIONS

LOCATION

- Two people should be used when moving the appliance.
- Remove interior and exterior packaging prior to installation. Wipe the outside of the appliance with a soft, dry cloth and the inside with a lukewarm wet cloth.
- Place the appliance on a floor that is strong enough to support it when it is fully loaded.
- Do not place the appliance in direct sunlight or near sources of heat, such as a stove or heater, as this can increase electrical consumption. Extreme cold ambient temperatures may also cause the appliance to perform improperly.
- Do not use the appliance near water, for example in a wet basement or near a sink.
- This appliance is intended for household use only.
- Before connecting the appliance to a power source, let it stand upright for approximately 6 hours. This will reduce the possibility of a malfunction in the cooling system from handling during transportation.
- Make sure that you leave the minimum amount of space between the appliance and all surrounding walls and vents. Do not cover any of the ventilation openings with any material as the appliance needs adequate space to breathe.
- Allow 12.7 cm (5 inches) of space between the back, sides and top of the appliance and all adjacent walls.
- This appliance is intended for free-standing installation only and is not intended to be built into a cabinet or counter. Building in this appliance can cause it to malfunction.
- Do not install the unit in a location where the ambient temperature will drop below 32 °F or rise above 110 °F. Ambient temperatures outside of this range will affect the performance of your unit and will not allow it to maintain the proper temperatures.

OPERATING INSTRUCTIONS

FEATURES

1. Display panel (FRONT)
2. Windward
3. Glass shelf 1
4. Downwind
5. Glass shelf 2
6. Lower drawer (VLUF14) /Basket (VLUF17)
7. Adjustable Feet
8. Door shelf

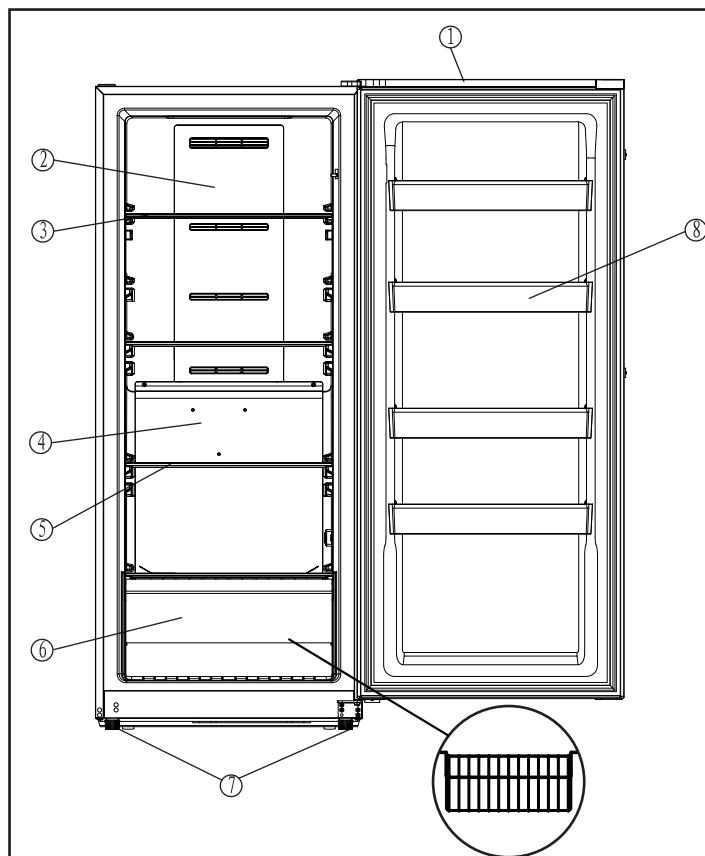

LEVELING INSTRUCTIONS

There are two adjustable legs on the bottom of the appliance that can be turned up or down to ensure that the appliance is level.

1. Turn the leveling leg counter-clockwise as far as it will go, until the top of the foot is touching the bottom of the chassis.
2. Slowly turn the leveling leg clockwise until the appliance is level.

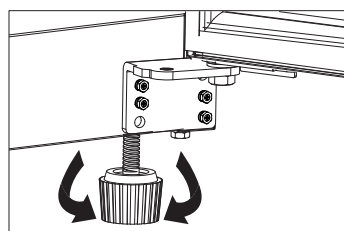

OPERATING INSTRUCTIONS

CONTROL PANEL

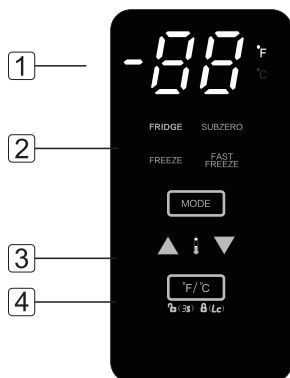

1. Temperature display
2. Temperature Mode
3. Up and Down arrows to select temperature
4. Selection button for °F or °C (press and hold for 3 seconds to activate the control panel)

LOCK ICON

The control panel default mode is unlocked. Press and hold the °F/ °C button for 3 seconds to lock or unlock the control panel manually.

TEMPERATURE SETTING

This appliance can be used as either a refrigerator or a freezer. The table below shows the MODE and temperature ranges. Select the MODE. Then set the desired temperature by pressing the Up and Down arrows on the Control Panel. The temperature increases or decreases in one degree increments. The display window will show the selection.

TEMPERATURE SCALE

"FRIDGE": 0°C~8°C (32°F~46°F)

"SUBZERO": -4°C~-8°C (25°F~18°F)

"FREEZE": -14°C~-24°C (7°F~-11°F)

"FASTFREEZE": -28°C(-18°F)

Setting the Temperature Control

Freezer mode: To use the appliance as a freezer, the internal temperature will be between -14 – 24°C (6.8 – 11.2°F). Do not place liquid items in sealed bottles or containers into the appliance when it is being used as a freezer to avoid damage caused by expansion and cracking of the container. While set as a Freezer this model will perform in ambient temperatures between 0°F – 110°F (-17°C – 43°C)

Refrigerator mode: To use the appliance as a refrigerator, the internal temperature will be between 0 - 8°C (32 – 46.4°F). There are refrigerant lines in the cabinet walls that will get very cold. When using the appliance as a refrigerator, keep food items away from the cabinet walls to avoid freezing food. While set as a Refrigerator the ambient temperature must fall within 50°F – 109°F (10°C – 43°C)

IMPORTANT

This appliance is considered "Garage Ready" if it is being used as a freezer. If this appliance is used as the refrigerator, then the appliance should only be used in climate-controlled spaces with an ambient temperature range of 50°F – 109°F (10°C – 43°C).

OPEN DOOR ALARM

This appliance is equipped with a door alarm that will sound if the door is left open for more than 3 minutes. The alarm will beep and the display will flash continuously until the door is closed.

HANDLE INSTALLATION

The appliance ships with the handle inside the cabinet to protect it from damage. It must be installed by the end user. The appliance should be unplugged before installing the handle.

1. Position the handle over the exposed door handle posts.
2. Remove the two screws from the side of door with a screwdriver, insert screws into the handle bracket, fix it to the side of door and tighten it until snug.

Note: The handle may look slightly different based on the colour of the appliance.

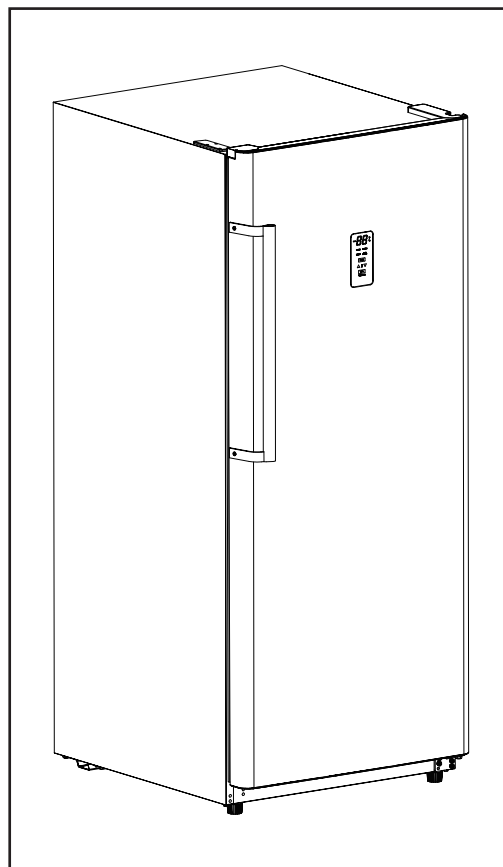

DOOR REVERSAL INSTRUCTIONS

If the appliance is placed on its back or side for any length of time during this process, it must be allowed to remain upright for 6 hours before plugging it in to avoid damage to the internal components.

WARNING: Before door reversal, make sure to unplug the unit and place the door face up. To avoid personal and property damage, replace the door with two persons. It is suggested to replace the door by authorized service personnel. Please keep the removed parts for the door reversal and close the door tightly.

STEP1 Replace upper door hinge

1. Remove the hinge cover and hinge on the top right. Remove the terminal of the wiring from cabinet. Remove the covers from the top left side of the cabinet.

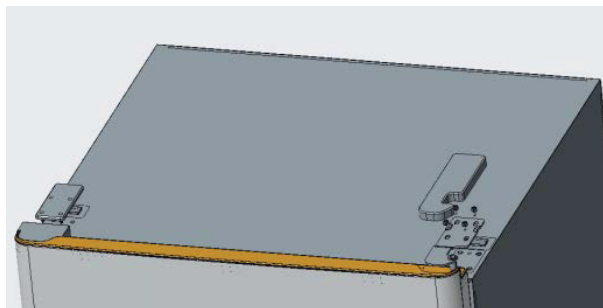

2. Remove the wire cover and fixing box on left door top. Get out the cover and fixing box for right side from the accessory bag. Fix the wire in the box and then cover it. Fix the cover taking off from top left side of cabinet to right side.

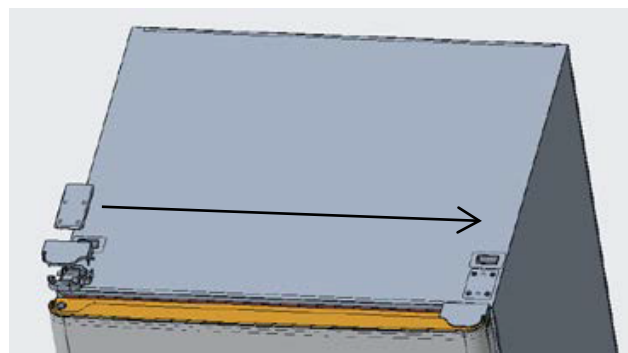

3. Get out hinge cover and hinge of top left and fix them on the left of cabinet. Install the terminal of the wiring and cover the hinge cover.

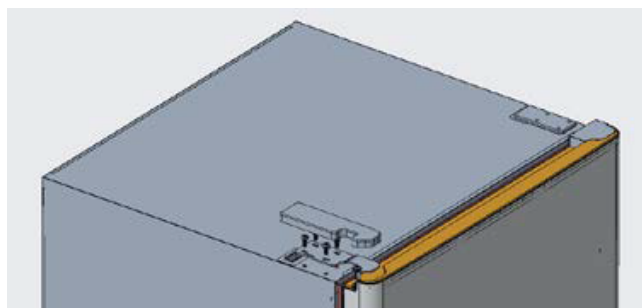

STEP2 Replace bottom door hinge

1. Remove four bolts and bottom hinge. Unscrew the door shaft nut, move the door shaft to the hinge left and tighten, and remove 4 cap nails of the other end.

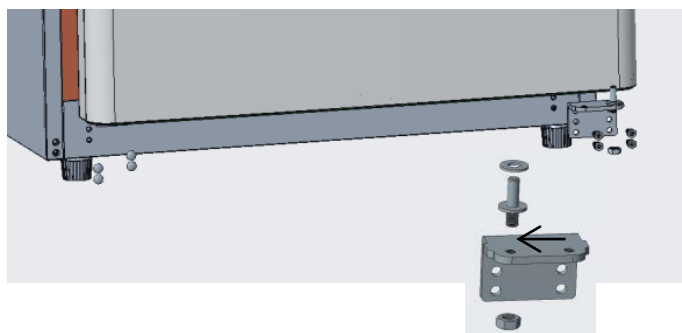

2. Remove the door limit block on the right of the door and then install it to the left end of the door and fix it.

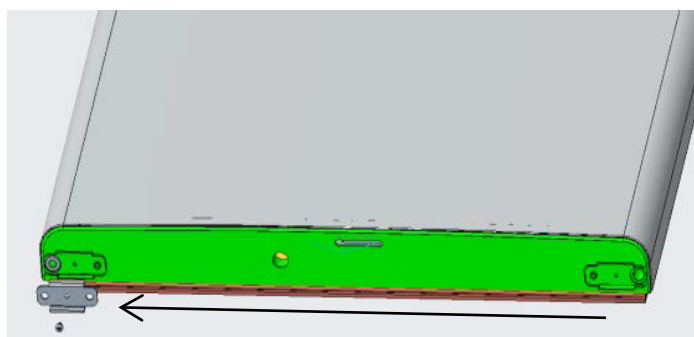

3. Install the lower hinge where the hinge shaft has been replaced on the left of cabinet with four screws and tighten it. Plug the four holes at the right with cap nails.

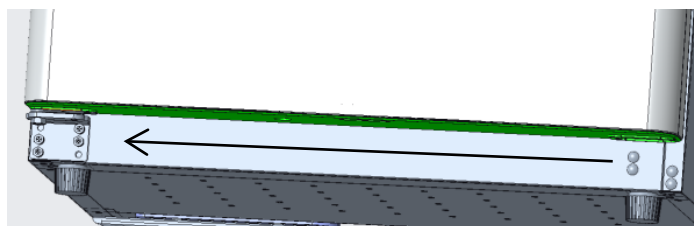

Finally, check whether the two sides of the door are in line with the cabinet. If necessary, adjust the adjusting foot in the front of the unit so that the product is completely horizontal. After replacing the door, place the unit vertically and let it stand for four hours before power on.

CARE & MAINTENANCE

CLEANING

Ensure the appliance is unplugged before cleaning.

- To clean the inside of the appliance, use a soft cloth and a solution of a tablespoon of baking soda to one quart of water or a mild soap solution or some mild detergent.
- Wash removable shelves in a mild detergent solution, then dry and wipe with a soft cloth.
- Clean the outside with a soft, damp cloth and some mild detergent.
- It is important to keep the area clean where the door seals against the cabinet. Clean this area with a soapy cloth. Rinse with a damp cloth and let dry.

Note: Do not use cleaners containing ammonia or alcohol on the appliance. Ammonia or alcohol can damage the appearance of the appliance. Never use any commercial or abrasive cleaners or sharp objects on any part of the appliance.

POWER FAILURE

Most power failures are corrected within a few hours and should not affect the temperature of your appliance if you minimize the number of times the door is opened. If the power is going to be off for a longer period of time, take the proper steps to protect your contents.

Note: Wait 3 to 5 minutes before attempting to restart the refrigerator if operation has been interrupted.

DEFROST

This unit is equipped with an automatic defrost function and does not require manual defrosting. Defrost water from the appliance is channeled into a drip tray located above the compressor. Heat transfer from the compressor causes the defrost water to evaporate.

ERROR CODES

- E1: The freezer sensor failure
- E2: Freezer defrosting sensor failure
- E3: The freezer sensor failure and freezer defrosting sensor failure
- C0: Communication failure
- dr: Door opening alarm
- H1: The freezer heater failure

VACATION

- **Short vacations:** Leave the appliance operating during vacations of less than three weeks.
- **Long vacations:** If the appliance will not be used for several months, remove all items and turn off the appliance. Clean and dry the interior thoroughly. To prevent odor and mold growth, leave the door open slightly, blocking it open if necessary.

ENERGY SAVING TIP

The appliance should be located in the coolest area of the room, away from heat producing appliances, and out of direct sunlight. Do not overload the unit or block any ventilation openings.

MOVING

- Remove all items.
- Tape the door shut.
- Be sure the appliance stays secure in the upright position during transportation. Also protect the outside of the appliance with a blanket or similar item.
- If the appliance is placed on its back or side during transportation, upon reaching the destination, allow it to remain in its operating position for 6 hours to avoid damage to internal components.

DISPOSAL

This appliance may not be treated as regular household waste, it should be taken to the appropriate waste collection point for recycling of electrical components. For information on local waste collection points, contact your local waste removal agency or government office.

TROUBLESHOOTING

PROBLEM	POSSIBLE CAUSE
No power	<ul style="list-style-type: none">• A fuse may be blown or the circuit breaker tripped• Plug not fully inserted into the wall outlet
Internal temperature not cold enough	<ul style="list-style-type: none">• Temperature setting is too warm• Door is not shut properly or opened excessively• Exhaust vent is obstructed• Recently added a large quantity of warm food to the cabinet• Close proximity to heat source or direct sunlight• Ambient temperature or humidity is very high
Appliance runs continuously	<ul style="list-style-type: none">• Temperature setting is too cold• Door not shut properly or opened excessively• Exhaust vent is obstructed• Recently added a large quantity of warm food to the cabinet• Close proximity to heat source or direct sunlight• Ambient temperature or humidity is very high
Internal temperature is too cold	<ul style="list-style-type: none">• Temperature setting is too cold
Noises	<ul style="list-style-type: none">• Parts are expanding and/or the refrigerant is circulating; this is normal