

# Assembly Instructions

## Rectangular Dining Table

### DPR500DT & DPR300DB

**Caution:** Please read instructions thoroughly before unpacking assembly parts. Sharp, exposed staple tips can cause injury, therefore, for your protection, please remove any exposed staples used in packing.

1. We recommend that you should assemble this product with the assistance of another person; this will make assembly easier, and will help to eliminate damage to the product or injury to persons during assembly.
2. Be sure to check all packing materials carefully for small parts that may have come loose inside the carton during shipment.
3. Please do not over tighten screws or bolts.
4. Please put all parts on a non-abrasive floor before assembly, and follow the assembly steps to assemble your newly purchased product correctly and efficiently.

PART LIST FOR DINING TABLE			
No.	PART DESC	CODE.	Q'TY
A	RECTANGULAR DINING TABLE - TOP		1
B	RECTANGULAR DINING TABLE - LEG	PDPR300DBLEG	4
C	RECTANGULAR DINING TABLE - UPPER SHELF	PDPR300DBSHF1	1
D	RECTANGULAR DINING TABLE - BOTTOM SHELF	PDPR300DBSHF2	1

HARDWARE LIST			
No.	HARDWARE DESC	CODE.	Q'TY
1	 ALLEN BOLT (5/16" x 45mm)	PDRB500RDBHW	12
2	 SPRING WASHER (5/16")		12
3	 FLAT WASHER (5/16")		12
4	 ALLEN KEY M4		1

#### Step:1

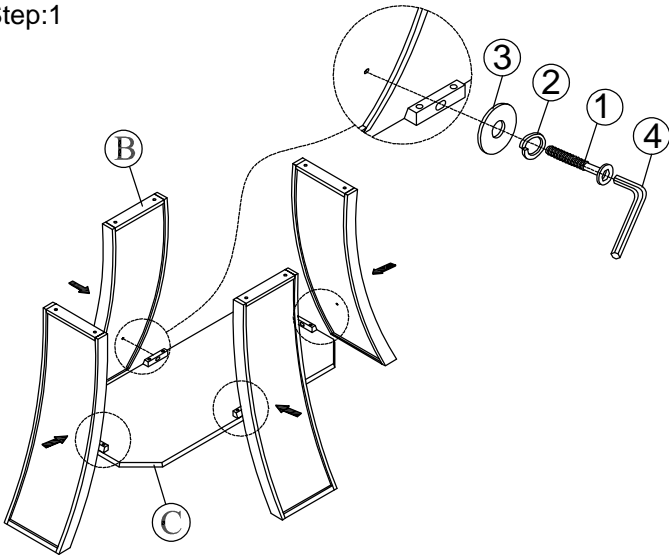

#### Step:2

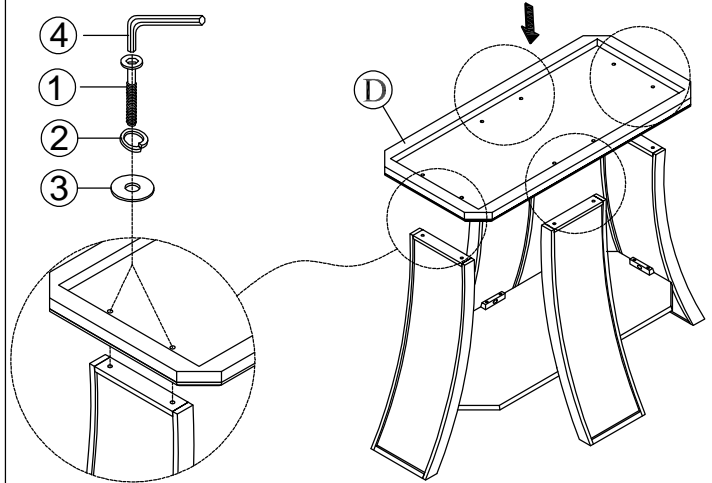

#### Step:3

Adjust the glass end to balance with the foot according to the sticker on the glass head.  
Remove sticker after assemble done.

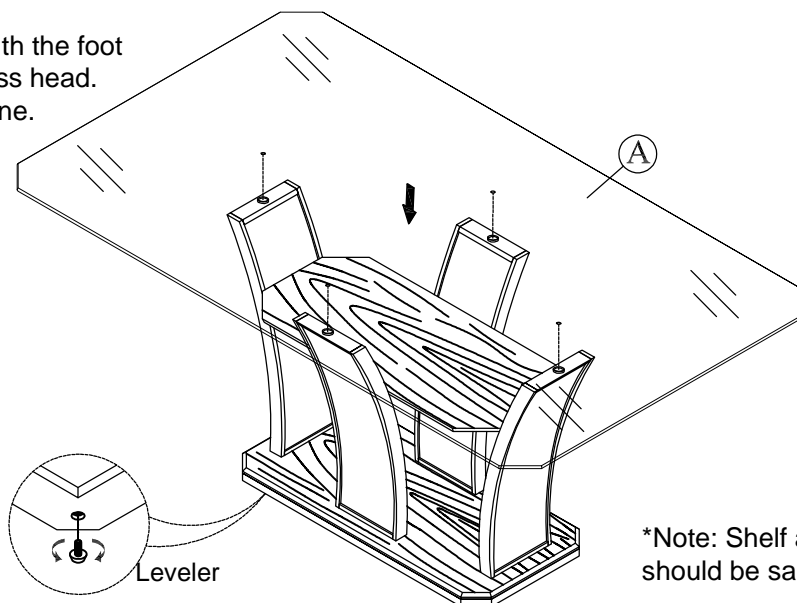

\*Note: Shelf and base veneer should be same grain.