

ASSEMBLY INSTRUCTIONS

MODEL #

FM65006BR-CH
FM65006PR-CH

Questions?

GIVE US A CALL: 1-888-980-5122
MON-FRI 8:30AM - 5:30PM (PT)

TOOLS REQUIRED



Screwdriver
(Not included)

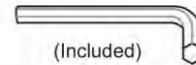

Allen Wrench



2 - People

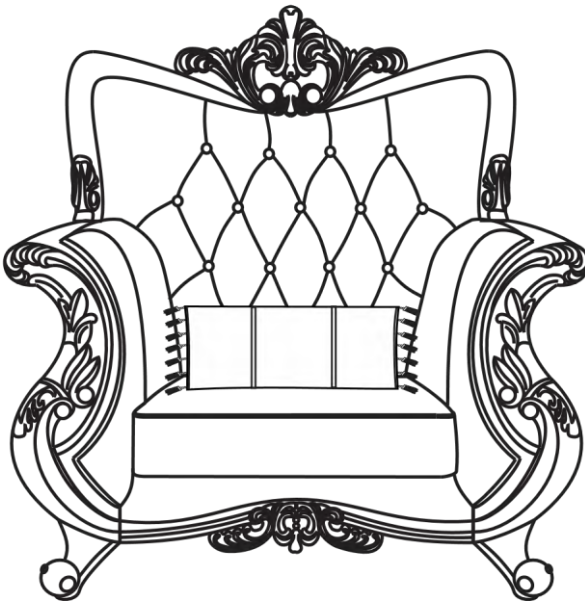

ASSEMBLY RATING



EASY —————> DIFFICULT

The Assembly Rating is a 5-point system showing the level of effort needed to assemble a specific product.



Thank you for your purchase!

We hope you enjoy this new addition to your home for many years to come.

Our commitment to providing quality products does not simply end when you purchase our product. We fully stand behind our products from start to finish. Our customer service department is available Monday – Friday 8:30 AM – 5:30 PM Pacific Time and can help with assembly questions as well as, if necessary, replacing damaged or missing parts. To help expedite our service, please have these assembly instructions readily available, along with your order receipt.



Consumer Hotline
Toll-Free 1-888-980-5122



WEBSITE
www.foagroup.com



Monday to Friday
8:30AM- 5:30PM (PT)



E-MAIL
cs.ec@foagroup.com



foagroup



FurnitureOfAmerica



CHECK BEFORE STARTING

☐

Are you missing anything?

Double-check all parts, hardware and accessories listed are all accounted for.

☐

Check out our Quick Tips!

We recommend reviewing the pre-assembly handouts. Even experts need a refresher now and then!

☐

Should we send any replacements?

Are there any irregularities or flaws in the parts? We can send replacements!

☐

Prep Time!

Please review the assembly instructions and all diagrams prior to assembling.

PRE ASSEMBLY INTRODUCTION

We understand building ready-to-assemble furniture can be a challenging experience for some. To help avoid confusion, we have provided some helpful tips that may speed up the process.



Teamwork

ALWAYS have at least two people to help with transporting and assembling the product to avoid potential injury and/or damage.



Suitable Location

Assembling near the area of the intended location is highly recommended.



Sufficient Space

Make sure you have enough space to move around during the assembly.



Avoid Scratches

Use cardboard, blankets or a carpeted area while assembling furniture to prevent scratches and damages.



Flat Surface

Make sure the furniture rests on a flat and level surface with each leg evenly touching the floor.

ASSEMBLY AND CARE ADVICE



**FAILURE TO FOLLOW THE GUIDELINES BELOW MAY
RESULT IN INJURY AND/OR PROPERTY DAMAGE.**



Position each part correctly
and insert screws or bolts into
their respective holes.



Turn clockwise to tighten and
only tighten when step is
completed or when instructed
to do so.



Use the appropriate hand tools
or power tools for assembly.
Select steps, such as tightening
screws and/or bolts, may require
hand tools to avoid causing
damage during assembly.



Save the instructions and store
any supplied tools for later
maintenance.



After two weeks, check and
tighten any loose hardware and
repeat again every six months
thereafter.

IT IS THE USER'S RESPONSIBILITY TO MAINTAIN THE FURNITURE. THE HARDWARE MAY LOOSEN OVER TIME AND MAY CAUSE THE FURNITURE TO BE WOBBLY AND UNABLE TO SUPPORT ITS INTENDED WEIGHT CAPACITY. THIS MAY LEAD TO COLLAPSE AND MAY CAUSE SERIOUS INJURY.

CHAIR

FM65006BR-CH
FM65006PR-CH

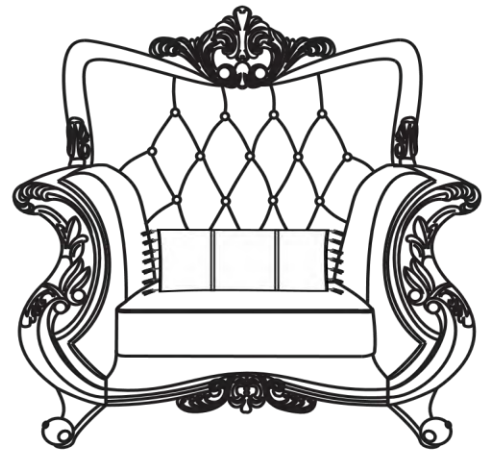
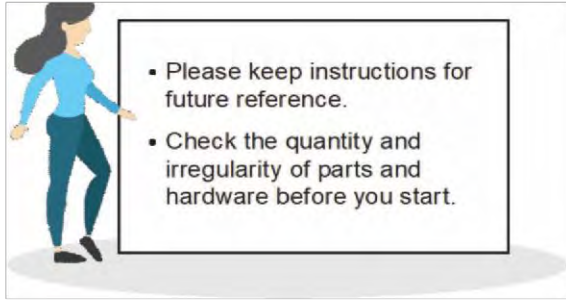

PARTS

1



SEAT FRAME
1 pc.

2



LEFT SIDE FACING (LSF) ARM
1 pc.

3



RIGHT SIDE FACING (RSF) ARM
1 pc.

4

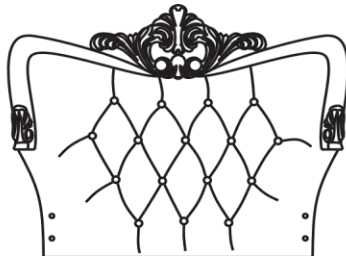

BACKREST
1 pc.

5

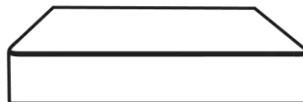

SEAT CUSHION
1 pc.

6



LEG
2 pcs

7

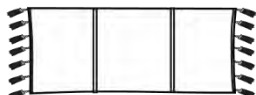

KIDNEY PILLOW
1 pc.

HARDWARE

A

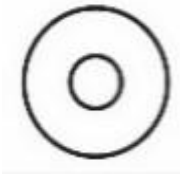

FLAT WASHER
Ø5/16 x 22mm
11pcs

B



LOCK WASHER
Ø5/16
11pcs

C

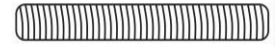

THREAD BOLT
Ø5/16 x 3¼"
1 pc.

D



ALLEN KEY M5
Ø5/16
1 pc.

E

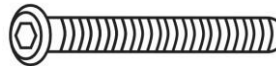

BOLT
Ø5/16 x 2¾"
10pcs

F

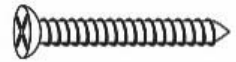

SCREWS
#4 x 70mm
4 pcs

G



HEX NUT
Ø5/16 x 1/2"
1 pc.

H

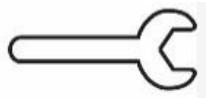

WRENCH
12mm
1 pc.

ASSEMBLY INSTRUCTIONS

1

Place the seat frame (1) upside down.
Assemble the legs (6) to both left and right back side of the seat frame (#1) by using the Allen Key (#D) with hardware #A, #B, and #E.

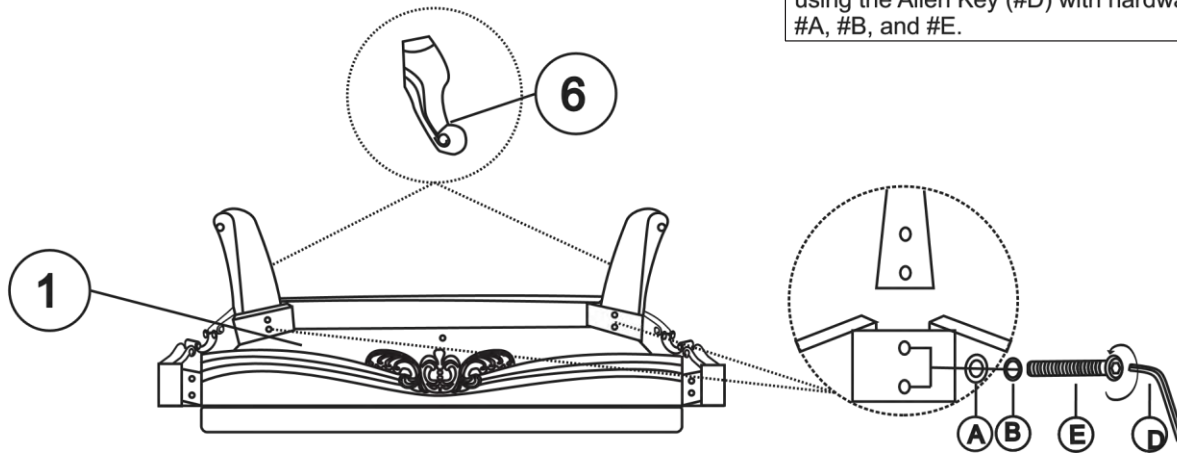

2

Lay the seat frame (#1) on its backside to reach the holes to secure the bolts for the arms.
Align and assemble the LSF arm (#2) and RSF arm (#3) to the seat frame (#1) by using the Allen Key (#D) with hardware #A, #B, and #E.

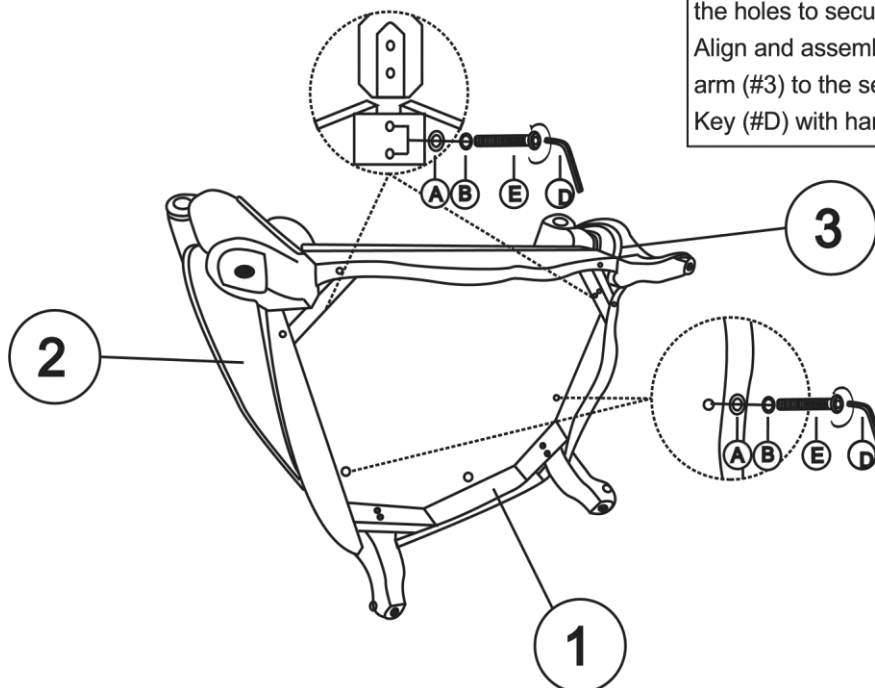

ASSEMBLY INSTRUCTIONS

3

Assemble and secure the front legs of the LSF arm (#2) and RSF arm (#3) to the seat frame (#1) by using a screwdriver with hardware #F.

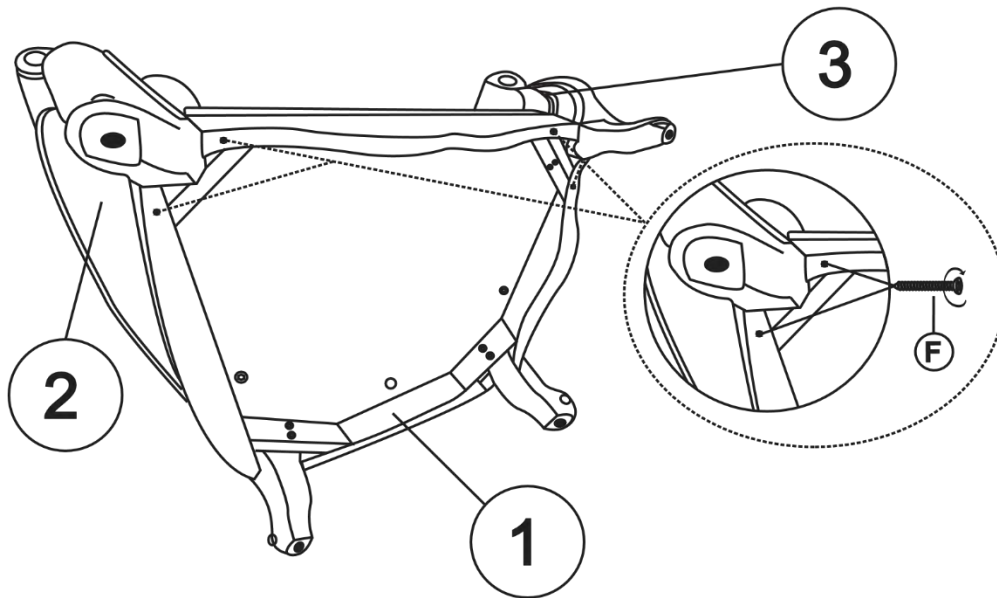

4

backrest (#4) to the LSF arm (#2) and RSF arm (#3) by sliding the brackets all the way until it is secured.

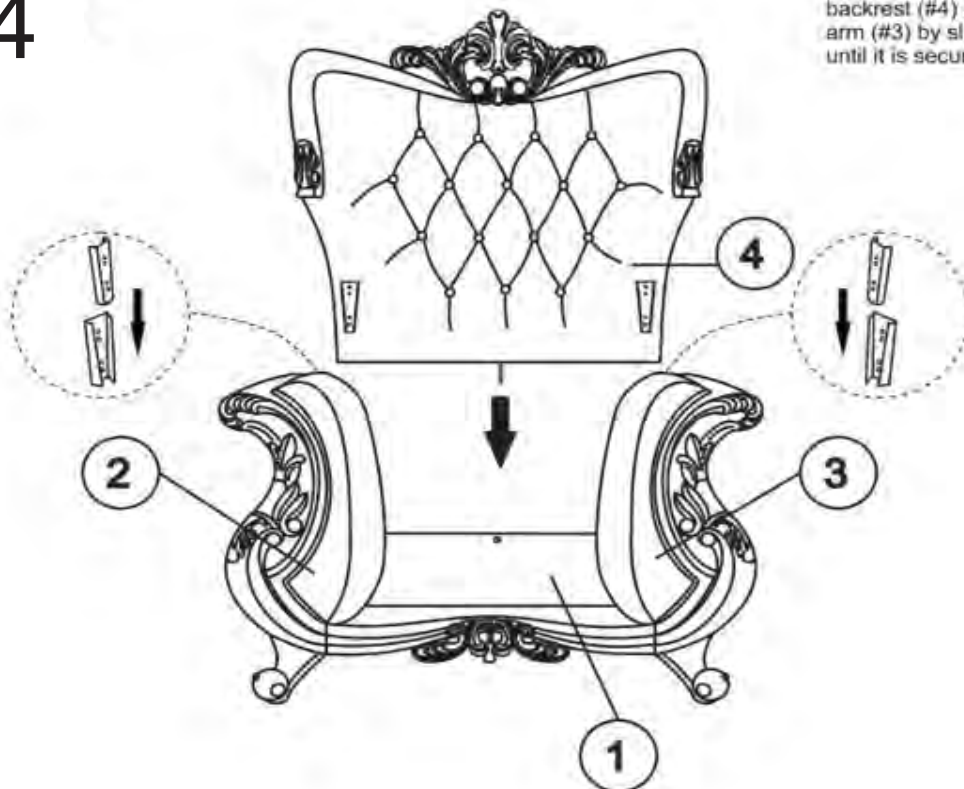

ASSEMBLY INSTRUCTIONS

5

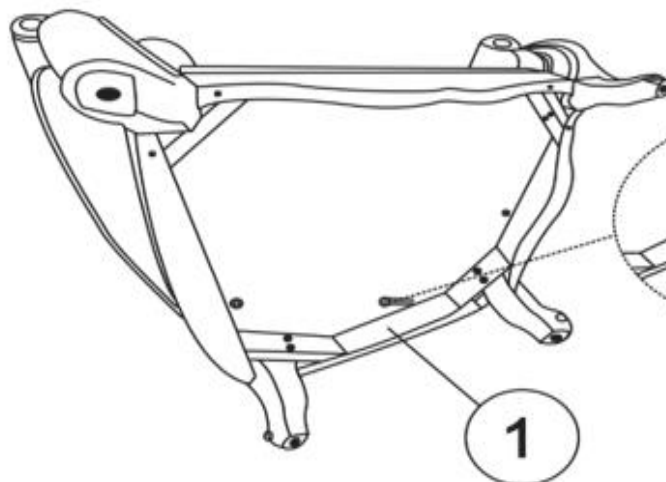

Place the chair on its back on a clean and soft surface to reach the thread bolt (#C). Secure the backrest (#4) to the seat frame (#1) by using the Wrench (#H) with hardware #A, #B and #G.

6

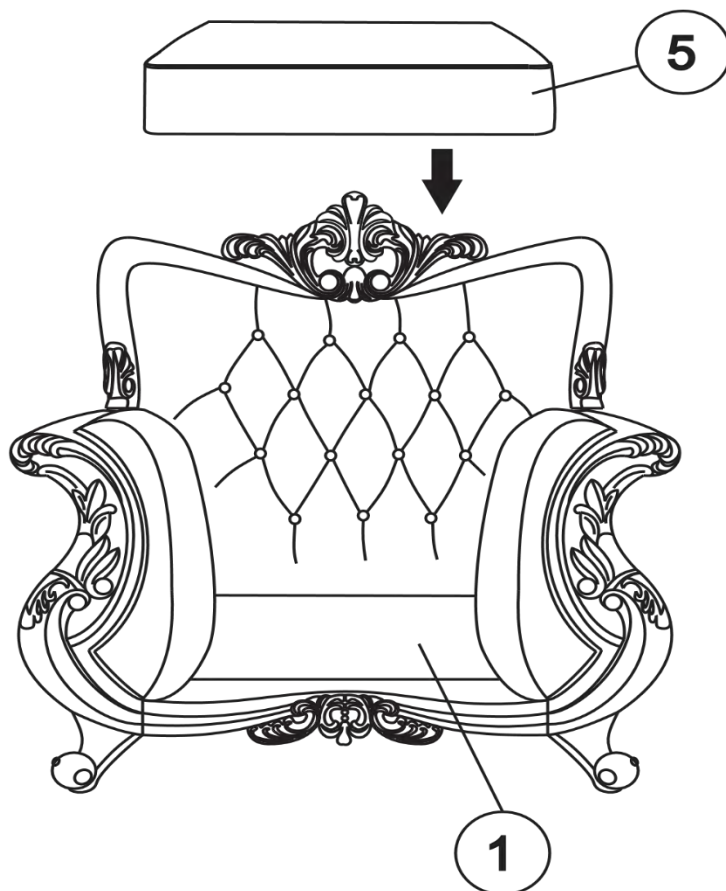

Place the chair up right and install the seat cushion (#5) to the seat frame (#1).

ASSEMBLY INSTRUCTIONS

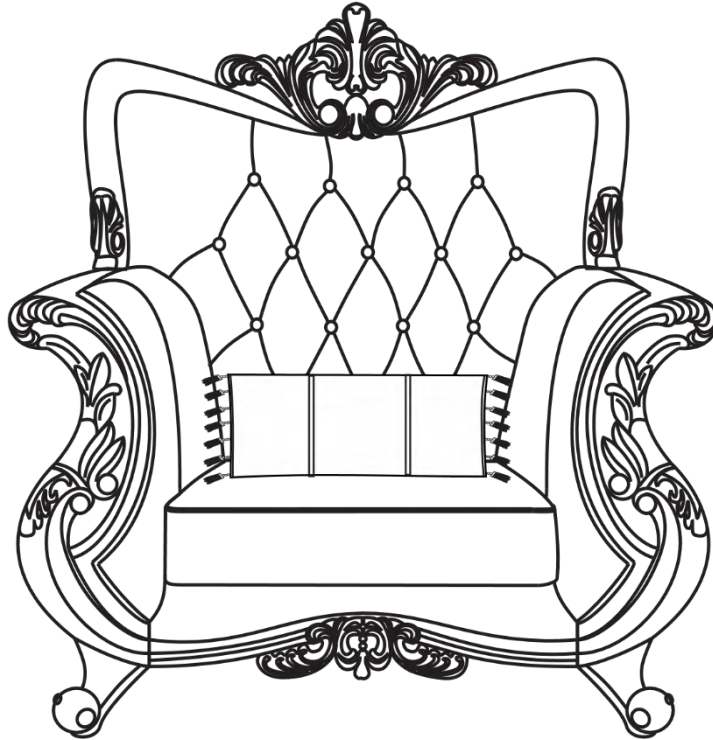

ASSEMBLY COMPLETED



Please ensure the furniture rests on an even and flat surface. If the product wobbles or feels loose, double-check all bolts and/or screws are properly tightened and secured.



Keep this handy!

Please retain this instruction manual and any order-related information for future reference.



Lift, don't drag!

To avoid damage to product please always LIFT the product when transporting or adjusting the placement.

This product is intended for
RESIDENTIAL USE ONLY
and not for commercial use



