

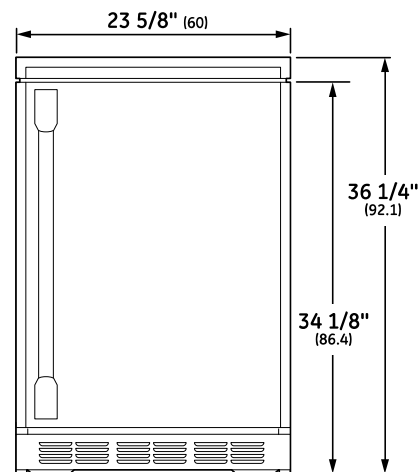

## OVERALL DIMENSIONS

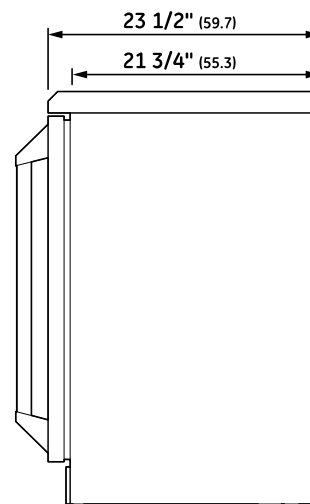

FRONT VIEW

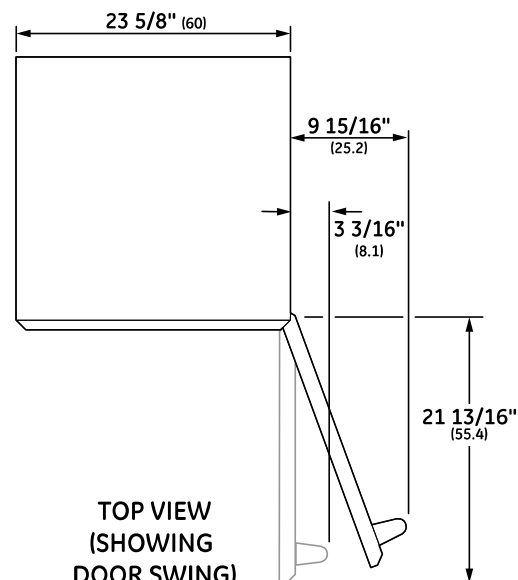

SIDE VIEW

TOP VIEW  
(SHOWING  
DOOR SWING)

## SPECIFICATIONS

Overall Width	23 5/8" (60 cm)
Overall Height	36 1/4" (92.1 cm)
Overall Depth	23 1/2" (59.7 cm)
Door Clearance	9 15/16" (25.2 cm) @ 110° 3 3/16" (8.1 cm) @ 90° 21 13/16" (60.6) door length
Overall Capacity	5.4 cu. ft.
Minimum Cabinet Width	23 3/4" (60.3 cm)
Minimum Cabinet Depth	24" (60.9 cm)
Cutout Width	23 3/4" (60.3 cm)
Cutout Height	34 1/2" (87.7 cm) Min 36 1/2" (89 cm) Max
Electrical Requirements	1.0 A
Voltz/Hertz/Amps	120 V, 60 Hz, 15 or 20 amp circuit
Shipping Weight	154 lb (70 kg)

## ATTENTION ELECTRICIAN:

A 115 volt 60Hz., 15 or 20 amp power supply is required. An individual properly grounded branch circuit or circuit breaker is recommended. Install a properly grounded 3-prong electrical receptacle recessed into the back wall.

Dimensions in parentheses are in centimeters unless otherwise noted.

Actual product dimension may vary due to manufacturing tolerances.

## INSTALLATION

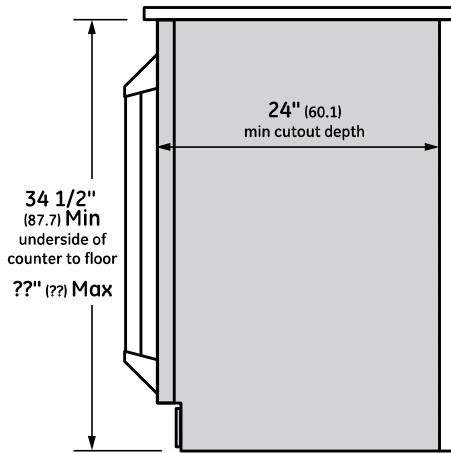

FLUSH CUTOUT INSTALLATION  
SIDE VIEW

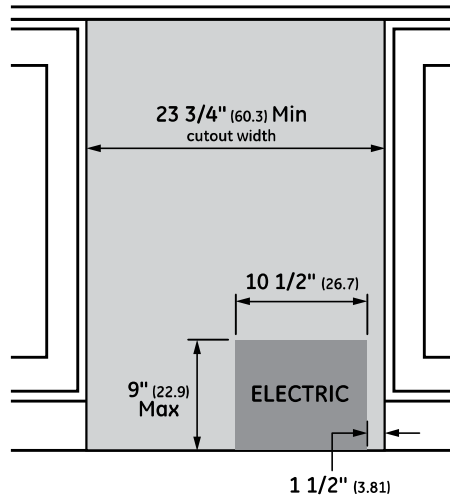

INSTALLATION CUTOUT  
FRONT VIEW

## NOTES

**Note:** If installing between frameless cabinets, a 1/2" wide filler strip or side panel may be required. The filler strip will act as a spacer between the door case and adjacent cabinet and will prevent interference with cabinet door swing. The width of the opening must include filler panels.

**Note:** This product can be installed as a built-in or used free-standing. The top canopy can be removed for installation below a countertop.

**The cutout depth must be 24"**

The cutout dimensions shown allows for a full door swing and access to the pull-out racks when installed as a built-in.

- The outdoor/indoor refrigerator can be used freestanding.
- Stainless steel top canopy can be removed for built-in installation.
- Vented stainless steel toekick.

## FEATURES AND BENEFITS

**Stainless Steel Outdoor design** - Sturdy, professional grade exterior stands up to the most demanding environmental conditions

**Adjustable Temperature Control** - Maintains a consistent temperature

**LED Temperature Display** - Allows you to monitor the temperature at a glance

**Removable Spillproof Glass Shelves** - Helps contain spills for ease of cleaning

**Professional-Style Handle** - Coordinates with other Monogram Professional cooking appliances

**Stainless steel removable canopy** - Canopy protects the top of the refrigerator in outdoor environments and can be removed to allow built-in installation

**Stainless Steel Exterior** - Convey a look of utmost polish and sophistication

**Quick Space Shelf** - Slides out of the way to make room for tall items

**Beverage Shelf on Full-Extension Slides** - Holds up to five wine bottles or ten 12-oz. cans



ZDOD240HSS - right-hinged door

