

User Guide for Pet Care Accessories



MHK67632109

Rev.01_013124

* This guide was created for all models, so the images or content may be different from your product.

When using pet care accessories, use the Pet Care cycle.

- After connecting the dryer to the **LG ThinQ** application, you can update the function on the Feature Updates screen. For detailed instructions on how to use the **LG ThinQ** application, refer to the user manual of the dryer or the **LG ThinQ** application guide.

The Pet Care cycle is available only on heat pump dryers with the ThinQ UP feature.

- Search for heat pump dryers with the ThinQ UP feature using the search window on the LG Electronics website and check the **Product - Clothes Dryer** column for ThinQ UP compatible dryer models.
- ※ The filter in the pet care accessories is only compatible with heat pump dryers that are 27 inches wide.

Using the Pet Care Dry Cycle

The **Pet Care** cycle helps to remove hair, reduce pet-related allergens, and deodorize pet owners' or pets' clothing. Performance may vary depending on the service environment or actual service conditions.

- 1 Before using the product, be sure to clean the filter and empty the water tank.
- 2 Remove both the **inner filter** ① and the **outer filter** ② of the normal filter installed in the product.

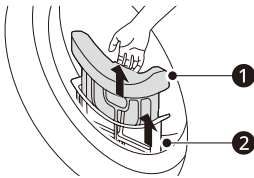

- 3 Insert the **inner filter** ③ and the **outer filter** ④ of the **pet care filter** into the filter inlet.

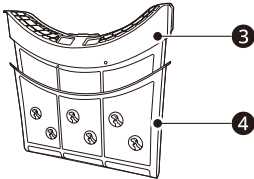

- Use the **pet care filter** only for the **Pet Care** cycle and use a normal filter for all other cycles.
 - Using a normal filter with the **Pet Care** cycle may degrade the hair and dust collection performance.
 - If the **pet care filter** is used with a cycle other than the **Pet Care** cycle, the drying time may be longer depending on the service environment.

- 4 Open the dryer door and place items weighing less than 3.3 lb (1.5 kg) and the **pet care dryer balls** ⑤ in the dryer.
 - Drying items stained with feces, saliva, or dirt may cause an odor inside the dryer. Always wash items before drying them.
 - Do not use with delicate fabrics such as wool or silk, or items that may fade.
 - The **pet care dryer balls** ⑤ help to shake hair off of clothing by tapping the clothing but do not collect the hair. Be sure to use only the provided **pet care dryer balls** ⑤.

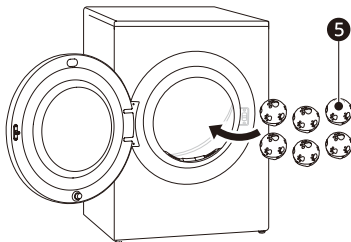

- 5 For dryers with a steam function, fill the steam tank with water or connect the water inlet hose.
- 6 Press the **Power** button.
- 7 Select the **Pet Care** cycle.

- 8 Press the **Start/Pause** button to start drying. When drying is completed, remove items and the **pet care dryer balls**.

⚠ Caution

- The temperature inside the drum is very high during drying. Your clothes and the **pet care dryer balls** may be hot after drying.
- 9 Clean the inside of the drum, the door glass, rubber packing, and lint around the filter using a damp cloth or wet paper towel.

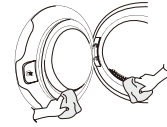

- 10 Empty the water tank.
 - If you have connected a drain hose to the product, there is no need to empty the water tank as it will drain during drying.

- 11 Clean the **pet care filter**.
 - For details, refer to the **Cleaning the Pet Care Filter** page.



Inner filter



Pet filter



Outer filter

- 12 Clean the **pet care dryer balls**.



- 13 Leave the dryer door ajar using the door magnet ⑥ to ventilate the inside of the dryer.

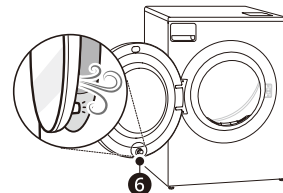

⚠ Caution

- Be sure to insert the **pet filter** into the **inner filter** before use. If the filter is used without the **pet filter**, the hair and dust collection performance may be degraded.
- Do not use damaged filters.

Note

- A noise may be generated as the **pet care dryer balls** tumble inside the drum. This is normal.
- If you use the **Pet Care** cycle often, use the **condenser care** function to maintain the dryer.

Cleaning Pet Care Accessories

Cleaning the Pet Care Filter

Clean the **inner filter** ①, **pet filter** ② and **outer filter** ③ every time you use them.

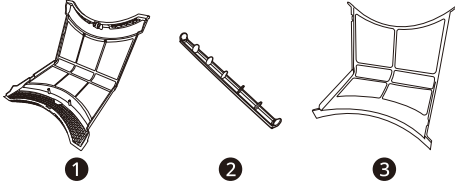

⚠ Caution

- If the filter is not cleaned and maintained properly, the drying time may increase or dust in the condenser may not be cleaned off properly.

Cleaning the Inner Filter and Pet Filter

- 1 After drying is done, remove all items from the drum and slide out the **inner filter**. Pull the two sides apart at the center to unfold the filter.

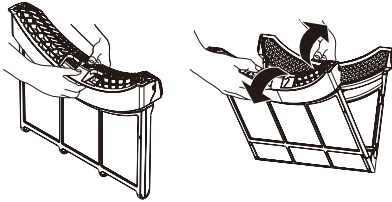

- 2 Remove the small **pet filter** inside the **inner filter**.
- 3 Remove any large lint from the filter first, and then remove any remaining lint with a vacuum cleaner or running water.

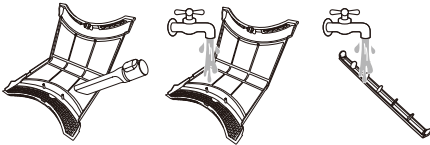

- If the filter is wet, allow it to dry completely before reusing it.
- Placing a filter that is not completely dry in the dryer may cause an odor inside the dryer.

- 4 When completely dry, insert the **pet filter** into the grooves in the **inner filter**.

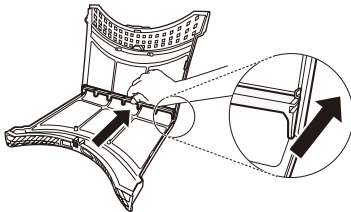

- 5 Refold the **inner filter** and snap the two sides together at the center. Make sure the left and right sides are closed properly.

Cleaning the Outer Filter

- 1 Remove any lint around the filter inlet and then remove the **outer filter**.

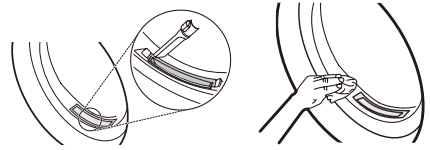

- If lint falls into the filter inlet, the drying performance may be degraded or the drying time may increase.
- 2 Pull the two sides apart to unfold the filter and remove any lint inside the filter using a vacuum cleaner or running water.

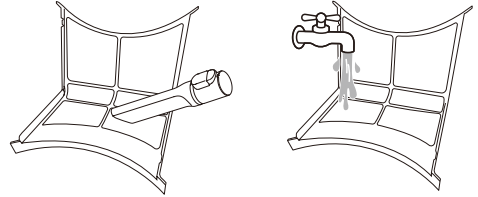

- If the filter is wet, allow it to dry completely before use.
- Placing a filter that is not completely dry in the dryer may cause an odor inside the dryer.

- 3 Assemble the inner and outer filters.
 - Make sure the **pet filter** is inserted in the **inner filter**.

⚠ Caution

- If you insert and use the **inner filter** in the filter inlet without the **outer filter**, drying time may increase or dust in the condenser may not be cleaned off properly.
- Always install the **pet filter** before using the **inner filter**. Using it without the **pet filter** may degrade the hair and dust collection performance.

Cleaning the Pet Care Dryer Balls

After use, wash the **pet care dryer balls** thoroughly under running water, including the insides, and allow them to dry in the shade.

- Remove any clumps of pet hair first, and then remove any remaining hair and lint under running water.



⚠ Caution

- Do not boil the **pet care dryer balls**. Doing so may deform the **pet care dryer balls**.