

BI-36UG/O



## FEATURES

- LED Lighting for brighter interior
- Overlay design accepts cabinetry panels of all kinds
- Dual refrigeration keeps food fresher longer
- Air purification system fights spoilage, odors
- Crispers and deli drawers in low-temp, high-humidity zones for optimum freshness
- Microprocessor control assures peak performance
- Water-filtration system reduces contaminants, chlorine taste and odor
- Freshness cards for maximum food preservation
- Rigorously tested in our U.S. manufacturing facilities to ensure decades of use
- Exceptional 24/7 support from Madison, WI-based Customer Care team
- Over-and-under refrigerator/freezer storage
- Magnetic door seal system locks in cold air
- Automatic ice maker with "max ice" feature
- Adjustable shelves for maximum convenience

## ACCESSORIES

- Air Purification Cartridge
- Built-In Custom Side Panel Mounting Kit
- Dual Installation Kit
- Egg Container
- Stainless Steel Side Panel
- White Side Panel
- Stainless steel kickplate
- Grilles for 83" or 88" finished height (84" is standard)
- Side panel mounting kit
- Dual Installation Kit with Dual Wide Grille
- Flush inset panels in stainless steel with tubular or pro handles
- Full-length standard and extended framed handles
- Stainless Steel Pro Handles
- Stainless Steel Tubular Handles

Accessories are available through an authorized Sub-Zero dealer.  
For local dealer information, visit [subzero-wolf.com/locator](http://subzero-wolf.com/locator).



## HANDLE ACCESSORIES

PRO



TUBULAR



## PRODUCT DETAILS

### REFRIGERATOR

- 3 Adjustable glass shelves
- 1 Stationary glass shelf
- 1 High-humidity drawer with dividers
- 1 Storage drawer with dividers

### FREEZER

- Full-extension roll-out freezer drawer
- Two-tier wire storage baskets
- Automatic ice maker

# 36" BUILT-IN OVER-AND-UNDER GLASS DOOR REFRIGERATOR/FREEZER - PANEL READY

SUB<sup>®</sup>ZERO

## PRODUCT SPECIFICATIONS

|                       |                          |
|-----------------------|--------------------------|
| Model                 | BI-36UG/O                |
| Dimensions            | 36"W x 84"H x 24"D       |
| Door Clearance        | 37 1/4"                  |
| Drawer Clearance      | 23 5/8"                  |
| Weight                | 515 lbs                  |
| Refrigerator Capacity | 16.3 cu. ft.             |
| Freezer Capacity      | 5.3 cu. ft.              |
| Electrical Supply     | 115 VAC, 60 Hz           |
| Electrical Service    | 15 amp dedicated circuit |
| Receptacle            | 3-prong grounding-type   |

## ELECTRICAL

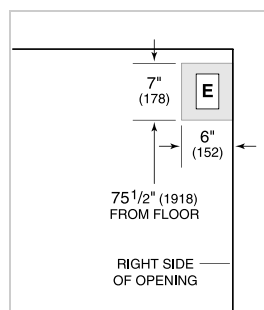

## PLUMBING

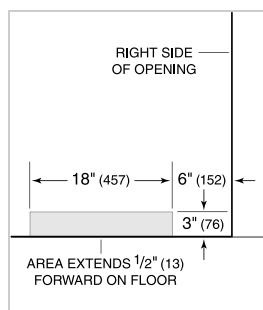

## PANEL SPECIFICATIONS

For complete panels specifications including width/height, weight requirements, thickness requirements and offset details visit [subzero-wolf.com/builtinconfigurator](http://subzero-wolf.com/builtinconfigurator).

## NOTE:

Dimensions in parenthesis are in millimeters unless otherwise specified

## INTERIOR VIEW



This illustration is intended for interior reference only and may not represent the exterior of the model being specified.

## DIMENSIONS

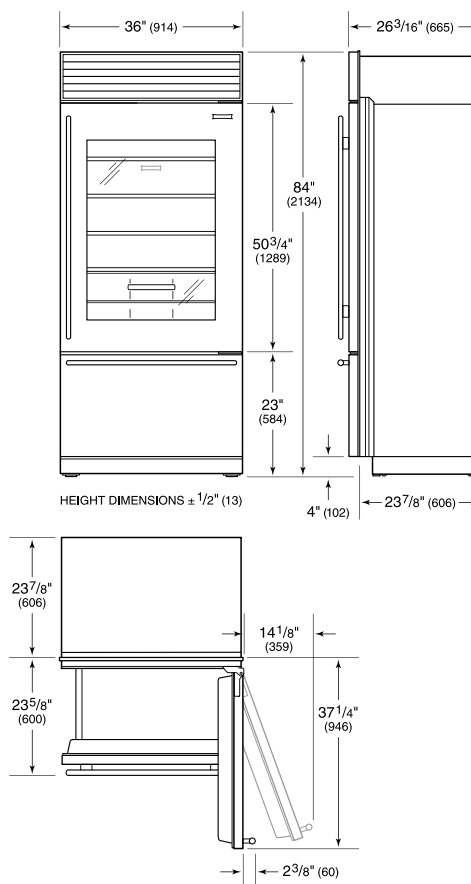

## FLUSH INSET INSTALLATION

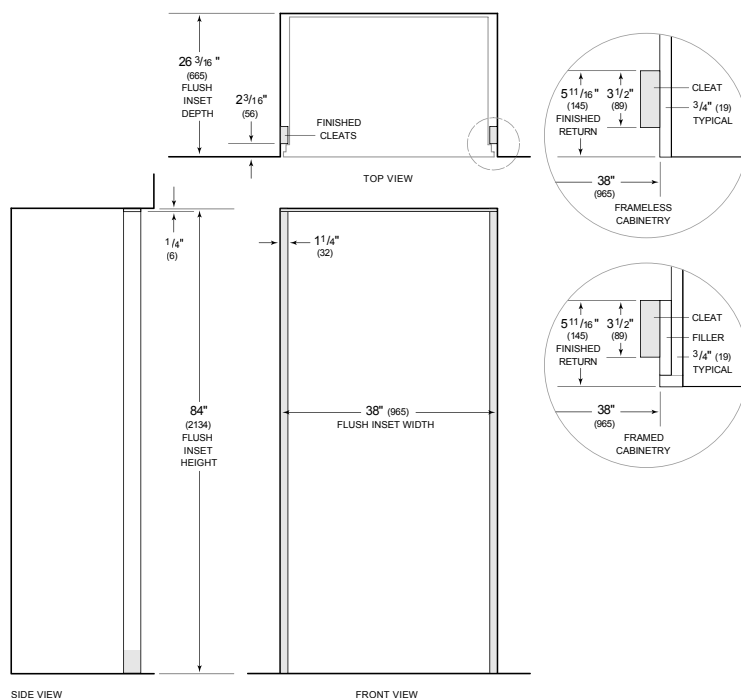

NOTE: 3 1/2" (89) finished returns and shaded areas will be visible and should be finished to match cabinetry. Shaded line represents profile of unit with 1/4" (19) panel.

