

# T24UW925LS

## UNDER-COUNTER WINE RESERVE WITH GLASS DOOR

PROFESSIONAL COLLECTION HANDLE – LEFT HINGED



Also Available:

- T24UW925RS – Right Hinged with Professional Collection Handle
- T24UW915LS – Left Hinged with Masterpiece® Collection Handle
- T24UW915RS – Right Hinged with Masterpiece® Collection Handle
- T24UW905LP – Left Hinged Custom Panel-Ready
- T24UW905RP – Right Hinged Custom Panel-Ready

### FEATURES & BENEFITS

- Dual zone wine storage with adjustable temperature zones
- Full-extension wine racks
- UV resistant tempered glass door
- Soft Close door hinges for ultra-smooth closing of the door
- LED theater lighting
- Touch electronic controls for precise temperature management

### GENERAL PROPERTIES

|                               |   |
|-------------------------------|---|
| UV Resistant Glass Door       | Yes   |
| Reversible Door Swing         | Left and Right Available                                |
| Soft Close Door Hinges        | Yes   |
| Lighting                      | Adjustable LED Lighting                                 |
| Bottle Shelves                | 6   |
| Shelf Material                | Wenge Triangular Hardwood dowels w/ Aluminum Front Caps |
| Full Extension Wine Racks     | Yes   |
| Dual Zone Wine Storage        | Yes   |
| Door Open Alarm               | Yes   |
| Touch Electronic Controls     | Yes   |
| STAR-K Certified Sabbath Mode | Yes   |

### CAPACITY

|                   |    |
|-------------------|----|
| Number of Bottles | 41 |
|-------------------|----|

### TEMPERATURE RANGES

|            |                             |
|------------|-----------------------------|
| Upper Zone | 40°F (3°C) to 54°F (12°C)   |
| Lower Zone | 40°F (4.5°C) to 64°F (18°C) |

### TECHNICAL DETAILS

|                         |             |
|-------------------------|-------------|
| Watts (W)               | 150 W       |
| Current (A)             | 15 Amp      |
| Volts (V)               | 115 V       |
| Frequency (Hz)          | 60 Hz       |
| Power Cord Length (in.) | 60"         |
| Plug Type               | 120V 3-Wire |

### DIMENSIONS & WEIGHT

|  |                             |
|--|-----------------------------|
| Appliance Dimensions (H x W x D) (in.) | 34 3/8" x 23 7/8" x 23 5/8" |
| Required Cutout Size (H x W x D) (in.) | 34 1/2"–35 1/4" x 24" x 24" |
| Net / Gross Weight (lbs.)              | 140 / 151 lbs.              |

### EFFICIENCY

|                           |         |
|---------------------------|---------|
| Annual Energy Consumption | 155 kWh |
|---------------------------|---------|

### WARRANTY

Limited, Entire Appliance, Parts and Labor on any Part of the Refrigerator that Fails Because of a Manufacturing Defect

2 Year

Limited Warranty for Sealed Refrigeration System\*\*; Parts and Labor

3rd to 6th Year

Limited Warranty for Sealed Refrigeration System\*; Parts Only

7th to 12th Year

\*Height adjustable + 1/2" (13 mm) with legs fully extended

\*\*Sealed refrigeration system includes compressor, evaporator, condenser, dryer / strainer and connection tubing

# T24UW925LS

## UNDER-COUNTER WINE RESERVE WITH GLASS DOOR

### PROFESSIONAL COLLECTION HANDLE – LEFT HINGED



#### GLASS DOOR WINE RESERVE PRODUCT DIMENSIONS

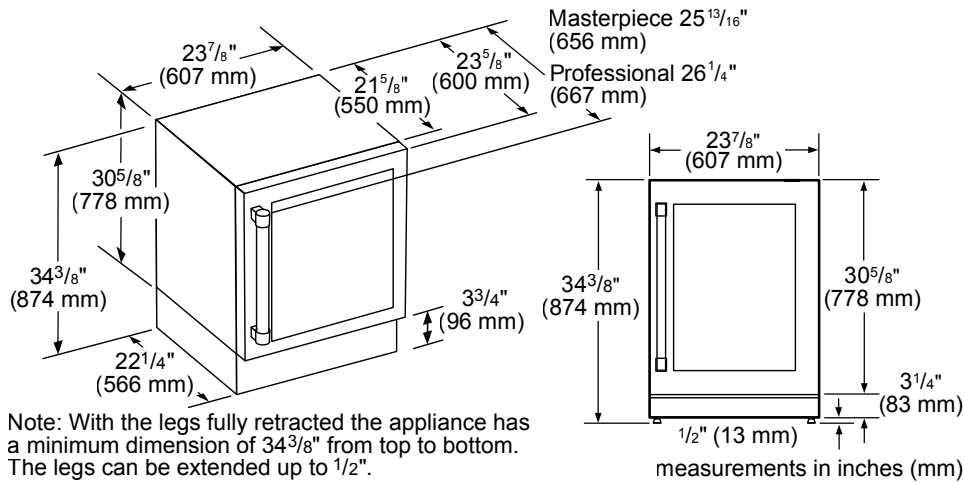

#### GLASS DOOR WINE RESERVE CUTOUT DIMENSIONS

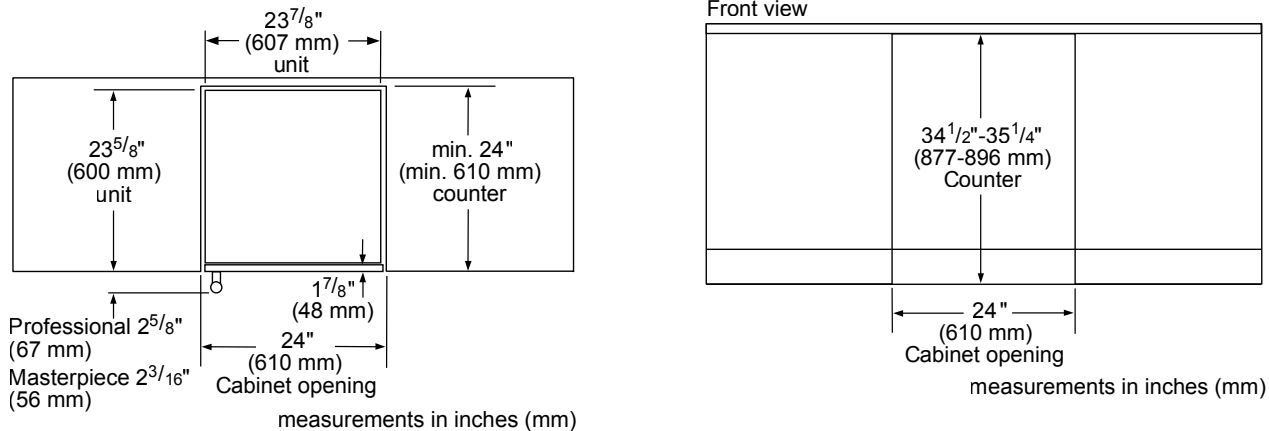

#### GLASS DOOR WINE RESERVE CUTOUT DIMENSIONS & ELECTRICAL LOCATION

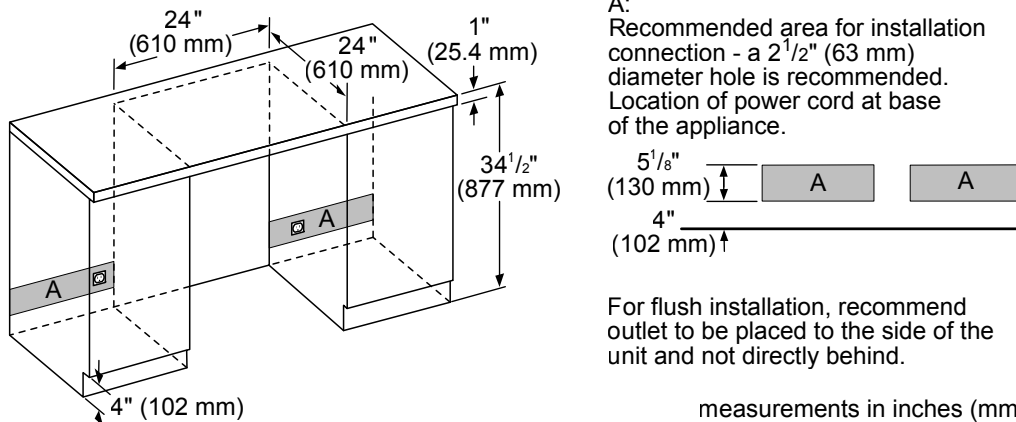

# T24UW925LS

## UNDER-COUNTER WINE RESERVE WITH GLASS DOOR

### PROFESSIONAL COLLECTION HANDLE – LEFT HINGED



#### GLASS DOOR WINE RESERVE CUTOUT & DOOR SWING DIMENSIONS

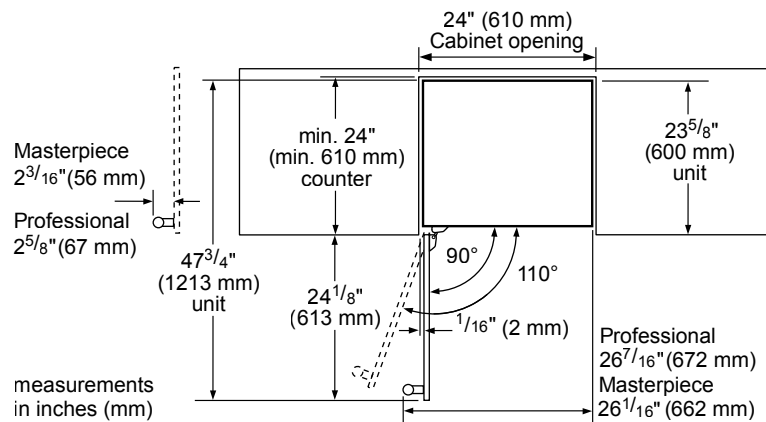

#### GLASS DOOR WINE RESERVE SIDE-BY-SIDE INSTALLATION

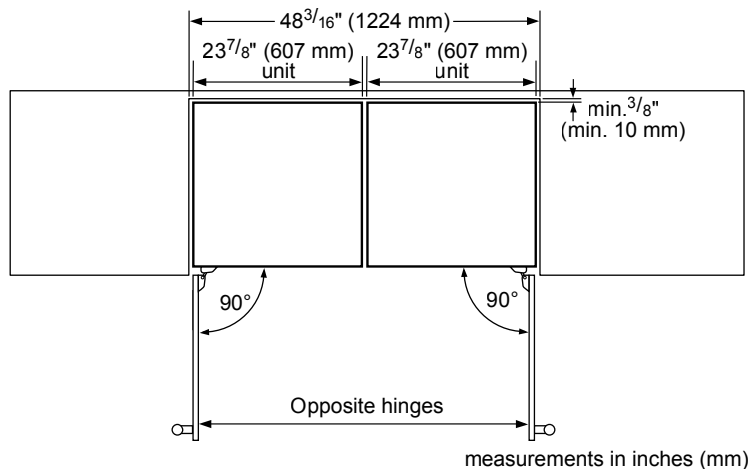

These warranties give you specific legal rights and you may have other rights that vary from state to state. Limited warranty from date of delivery. For complete warranty details, refer to your Use & Care manual, or ask your dealer.

Specifications are for planning purposes only. Refer to installation instructions and consult your countertop supplier prior to making counter opening. Consult with a heating and ventilation engineer for your specific ventilation requirements. For the most detailed information, refer to installation instructions accompanying product or write to Thermador indicating the model number. Specifications are correct at time of printing. Thermador reserves the right to change product specifications or design without notice. Some models are certified for use in Canada. Thermador is not responsible for products that are transported from the U.S. for use in Canada.