

# TA53086 ASSEMBLY INSTRUCTION

**P1** x1

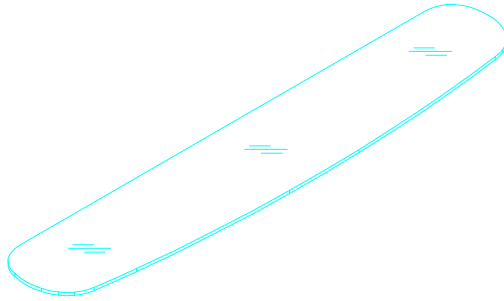

Glass top

**P2** x1

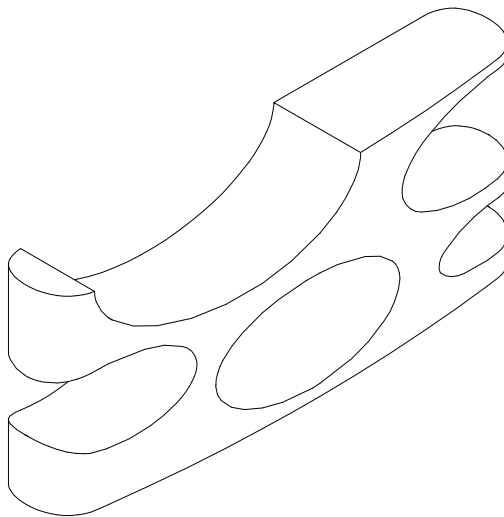
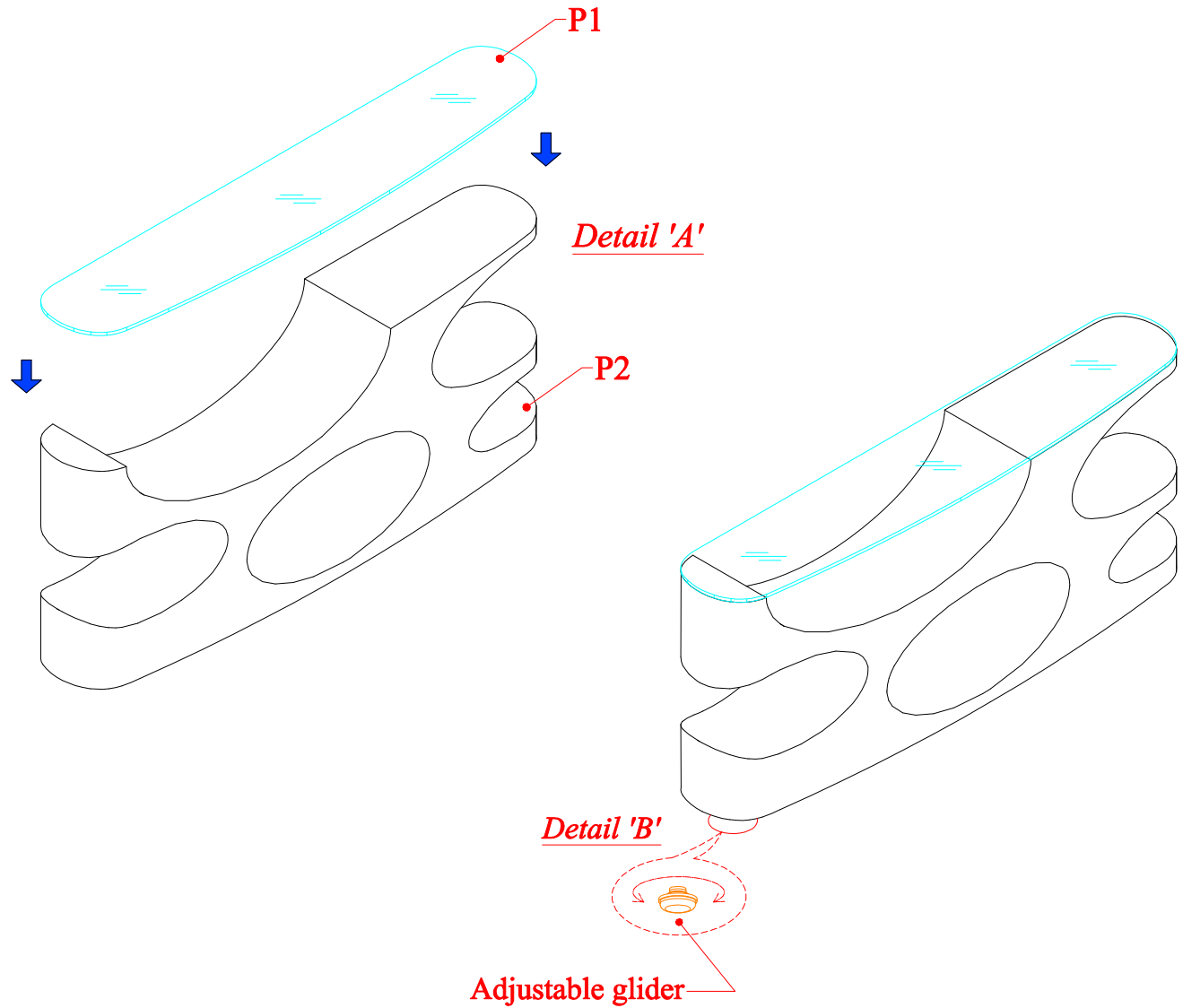

Table frame



**INSTRUCTIONS :**

1. Put the glass top (**P1**) to the table frame (**P2**). Refer *detail 'A'*.
2. Item is ready to use.(Adjust glider for the table levelling if necessary refer *detail 'B'*)