

MONTIGO®

OUTDOOR

OUTDOOR / PROUDLY HANDCRAFTED IN NORTH AMERICA

H34VO

H38VO

HL38VO

H42VO

H38SVO

HL38SVO

PL42VO

PL60VO

R324STIO





OUTDOOR / HL38SVONE / EBONY FIRESTONES

A large outdoor fireplace with a thick, rustic wood stone surround. The fire is burning brightly inside the glass-enclosed unit. In the background, there is a modern house with large windows and a patio area with outdoor furniture.

OUTDOOR



MONTIGO / MAHANA / PL42VONE / STAINLESS STEEL ENCLOSURE

A modern outdoor fireplace with a sleek, stainless steel enclosure. The fire is burning brightly inside the glass-enclosed unit. The fireplace is situated on a wooden deck, and there is outdoor furniture visible in the background.

The image is a composite of two photographs. The top photograph shows a close-up of a wooden lounge chair with light blue and white striped cushions, positioned next to a large glass door. The bottom photograph shows a wider view of an outdoor patio. In the foreground, there is a wooden dining table with four matching chairs and a wooden bench. To the left, there are wooden lounge chairs. In the background, a fireplace is mounted on a grey wall, and a large glass door reflects the outdoor scene. The word 'DOOR' is written in large, white, outlined letters across the middle of the image, with the 'O's overlapping the top and bottom photos.

REDEFINE YOUR OUTDOOR SPACE

THE WARMTH AND COMFORT OF YOUR LIVING ROOM NOW ON YOUR PATIO

Ventless design creates endless possibilities for placement in your outdoor space. All Montigo outdoor fireplaces are fabricated with high quality 304 stainless steel construction for extended outdoor life.

From traditional brick liners, all the way to multi-color LED lighting for the Mahana, all fireplaces in the Montigo Outdoor series have numerous options for customization.

DOOR

OUTDOOR HL38VONE SAGE FIREBEADS



OUTDOOR
OUTDOOR  SERIES

REDEFINE YOUR OUTDOOR SPACE

H34 H38 H42 TRADITIONAL

Standard

Traditional burner
and logset

Safety screen

Options

Various traditional liners

Mirror back panel

Drain pan

Wrought iron grate

HL38 CONTEMPORARY

Standard

Contemporary burner with
Ice fireglass

Safety screen

Options

Glass media

Drain pan

H34VO
H38VO
HL38VO
H42VO

SINGLE SIDED
VENTLESS
OUTDOOR





MONTIGO / DIVINE / HL38VON / SAGE FIREBEADS / SHOWN WITHOUT SCREEN



MONTIGO / DIVINE / H34VON / SHOWN WITHOUT SCREEN

OPTIONS &
FEATURES

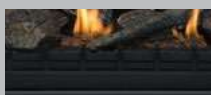

IRON GRATE
HWIG**



DRAIN PAN
ODSSP**

LINERS



HERRING BONE
HBK**



COLONIAL
HBK**



HERITAGE
HBK**



MIRROR
RPH**VOR

Features

Ventless design

Stainless steel
construction

OUTDOOR / PROUDLY HANDCRAFTED IN NORTH AMERICA

OUTDOOR
OUTDOOR  SERIES

CREATE YOUR OUTDOOR OASIS

H38SVO TRADITIONAL

Standard

Traditional burner
and logset

Manual Hi-Lo
flame control

Wrought iron grate

Safety screen

Options

Freestanding cool-touch
enclosure (HSI units only)

HL38SVO CONTEMPORARY

Standard

Contemporary burner
with Ice fireglass

Manual Hi-Lo
flame control

Safety screen

Options

Glass media

Freestanding cool-touch
enclosure (HSI units only)

H38SVO, HL38SVO

SEE THROUGH
VENTLESS
OUTDOOR





MONTIGO / DIVINE / H38SVON / TRADITIONAL LOGSET / SHOWN WITHOUT SCREEN



OPTIONS &
FEATURES



COOLTOUCH
ENCLOSURE¹
RTSCH38VO



Features

Ventless design

304 Stainless steel

Fans provide zone heating up to 10'

OUTDOOR / PROUDLY HANDCRAFTED IN NORTH AMERICA



MAHANA
OUTDOOR  SERIES

A WARM BREEZE

MAHANA CONTEMPORARY

PL42VO
PL60VO

VENTLESS
OUTDOOR

Standard

Concealed burner with Quartz firebeads

Built in fan system

Safety screen

Options

LED backlighting

Stainless steel and powdercoated enclosures

Enclosure pedestal

Enclosure cover

Speckled stones, driftwood, glass media

Remote control on/off



CARBON
RAL 9005

GRAPHITE
RAL 7015

DUNE
RAL 9002

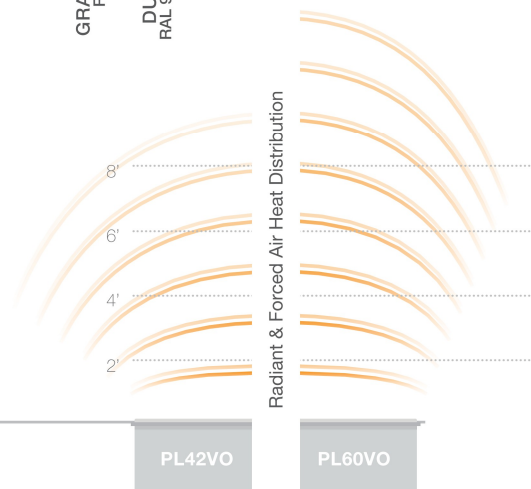



MONTIGO / MAHANA / PL60V0 / QUARTZ FIREBEADS /



OPTIONS & FEATURES



ENCLOSURES
PLVOBE**



ENCLOSURE
PEDESTAL
PL**VOBE-P



ENCLOSURE COVER
PL**CVR



LED BACKLIGHTING
PLVOBE**



REMOTE ON/OFF
RXM40VACVO



SPECKLED STONES
RR***SS

COPPER
HW1143

AMBER
HW1261

ICE
HW1157

GLACIER
HW1219B

PLATINUM
HW1144

ALABASTER
HW1260

OBSIDIAN
HW1113

ONYX
HW1259

MEDIA

FROST
HW1112

QUARTZ
HW1106

EBONY
HW1091

DRIFTWOOD
LGS***

Unit Specifications

ICON LEGEND

AVAILABLE

+

NOT AVAILABLE

-

DEDICATED

◊

STANDARD

◊

	BTU NATURAL GAS	BTU LIQUID PROPANE	CLEARANCE TOP	CLEARANCE SIDES	CLEARANCE BACK	CLEARANCE FLOOR	STANDARD MEDIA	FRONT GLASS TYPE	POWERVENT	REMOTE CONTROL	FANS	UPLIGHTING	DOWNLIGHTING
H34VO**	26,000	26,000	9	1†	1†	0	TRADITIONAL	HIGH TEMPERATURE	-	-	-	-	-
H38VO**	34,000	34,000	9	1†	1†	0	TRADITIONAL	HIGH TEMPERATURE	-	-	-	-	-
HL38VO**	34,000	34,000	9	1†	1†	0	HW1157	HIGH TEMPERATURE	-	-	-	-	-
H38SVO**	34,000	34,000	36	12	N/A	0	TRADITIONAL	HIGH TEMPERATURE	-	-	-	-	-
HL38SVO**	34,000	34,000	36	12	N/A	0	HW1157	HIGH TEMPERATURE	-	-	-	-	-
H42VO**	40,000	40,000	9	1†	1†	0	TRADITIONAL	HIGH TEMPERATURE	-	-	-	-	-
PL42VO*	28,000	28,000	0	1	0	0	HW1106	HIGH TEMPERATURE	-	-	◊	+	-
PL60VO*	47,000	47,000	0	1	0	0	HW1106	HIGH TEMPERATURE	-	-	◊	+	-

†Clearance to insulation jacket is 0"

DIVINE OUTDOOR FRAMING

	A	B	C	D	E	F	G	H
H34VO	38¾	35⅞	20¼†	*	61⅞	35⅞	0	43⅞
H38VO	42½	39¼	21⅞†	*	65⅞	39¼	0	49⅞
H42VO	46½	43½	22⅞†	*	72¼	43½	0	51⅞

DIVINE OUTDOOR ST FRAMING

	A	B	C	D
H38SVO	38	41	23⅞	*

MAHANA FRAMING AND ENCLOSURE

	A	B	C	D	E	F	G	H	I	J
PL42VO	27¼	42	11⅞	*	62⅞	42	0	48⅞	51⅞	34⅞
PL60VO	27¼	66	11⅞	*	87	66	0	65½	76⅞	34⅞

MAHANA ENCLOSURE

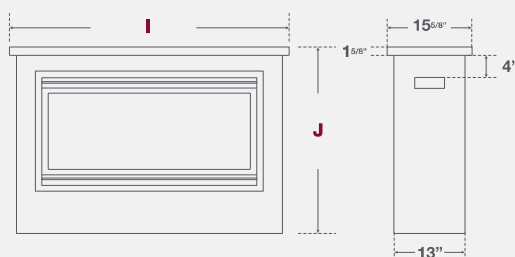

DIVINE OUTDOOR ST ENCLOSURE

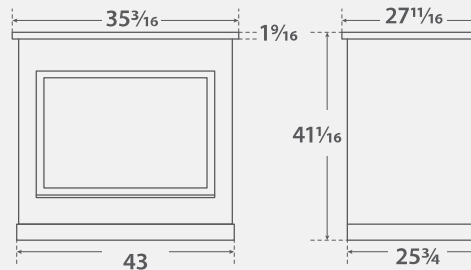

See instruction manual for detailed instructions

Be sure to plan a drain system for both in the wall and standalone installations.

*Check local codes and manual for minimum distance from grade to unit.

†Dimension is to back wall or back studs

1976: The Days Before Gas Fireplaces

In 1976, Montigo president and founder, Dan Binzer, started installing zero-clearance wood burning fireplaces for local builders in Vancouver, BC. Over the years, demand grew for a gas alternative, and Dan engineered and manufactured the first ever sandpan logset. The logset was installed in a zero-clearance wood burning fireplaces shell, resulting in one of the first zero-clearance gas fireplaces on the market.

1985: Gas Fireplace Manufacturing Begins

Demand for gas grew rapidly, especially among multi-unit developments so Dan Binzer started a company called Canadian Heating that would offer full service design, engineering and manufacturing for gas fireplaces. Under the Montigo brand, Canadian Heating began manufacturing and selling a wide selection of zero-clearance gas fireplaces throughout Canada and in 1985 development began for the latest and greatest in gas fireplace technology – direct venting.

1994: Manufacturing Excellence is Achieved

Development and advancement of the gas fireplace continued over the years with continual developments to improve the efficiency of the fireplaces and perfected manufacturing processes to deliver an optimum fireplace each and every time – even for completely custom units.

Present: Leading the Way with Modern Fireplace Design

As one of the first to bring a linear designed fireplace to market, Montigo now offers the largest selection of linear fireplaces demanded by designers, architects and homeowners wanting to create a modern and contemporary space and homeowners wanting to create a modern and contemporary space.



WARNING

Some materials used in the manufacturing process of this product can expose you to Benzene which is known in the State of California to cause cancer and birth defects or other reproductive harm. For more information go to www.P65warnings.ca.gov

for more inspiration go to
www.montigo.com

MONTIGO[®]
the art of **fireplaces**



Our Guarantee

Montigo[®] stands behind the craftsmanship and durability of our products by providing a 15 year warranty on the burner and firebox in all our residential fireplaces.



Printed in USA

XB2210