



# Assembly Instructions

ITEM NO. D3651-22  
AMY COUNTER CHAIR (2PCS/CTN)

Thank you for purchasing this quality product. Be sure to check all packing materials carefully for small parts, which may have come loose inside the carton during shipment. Identify and count all items and compare with the PARTS LIST and/or HARDWARE LIST shown below.



Please read the instructions thoroughly before assembly.

1. We recommend that you assemble this product with the assistance of another person; this will make the assembly easier, and will help eliminate damage to the product or injury to persons during assembly.
2. Please do not tighten screws or bolts until the assembly is completed.
3. To level the chairs or table, before tightening all the screws, the chair s or table must be placed on a flat surface and then tighten the screws.
4. Please put all parts on a non-abrasive floor before assembly and follow the assembly steps to assemble your newly purchased product correctly and efficiently.

## PARTS LIST

NO.	COMPONENT	SKETCH	QTY.
A	CHAIR BACK		2 PCS
B	SEAT FRAME		2 PCS
C1	RIGHT SIDE FACING (RSF) LEG		2 PCS
C2	LEFT SIDE FACING (LSF) LEG		2 PCS
D1	RIGHT SIDE FACING (RSF) STRETCHER		2 PCS
D2	LEFT SIDE FACING (LSF) STRETCHER		2 PCS
E	FRONT STRETCHER		2 PCS

## HARDWARE LIST

NO.	COMPONENT	SKETCH	QTY.
1	FLAT WASHER 5/16" DIA.		22 PCS
2	SPRING WASHER 5/16" DIA.		22 PCS
3	NUT 5/16" DIA.		8 PCS
4	WRENCH 5/16" DIA.		1 PC
5	SHORT BOLT 1/4" x 1 3/4"		6 PCS
6	LONG BOLT 1/4" x 3"		8 PCS
7	WOOD SCREW #8 x 1 1/2"		12 PCS

WEIGHT CAPACITY

250 pounds (per seat)

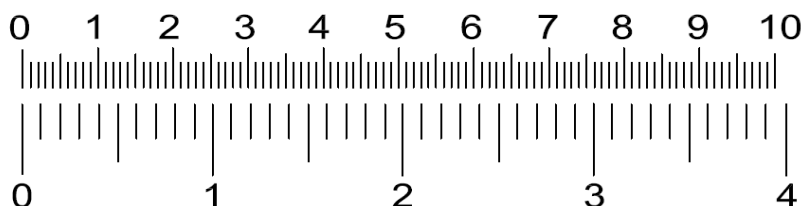

# Assembly Instructions

ITEM NO. D3651-22  
AMY COUNTER CHAIR (2PCS/CTN)

To assemble the chairs, please follow the following steps and repeat for each chair :

## STEP 1

Place the chair back (A) on a soft and clean surface.

Assemble the seat frame (B) with the chair back (A) by using wrench (4) with hardware 1, 2, and 5.

**\*\*Attention: DO NOT TIGHTEN THE BOLTS**

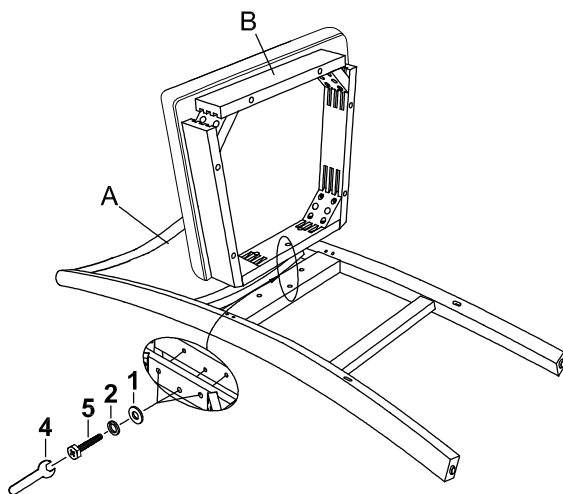

## STEP 2

Assemble the seat frame (B) with the back legs of the chair back (A) by using wrench (4) with hardware 1, 2, and 6.

**\*\*Attention: DO NOT TIGHTEN THE BOLTS**

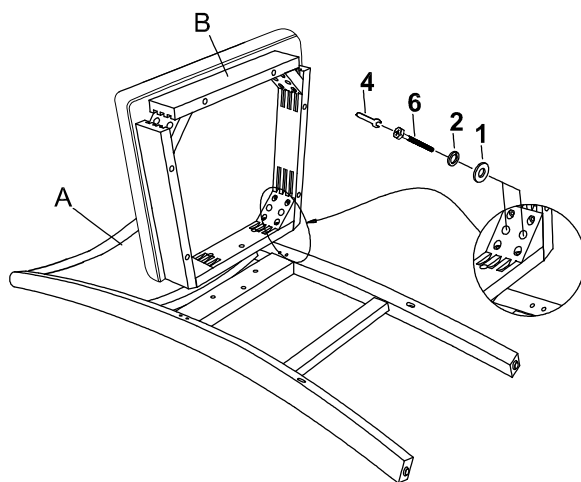

# Assembly Instructions

ITEM NO. D3651-22  
AMY COUNTER CHAIR (2PCS/CTN)

## STEP 3

Assemble the RSF and LSF front legs (C1 and C2) with the seat frame (B) by using wrench (4) with hardware 1,2, and 3.

**\*\*Attention: DO NOT TIGHTEN THE BOLTS**

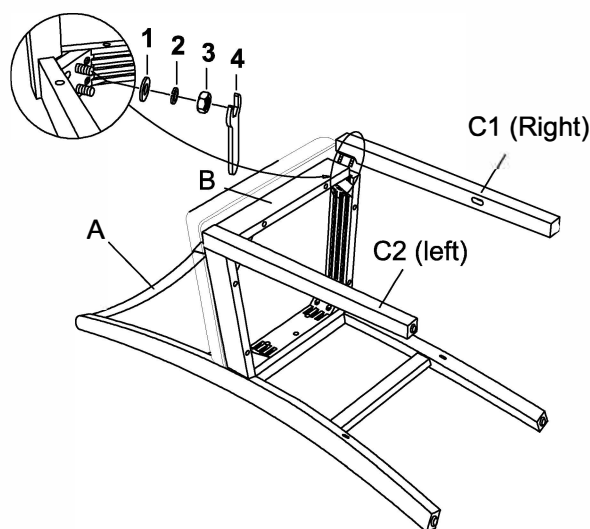

## STEP 4

Install the front stretcher (E) between RSF and LSF front legs (C1 and C2) then the RSF side stretcher (D1) between the chair back (A) and RSF front legs (C1) and the LSF side stretcher (D2) between the chair back (A) LSF front legs (C2). Assemble Install the stretchers by using a screwdriver with hardware 7.

**\*\*Attention: DO NOT TIGHTEN THE BOLTS OR THE SCREWS.**

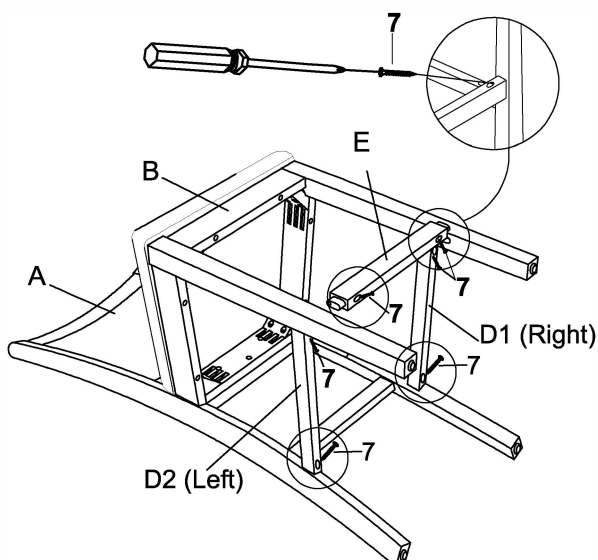

## Assembly Instructions

ITEM NO. D3651-22  
AMY COUNTER CHAIR (2PCS/CTN)

### STEP 5

To level the chair, stand the chair up on a flat surface and tighten all the bolts by using wrench (4) and all the screws with a screwdriver.

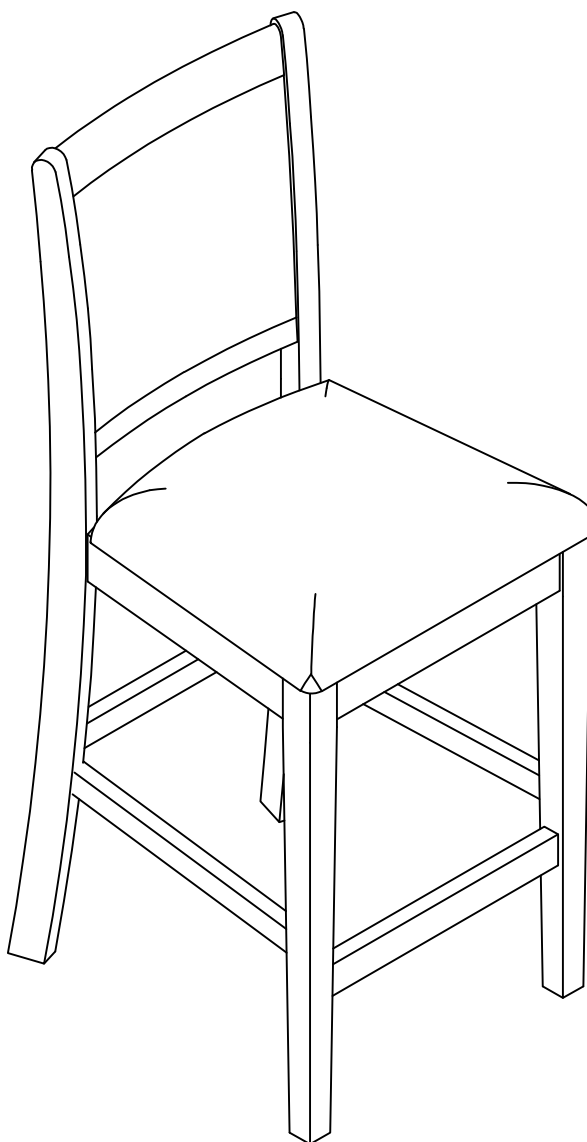

Fully Assembled Chair