

CUSTOM DOOR PANELS SPECIFICATIONS

FOR BUILT-IN REFRIGERATOR MODELS REF30BMBIPLT - REF30BMBIPRT

Panels to be manufactured and fitted by cabinet maker and installer

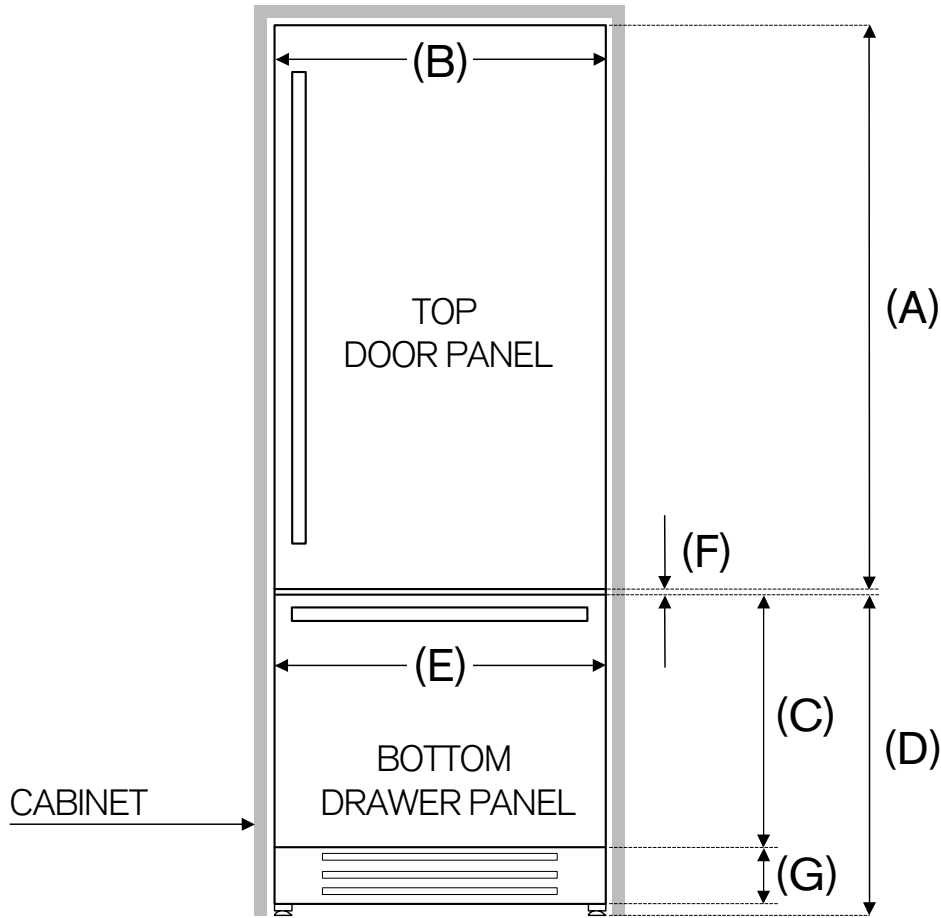

NOTE: These specifications assume a standard toe kick height of 4". For different toe kick heights, adjust C accordingly. C must be between 21 1/2" and 25 3/4".

DIMENSIONS - INCHES		
(A)	Height of top door panel	54 3/4"
(B)	Width of top door panel	29 3/4"
(C)	Height of bottom drawer panel	24 7/8"
(D)	Height from bottom of product to top of bottom drawer panel	28 7/8"
(E)	Width of bottom drawer panel	29 3/4"
(F)	Gap between top door panel and bottom drawer panel	1/8"
(G)	Toe kick height	3 1/8" - 7 3/8"
(A+D)	Overall height	83 5/8"
Thickness of custom panels		min 3/4" - max 1 1/8"

WEIGHT - POUNDS	
Maximum weight of top door panel	51 lbs
Maximum weight of bottom drawer panel	25 lbs

Disclaimer: while every effort has been made to insure the accuracy of the information contained in this document, Fratelli Bertazzoni reserves the right to change any part of the information at any time without notice. For detailed installation specifications consult the installation manual. Fratelli Bertazzoni, Bertazzoni and the winged wheel brand icon are registered trademarks of Bertazzoni Spa.