

PRESRV™

## REFRIGERATOR DRAWERS

SINGLE ZONE



From snacks for the kids to the freshest produce to party-ready food and drinks, these stylish under-counter Single Zone Refrigerator Drawers give you additional cold storage right where you need it. Loaded with features like Quick Chill to instantly lower overall refrigerator tempera-

ture; handy temperature presets; PreciseTemp™ temperature control for maintaining accurate temperatures; Full-Extension, Soft-Close Drawers; and a sleek stainless steel exterior.

# ZEPHYR

ZEPHYRONLINE.COM



Quick Chill preset. Image shown with optional silicone mat accessory.



### How Presrv™ Stands Out:



#### PreciseTemp™

Multiple internal sensors help maintain accurate temperatures and increase overall performance



#### Drawer Organizers

Customizable drawer organizers help keep everything in its place



#### Active Cooling Technology

An on-board computer controls an active cooling fan to provide temperature stability and even cooling



#### Soft-Close Drawers

Close more smoothly and quietly to prevent shifting of drawer contents

**MODEL**

Single Zone

Refrigerator Drawers

PRRD24C1AS

**Size**

24"

**Dimensions**

23-7/8"W x 33-7/8"H x 24"D

**Weight**

137 lbs.

**Installation Type**

Compact / Built-in

**Refrigerant Type**

R600a

**FEATURES****Volume**

5.4 cu/ft

**Temperature Range**

33° - 65° F

**Sound Level**

39 dBA

**Exterior Drawer Finish**304-grade Stainless Steel  
with Contemporary Handles**Interior Drawer Finish**

White

**Exterior Cabinet Finish**

Black

**Interior Cabinet Finish**

Black

**Full-Extension Drawers**

Yes

**Soft-Close Drawers**

Yes

**Drawer Organization**Adjustable Bar Dividers +  
Transparent Drawer Tray**Lighting**3-Color LED Lighting  
Cloud White, Deep Blue, Amber**Controls**

3-Color Electronic Touch

**Preset Temperature Modes**

Produce, Beverage, Wine

**Quick Chill**

Yes, for faster cooldown

**Door Open Alarm**

Yes

**Sabbath Mode**

Yes

**ENERGY STAR® Certified**

Yes

**PreciseTemp™**

Yes

**Active Cooling Technology**

Yes

**AC POWER**

115V, 60Hz at Max. 1.5A

**OPTIONAL ACCESSORIES****Drawer Pan Kit**

DRPAN241S

**Pro Handle\***

50280012

**Silicone Mat, Upper Drawer**

54290001

**Silicone Mat, Lower Drawer**

54290002

**WARRANTY**

2 years parts, 2 years labor

5 years compressor

\*1 handle included, 2 handles required.

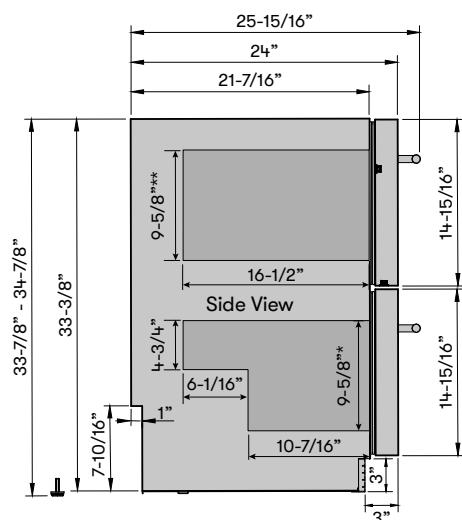
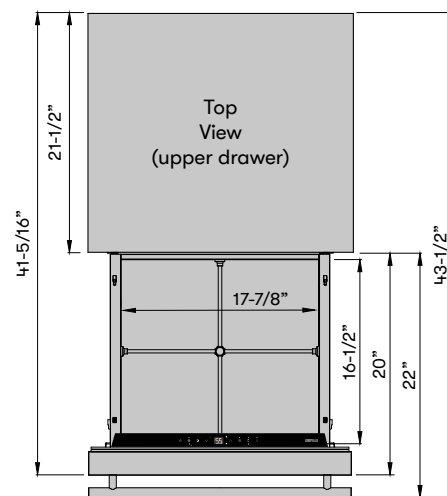

\*Maximum clearance height inside drawers is 12"

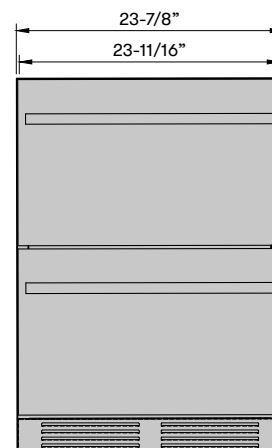
**Transforming the Kitchen through Design, Discovery, and Care**Specifications subject to change, check zephyronline.com for up-to-date information.  
Zephyr | 2277 Harbor Bay Parkway, Alameda, CA 94502 | 888.880.8368

AUG25.0101

