



## QUICK START GUIDE

# SHARP MICROWAVE DRAWER™ OVEN

MODELS: SMD2420MS, SMD2430MS



SMD2420MS

Insight®

For the complete operation information of this oven please visit our website [www.sharpusa.com](http://www.sharpusa.com) or follow the QR code.



SHARP MICROWAVE DRAWER™ OVEN MODELS: SMD2420MS, SMD2430MS

## **PRECAUTIONS TO AVOID POSSIBLE EXPOSURE TO EXCESSIVE MICROWAVE ENERGY**

- (a)** Do not attempt to operate this oven with the door open since open-door operation can result in harmful exposure to microwave energy. It is important not to defeat or tamper with the safety interlocks.
- (b)** Do not place any object between the oven front face and the door or allow soil or cleaner residue to accumulate on sealing surfaces.
- (c)** Do not operate the oven if it is damaged. It is particularly important that the oven door close properly and that there is no damage to the: (1) door (bent), (2) hinges and latches (broken or loosened), (3) door seals and sealing surfaces.
- (d)** The oven should not be adjusted or repaired by anyone except properly qualified service personnel.

# IMPORTANT SAFETY INSTRUCTIONS

**IMPORTANT** Read all instructions carefully before installation and operation. Keep this Operation Manual for future use. Sharp Microwave Drawer™ Oven is manufactured in compliance with the relevant safety standard.

**⚠ WARNING** Failure to follow these warnings could result in a fire or explosion causing property damage, personal injury or death. To reduce the risk of fire, electric shock, exposure to excessive microwave energy or injury, use only as intended and take the following precautions.

## SAFETY PRECAUTIONS

**⚠ WARNING** When using electrical appliances, take safety precautions, including the following:

- 1 Install or locate this unit only in accordance with the provided installation instructions.
- 2 Read all instructions before using Sharp Microwave Drawer™ Oven.
- 3 Read and follow specific PRECAUTIONS TO AVOID POSSIBLE EXPOSURE TO EXCESSIVE MICROWAVE ENERGY on page 2.
- 4 Do not store or use this appliance outdoors or in areas near water, such as near a kitchen sink, in a wet basement, near a swimming pool or similar locations.
- 5 Do not immerse the cord in water. Keep the cord away from heated surfaces.
- 6 To prevent accidents and achieve optimal ventilation, ensure sufficient space around the cooking area.
- 7 **HOT CONTENTS CAN CAUSE SEVERE BURNS. DO NOT ALLOW CHILDREN TO USE THE MICROWAVE OVEN.** Use caution when removing hot items.
- 8 Use the Sharp Microwave Drawer™ Oven only for its intended purpose as described in this manual. This appliance is designed for built-in household use only. Do not use outdoors. Do not use to heat a room. Do not use corrosive chemicals or vapors in this appliance. This appliance is specifically designed to heat, cook or dry food. It is not designed for industrial or laboratory use.
- 9 Do not store or use flammable or combustible materials, gasoline or other flammable vapors and liquids in the vicinity of this appliance.
- 10 Use caution when removing hot items.
- 11 Use only dry potholders. Moist or damp potholders on hot surfaces may cause burns from steam. Do not let potholders touch hot surfaces or radiant surface units. Do not use towels or other bulky cloth.
- 12 Keep fingers and clothes clear of drawer guides when the drawer is opened or closed. Fingers or clothes could be caught in the guides when the drawer is closed.
- 13 Have the installer identify the location of the circuit breaker or fuse. Mark it for easy reference.
- 14 Before performing any service, disconnect the appliance power supply at the household distribution panel by removing the fuse or switching off the circuit breaker.
- 15 Do not repair or replace any part of Sharp Microwave Drawer™ Oven unless specifically recommended in this manual. All other servicing should be referred to a qualified technician.
- 16 Some products in sealed containers, such as whole eggs and closed glass jars, can explode and should not be heated in the Sharp Microwave Drawer™ Oven.
- 17 To reduce risk of fire in the oven cavity, take the following precautions.
  - Do not overcook food. Carefully attend the appliance when paper, plastic or other combustible materials are used to facilitate cooking in the Sharp Microwave Drawer™ Oven.
  - Remove wire twist-ties from paper or plastic bags before placing bag in oven cavity.
  - If materials inside the Sharp Microwave Drawer™ Oven ignite, keep the drawer closed, turn off the appliance and shut off power at the fuse or circuit breaker panel.
  - Do not use Sharp Microwave Drawer™ Oven for storage purposes. Do not leave paper products, cooking utensils or food in the oven cavity when not in use.
- 18 Food and containers must be shorter in height than the drawer. Refer to the height of the side walls of the drawer.
- 19 Use only mild, nonabrasive soaps or detergents applied with a sponge or soft cloth when cleaning the sealing surfaces that come together on closing the drawer.
- 20 Liquids, such as water, coffee or tea, can be overheated beyond the boiling point without appearing to boil, due to surface tension of the liquid. Visible bubbling or boiling when the container is removed from the Sharp Microwave Drawer™ Oven is not always present. This could result in **VERY HOT LIQUIDS** suddenly boiling over when a spoon or other utensil is inserted into the liquid.

To reduce the risk of injury to persons when heating liquids:

  - Do not overheat liquids.
  - Stir liquids both before and halfway through heating.
  - Do not use straight-sided containers with narrow necks. Use wide-mouthed containers.
  - After heating allow the container to stand in the Sharp Microwave Drawer™ Oven for at least 20 seconds before removing.
  - Use extreme care when inserting a spoon or other utensil into liquids after heating.
- 21 If the Sharp Microwave Drawer™ Oven light fails, consult a Sharp Authorized Servicer. Only qualified service personnel should service Sharp Microwave Drawer™ Oven. Contact 1-800-BE-SHARP for the nearest Sharp Authorized Servicer for evaluation, repair and/or adjustment.

## SAVE THESE INSTRUCTIONS

# QUICK START GUIDE

For more complete operation information and safety precautions, please refer to the operation manual located on our website at [www.sharppusa.com](http://www.sharppusa.com) or follow QR code.



## TIME COOKING

### HIGH POWER COOKING

- 1 Touch **number** pads to enter cooking time.
- 2 Touch **START/+30 SEC** pad for 100% power. The timer on the display counts down.

### VARIABLE POWER COOKING

- 1 Touch number pads to enter time.
- 2 Touch **Power Level** pad repeatedly to select power level.
- 3 Touch **START/+30 SEC** pad.

## SENSOR COOK

- 1 Touch **Cook** pad.
- 2 Touch a **number** pad to select food item.
- 3 Touch **START/+30 SEC** pad.
- 4 Once cooking is complete, instructions such as *STIR LET STAND COVERED* appear on the screen, depending on the food item.

## DEFROST

The Defrost feature uses lower power level to gently defrost foods shown on the menu label.

- 1 Touch **Defrost** pad.
- 2 Touch **number** pads to select food item.
- 3 Touch **number** pads to enter weight.
- 4 Touch **START/+30 SEC** pad.
- 5 The oven will pause so the food can be checked. Open the Sharp Microwave Drawer™ Oven and follow instructions on the display.
- 6 Touch **START/+30 SEC** pad.
- 7 After each audible signal, turn the food over and touch **START/+30 SEC** pad again.

## BEVERAGE

Use the Beverage feature to reheat coffee or tea to a suitable drinking temperature or make instant coffee, tea or hot cereal.

- 1 Touch **Beverage** pad
- 2 Touch a **number** pad to select food item.
- 3 Touch the same **number** pad repeatedly to increase quantity.
- 4 Touch **START/+30 SEC** pad.

NOTE: After heating, stir beverage again.

## MORE MENUS

### MELT/SOFTEN/WARM

- 1 Touch **More menus** pad.
- 2 Touch a **number** pad to select food item.
- 3 Repeat touching the same **number** pad to select quantity.
- 4 Touch **START/+30 SEC** pad.

### ROLLS/MUFFINS

The Rolls/Muffins feature can be used to warm rolls, muffins, biscuits or bagels from room temperature, refrigerated or frozen.

- 1 Arrange rolls on a plate and cover with a paper towel.
- 2 Touch **More Menus** pad.
- 3 Touch a **number** pad to select food item.
- 4 Touch **number** pads to enter quantity.
- 5 Touch **START/+30 SEC**.

### KEEP WARM

Use the Keep Warm feature to keep food warm for up to 30 minutes. The feature can be used directly or in sequence with timed cooking.

### DIRECT USE

- 1 Touch **More Menus** pad.
- 2 Touch **9** to select Keep Warm.
- 3 Touch **number** pads to enter desired warming time in minutes and seconds. To warm for 30 minutes, touch **3-0-0-0**.
- 4 Touch **START/+30 SEC**. The oven will start, and the display will show the timer counting down with **KEEP WARM** appearing intermittently.

### KEEP WARM AFTER TIMED COOK

- 1 Touch **number** pads to enter cook time in minutes and seconds.
- 2 If necessary, set the power level by touching **Power Level** pad repeatedly until the correct level is displayed.
- 3 Touch **More Menus** pad.
- 4 Touch **9** to select Keep Warm.
- 5 Touch **number** pads to enter desired warming time in minutes and seconds.
- 6 Touch **START/+30 SEC** pad. The timed cooking will start. When cooking is complete, a long tone will sound and the Keep Warm feature will start. The display will show the timer counting down with **KEEP WARM** appearing intermittently during count down.

## CONTROL LOCK

The Control Lock prevents unwanted drawer operation such as by small children. The Sharp Microwave Drawer™ Oven can be set so the control panel and the automatic door mechanism are deactivated or locked.

### TO LOCK

Touch and hold  pad for 3 seconds.

### TO UNLOCK

Touch and hold  pad for 3 seconds.

## HELP/SETTINGS

Check operation manual for specific details.

Touch **Help/Settings** pad:

- 4 times for Auto Start. Then touch **START/+30 SEC** pad.
- 5 times for Demo Mode. Then touch **START/+30 SEC** pad.
- 8 times for Sound On/Off. Then touch **START/+30 SEC** pad.
- 9 times for End of Cooking Reminder On/Off. Then touch **START/+30 SEC** pad.

## SET THE CLOCK

- 1 Touch **Timer/Clock** pad.
- 2 Touch **2** pad to set clock.
- 3 Use **number** pads to enter time of day.
- 4 Touch **Timer/Clock** pad to accept entered time of day.

## TIMER

To set the timer:

- 1 Touch **Timer/Clock** pad.
- 2 Touch **1** pad to set the timer.
- 3 Use **number** pads to enter time. The time counts down.
- 4 Touch **STOP/CLEAR** pad to cancel the timer. An audible signal will sound when the countdown completes.

## REGISTER YOUR PRODUCT

Registering your new product is easy and offers benefits that help you get the most out of your Sharp product including:

- ✓ **Convenience:** If you ever need warranty support, your product information is already on file.
- ✓ **Communication:** Stay up to date with important notifications and special offers from SHARP.
- ✓ **Support:** Quickly access support content including Owner's Manuals, FAQ's, How-to Videos, and much more.

## 3 EASY WAYS TO REGISTER TODAY!

 <p><b>SCAN</b> Use the camera or QR code scanning application on your mobile device</p>	 <p><b>ONLINE</b> Visit our sites to learn more about your product at <a href="http://sharpusa.com">sharpusa.com</a> and <a href="http://sbl.sharpusa.com">sbl.sharpusa.com</a></p>	 <p><b>CALL US</b> US <b>800-BE-SHARP</b> 800-237-4277</p>
Scan this QR Code on your mobile device	Visit <a href="http://www.sharpusa.com/register">http://www.sharpusa.com/register</a>	Contact a Sharp Advisor on the phone

## PRODUCT SUPPORT

If you have questions about the setup or operation of your product, please refer to the corresponding section within this manual.

Additionally, visit <https://support.sharpusa.com/s/> to access exclusive content about your product including:

- FAQ's and How-To Videos
- Find or Request Service
- Extended Warranty Options
- Downloads including the Installation Guide, Spec Sheet, and Owner's Manual

## CONTACT US

If at any time you have questions or comments concerning your SHARP product, please contact the SHARP Customer Assistance Center. We are available to assist you through multiple contact methods for your convenience:

 <p><b>EMAIL</b> Available 24/7 US: <a href="mailto:sharpusa.com">sharpusa.com</a></p>	 <p><b>CHAT ONLINE</b></p>	 <p><b>CALL US</b> US <b>800-BE-SHARP</b> 800-237-4277</p>
See the Contact Us section on our sites	U.S.   <a href="https://support.sharpusa.com/s/">https://support.sharpusa.com/s/</a>	Contact a Sharp Advisor on the phone

# SHARP®

## CONSUMER LIMITED WARRANTY

SHARP ELECTRONICS CORPORATION ("Sharp") warrants to the first consumer purchaser that this Sharp brand product (the "Product"), when shipped in its original container, will be free from defective workmanship and materials, and agrees that it will, at its option, either repair the defect or replace the defective Product or part thereof with a new or remanufactured equivalent at no charge to the purchaser for parts or labor for the period(s) set forth below.

This warranty does not apply to any cosmetic or appearance items of the Product nor to the additional excluded item(s) set forth below nor to any Product the exterior of which has been damaged or defaced, which has been subjected to misuse, abnormal service, or handling, or which has been altered or modified in design or construction. In order to enforce the rights under this limited warranty, the purchaser should follow the steps set forth below and provide proof of purchase to the servicer.

The limited warranty described herein is in addition to whatever implied warranties may be granted to purchasers by law. ALL IMPLIED WARRANTIES INCLUDING THE WARRANTIES OF MERCHANTABILITY AND FITNESS FOR USE ARE LIMITED TO THE PERIOD(S) FROM THE DATE OF PURCHASE SET FORTH BELOW. Some states do not allow limitations on how long an implied warranty lasts, so the above limitation may not apply to you.

Neither the sales personnel of the seller nor any other person is authorized to make any warranties other than those described herein, or to extend the duration of any warranties beyond the time period described above on behalf of Sharp. The warranties described herein should be the sole and exclusive warranties granted by Sharp and should be the sole and exclusive remedy available to the purchaser. Correction of defects, in the manner and for the period of time described herein, should constitute complete fulfillment of all liabilities and responsibilities of Sharp to the purchaser with respect to the Product, and should constitute full satisfaction of all claims, whether based on contract, negligence, strict liability or otherwise. In no event should Sharp be liable, or in any way responsible, for any damages or defects in the Product which were caused by repairs or attempted repairs performed by anyone other than a Sharp authorized servicer. Nor should Sharp be liable or in any way responsible for any incidental or consequential economic or property damage. Some states do not allow the exclusion of incidental or consequential damages, so the above exclusion may not apply to you.

THIS LIMITED WARRANTY IS VALID ONLY IN THE FIFTY (50) UNITED STATES, THE DISTRICT OF COLUMBIA AND PUERTO RICO.

**Product model number & description:**

SMD2420MS or SMD2430MS Home Use Microwave Drawer™ Oven (Be sure to have this information available when you need service for your product.)

**Warranty period for this product:**

One (1) year parts and labor, including in-home service.  
Product must be accessible to provide service.  
The warranty period continues for an additional four (4) years, for a total of five (5) years, with respect to the magnetron tube in the Product for parts only; labor and service are not provided free of charge for this additional period.

**Additional item(s) excluded from warranty coverage:**

Commercial, non-residential, or use inconsistent with published installation and product operational instructions.  
Non-functional accessories, light bulb, service calls to your home to instruct how to use your microwave oven appliance, replace or repair house fuses or to correct house wiring, improper commercial use, installation, or maintenance, damage to the product caused by delivery, accident, modifications, fire, floods or acts of God.

**What to do to obtain service:**

In-home service is provided for one (1) year from date of purchase. Service can be arranged by calling 1-800-BE-SHARP. Be sure to have Proof of Purchase, Model, and Serial Number available.

TO OBTAIN SUPPLY, ACCESSORY OR PRODUCT INFORMATION, CALL 1-800-BE-SHARP or visit [www.sharppusa.com](http://www.sharppusa.com).  
SAVE THE PROOF OF PURCHASE AS IT IS NEEDED SHOULD YOUR OVEN EVER REQUIRE WARRANTY SERVICE.

# **SHARP®**

**SHARP ELECTRONICS CORPORATION**

100 Paragon Drive • Montvale, New Jersey 07645

1-800-BE-SHARP (237-4277)



## Sharp Microwave Drawer™ Oven: SMD2420MS, SMD2430MS INSTALLATION MANUAL

### SPECIAL WARNING

Installation and service must be performed by a qualified installer.

**IMPORTANT:** Save this installation manual for local electrical inspector's use and future reference.

### CLEARANCES AND DIMENSIONS

Do not install this appliance in any combustible cabinetry, which is not in accord with the stated clearances and dimensions on pages 2–5. See Figures 1–7.

### SAFELY LIFT AND MOVE UNIT

Two people are required to safely lift and move this unit.

### UNPACKING THE APPLIANCE

- Remove all packing materials from inside the Sharp Microwave Drawer™ Oven. **DO NOT REMOVE THE WAVEGUIDE COVER**, which is located on the top of the Sharp Microwave Drawer™ Oven.

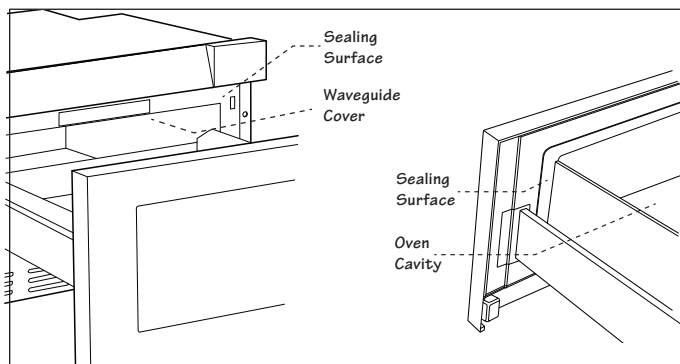

- Remove the protective film from the touch control area. Additionally, remove the feature sticker, if there is one. Check the drawer for any damage, such as misaligned or bent drawer, damaged drawer seals and sealing surfaces, broken or loose drawer guides and dents inside the cavity or on the front side of the drawer. If there is any damage, do not operate the Sharp Microwave Drawer™ Oven and contact your dealer or a Sharp authorized servicer.

### IMPORTANT NOTES TO THE INSTALLER

- Read the entire Installation Manual before installing the Sharp Microwave Drawer™ Oven.
- Remove all packing material before connecting the electrical supply. Manually pull open the drawer to ensure all packing material is removed prior to connection and installation.
- Observe all governing codes and ordinances.
- Leave these instructions with the consumer.

### IMPORTANT NOTES TO THE CONSUMER

Keep this manual with your Operation Manual for future reference.

- Read and follow the safety precautions listed in the operation manual.
- Ensure your Sharp Microwave Drawer™ Oven is installed and grounded properly by a qualified installer or service technician.

### IMPORTANT SAFETY INSTRUCTIONS

**⚠ WARNING** If the information in this manual is not followed exactly, a fire or electrical shock may result that could cause property damage, personal injury or death.

**⚠ WARNING** To reduce the risk of tipping, the Sharp Microwave Drawer™ Oven must be secured by a properly installed Anti-Tip block.

- This appliance must be electrically grounded in accordance with local codes.
- Ensure the wall coverings and the cabinets around the appliance can withstand the heat generated by the Sharp Microwave Drawer™ Oven.

**⚠ WARNING** Never leave children alone or unattended in the area where the Sharp Microwave Drawer™ Oven is in use. Never leave the drawer open when the appliance is unattended.

**⚠ WARNING** Stepping, leaning or sitting on the drawer may result in serious injuries and can also cause damage to the Sharp Microwave Drawer™ Oven.

- Do not use the Sharp Microwave Drawer™ Oven as a storage space, as this creates a potentially hazardous situation.
- Check that the time-of-day is in the display. If not, touch **STOP/CLEAR** for safety reasons and to prevent unintended use.

## CLEARANCES AND DIMENSIONS

- Dimensions shown in Figure 1 must be used. Given dimensions provide minimum clearance. Locate electrical outlet in the shaded area in the upper left-hand corner of the cutout. See Figure 9.
- Contact surface must be solid and level. Pay special attention to the floor on which the Sharp Microwave Drawer™ Oven will sit. The floor of the opening should be constructed of plywood strong enough to support the weight of the oven (about 100 pounds).
- Check location where the Sharp Microwave Drawer™ Oven will be installed for proper electrical supply.
- If installing below a wall oven, ensure the clearance of the floor between the wall oven and the Sharp Microwave Drawer™ Oven is a minimum of 2".
- The oven can also be mounted flush. See page 4 for flush mounting instructions.

- Your oven can be built into a cabinet or wall as a stand-alone unit. It can be installed under gas or electric wall ovens and the Sharp Combi Steam Oven/Wall Oven Models ovens or under the Sharp cooktops listed below.

COMBI STEAM OVEN/ WALL OVEN MODELS	COOKTOP MODELS
<ul style="list-style-type: none"> <li>• SSC3088AS</li> <li>• SSC2489DS</li> <li>• SSC2489GS</li> <li>• SWA2450GS</li> <li>• SWA3099MS</li> </ul>	<ul style="list-style-type: none"> <li>• SDH3042DB</li> <li>• SDH3652DB</li> <li>• SCH3043GB</li> <li>• SCH2443GB</li> <li>• SCR3042FB</li> <li>• SCR2442FB</li> </ul>

## 24" MICROWAVE DRAWER™ STANDARD MOUNT AND MEASUREMENTS

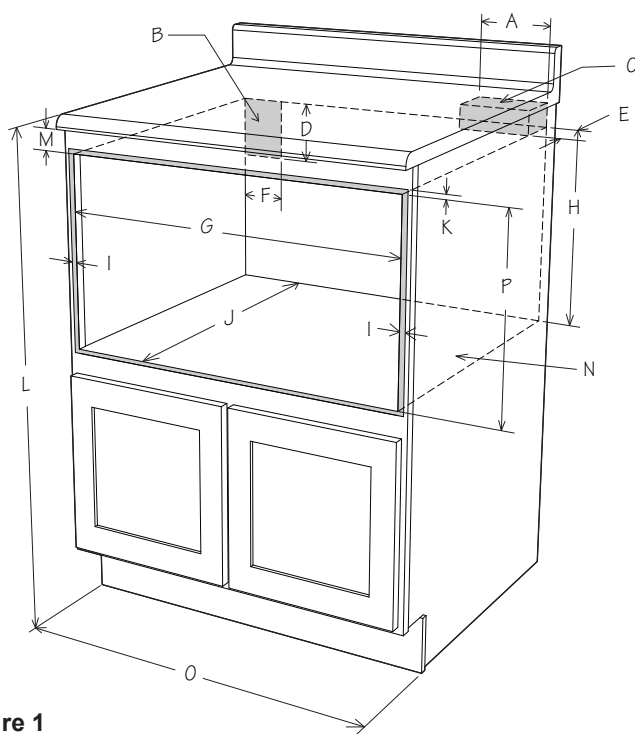

Figure 1

- A. 6"
- B. Suggested electrical outlet location\*
- C. Anti-Tip block
- D. 5"
- E. 3 1/2"
- F. 4"
- G. 22 1/8" opening
- H. 14 13/16" to bottom of Anti-Tip block
- I. Allow 7/8" overlap
- J. 23 1/2" minimum depth
- K. Allow 1/4" overlap
- L. 36" countertop height
- M. Allow 1/4" minimum space
- N. Floor must support 100 lb
- O. 24" cabinet minimum
- P. 14 13/16" opening

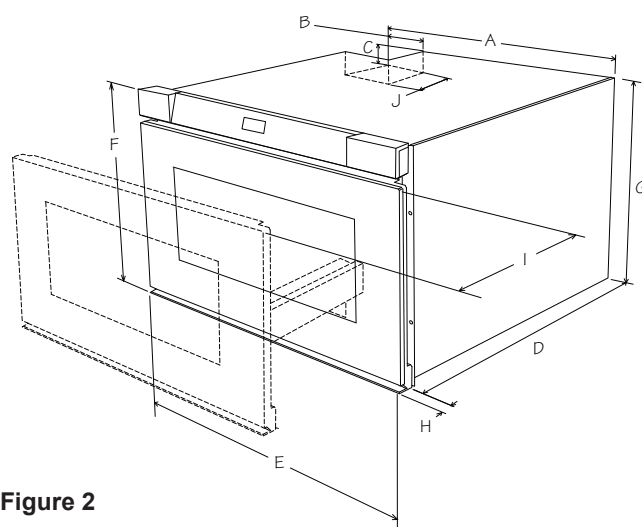

Figure 2

- A. 21 5/8"
- B. 4 11/16"
- C. 1 3/4"
- D. 21 7/8"
- E. 23 5/8"
- F. 15 1/16"
- G. 14 5/8"
- H. 1 9/16" door thickness
- I. 15" auto drawer opening
- J. 4"

Figures 1 and 2 contain many measurements for reference when planning the Sharp Microwave Drawer™ Oven location.

\* Can also be installed using an electrical outlet in an adjacent cabinet within the area where the provided electrical cord can reach. Power cord access hole in cabinet should be a minimum 1 1/2" diameter hole and deburred of all sharp edges.

**IMPORTANT** Always allow sufficient power cord length to the electrical outlet to prevent tension.

Always check electrical codes for requirements.

Figure 3 represents a typical standard cabinet. If installed in custom cabinets with extended countertops, take into account visibility and access to controls. See Figure 4.

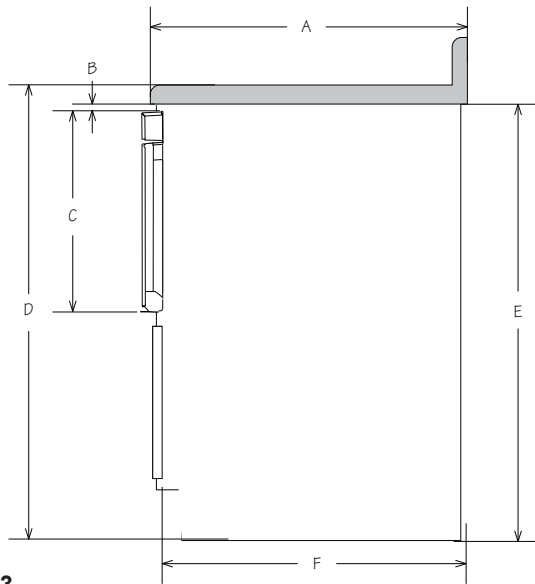

**Figure 3**

- |                 |            |
|-----------------|------------|
| A. 25"          | D. 36"     |
| B. 1/2" minimum | E. 34 1/2" |
| C. 15 1/16"     | F. 24"     |

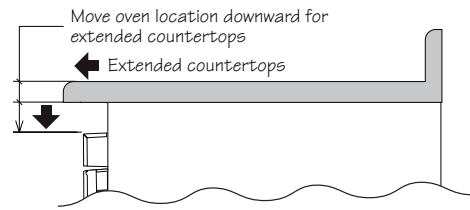

**Figure 4**

# 24" MICROWAVE DRAWER™ FLUSH MOUNT AND MEASUREMENTS

Prepare cabinet opening as shown in Figures 5, 6, 7

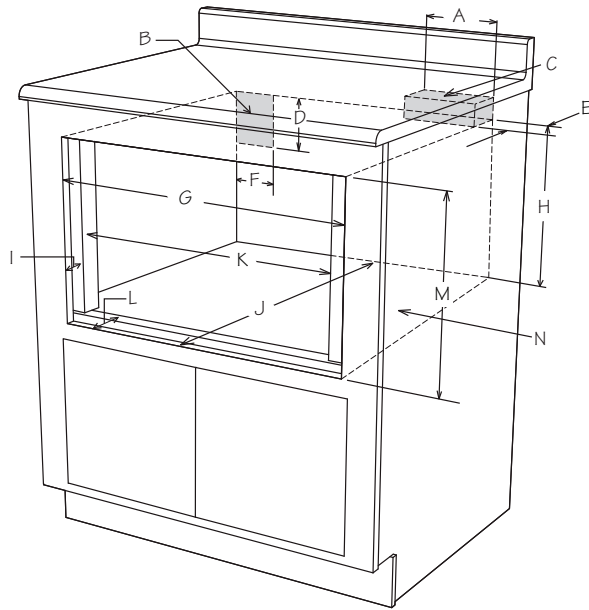

Figure 5

- A. 6"
- B. Suggested electrical outlet location
- C. Anti-Tip block
- D. 5"
- E. 3 1/2"
- F. 4"
- G. 23 7/8"
- H. 14 13/16" to bottom of Anti-Tip block
- I. 1 9/16"
- J. 23 1/2" minimum depth
- K. 22 1/8"
- L. 1 9/16" to front of shelf
- M. 15 5/16" opening
- N. Floor must support 100 lb

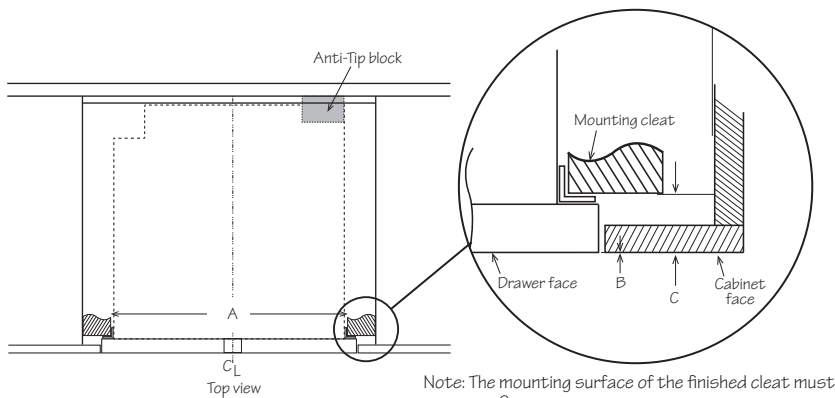

Figure 6

- A. 22 1/8" mounting cleat opening width
- B. 0" flush
- C. 1 9/16" front of cleat to cabinet face

Note: The mounting surface of the finished cleat must sit 1 9/16" back from the face of the cabinet.

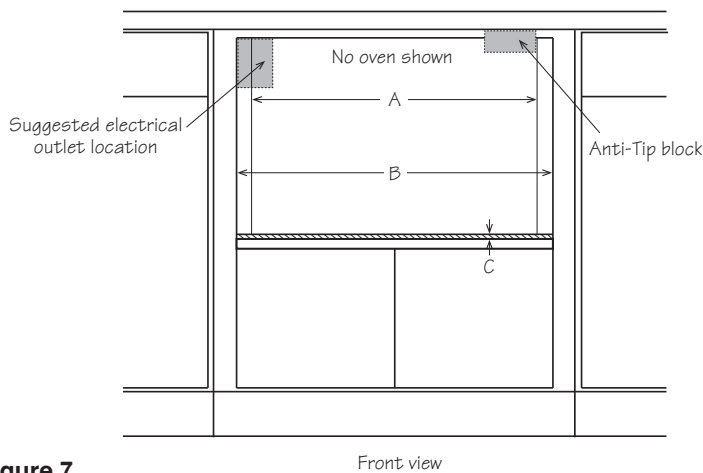

Figure 7

- A. 22 1/8" mounting cleat opening width
- B. 23 7/8" flush opening width
- C. 1/8" from opening to top of shelf

## ANTI-TIP BLOCK

### NORMAL INSTALLATION STEPS

#### ANTI-TIP BLOCK INSTALLATION INSTRUCTIONS

To reduce the risk of tipping of the drawer, the Anti-Tip block must be properly installed located  $14\frac{13}{16}$ " above the floor on which the Sharp Microwave Drawer™ Oven will sit. The 6" Anti-Tip block must be provided by the installer. See Figure 1. The Anti-Tip block prevents serious injury that might result from spilled hot liquids.

If the Sharp Microwave Drawer™ Oven is ever moved to a different location, the Anti-Tip block must also be moved and installed. When installed to the wall, ensure the screws completely penetrate the drywall and are secured in wood or metal so the block is totally stable. When fastening, ensure the screws do not penetrate electrical wiring or plumbing.

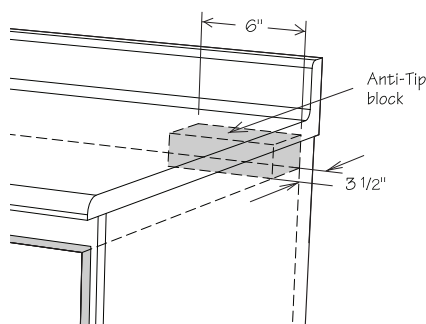

Figure 8

## ELECTRICAL OUTLET

The electrical requirements are a 120 volt 60 Hz, AC only, 15 amp. or more protected electrical supply. It is recommended that a separate circuit serving only this appliance be provided.

The drawer is equipped with a 3-prong grounding plug. It must be plugged into a properly installed and grounded wall receptacle. Should you only have a 2-prong outlet, have a qualified electrician install a correct wall receptacle.

**Note:** If you have any questions about the grounding or electrical instructions, consult a qualified electrician or servicetperson.

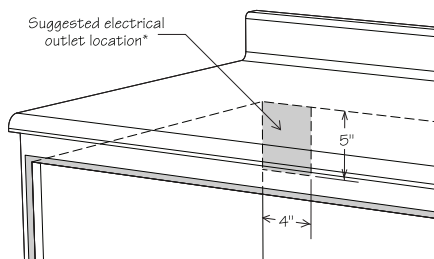

Figure 9

\* Can also be installed using an electrical outlet in an adjacent cabinet within the area where the provided electrical cord can reach.

Always check electrical codes for requirements.

## GROUNDING INSTRUCTIONS

This appliance must be grounded. The Sharp Microwave Drawer™ Oven is equipped with a cord having a grounding wire with a grounding plug. It must be plugged into a properly installed and grounded wall receptacle in accordance with the National Electrical Code and local codes and ordinances. In the event of an electrical short circuit, grounding reduces risk of electric shock by providing an escape wire for the electric current.

**WARNING** Improper use of the grounding plug can result in a risk of electric shock. **Do not use an extension cord. If the power supply cord is too short, have a qualified electrician or serviceman install an outlet near the appliance.**

#### Permanent and Correct Installation

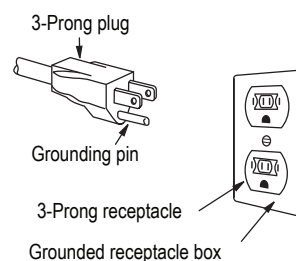

## DRAWER INSTALLATION

1. Place the drawer adjacent to the wall or cabinet opening. Plug the power supply cord into the electrical outlet.
2. Carefully guide the drawer into the prepared opening. Avoid pinching the cord between the oven and the wall.
3. Slide the drawer all the way until the mounting flange is flush with the face of the cabinet. See Figure 10.
4. Open the drawer. Using the 4 holes on the drawer as a template, pre-drill the cabinet using a  $\frac{1}{16}$ " bit. See Figure 10.
5. Secure the drawer with the 4 screws supplied. See Figure 11.

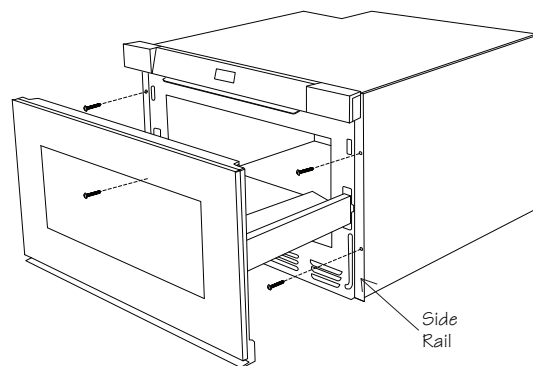

Figure 10

Parts supplied - 4 Screws

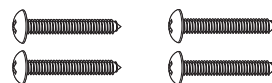

Figure 11

## MODEL AND SERIAL NUMBER LOCATION

The nameplate includes model and serial number. Open the Sharp Microwave Drawer™ Oven fully. The label is beyond the back wall of the microwave cavity facing up from the flat surface.

## CARE, CLEANING AND MAINTENANCE

Refer to the Operation Manual for cleaning instructions.

## ACCESSORIES

### UNDER THE COUNTER MICROWAVE DRAWER™ PEDESTAL SKMD24U0ES

Complete the installation with a two-drawer installation pedestal that comes with sleek, stainless-steel drawer fronts. For a unified look, the pedestal accepts custom front drawer panels. The pedestal is installed in three easy steps into a 24" wide opening under the counter and has flexible mounting depths available, including flush.

## BEFORE YOU CALL FOR SERVICE

Read the BEFORE YOU CALL and operating instruction sections in your Operation Manual. It may save you time and expense. The list includes common occurrences that are not the result of defective workmanship or materials in this microwave.

Please call or write if you have inquiries about your Sharp Microwave Drawer™ Oven and/or need to order parts.

## CONTACT US

If at any time you have questions or comments concerning your SHARP product, please contact the SHARP Customer Assistance Center. We are available to assist you through multiple contact methods for your convenience:



### EMAIL

Available 24/7  
US: [sharpusa.com](mailto:sharpusa.com)



### CHAT ONLINE



### CALL US

US 800-BE-SHARP  
800-237-4277

See the Contact Us section on our sites

U.S. | <https://support.sharpusa.com/s/>

Contact a Sharp Advisor on the phone





100 Paragon Drive, Montvale, NJ 07645, USA • 1-800-BE-SHARP (237-4277)