



OWNER'S MANUAL

DUST EMPTYING CHARGING STATION

Read this owner's manual thoroughly before operating the appliance and keep it handy for reference at all times.

ENGLISH

VDS-RB4**



MFL71780934
Rev.00_081623

www.lg.com

Copyright © 2023 LG Electronics Inc. All Rights Reserved.

TABLE OF CONTENTS

3 IMPORTANT SAFETY INSTRUCTIONS

- 3 READ ALL INSTRUCTIONS BEFORE USE
- 3 WARNING STATEMENTS
- 6 CAUTION STATEMENTS

8 INSTALLATION

- 8 Product Overview
- 11 Installing the Charging Station

12 OPERATION

- 12 Getting Started

15 MAINTENANCE

- 15 Cleaning the Appliance

19 TROUBLESHOOTING

- 19 Before Calling for Service

IMPORTANT SAFETY INSTRUCTIONS

READ ALL INSTRUCTIONS BEFORE USE

The following safety guidelines are intended to prevent unforeseen risks or damage from unsafe or incorrect operation of the appliance. The guidelines are separated into 'WARNING' and 'CAUTION' as described below.

Safety Messages

Your safety and the safety of others are very important.

We have provided many important safety messages in this manual and on your appliance. Always read and follow all safety messages.



This is the safety alert symbol.

This symbol alerts you to potential hazards that can kill or injure you and others. All safety messages will follow the safety alert symbol and either the word WARNING or CAUTION.

These words mean:



WARNING

You may be killed or seriously injured if you do not follow instructions.



CAUTION

You may be injured or cause damage to the product if you do not follow instructions.

All safety messages will tell you what the potential hazard is, tell you how to reduce the chance of injury, and tell you what may happen if the instructions are not followed.

WARNING STATEMENTS



WARNING

- To reduce the risk of explosion, fire, death, electric shock, injury or scalding to persons when using this product, follow basic precautions, including the following:

Technical Safety

- Read all safety warnings and instructions. Use only manufacturer's recommended attachments.
- Do not use an appliance with a damaged power cord or plug. The power cord or plug must be replaced. If the appliance is not working as it should, has been dropped, damaged, left outdoors, or dropped into water, return it to an LG Electronics service center.
- Do not pull or carry by the cord, use the cord as a handle, close a door on the cord, or pull the cord around sharp edges or corners. Do not run the appliance over the cord. Keep the cord away from heated surfaces.
- Do not unplug by pulling on the cord. To unplug, grasp the plug, not the cord.
- Place the cords from other appliances out of the area to be cleaned.
- This appliance is intended to be used in a household only. To avoid risk of electric shock, use indoors on a dry floor only.
- This appliance is not intended for use by persons (including children) with reduced physical, sensory or mental capabilities, or lack of experience and knowledge, unless they have been given supervision or instruction concerning use of the appliance by a person responsible for their safety. Children should be supervised to ensure that they do not play with the appliance.

4 IMPORTANT SAFETY INSTRUCTIONS

- Have servicing performed by a qualified repair person using only identical replacement parts. This will ensure that the safety of the product is maintained.
- Do not allow the appliance to be used as a toy. Close attention is necessary when used by or near children.
- Do not operate the appliance in a room where an infant or child is sleeping.
- Before using this appliance, clear the floor of objects such as candles, power cords, fragile objects, clothing, loose papers, and pull cords for blinds or curtains.

Installation

- Charge, store and operate this appliance in room temperature environments only.
- Place the charging station on a firm, level surface.
- Charge and store the appliance in a well-ventilated place.
- Do not store the product body, power cord or home station near heating devices or open flames.
- Do not operate or store the appliance at temperatures below 41 °F (5 °C) or above 100 °F (38 °C).
- This appliance is designed to be plugged into a standard outlet only. The appliance may not be used with any type of power converter.
- Do not plug the appliance into a damaged or loose outlet.
- Dispose of all packaging materials (such as plastic bags and styrofoam) away from children. The packaging materials can cause suffocation.
- Certain internal parts are intentionally not grounded and may present a risk of electric shock only during servicing, Service personnel - Do not contact the following parts while the appliance is energized: pump, valve, motor, control board.

Battery

- Never use the battery, adapter, and the home station from other appliances with this appliance. Use only the battery and the home station provided by LG Electronics.
- Never use the battery, adapter, and the home station from this appliance with other appliances.
- Keep the remote controller batteries out of the reach of children. Swallowing the batteries can lead to chemical burns, perforation of soft tissue, and death. Seek medical attention immediately. Severe burns can occur within 2 hours of swallowing.
- Unplug the power cord and remove the battery if the appliance will not be used for an extended period of time.
- Do not use the battery if it is leaking or has changed shape. If battery fluid comes into contact with skin or eyes, thoroughly wash the affected area immediately with clean water and seek medical attention.
- Do not use modified or damaged batteries.
- Do not disassemble or short-circuit the battery. Do not crush or dismantle the battery.
- When disposing of the battery or the appliance, remove the battery from the appliance and safely dispose of it.
- Do not heat or place the battery near any heat source or direct sunlight. Do not subject the battery to mechanical shock.
- Have the battery replaced when it is no longer able to hold a charge. For replacement, contact an authorized LG Electronics service center for alternative battery options.
- When disposing of this appliance, follow regulations for disposal of rechargeable lithium-ion batteries.
- Follow all local ordinances and regulations when handling or disposing of the battery.
- For your safety, do not remove the battery from the appliance. If you need to replace the battery of the appliance, take it to an authorized LG Electronics service center or dealer for assistance.

- Do not modify or attempt to repair the appliance or the battery pack (as applicable) except as indicated in the instructions for use and care.

Operation

- This appliance is exclusively for use with the LG Electronics Robot Cleaner. Do not use it for other appliances or other purposes.
- Use only as described in this manual. Use only manufacturer's recommended attachment.
- This appliance is designed for normal indoor domestic use only. It is not to be used for any non-residential, commercial, or industrial application.
- Do not use or store the appliance in any outdoor location, garage environment or on wet surfaces.
- This appliance is equipped with a double insulated power cord. The power plug must be plugged into an appropriate outlet that is installed in accordance with all local codes and ordinances.
- Do not handle the power cord, plug, or appliance controls with wet hands.
- Wipe any moisture or dirt off the cord or plug with a dry cloth.
- Unplug the power cord using the plug, not the cord. Pulling on the cord can damage it and result in electric shock or fire.
- Never attempt to operate this appliance if it is damaged, malfunctioning, partially disassembled, or has missing or broken parts, including a damaged cord or plug. Take it to an authorized LG Electronics service center or dealer for assistance.
- Do not apply excessive force to the power cord to bend it, or place it under a heavy object, as this will damage it.
- Do not use multiple-outlet adapters with this appliance. Make sure to use a power socket with a capacity of 10 A.
- Do not plug the appliance into a damaged or loose outlet.
- Make sure to unplug the power cord when the appliance is not to be used for an extended period of time.
- Do not damage, alter, excessively bend, twist, pull, pinch or heat the power cord.
- Before using the appliance, remove any wire or string on the floor.
- Avoid touching the prongs of the power plug with your finger(s) when unplugging the power cord.
- Do not cover the power cord with a rug or carpeting.
- Push the power plug firmly into the wall outlet so that it is not loose.
- If the product has been submerged, contact an LG Electronics service centre or dealer for instructions before resuming use.
- If the product makes a strange noise or emits an odor or smoke, discontinue use and contact an LG Electronics customer information center.
- Only qualified technicians or service personnel from LG Electronics may disassemble, repair or modify the appliance.
- Never insert a sharp metal object such as a pin, nail or knife in a hole or gap in the appliance or the charging station.
- Make sure that no water, beverage or detergent gets inside the appliance or the charging station.
- Do not allow children to use the appliance.
- Do not let children or pets get close to the appliance when using, charging or storing.
- Keep clothing and hair, fingers, or other parts of the body away from openings and moving parts.
- Do not use in an enclosed space where vapors are present from paint thinner, mothproofing substances, flammable dust or other explosive or toxic materials.
- Make sure that the filter is installed before use.

6 IMPORTANT SAFETY INSTRUCTIONS

- Do not touch the charging terminals on the appliance or the charging station, or insert an electrified object inside the appliance or the station.
- Do not lean the appliance on walls, chairs or tables.
- If the earth leakage breaker is tripped when the product is put on the charging station, immediately remove the appliance from the charging station. Contact an LG Electronics customer service center.
- Do not use or store a heating device or flammable substance (ether, benzene, alcohol, chemicals, combustible sprays, insecticide, air freshener or cosmetics) in close proximity to the appliance.
- Do not attempt to clean up a liquid substance (water, beverage), odorous substances (candy, chocolate, pet excrement), metal objects (blades, pins), flammable substances, surfactants, or glass shards with this appliance.
- In the event of a gas leak (natural gas, propane gas, etc.) do not operate this or any other appliance. Open a window or door to ventilate the area immediately.
- Do not hold the charging station upside down with the battery in the charging station.
- Do not expose the appliance, and the battery in particular, to heat, a heating device or direct sunlight.
- Do not keep the appliance or its battery inside a vehicle which is exposed to direct sunlight.
- Never allow any water, beverage or detergent to get inside the battery.
- Do not apply physical impacts to the battery.
- Do not use without dust bag or filters in place.
- Do not use the appliance without the dust bag and filters in place.
- Turn off all controls before unplugging.
- Keep clothing and hair, fingers, or other parts of the body away from openings and moving parts.
- Do not put any object into openings. Do not use with any opening blocked; keep free of dust, lint, hair, and anything that may reduce air flow.

Maintenance

- Make sure to unplug the power cord when cleaning or maintaining the charging station.
- Do not spray or use water, inflammable materials such as gasoline or thinners, or surfactants such as detergent or bath soap near the appliance.

Disposal

- Keep packing materials out of the reach of children. Packaging materials can pose a suffocation risk for children.
- Destroy the carton, plastic bag, and other packing materials after the appliance is unpacked. Children might use them for play. Cartons covered with rugs, bedspreads, or plastic sheets can become airtight chambers.
- Dispose of this appliance according to local, state, and regional laws and regulations.
- Contact your local city council or the related government authority before disposing of this appliance.

CAUTION STATEMENTS



CAUTION

- To reduce the risk of injury to persons, malfunction, or damage to the product or property when using the appliance, follow basic safety precautions, including the following:
-

Operation

- Do not open the door of the product using excessive force.
- Do not carry the product with the robot cleaner, nozzles, or accessories inside. Doing so may cause injury or product damage.
- When opening and closing the product door or control panel, be careful not to get your fingers caught.
- Remove all the protective plastic from the robot cleaner before use. Otherwise, it may cause abnormal noise during the dust emptying operation.
- Keep the area around the charging station clean. A strong airstream can be emitted from the exhaust on the back of the product, causing dust to accumulate on the floor.
- This appliance has a built-in safety device to prevent damage from overheating. If the appliance becomes overheated after extended use, it may automatically turn off. If this occurs, leave the appliance in a cool, well-ventilated area for about an hour before turning on the power again.
- Do not subject the product to shocks or drop it.
- Do not install wet or damp filters.
- Do not clean the product with a volatile or organic solvent (thinner or acetone).
- Always use a soft cloth to clean the appliance.
- Remain aware of your surroundings while using the appliance to avoid colliding with people or animals.
- Do not kick or apply force to the appliance.
- Do not put any object other than the appliance, especially a metallic or magnetic object, on the charging station.
- Keep fingers away from pinch points when assembling the appliance or the charging station.
- Do not let a child or a pet hang onto the charging station.
- Follow all applicable state and local codes and regulations when installing the mounting station.
- Do not use the double-sided tape to anchor the charging station on wallpaper. Use the provided screws to anchor the charging station. The weight of the charging station and the appliance could damage the paper.
- Do not remove the battery during operation.

SAVE THESE INSTRUCTIONS

INSTALLATION

Product Overview

The images in this guide may be different from the actual components and accessories, which are subject to change by the manufacturer without prior notice for product improvement purposes.

NOTE

- For your safety and for extended product life, use only authorized components. The manufacturer is not responsible for product malfunction, property damage or bodily injury caused by the use of separately purchased unauthorized components, parts, or non-LG products.

Front View

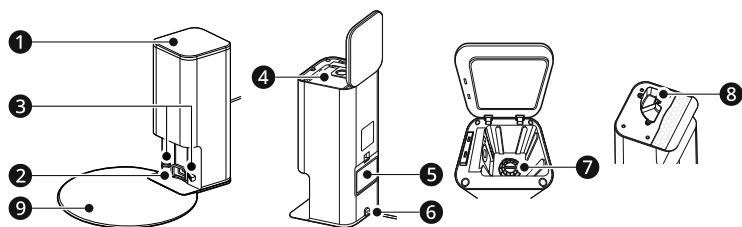

Part Name		Part Name	
❶	Charging Station Cover	❸	Power Plug
❷	Dust Nozzle	❹	Motor Protection Filter (Expendable) [†]
❸	Charging Terminals	❺	Cover for Inner Cleaning
❹	Dust Bag (Expendable) [†]	❻	Floor Damage Prevention Plate
❺	Exhaust Filter (Expendable) [†]		

[†] The dust bag, exhaust filter, and motor protection filter are installed on the product.

NOTE

- Images or content shown may be different than the model you purchased.

Accessories

Included Accessories

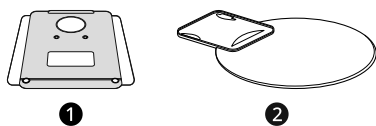

- ❶ Dust Bag (Expendable)
- ❷ Floor Damage Prevention Plate

NOTE

- The dust bag exhaust filter and the motor protection filter will eventually need to be replaced. Contact an LG Electronics customer service center.
- If you have purchased the appliance online, the installation service may not be included. You can receive the installation service for a fee from an LG Electronics Service Center, or install it yourself by referring to the installation instructions in the owner's manual.
- The dust bag for the A9/A9S dust emptying charging station is not compatible with this appliance.

Specifications

Appliance

Model	VDS-RB4**
Dimensions (Width X Depth X Height)	7.9 in X 8.8 in X 18.9 in 200 mm X 223 mm x 480 mm
Weight	Approximately 11.7 lb (5.3 kg)
Power Consumption	9 A (Cleaning) 0.5 A (Charging)
Input	120 V~ 60 Hz
Output	DC 24.5 V / 1.45 A

FCC Notice

This equipment has been tested and found to comply with the limits for a Class B digital device, pursuant to Part 15 of the FCC Rules. These limits are designed to provide reasonable protection against harmful interference in a residential installation. This equipment generates, uses, and can radiate radio frequency energy and, if not installed and used in accordance with the instructions, may cause harmful interference to radio communications. However, there is no guarantee that interference will not occur in a particular installation. If this equipment does cause harmful interference to radio or television reception, which can be determined by turning the equipment off and on, the user is encouraged to try to correct the interference by one or more of the following measures:

- Reorient or relocate the receiving antenna.
- Increase the separation between the equipment and the receiver.
- Connect the equipment into an outlet on a circuit different from that to which the receiver is connected.
- Consult the dealer or an experienced radio/TV technician for help.

Any changes or modifications in construction of this device which are not expressly approved by the party responsible for compliance could void the user's authority to operate the equipment.

Supplier's Declaration of Conformity

47 CFR §2.1077 Compliance Information

Trade Name	LG
Responsible Party	LG Electronics USA, Inc.

10 INSTALLATION

Address	111 Sylvan Avenue North Building Englewood Cliffs, NJ 07632
Email	lg.environmental@lge.com

This device complies with part 15 of the FCC Rules. Operation is subject to the following two conditions:

(1) This device may not cause harmful interference, and

(2) This device must accept any interference received, including interference that may cause undesired operation.

Installing the Charging Station

Installation

Follow the steps below to install the charging station onto a hard and level floor.

⚠ CAUTION

- Do not install on carpeted floors or rugs. The product may fall, causing injury or damage.

- 1 Install the charging station on top of the floor damage prevention plate. Install the charging station by lowering it onto the plate.
 - Be sure to install the floor damage prevention plate, as it prevents a wet mop from coming into contact with and damaging the floor.

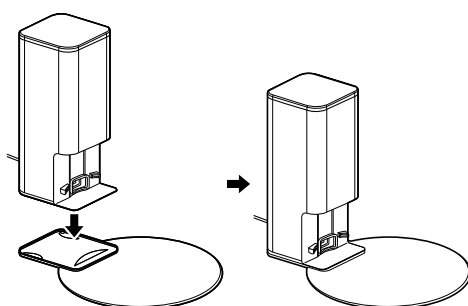

- 2 To prevent the robot cleaner from sliding while docking, place the charging station on a hard, flat surface and attach it to the wall.
 - The area around the charging station must be clear of obstacles. (Clearances: left and right: 5 ft (1.5 m); in front: 6.6 ft (2 m); above: 1 ft (30 cm)).

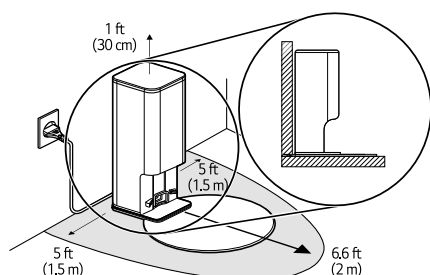

- 3 Plug the power plug into the outlet.
 - When the power plug is connected correctly, the status display flashes, and the product setting is initialized. Once initialization is completed, the status display turns off.

NOTE

- If the charging station is not plugged into a power outlet, the robot cleaner battery will not charge.
- Do not install the charging station in a narrow space. Doing so will make it difficult for the robot cleaner to find the charging station.
- Make sure that the charging station is plugged into a power outlet during use. If the power supply is not connected to the charging station, the robot cleaner cannot automatically return to the charging station to charge the battery.
- For models with the voice recognition function, do not install the charging station near a TV, a speaker, an air conditioner, or a fan. Ambient noise may be mistakenly recognized as a voice command.

OPERATION

Getting Started

Control Panel Features

Control Panel

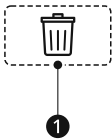

	List	Descriptions
1	Dust Emptying (Replace Bag) Indicator	<p>Indicates the dust emptying operation status or when to replace the dust bag.</p> <ul style="list-style-type: none">• White: Product is emptying dust.• Flashing red: If the indicator flashes red while emptying dust, this indicates the dust bag requires replacement. At the end of the dust emptying operation, replace the dust bag.

Using the Product

Using the Automatic Dust Emptying Mode

Once the robot cleaner returns to the charging station after finishing cleaning, the dust emptying operation automatically begins, and then the battery charges.

- When the product is returned to the charging station within 5 minutes after automatic dust emptying, automatic dust emptying does not work.

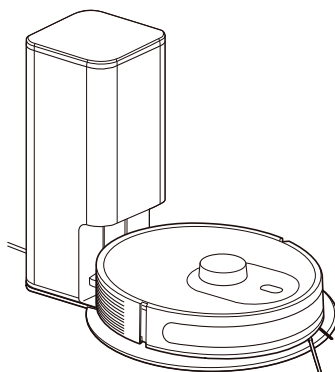

⚠ WARNING

- Do not wash the main body or the suction port of the robot cleaner with water. Moisture in the built-in motor may cause an electric shock or fire.

⚠ CAUTION

- If the robot cleaner is fastened to the charging station while the dust bin is being emptied, do not forcibly move the robot cleaner. Doing so may cause malfunction or damage to the appliance, or the charging station may fall down resulting in injury.
 - Separate the robot cleaner only after the Dust Emptying (Bag Replacement)  icon on the status indicator is completely turned off.
- Do not put your hands, garbage, toys, or any other materials into the dust nozzle of the appliance when the robot cleaner is not installed in the charging station.
- Do not pull or lean against the dust emptying charging station. Doing so may cause the appliance to fall down, resulting in injury or appliance damage.
- Do not place any object, such as a smartphone, on the charging station cover. Doing so may cause the appliance to malfunction due to vibration or said object may fall onto the floor, resulting in injury or appliance damage.

NOTE

- If necessary, charge the robot cleaner manually. Align the arrow on the robot cleaner with the arrow on the charging terminals and push the robot cleaner in until you hear a beep.

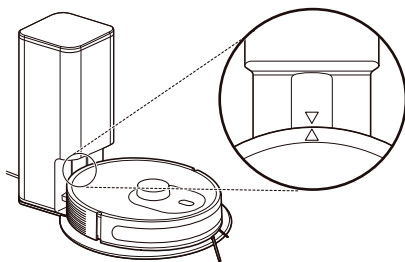

MAINTENANCE

Cleaning the Appliance

Before Cleaning the Product

- Disconnect the power plug from the outlet before cleaning the appliance.
- The dust bag should be replaced every 1 to 2 months to keep the appliance clean and maintain appliance performance. When the Dust Emptying (Bag Replacement) icon blinks in red, the dust emptying performance has deteriorated or there is an odor, replace the dust bag immediately. The dust bag replacement cycle may vary depending on the service environment.
- In order to ensure that dust emptying performance does not deteriorate, clean the motor protection filter and the exhaust filter at least once every three months.
- The cleaning cycle varies depending on the service environment and hours of use, so clean frequently in dusty environments.
- Fine dust may remain in the robot cleaner's dust bin due to static electricity generated during the dust emptying operation. Periodically clean the dust bin thoroughly.

⚠ WARNING

- The motor is inside the main body of the appliance. Do not wash the main body with water. Moisture in the motor may cause an electric shock or fire.
- Do not allow foreign objects to enter the motor. Failure to follow this caution may cause an explosion or fire, and the appliance may malfunction.

Cleaning the Product Body

- 1 Disconnect the power plug from the outlet.
- 2 Remove any dust from around the dust nozzle using a dry towel.

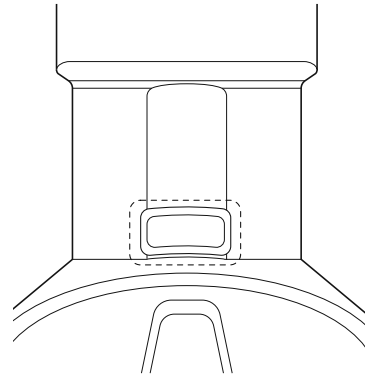

Replacing the Dust Bag

- 1 Lift up the dust emptying charging station cover.

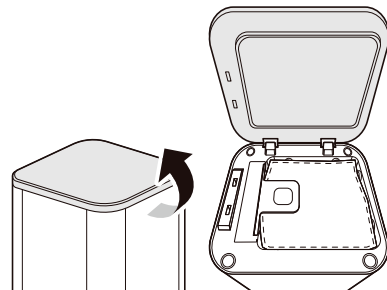

- 2 Pull the dust bag holder to remove the dust bag.

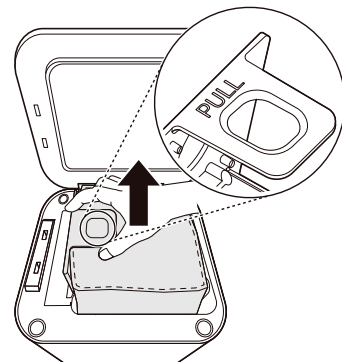

- 3 Discard the dust bag.

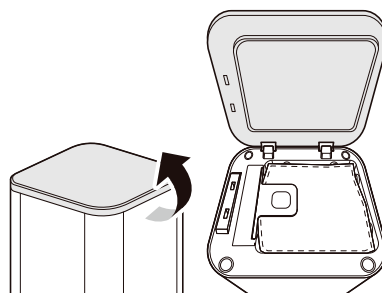
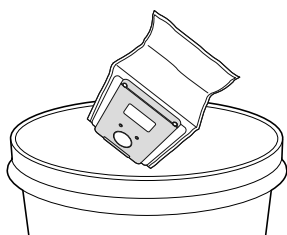

4 Prepare a new dust bag.

- Do not reuse the used dust bag. Doing so may cause odors from the appliance.

2 Pull the dust bag holder to remove the dust bag.

5 Slide the dust bag all the way in along the rails of the appliance until a click is heard.

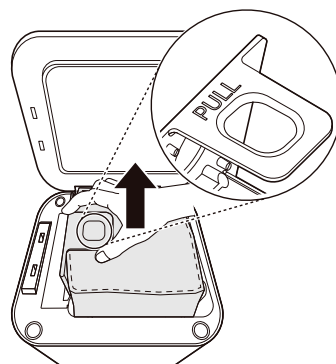
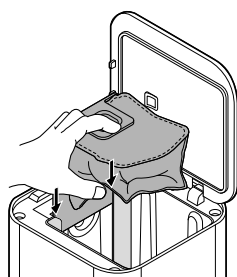

3 Turn the motor protection filter in the direction of the arrow to remove it.

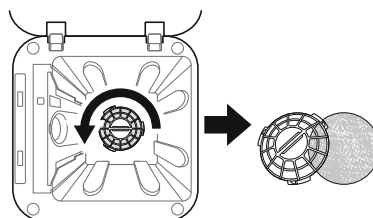

4 Hold the appliance with one hand and remove the exhaust filter from the back of the appliance with the other hand.

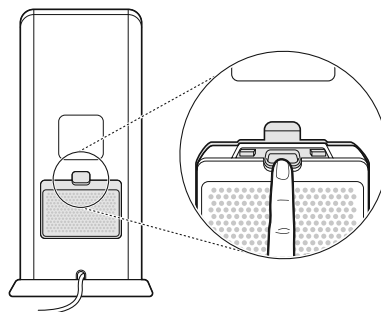

NOTE

- If a dust bag is not inserted, the dust bag door won't close. Be sure to insert a new dust bag into place after discarding the used dust bag.
- Replace the dust bag every one to two months in order to keep the appliance clean and maintain appliance performance. Replace the dust bag immediately when the dust emptying performance has deteriorated or there is an unpleasant odor. The dust bag replacement cycle may vary depending on the service environment.
- Dust bags are a consumable. Dust bags can be purchased from the LG Electronics website (www.lg.com).
- The dust bag for this appliance is not compatible with the dust bag of the dust emptying charging station for the A9/A9S.

Changing the Filter

1 Open the dust emptying charging station cover.

- 5** Once every three months, shake off the dust from the motor protection filter **1** and the exhaust filter **2**, and wash them with cold water.

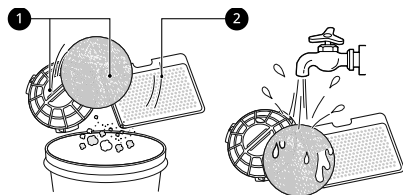

- 6** After washing the motor protection filter and the exhaust filter with water, dry them completely in a well-ventilated shady area for at least 24 hours before use. If water remains in the filter, odors may occur or the motor may be damaged.

- Only use water to wash the filters. Using a detergent may deform the filters or deteriorate filter performance.

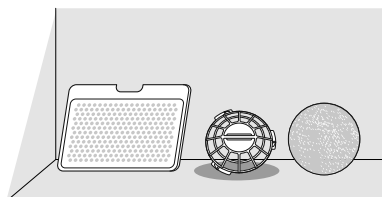

- 7** Reassemble the motor protection filter by turning it clockwise, and install the exhaust filter.
- Be sure to assemble the motor protection filter and the exhaust filter before using the appliance.

Cleaning the Inside of the Appliance

If an abnormal noise is heard from the dust emptying charging station or the bag replacement icon (🗑️) blinks in red even after the dust bag has been replaced, clean the inside of the appliance.

- 1** Spread a soft cloth on the floor and turn the appliance upside down on the cloth.

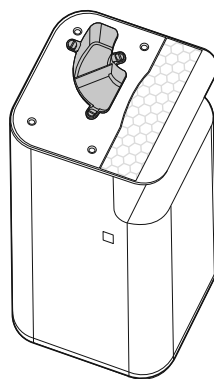

- 2** Turn the 3 locking holes on the bottom cover counter-clockwise.

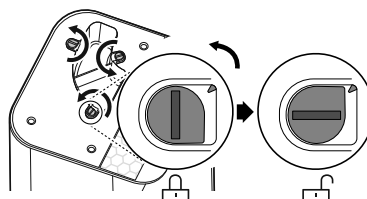

- 3** Lift the bottom cover up to remove it.

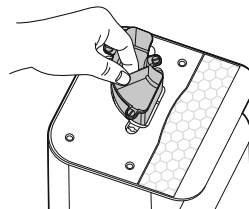

- 4** Use a damp towel or cloth to wipe the inside and remove any foreign objects blocking the pipe with tweezers.

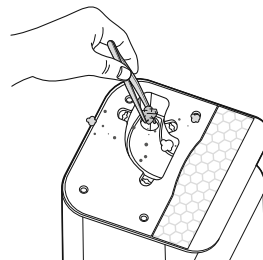

- 5** Put the bottom cover back in place and lock the 3 locking holes by turning them clockwise.

Cleaning the Charging Terminals

Disconnect the power plug of the charging station from the power outlet and clean the charging terminals periodically using a soft cloth or a brush.

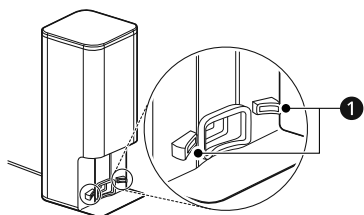

❶ Charging Terminals

TROUBLESHOOTING

Before Calling for Service

Operation

Problem	Possible Cause & Solution
Dust emptying doesn't work.	The power plug is not connected. <ul style="list-style-type: none"> Connect the power plug to an outlet.
	The robot cleaner is not properly inserted into the product. <ul style="list-style-type: none"> Remove the robot cleaner and reinsert it. If it is installed properly, a beep will sound.
	Dust emptying operation is stopped. <ul style="list-style-type: none"> If you move the robot cleaner, the dust emptying operation will be cancelled.
	The robot cleaner has not completed cleaning. <ul style="list-style-type: none"> If the robot cleaner returns to the charging station due to low battery level, the automatic dust emptying function will not operate. The robot cleaner resumes cleaning the remaining area after the battery is recharged.
	The protection mode is automatically activated if the motor has become overheated after carrying out the dust emptying operation sequentially 5 times or more within a set period of time. If the protection mode is activated, the dust emptying operation is not available. <ul style="list-style-type: none"> Begin the dust emptying operation after the protection mode has deactivated.
It won't charge.	It is not plugged in. <ul style="list-style-type: none"> Plug it into an outlet.
	There is a foreign object on the charging terminals. <ul style="list-style-type: none"> After unplugging the appliance from the outlet, wipe off any foreign matter from the charging terminal with a dry cloth.
	The room temperature was 41°F (5°C) or less during charging. <ul style="list-style-type: none"> Charging may not work if the temperature where you are charging is 41°F (5°C) or less. Before use, fully charge the robot cleaner at a temperature above 41°F (5°C).
	The robot cleaner is not properly inserted into the product. <ul style="list-style-type: none"> When the robot cleaner is properly inserted into the product, a beep sounds. If the beep does not sound, reinsert the robot cleaner.
The power supply has been cut off.	The power supply has been cut off. <ul style="list-style-type: none"> Check whether the power plug is connected correctly to the outlet. If using a multi-outlet strip, make sure the strip is turned on. Check if the breaker is tripped or there is a power outage.
The product has a strange smell.	The product is purchased within 3 months. <ul style="list-style-type: none"> The odors from manufacturing the product should be gone within 3 months.
	The robot cleaner smells. <ul style="list-style-type: none"> The pre-filter, exhaust filter, or large dust separator may smell after washing if it isn't dried completely. After washing with water, dry them thoroughly in well-ventilated, shady area for at least 24 hours before using them again.

Problem	Possible Cause & Solution
The product has a strange smell.	The dust bag smells. <ul style="list-style-type: none">• If you clean foreign matter that smells (such as pet excrement) with the robot cleaner, the vacuum may smell even if you do not have a full dust bag. Replace with a new dust bag even if the existing bag isn't full.• If you have not replaced the dust bag for a long time, it may smell. Replace it with a new dust bag even if it isn't full.
During the dust emptying operation, the dust emptying notification flashes red.	The dust bag is full. <ul style="list-style-type: none">• Throw away the used dust bag and replace it with a new dust bag.



LG Customer Information Center

For inquiries or comments,
visit **www.lg.com** or call:
1-800-243-0000 U.S.A.

Register your product Online!

www.lg.com