

## SECTION 1

### FLUSH INSET INSTALLATION



## SECTION 2

### STANDARD INSTALLATION

#### 1/4" FRAMED PANELS



#### 3/4" OVERLAY PANELS



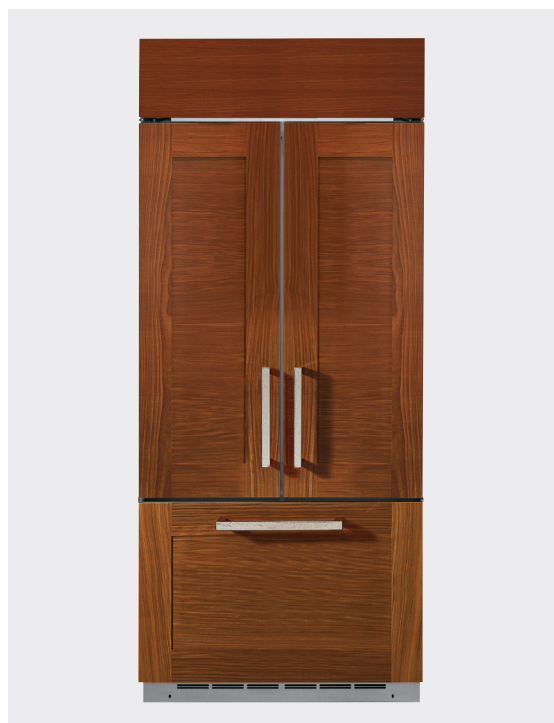

### SPECIFICATIONS

Overall Width	38" (96.5 cm)
Overall Height	84 1/2" (214.6 cm)
Overall Depth	25 7/8" (49.5 cm)
Door Clearance	19 1/2" (49.5 cm)
Cutout Width	39" (99.1 cm)
Cutout Height	85" (215.9 cm)
Cutout Depth	26 3/16" (66.5 cm)
Electrical Requirements	115 V AC, 60 Hz 20 amp circuit
Plumbing Requirements	1/4" OD copper tubing or GE SmartConnect kit
Shipping Weight	663 lb (300.7 kg)

### ATTENTION ELECTRICIAN:

A 115 volt 60Hz., 15 or 20 amp power supply is required. An individual properly grounded branch circuit or circuit breaker is recommended. Install a properly grounded 3-prong electrical receptacle recessed into the back wall.

### OVERALL DIMENSIONS AFTER PANEL INSTALL

### FLUSH INSET INSTALLATION

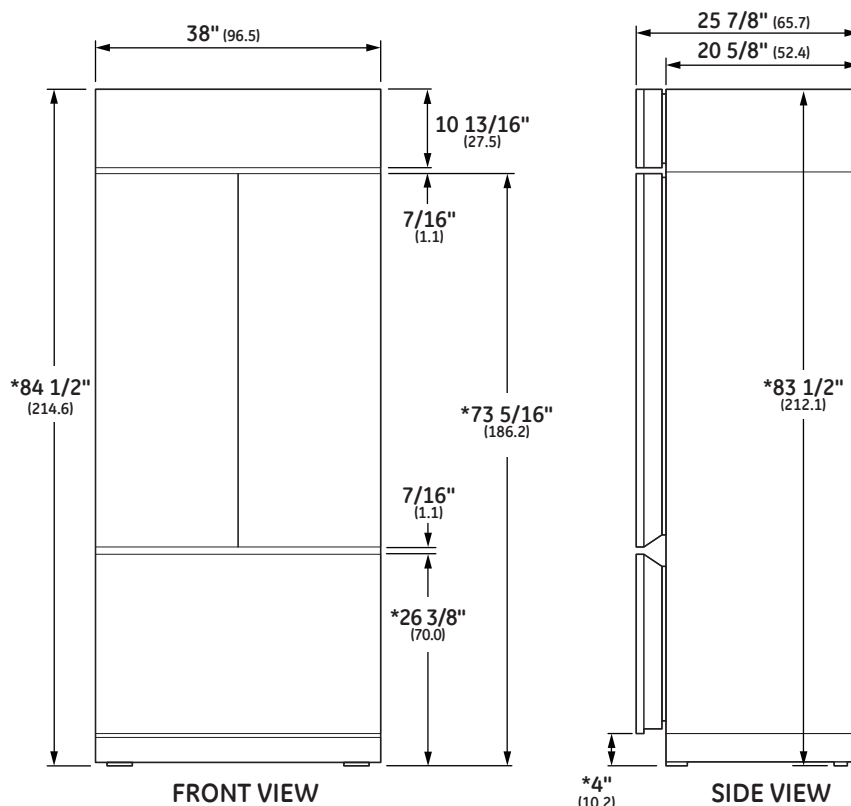

\* Shipping height. Use leveling legs and wheels for maximum 1" height adjustment from shipping height.

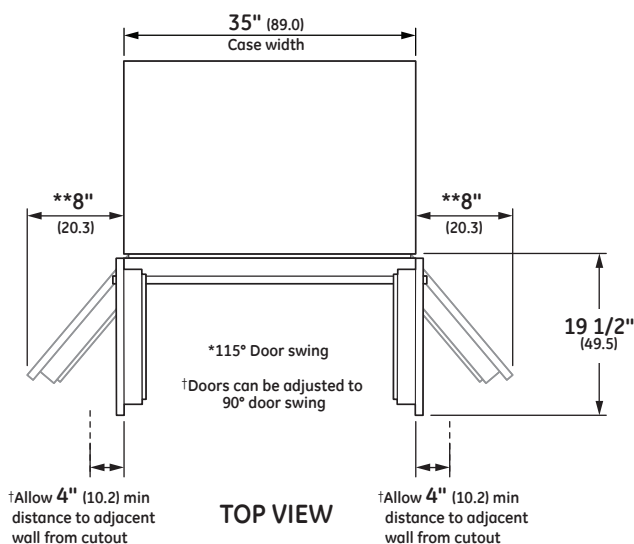

Dimensions in parentheses are in centimeters unless otherwise noted. Actual product dimensions may vary due to manufacturing tolerances.

## FLUSH INSET INSTALLATION

**A** Mounting the junction box in this location will also allow for front accessibility through access panel.

**B** Water supply area

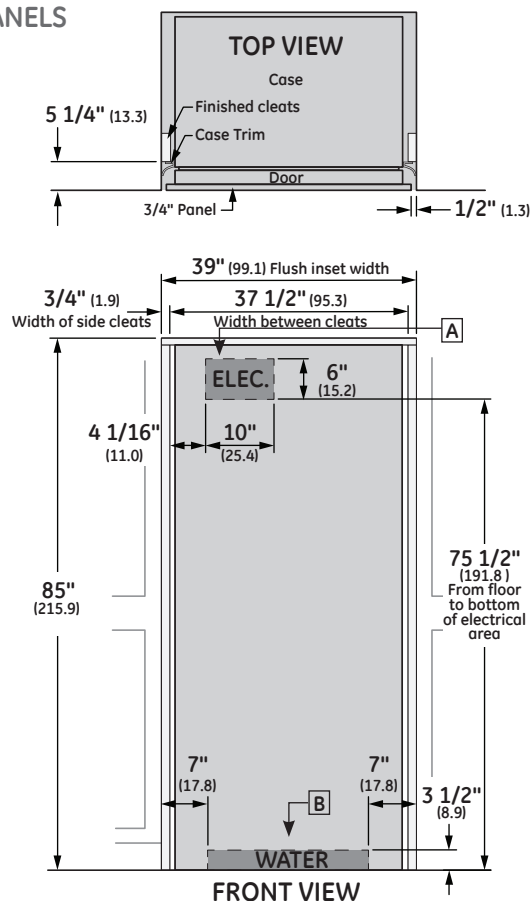

**⚠ WARNING:**

The refrigerator is top heavy and must be secured to prevent the possibility of tipping forward. Failure to do so may result in death or serious injury.

The information below is for cabinet design only. When installing the anti-tip system you must use the product installation instructions.

The information below applies to all installation constructions:

- A wall bracket, bolts and toggles will be supplied with the unit.
- The bolts will be used to attach bracket to wall in 4 locations. Two of the locations must penetrate the center of the wall studs.
- The toggles are used for stability in drywall and when metal studs are encountered. Lag bolts are used in wood studs.
- In installation opening, measure 81 1/2" from floor and draw a horizontal line.
- Locate and mark the wall studs on horizontal line. Verify at least two studs have their centerlines within the center 32.5" of installation opening to ensure 2 wall studs are penetrated.
- The bracket will be centered left to right in opening with bottom of bracket on the horizontal line.
- When unit is placed in opening, the bracket tabs will align with openings in back of the unit. The unit will be secured to the bracket using supplied "L" bolts.

**See Installation Instructions for detailed instructions.**

## ANTI-TIP BRACKET

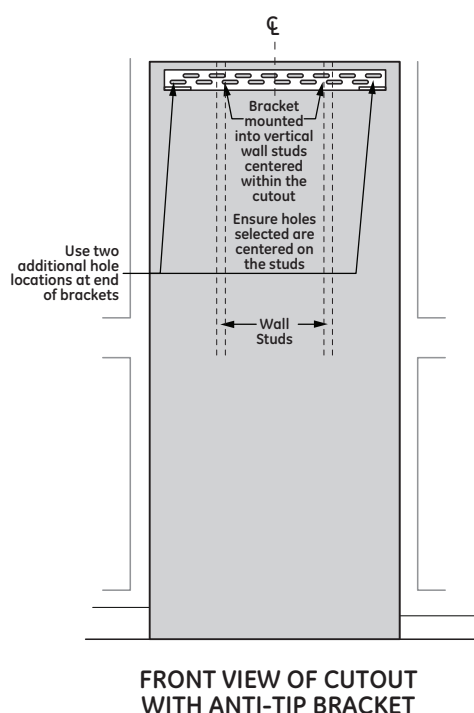
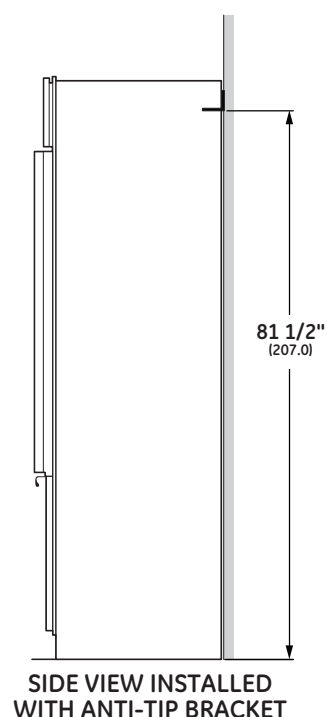

FLUSH INSET 3/4" PANEL DIMENSIONS

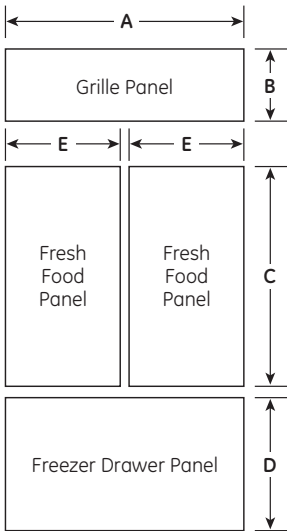

PANEL DIMENSIONS

A	B	C	D	E
38"	10 13/16"	46 7/16"	22 3/8"	18 3/4"

FLUSH INSET INSTALLATION

NOTES

Trimmed refrigerators are designed to be customized with decorative panels. Field-installed 1/2" or 3/4" custom door, drawer and grille panels are required. For 3/4" raised panels, routing is required. The router depth is 1/4" all the way around the panel's backs. Additional panel width reductions are required per the diagrams shown. This will create "picture frame" routing allowing the panels to slide into the attached door, drawer and grille trims.

- Maximum total panel weight:
- Fresh food door panels – 30 lbs.
  - Freezer drawer panel – 28 lbs.
  - Grille panel – 11 lbs

**Door Handles**  
Door handles not included. Custom handles supplied by your cabinet maker may be used.

**ZKHFD2H:** European tubular stainless steel handles designed to fit 3/4" panels. Kit includes three handles.

3/4" RAISED FRESH FOOD DOOR PANELS ROUTING

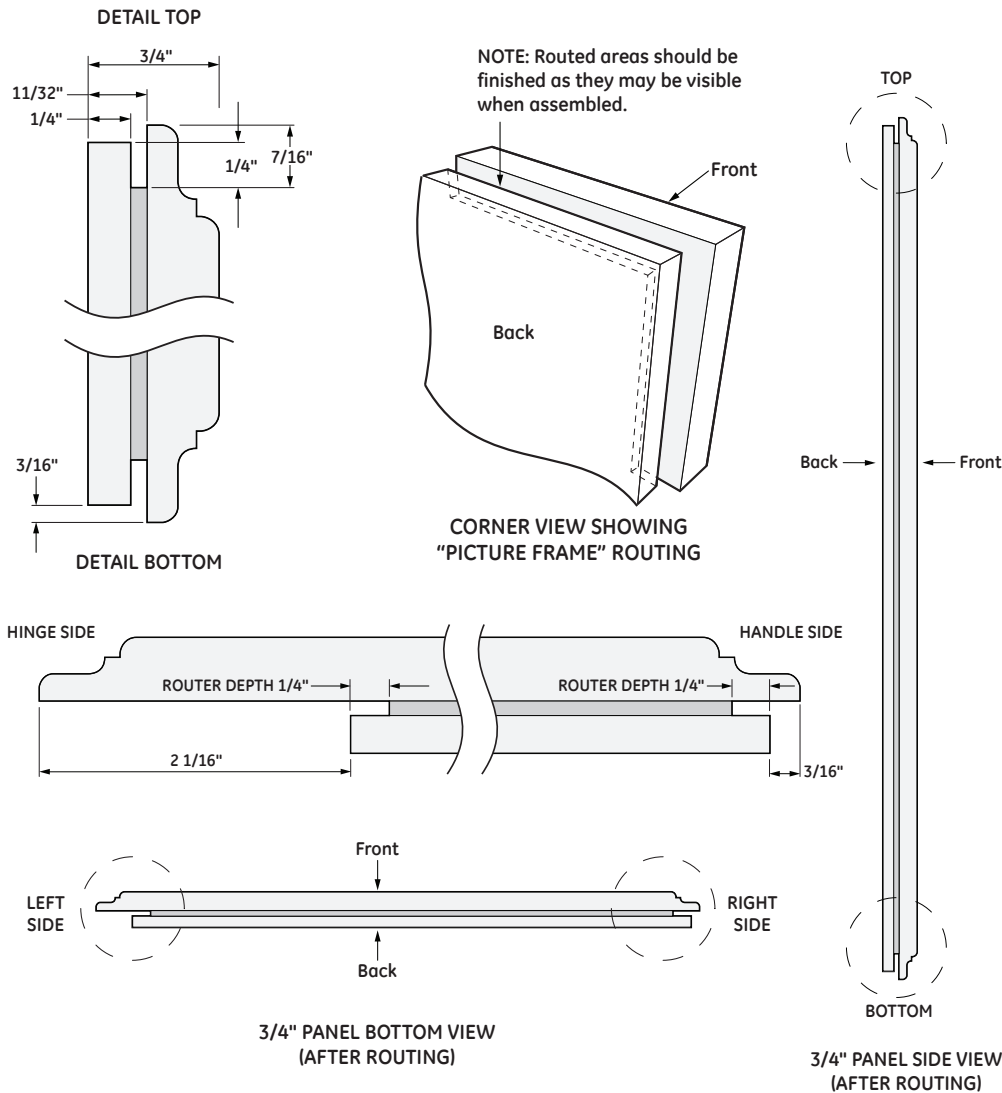

**WARNING:**

**Door Trim Pinch Point Hazard**  
Improper installation can lead to a finger pinch point hazard between the side door trim and the cabinets when operating the door, especially with children. To minimize this risk you must follow the installation instructions for cabinet dimensions, trim assembly and door stop angle.



### 3/4" RAISED FREEZER DRAWER PANEL ROUTING

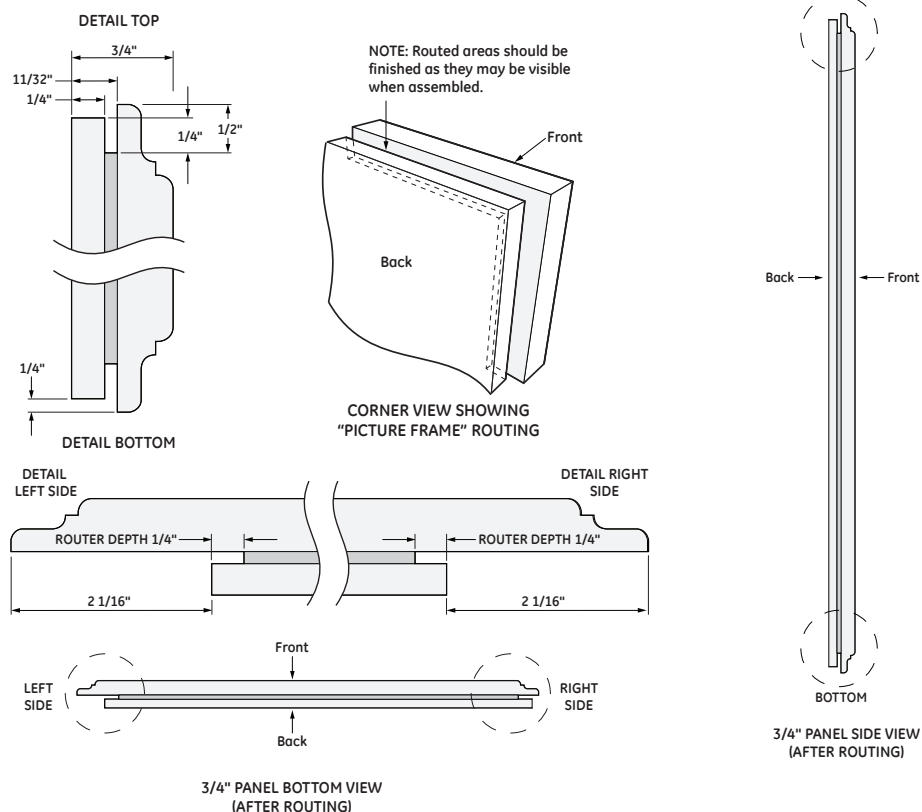

### FLUSH INSET INSTALLATION

#### NOTES

Trimmed refrigerators are designed to be customized with decorative panels. Field-installed 1/2" or 3/4" custom door, drawer and grille panels are required. For 3/4" raised panels, routing is required. The router depth is 1/4" all the way around the panel's backs. Additional panel width reductions are required per the diagrams shown. This will create "picture frame" routing allowing the panels to slide into the attached door, drawer and grille trims.

#### Maximum total panel weight:

- Fresh food door panels – 30 lbs.
- Freezer drawer panel – 28 lbs.
- Grille panel – 11 lbs

#### Door Handles

Door handles not included. Custom handles supplied by your cabinet maker may be used.

**ZKHFD2H:** European tubular stainless steel handles designed to fit 3/4" panels. Kit includes three handles.

### 3/4" RAISED GRILLE PANEL ROUTING

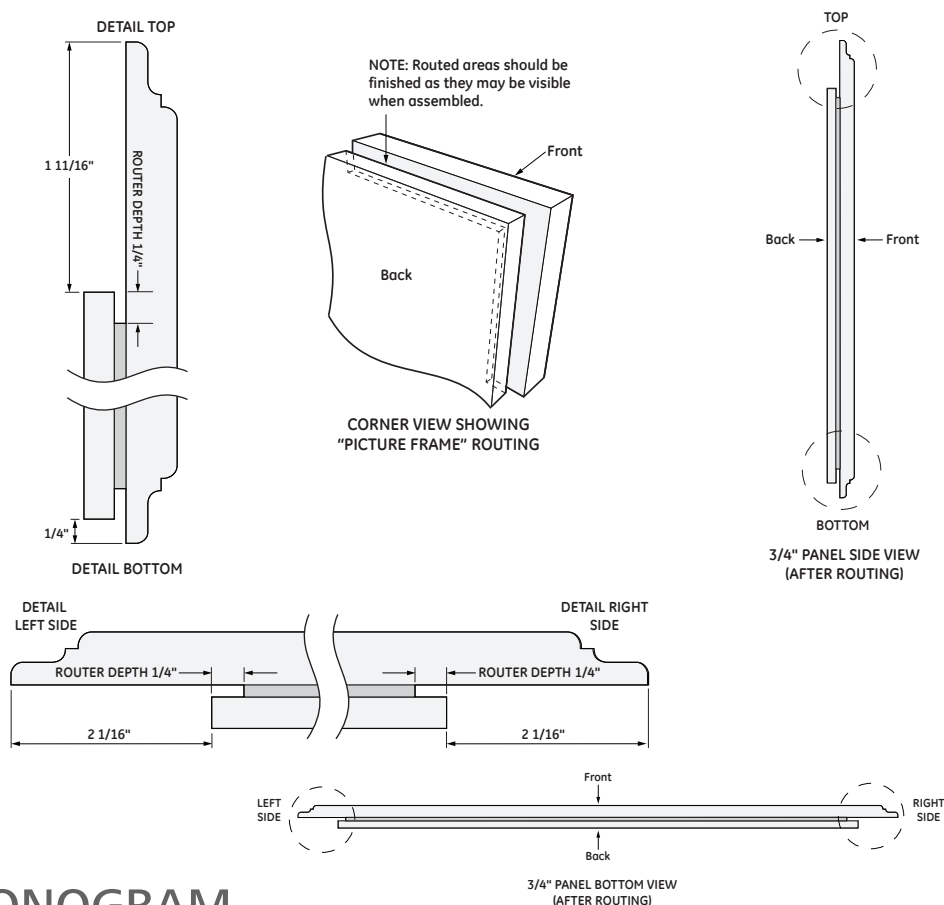

## FLUSH INSET INSTALLATION

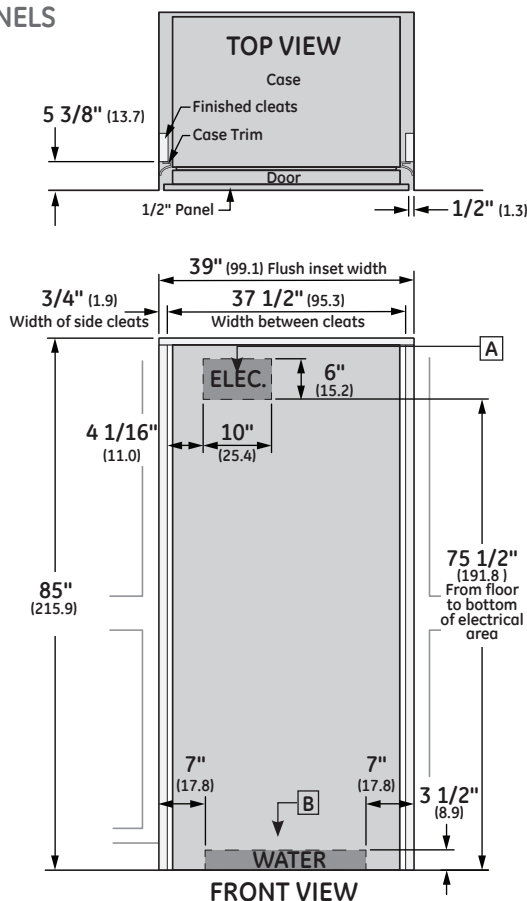

Diagram illustrating the front view of a cutout with an anti-tip bracket. The cutout is shown as a rectangular opening in a wall. The bracket is mounted into vertical wall studs, centered within the cutout. The diagram shows the bracket is mounted into vertical wall studs centered within the cutout. The diagram also indicates that the holes selected are centered on the studs. The diagram shows the bracket is mounted into vertical wall studs centered within the cutout. The diagram also indicates that the holes selected are centered on the studs. The diagram shows the bracket is mounted into vertical wall studs centered within the cutout. The diagram also indicates that the holes selected are centered on the studs.

Use two additional hole locations at end of brackets

Bracket mounted into vertical wall studs centered within the cutout

Ensure holes selected are centered on the studs

Wall Studs

**FRONT VIEW OF CUTOUT WITH ANTI-TIP BRACKET**

**See Installation Instructions for detailed instructions.**



FLUSH INSET 1/2" PANEL DIMENSIONS

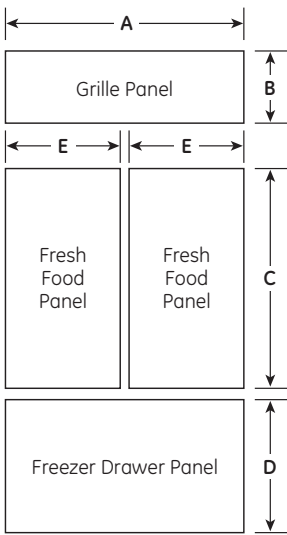

PANEL DIMENSIONS

	A	B	C	D	E
1/4" Backer Panel	33 7/8"	8 7/8"	46 1/16"	21 7/8"	16 1/2"
.10" Space Panel	32 1/2"	7 5/8"	44 11/16"	20 1/2"	15"
1/2" Overlay Panel	38"	10 13/16"	46 7/16"	22 3/8"	18 3/4"

FLUSH INSET INSTALLATION

NOTES

The 1/2" overlay panel must be secured to a .10" spacer panel and a 1/4" thick backer panel, which slides into the trim.

Assemble the panels with glue and screws:

- Center the spacer panel on the backer panel, left to right and top to bottom. Secure the panels with glue.
- Refer to the chart for locating the backer panel to the overlay panel. Secure the overlay panel to the backer panel with glue and screws. Screws must be countersunk into the backer panel.

Maximum total panel weight:

- Fresh food door panel – 30 lbs.
- Freezer drawer panel – 28 lbs.
- Grille panel – 11 lbs.

1/4" BACKER ASSEMBLY DIMENSIONS

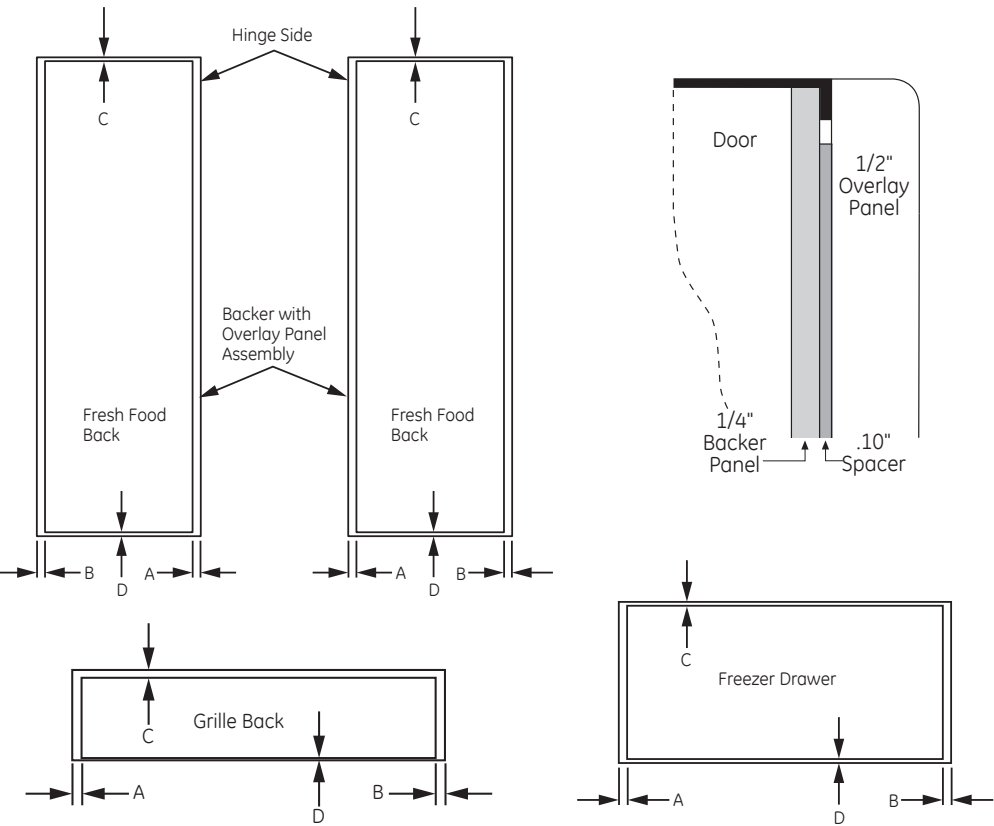

PANEL DIMENSIONS

	A	B	C	D
Fresh Food Door Panels	2 1/16"	3/16"	3/16"	3/16"
Freezer Drawer Panel	2 1/16"	2 1/16"	1/4"	1/4"
Grille Panel	2 1/16"	2 1/16"	1 11/16"	1/4"

⚠ WARNING:

Door Trim Pinch Point Hazard

Improper installation can lead to a finger pinch point hazard between the side door trim and the cabinets when operating the door, especially with children. To minimize this risk you must follow the installation instructions for cabinet dimensions, trim assembly and door stop angle.



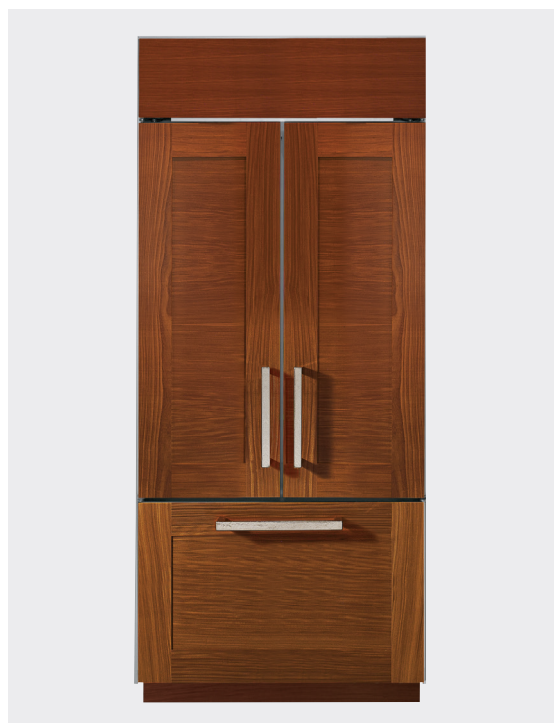

### SPECIFICATIONS

Overall Width	36" (91.4 cm)
Overall Height	84" (213.4 cm)
Overall Depth	25 3/8" (64.5 cm)
Door Clearance	18 3/16" (46.2 cm)
Cutout Width	35 1/2" (90.2 cm)
Cutout Height	84" (213.4 cm)
Cutout Depth	24" (61 cm)
Electrical Requirements	115 V AC, 60 Hz 20 amp circuit
Plumbing Requirements	1/4" OD copper tubing or GE SmartConnect kit
Shipping Weight	614 lb

### ATTENTION ELECTRICIAN:

A 115 volt 60Hz., 15 or 20 amp power supply is required. An individual properly grounded branch circuit or circuit breaker is recommended. Install a properly grounded 3-prong electrical receptacle recessed into the back wall.

### OVERALL DIMENSIONS AFTER PANEL INSTALL

### STANDARD INSTALLATION

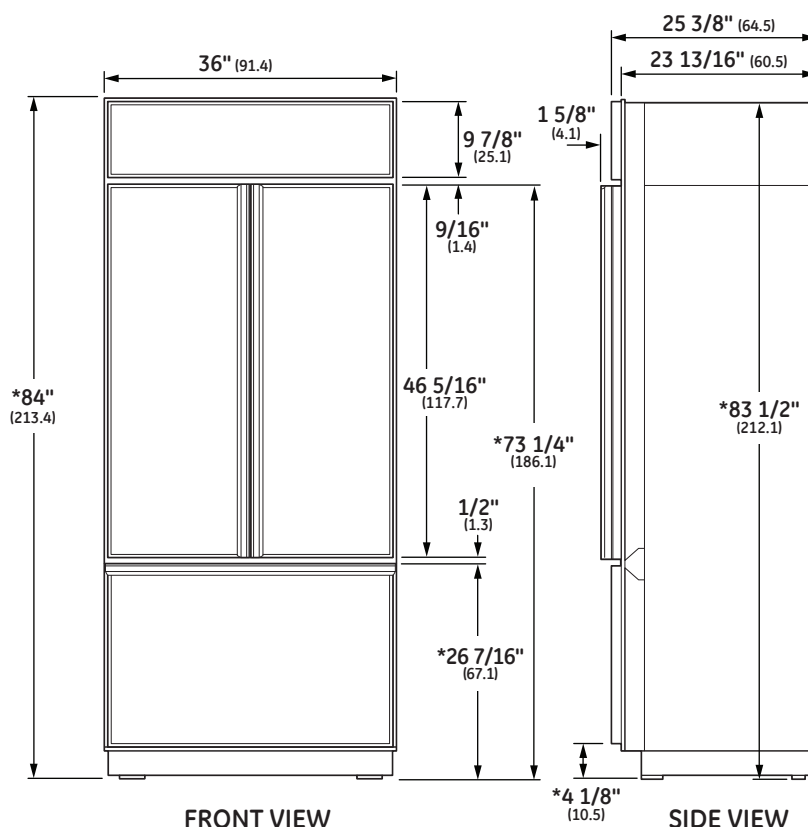

\*Shipping height. Use leveling legs and wheels for maximum 1" height adjustment from shipping height.

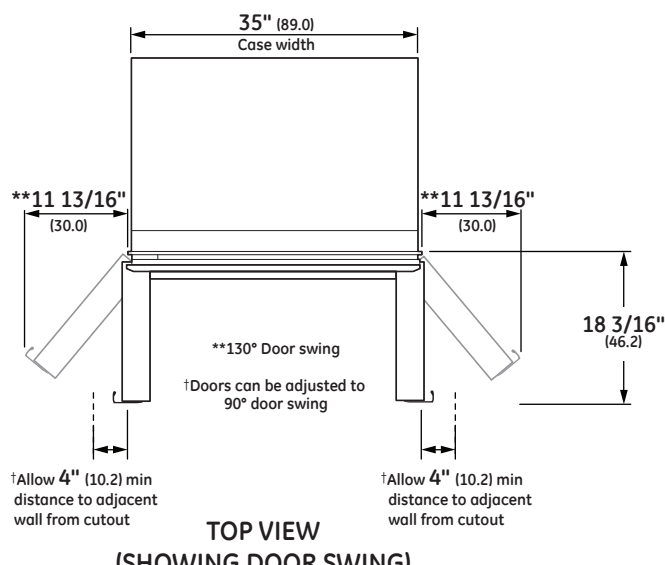

Dimensions in parentheses are in centimeters unless otherwise noted. Actual product dimensions may vary due to manufacturing tolerances.



## STANDARD INSTALLATION 3/4" PANELS

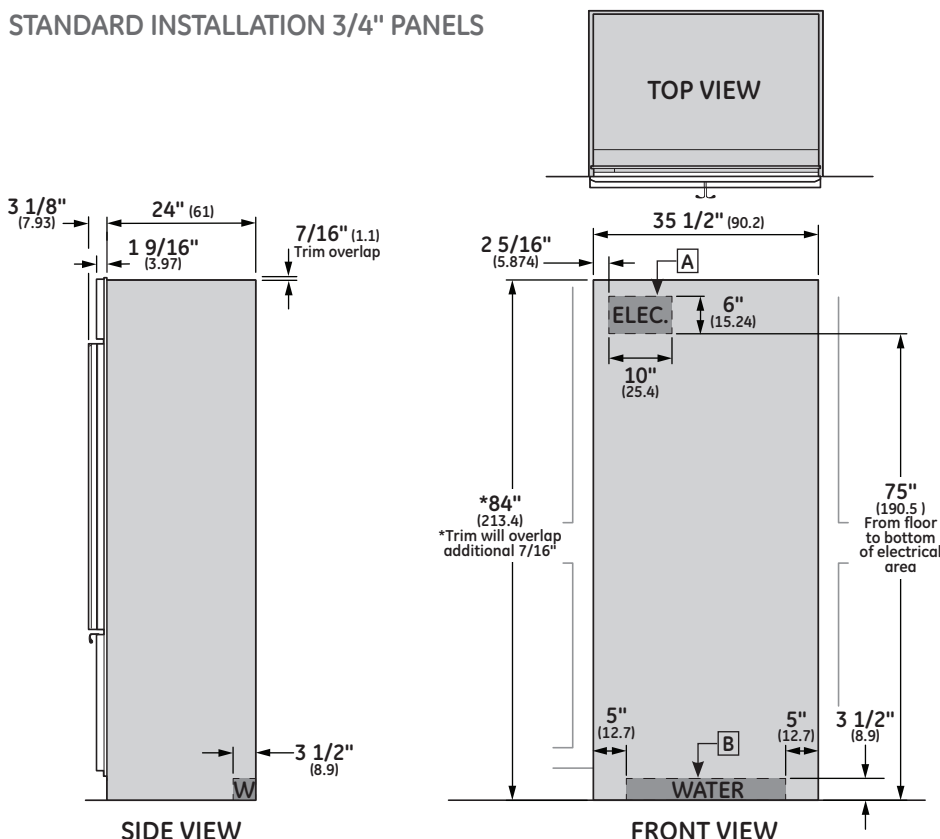

## STANDARD INSTALLATION

## NOTES

**A** Mounting the junction box in this location will also allow for front accessibility through access panel.

**B** Water supply area

**WARNING:**

The refrigerator is top heavy and must be secured to prevent the possibility of tipping forward. Failure to do so may result in death or serious injury.

The information below is for cabinet design only. When installing the anti-tip system you must use the product installation instructions.

The information below applies to all installation constructions:

- A wall bracket, bolts and toggles will be supplied with the unit.
- The bolts will be used to attach bracket to wall in 4 locations. Two of the locations must penetrate the center of the wall studs.
- The toggles are used for stability in drywall and when metal studs are encountered. Lag bolts are used in wood studs.
- In installation opening, measure 81 1/2" from floor and draw a horizontal line.
- Locate and mark the wall studs on horizontal line. Verify at least two studs have their centerlines within the center 32.5" of installation opening to ensure 2 wall studs are penetrated.
- The bracket will be centered left to right in opening with bottom of bracket on the horizontal line.
- When unit is placed in opening, the bracket tabs will align with openings in back of the unit. The unit will be secured to the bracket using supplied "L" bolts.

See Installation Instructions for detailed instructions.

## ANTI-TIP BRACKET

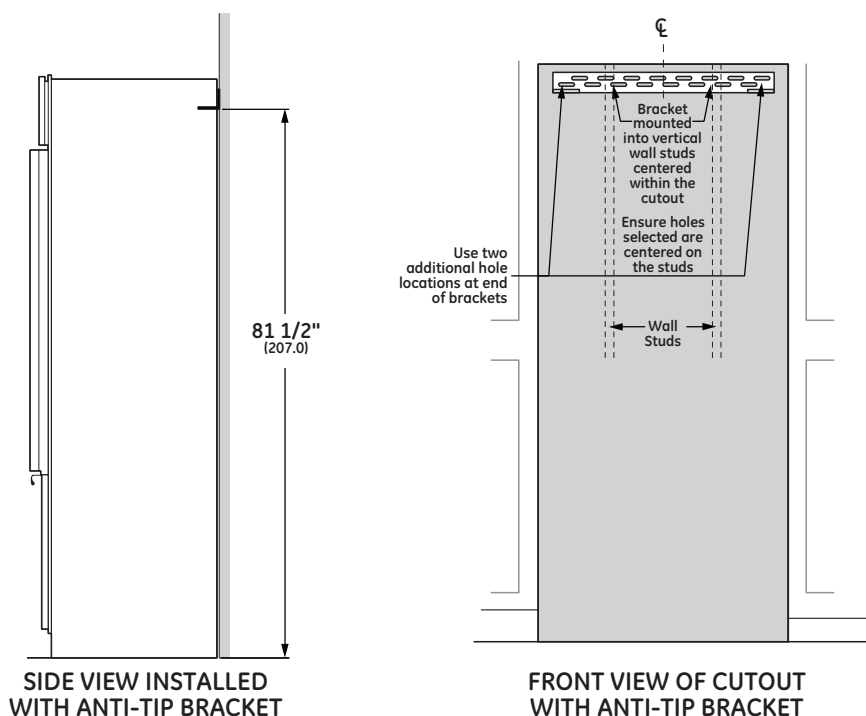

STANDARD 1/4" FRAMED PANEL DIMENSIONS

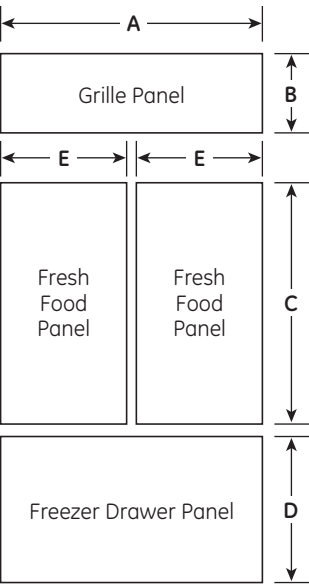

PANEL ASSEMBLY CROSS SECTION

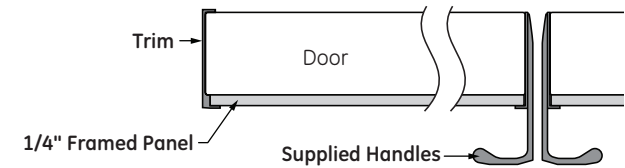

PANEL DIMENSIONS

	A	B	C	D	E
1/4" Framed Panel	33 7/8"	8 7/8"	46 1/16"	21 7/8"	16 1/2"

STANDARD INSTALLATION

NOTES

Trimmed refrigerators are designed to be customized with decorative panels Field-installed custom door and grille panels are required.

1/4" Framed Panels:

For 1/4" thick custom panels ordered from your cabinet maker. The decorative panels slide into this trim.

Maximum total panel weight:

- Fresh food door panel – 30 lbs.
- Freezer drawer panel – 28 lbs.
- Grille panel – 11 lbs

Door Handles:

The supplied handles accommodate both framed or overlay panels. Custom handles of your choice, supplied by your cabinet maker, can also be installed.

STANDARD 3/4" OVERLAY PANEL DIMENSIONS

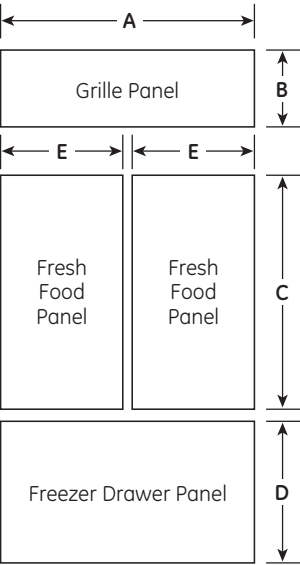

PANEL ASSEMBLY CROSS SECTION

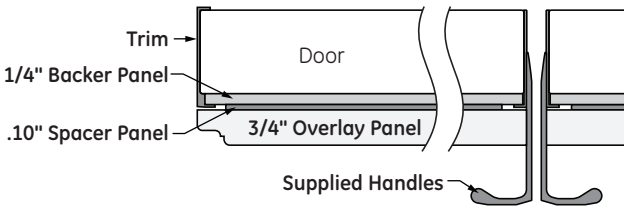

PANEL DIMENSIONS

	A	B	C	D	E
1/4" Framed Panel	33 7/8"	8 7/8"	46 1/16"	21 7/8"	16 1/2"
.10" Framed Panel	32 1/2"	7 5/8"	44 11/16"	20 1/2"	15"
3/4" Overlay Panel	34 1/8"	9"	46 5/16"	22"	16 5/8"

$.25" + .10" + .75" = 1.10"$  Total Panel Thickness

STANDARD INSTALLATION

NOTES

Trimmed refrigerators are designed to be customized with decorative panels. Field-installed custom door and grille panels are required.

3/4" Overlay Panels:

For your 3/4" thick custom panels ordered from your cabinet maker the overlay panel must be secured to a 1/4"-thick backer panel which slides into the trim. A spacer panel 0.10" thick must be placed between the overlay and backer panels.

Center each panel over the other. Assemble the panels with glue and screws. Screws must be countersunk into the backer panel.

**NOTE:** Left-to-right offset is not always equal to top-to-bottom offset.

Maximum total panel weight:

- Fresh food door panel – 30 lbs.
- Freezer drawer panel – 28 lbs.
- Grille panel – 11 lbs

Door Handles:

The supplied handles accommodate both framed or overlay panels. Custom handles of your choice, supplied by your cabinet maker, can also be installed.

**ZKHFD2H:** European tubular stainless steel handles designed to fit 3/4" panels. Kit includes three handles.

1/4" BACKER ASSEMBLY DIMENSIONS

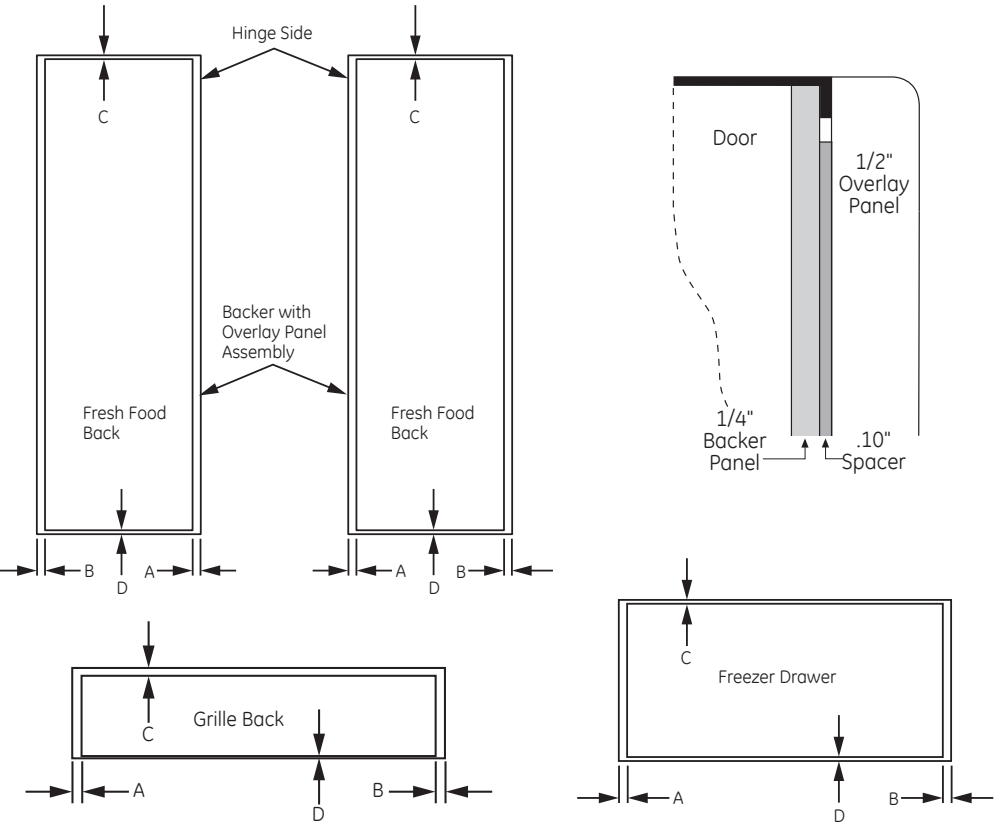

PANEL DIMENSIONS

	A	B	C	D
Fresh Food Door Panels	1/8"	0	1/8"	1/8"
Freezer Drawer Panel	1/8"	1/8"	1/16"	1/16"
Grille Panel	1/8"	1/8"	1/16"	1/16"

## FEATURES AND BENEFITS

**French-door design** gives your wide-open access to every fresh food shelf and bin.

**Finely crafted glass-front metal door bins with riveted metal accents** offer easy access to beverages and quick-grab items.

**LED lighting** positioned throughout the interior and under fresh food drawers spotlights food inside the refrigerator and in the freezer.

**Upfront electronic controls with digital readout** offer a range of precise temperature settings, all within easy reach.

**Large full-extension freezer drawer** has storage bins that slide out independently of one another for easy loading and unloading. An automatic icemaker keeps plenty of filtered ice on hand.

**Precision glass-front produce and deli drawers** feature full-extension, soft-close slides.

**Aluminum trimmed glass shelves** allow convenient access to contents in the fresh-food compartment.



70 to 90% U.S. content. Product content details at [GEAppliances.com/USA](http://GEAppliances.com/USA)