

ASSEMBLY INSTRUCTION

Model : D2207DT

Description : Dining Table

Thank you for purchasing this quality product. Be sure to check all packing material carefully for small parts that may have come loose inside the carton during shipment.

Step 1:

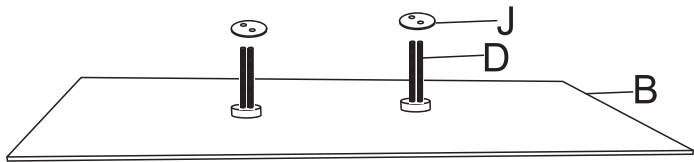

Firstly, fix the table glass top with stud.(D)

Step 2:

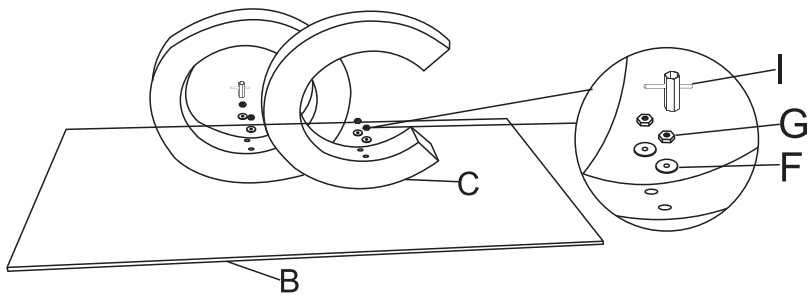

Assemble dining table leg with lead stud.(G)

Step 3:

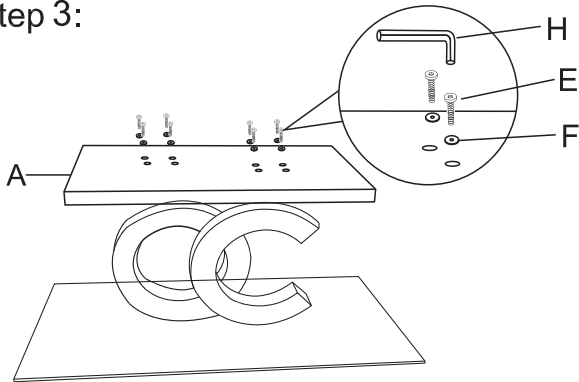

Assemble dining table base with table leg.(E)

PART LIST :

No.	Description	Diagram	Quantity
A	Table base		1
B	Table glass top		1
C	Table leg		1

HARDWARE LIST :

No.	Description	Diagram	Size	Quantity
D	Stud		M8X105mm	4
E	Bolt		M8X50mm	8
F	Flat washer		Ø8x18x1.5 mm	12
G	Nut		M8	4
H	Allen key		M5	1
I	Socket Spanner		M8	1
J	Plastic washer		M8	2

Finished

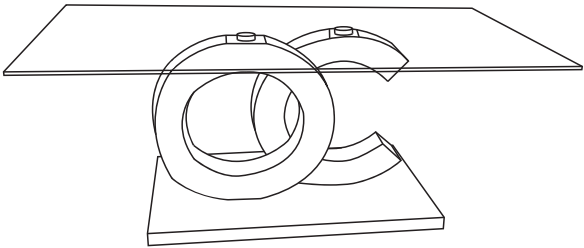

Made In China

ASSEMBLY INSTRUCTION

Model : D9002DC

Description : Dining chair

Thank you for purchasing this quality product. Be sure to check all packing material carefully for small parts that may have come loose inside the carton during shipment.

Step 1:

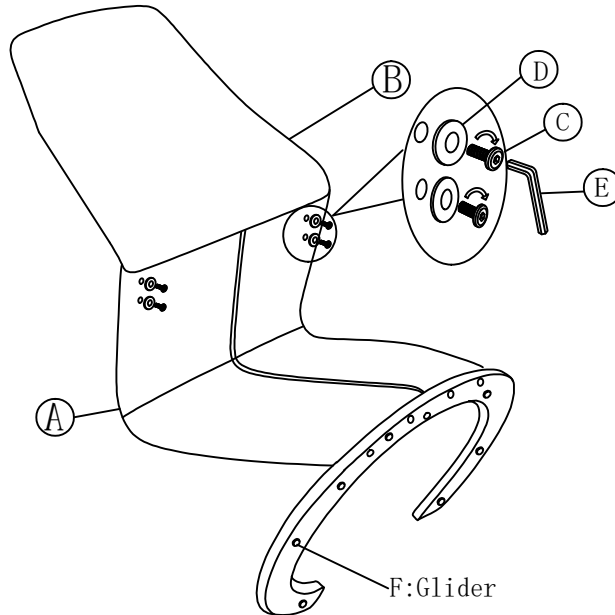

PART LIST :

No.	Description	Diagram	Quantity
A	The cushion and frame		1
B	Back of a chair		1

HARDWARE LIST :

No.	Description	Diagram	Size	Quantity
C	Bolt		M6 x 12mm	4
D	Flat washer		Ø16 x Ø6mm	4
E	Allen key		M4	1

PREFIX HARDWARE:

F	Glider		8
---	--------	--	---

Step 2:

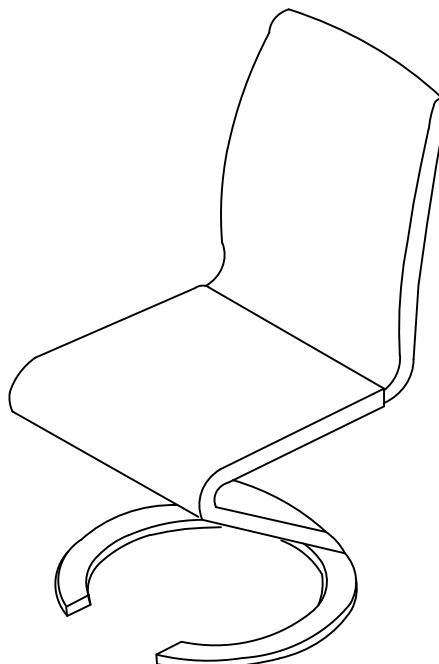

Poor Assembly Picture:

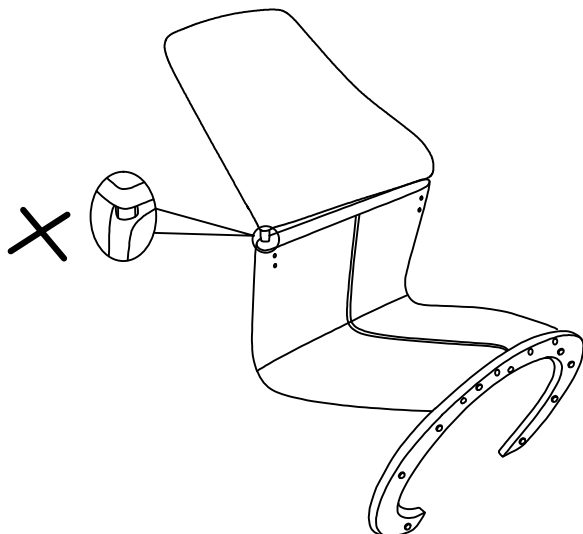

Step 2-a: Place the backrest (B) into the holes on the seat (A). Push down to make sure the screw holes on the backrest (B) are aligned with the screw holes on the seat (A). Screw in all necessary hardware as shown only halfway, do not completely tighten.

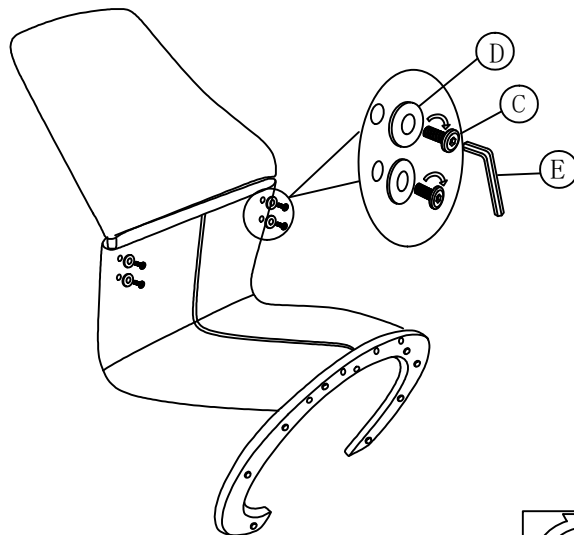

Step 2-b: Press the backrest (B) down so that the backrest is completely flush with the seat (A). Then proceed to completely lock all the screws. (Do not completely tighten the screws if the backrest (B) and seat (A) are not completely flush with each other)

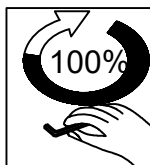
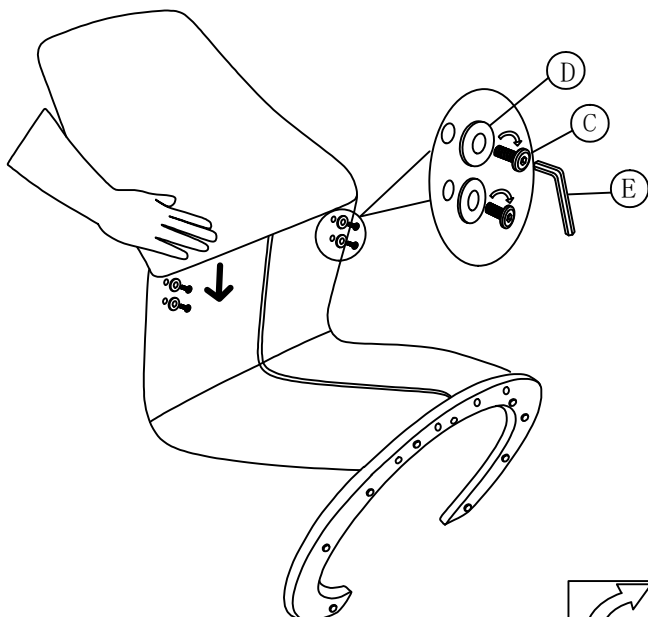

Finished:

