

# PU64ES



Product Family	Hob
Built-in type	Traditional
Dimensions	24"
Power supply	Mixed
Type	Gas
EAN code	8017709185008



## Aesthetics



Aesthetic	Piano Design
Colour	Stainless steel
Finishing	Glossy
Material	Stainless Steel
Type of steel	Polished
Pan stands	Stainless steel
Pan Stand Coating	EverShine
Burners	Piano Design
Burners Material	Stainless steel
Burner Coating	EverShine
Type of control setting	Control knobs
Control knob position	Front
No. of controls	4
Controls colour	Steel effect

## Programs / Functions

Total no. of cook zones	4
No. of gas cook zones	4

## Options



Worktop Cut-Out	478-482x555-560 mm
-----------------	--------------------

## Technical Features

Front-right - Gas - AUX

Rear-right - Gas - Rapid

Rear-left - Gas - Rapid

Front-left - Gas - Semi Rapid

Gas safety valves Yes

Automatic Ignition

Yes

## Electrical Connection

Electrical connection rating (W) 1 W

Voltage (V) 120 V

Type of electric cable Single phase

Frequency (Hz) 60 Hz

Power supply cable length 47 1/4 "

Terminal box 3 poles

Plug B

## Gas Connection

Gas Type G20 Natural gas  
Gas connection Cilindrical

Other gas nozzles included

G30 GPL Liquid gas

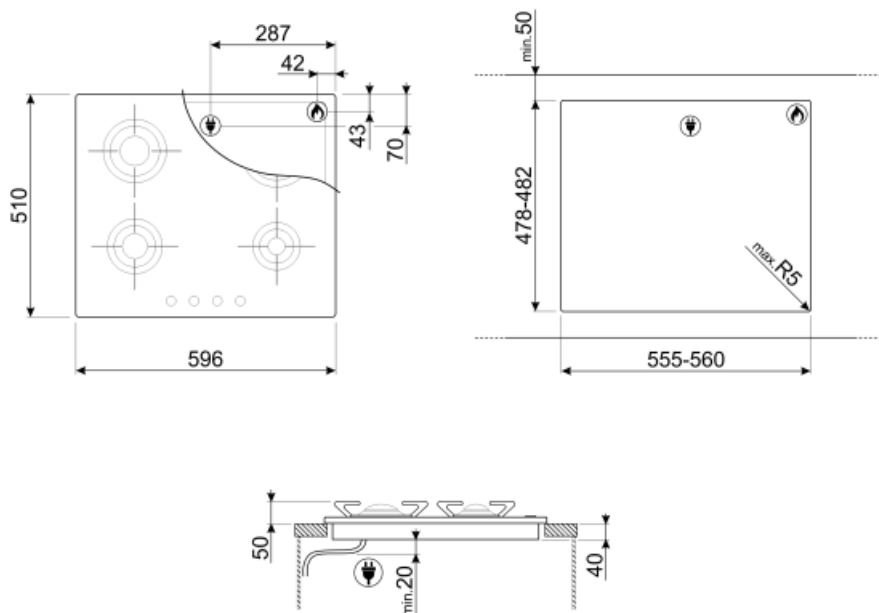

## Symbols glossary (TT)

---



Standard installation: Traditional installation in tabletop, suitable for any kitchen sets



CUT\_OUT\_STANDARD\_72dpi



Ever Shine: is an invisible coating that makes the effected area highly resistant to heat.



Knobs control