



ASSEMBLY INSTRUCTIONS

MODEL#

FM31000WH-T-1
FM31000WH-T-2

Questions?

GIVE US A CALL: 1-888-980-5122
MON-FRI 8:30AM - 5:30PM (PT)

TOOLS REQUIRED



Screwdriver
(Not included)

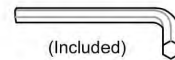

(Included)
Allen Wrench



2 - People

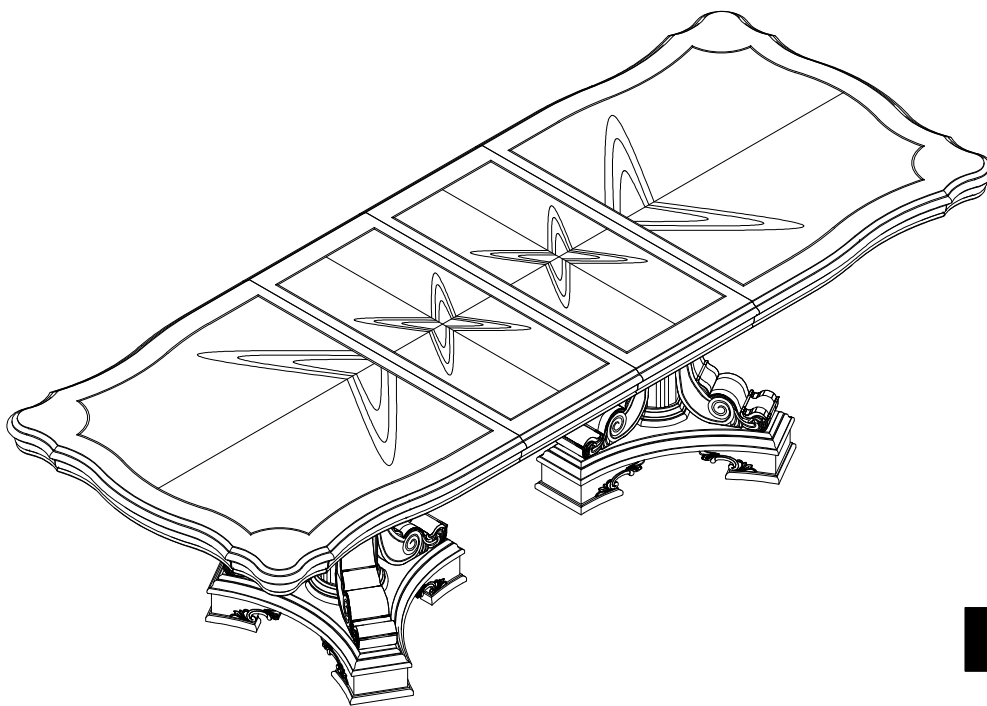

ASSEMBLY RATING



EASY —————> DIFFICULT

The Assembly Rating is a 5-point system showing the level of effort needed to assemble a specific product.



Thank you for your purchase!

We hope you enjoy this new addition to your home for many years to come.

Our commitment to providing quality products does not simply end when you purchase our product. We fully stand behind our products from start to finish. Our customer service department is available Monday – Friday 8:30 AM – 5:30 PM Pacific Time and can help with assembly questions as well as, if necessary, replacing damaged or missing parts. To help expedite our service, please have these assembly instructions readily available, along with your order receipt.



Consumer Hotline
Toll-Free 1-888-980-5122



WEBSITE
www.foagroup.com



Monday to Friday
8:30AM- 5:30PM (PT)



E-MAIL
cs.ec@foagroup.com



foagroup



FurnitureOfAmerica



CHECK BEFORE STARTING



Are you missing anything?

Double-check all parts, hardware and accessories listed are all accounted for.



Check out our Quick Tips!

We recommend reviewing the pre-assembly handouts. Even experts need a refresher now and then!



Should we send any replacements?

Are there any irregularities or flaws in the parts? We can send replacements!



Prep Time!

Please review the assembly instructions and all diagrams prior to assembling.

PRE ASSEMBLY INTRODUCTION

We understand building ready-to-assemble furniture can be a challenging experience for some. To help avoid confusion, we have provided some helpful tips that may speed up the process.



Teamwork

ALWAYS have at least two people to help with transporting and assembling the product to avoid potential injury and/or damage.



Suitable Location

Assembling near the area of the intended location is highly recommended.



Sufficient Space

Make sure you have enough space to move around during the assembly.



Avoid Scratches

Use cardboard, blankets or a carpeted area while assembling furniture to prevent scratches and damages.



Flat Surface

Make sure the furniture rests on a flat and level surface with each leg evenly touching the floor.

ASSEMBLY AND CARE ADVICE



**FAILURE TO FOLLOW THE GUIDELINES BELOW MAY
RESULT IN INJURY AND/OR PROPERTY DAMAGE.**



Position each part correctly
and insert screws or bolts into
their respective holes.



Turn clockwise to tighten and
only tighten when step is
completed or when instructed
to do so.



Use the appropriate hand tools
or power tools for assembly.
Select steps, such as tightening
screws and/or bolts, may require
hand tools to avoid causing
damage during assembly.



Save the instructions and store
any supplied tools for later
maintenance.



After two weeks, check and
tighten any loose hardware and
repeat again every six months
thereafter.

IT IS THE USER'S RESPONSIBILITY TO MAINTAIN THE FURNITURE. THE HARDWARE MAY LOOSEN OVER TIME AND MAY CAUSE THE FURNITURE TO BE WOBBLY AND UNABLE TO SUPPORT ITS INTENDED WEIGHT CAPACITY. THIS MAY LEAD TO COLLAPSE AND MAY CAUSE SERIOUS INJURY.

DOUBLE PEDESTAL DINING TABLE TOP

DOUBLE PEDESTAL DINING TABLE BASE

FM31000WH-T-1
FM31000WH-T-2



- Please keep instructions for future reference.
- Check the quantity and irregularity of parts and hardware before you start.

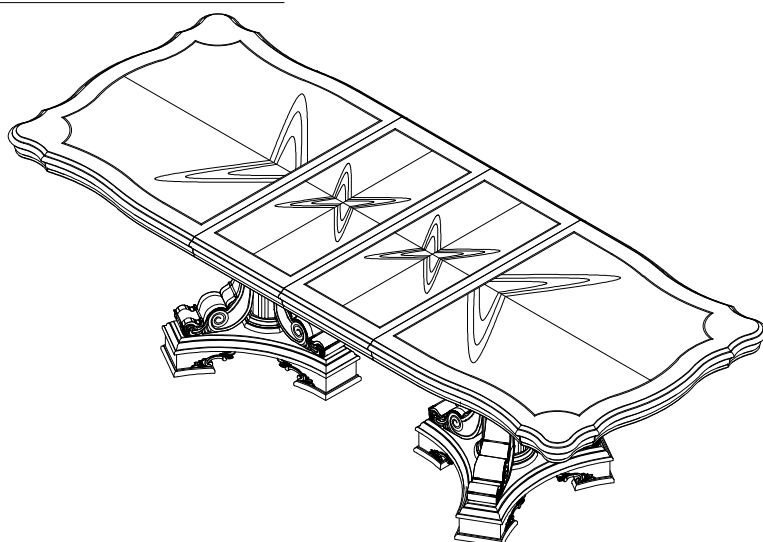

PART

#1 1pc

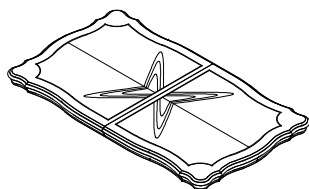

TABLE TOP

#2 2pcs

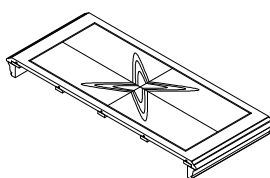
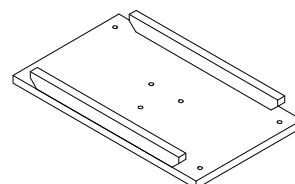

TABLE LEAF

#3 2pcs



MOUNTING PLATE

#4 2pcs

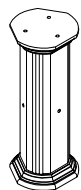

PEDESTAL

#5 6pcs

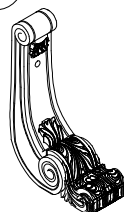

LEG

#6 2pcs

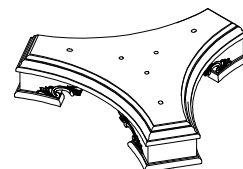

BASE

HARDWARE

#A 12pcs

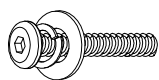

BOLT $\phi 5/16"$ X 3"
SPRING WASHER $\phi 5/16"$ X 13 X 1.2MM
FLAT WASHER $\phi 5/16"$ X 19 X 1.8MM

#B 14pcs

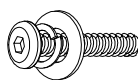

BOLT $\phi 5/16"$ X 1-3/4"
SPRING WASHER $\phi 5/16"$ X 13 X 1.2MM
FLAT WASHER $\phi 5/16"$ X 19 X 1.8MM

#C 6pcs



BOLT $\phi 5/16"$ X 1-3/4"
SPRING WASHER $\phi 5/16"$ X 13 X 1.2MM

#D 1pc



ALLEN WRENCH 4MM

#E 6pcs



WOOD PLUG $\phi 15 \times 14 \text{MM}$

DOUBLE PEDESTAL DINING TABLE is packed in 2 cases

| Carton | Designation | Part | | Hardware |
|---------------|-----------------------|------|--|-------------------|
| FM31000WH-T-1 | Table Top (1pc) | #1 | | |
| | Table Leaf (2pcs) | #2 | | |
| FM31000WH-T-2 | Mounting Plate (2pcs) | #3 | | #A 12pcs |
| | Pedestal (2pcs) | #4 | | #B 14pcs |
| | Leg (6pcs) | #5 | | #C 6pcs |
| | Base (2pcs) | #6 | | #D 1pc #E 6pcs |

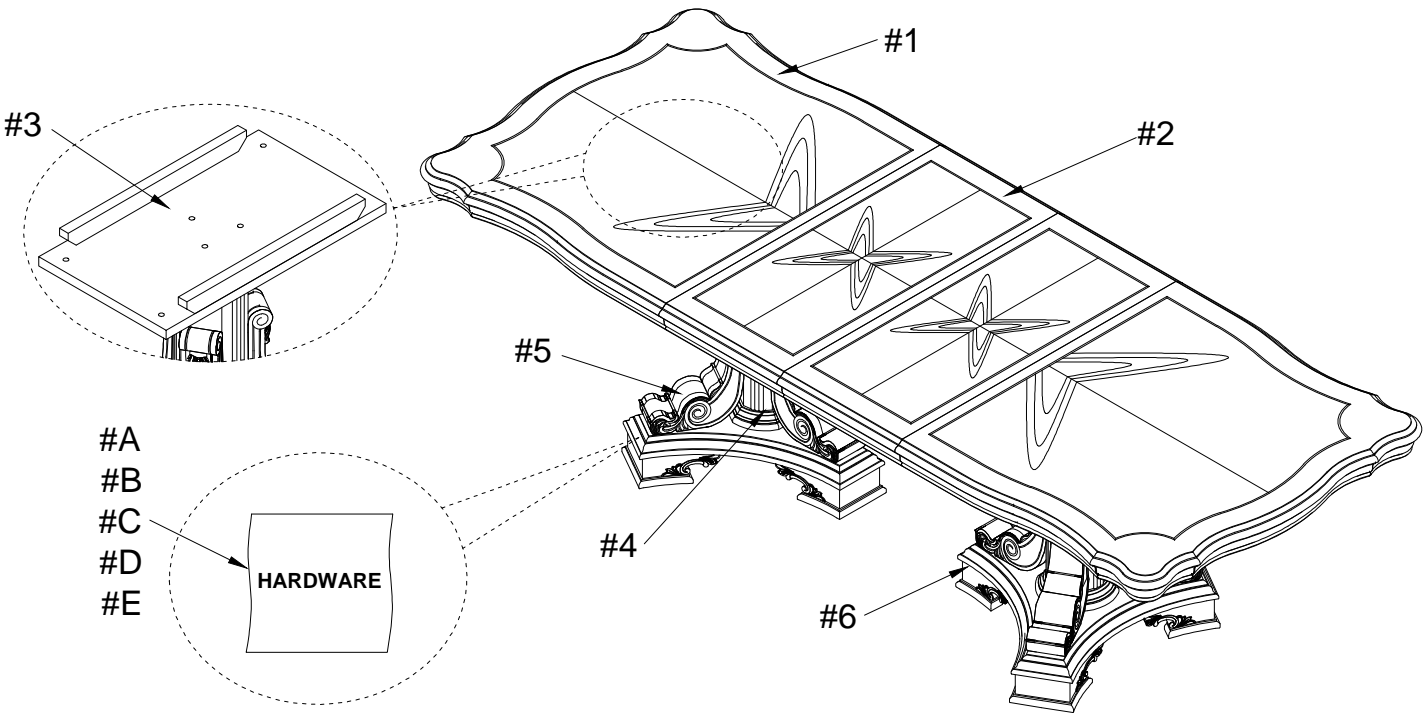

ASSEMBLY INSTRUCTIONS

1

Part #3 x2pcs
Part #4 x2pcs
Hardware #B x6pcs
Hardware #D x1pc

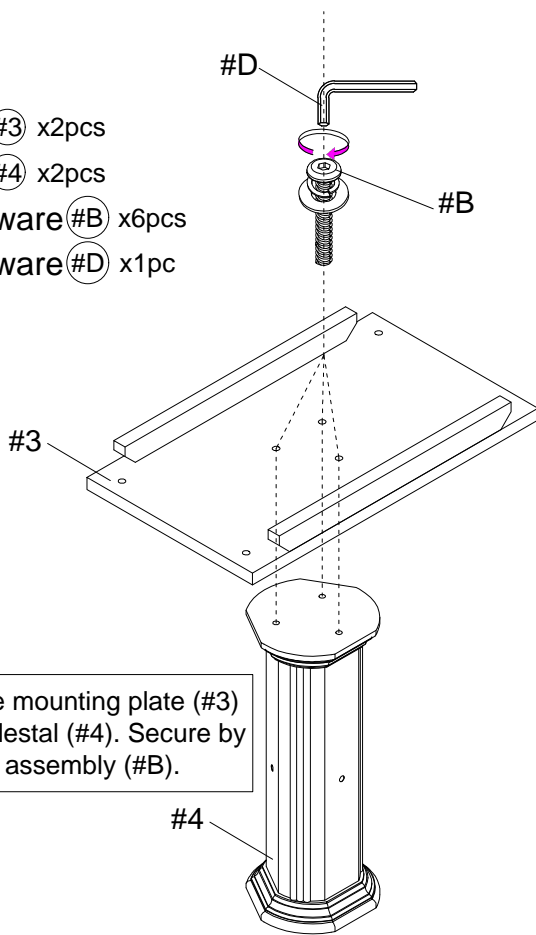

Attach the mounting plate (#3) to the pedestal (#4). Secure by using bolt assembly (#B).

2

Part #4 x2pcs
Part #6 x2pcs
Hardware #A x6pcs
Hardware #D x1pc

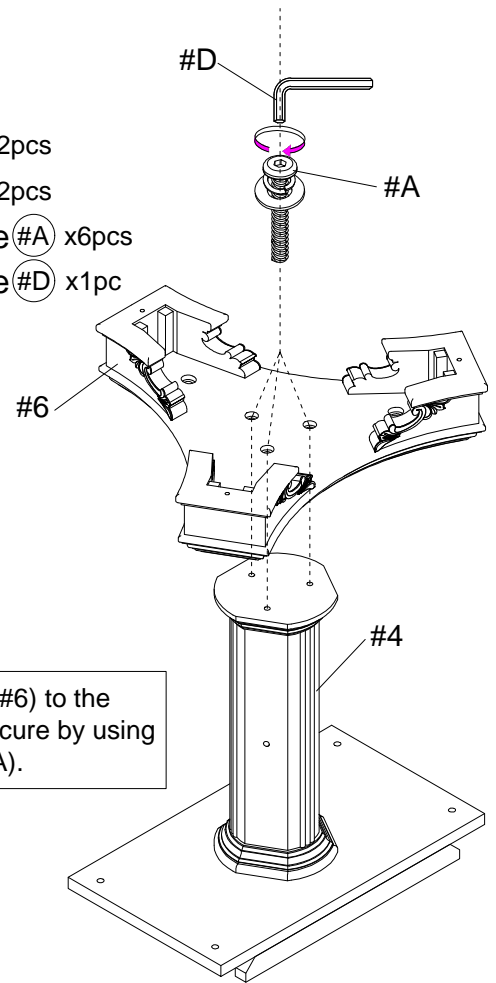

Attach the base (#6) to the pedestal (#4). Secure by using bolt assembly (#A).

3

Part #4 x2pcs
Part #5 x6pcs
Part #6 x2pcs
Hardware #A x6pcs
Hardware #C x6pcs
Hardware #D x1pc

3-1 Attach the leg (#5) to the base (#6). Secure by using bolt assembly (#A).

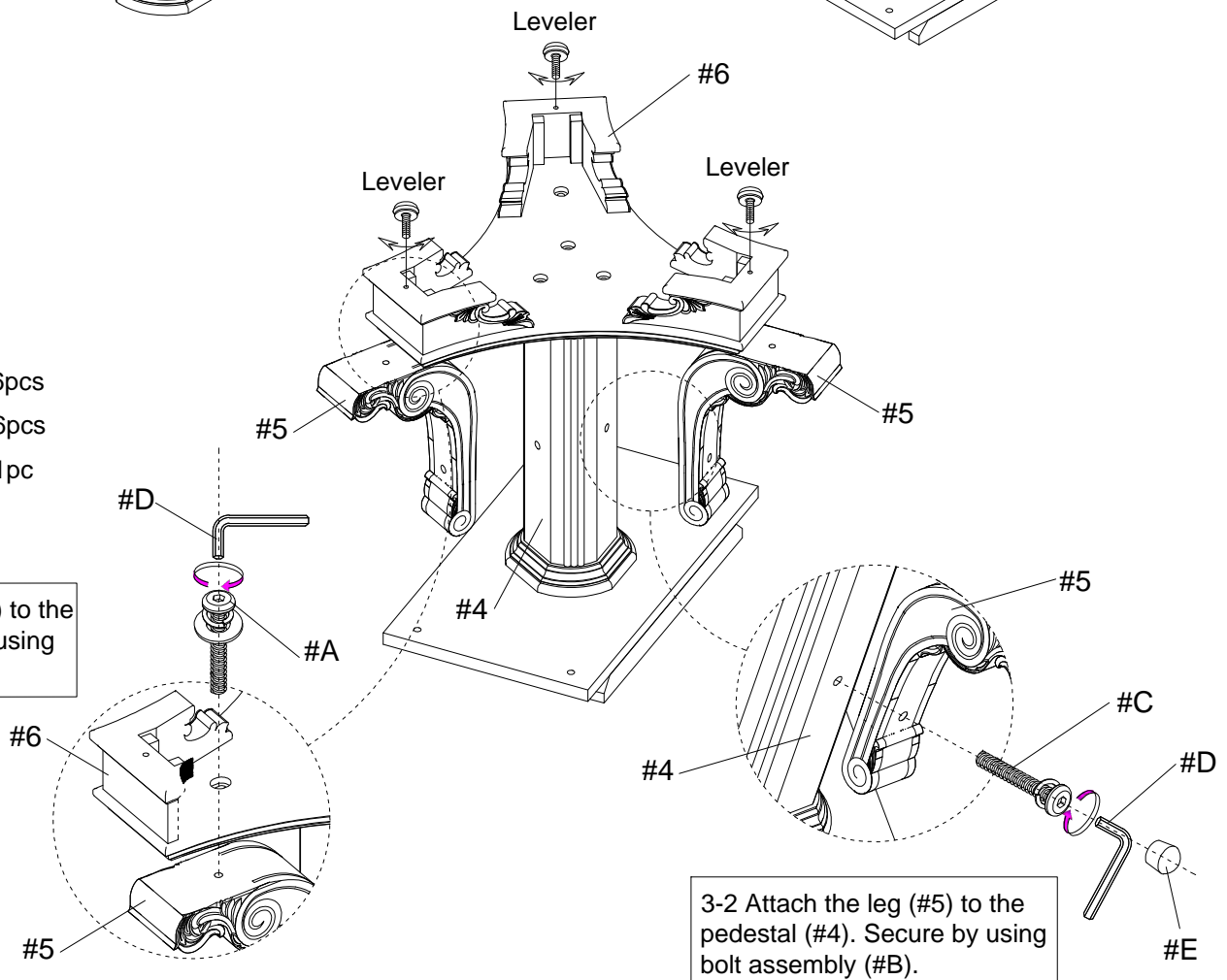

3-2 Attach the leg (#5) to the pedestal (#4). Secure by using bolt assembly (#B).

ASSEMBLY INSTRUCTIONS

4

Part #1 x1pc

Part #3 x2pcs

Hardware #B x8pcs

Hardware #D x1pc

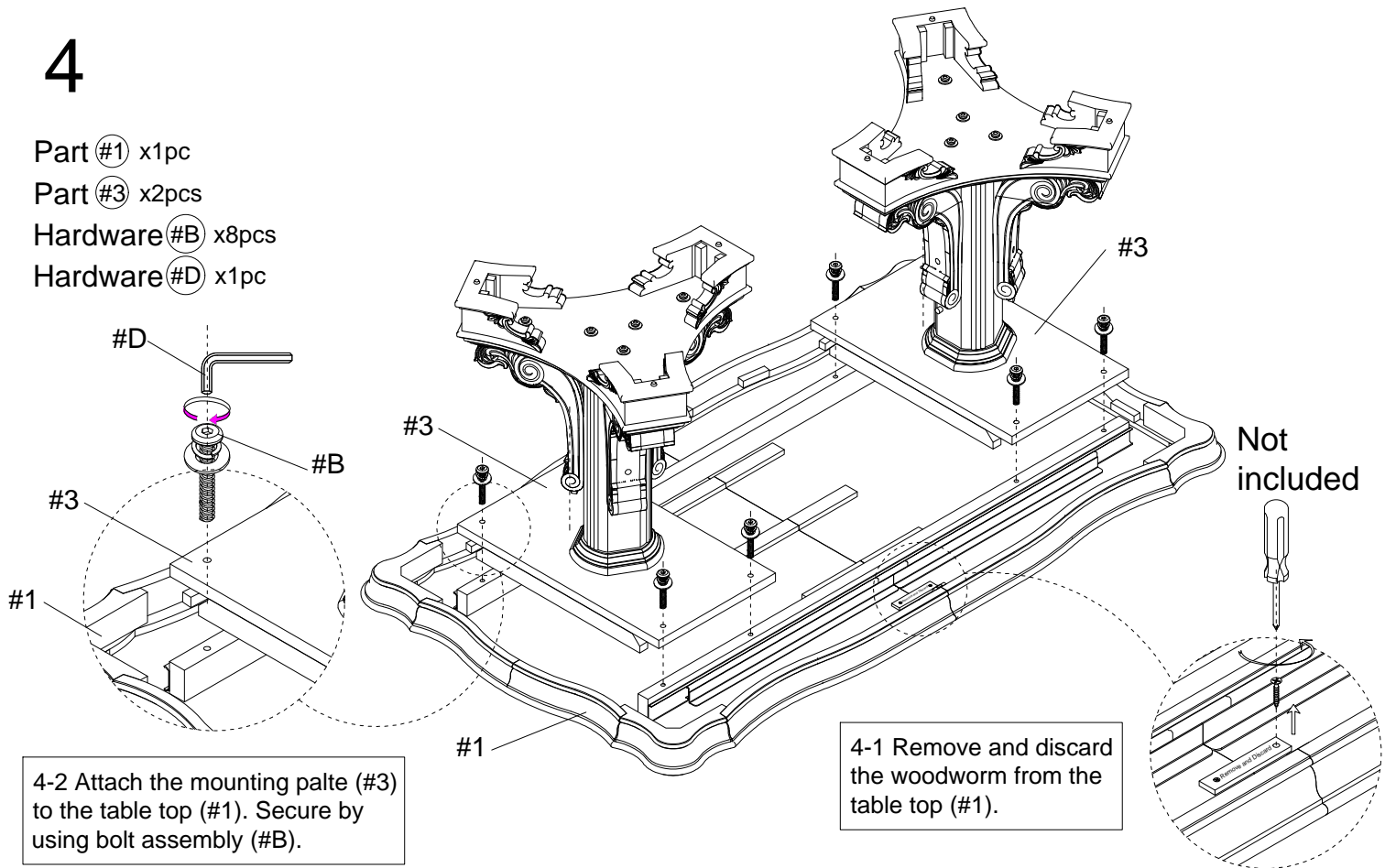

5

OPTION 1: Use only the table top.

Part #1 x1pc

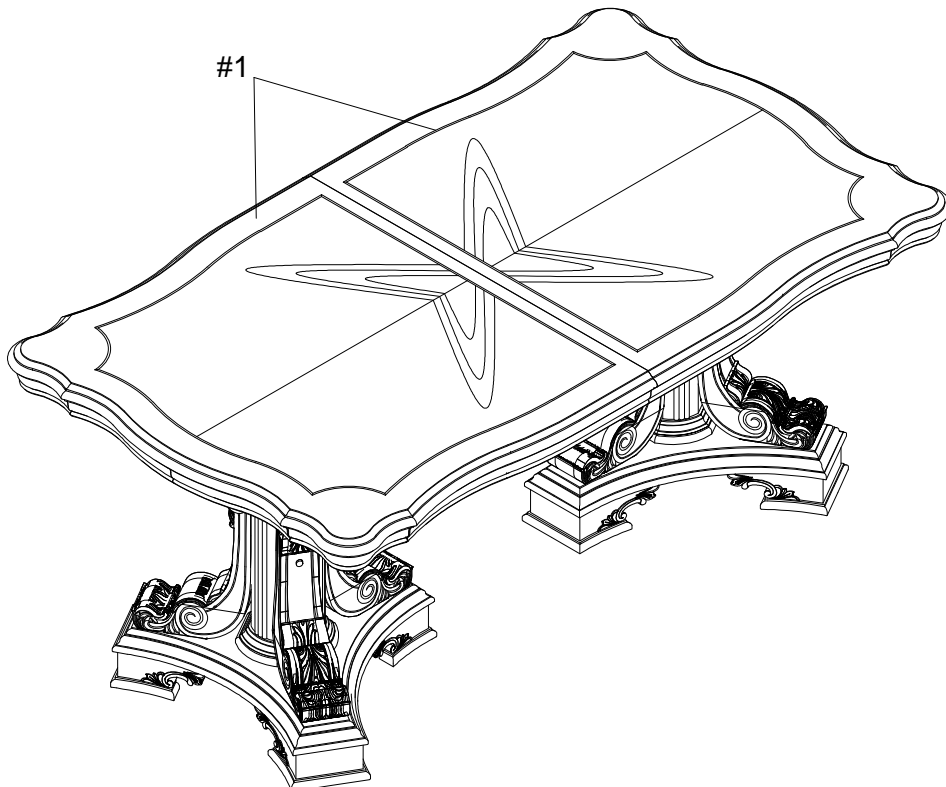

ASSEMBLY INSTRUCTIONS

6

OPTION 2: With one leaf only.

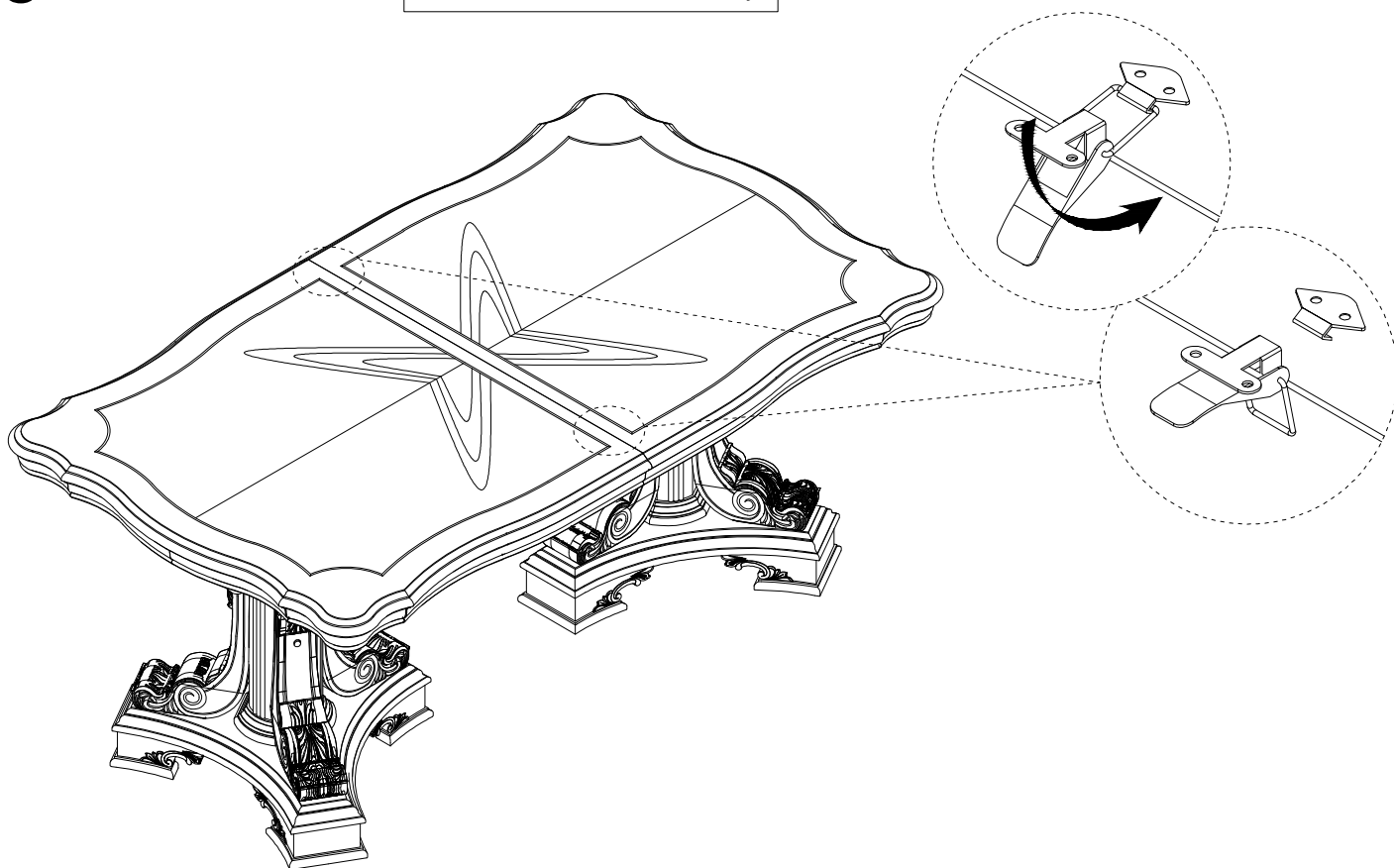

7

Part #1 x1pc

Part #2 x1pc

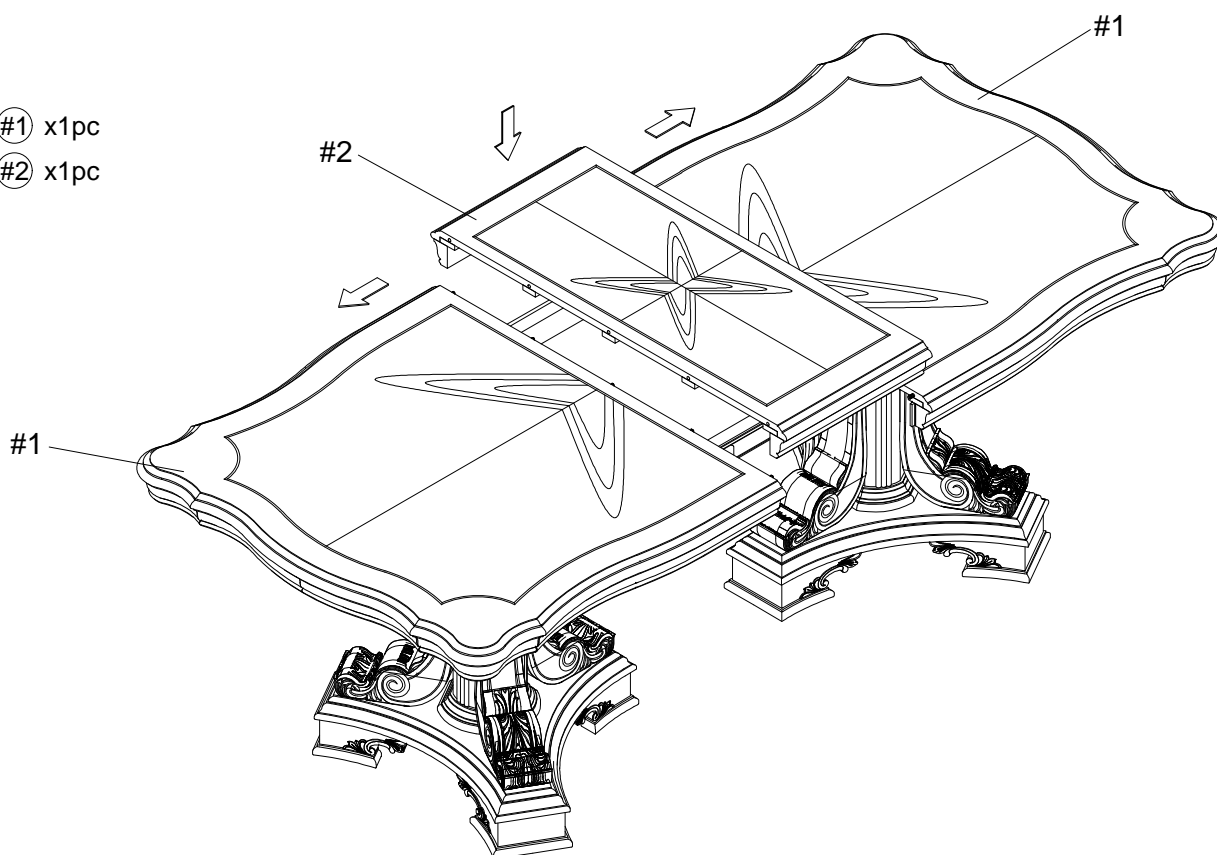

ASSEMBLY INSTRUCTIONS

8

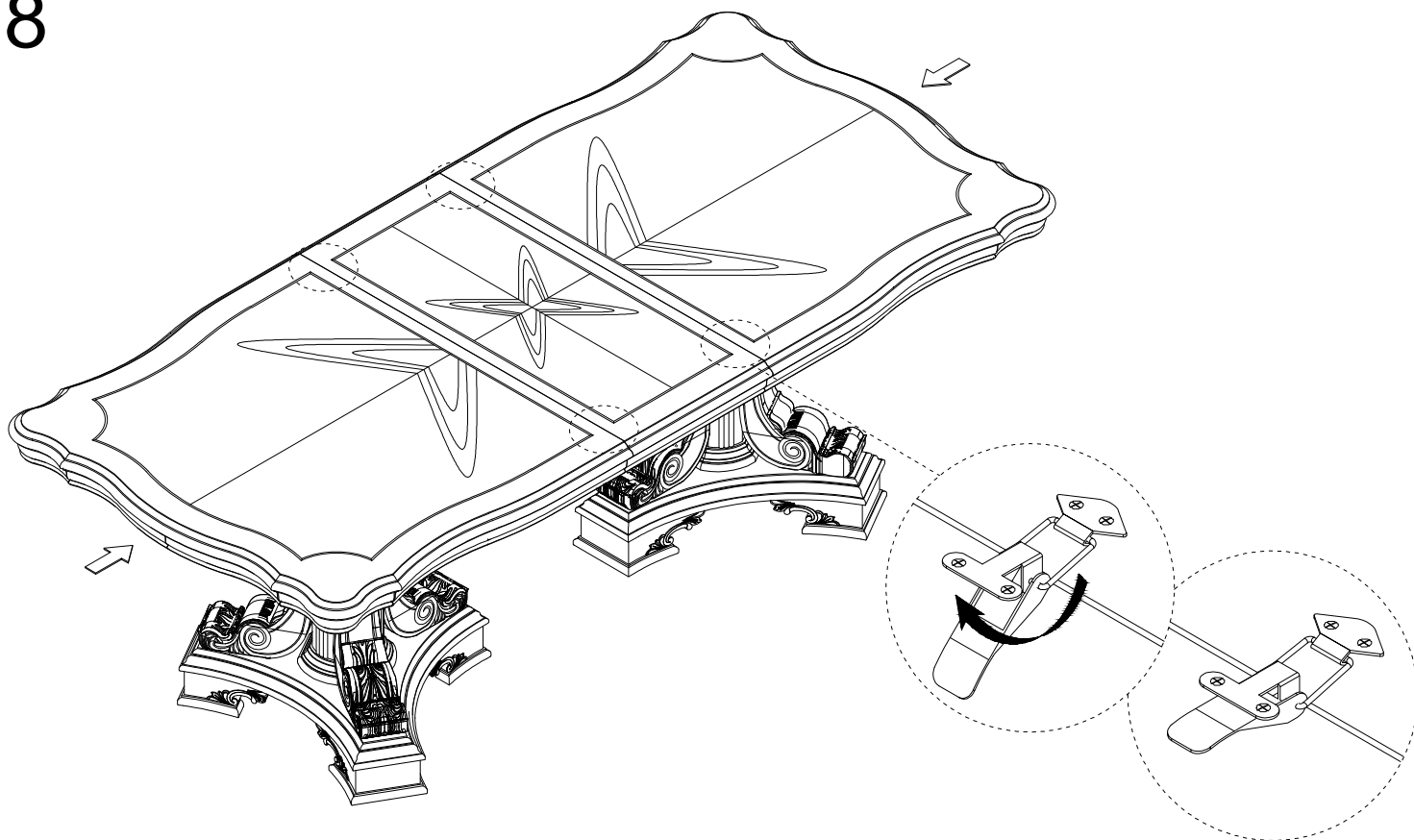

9

OPTION 3: When using two leaves.

Part #1 x1pc

Part #2 x2pcs

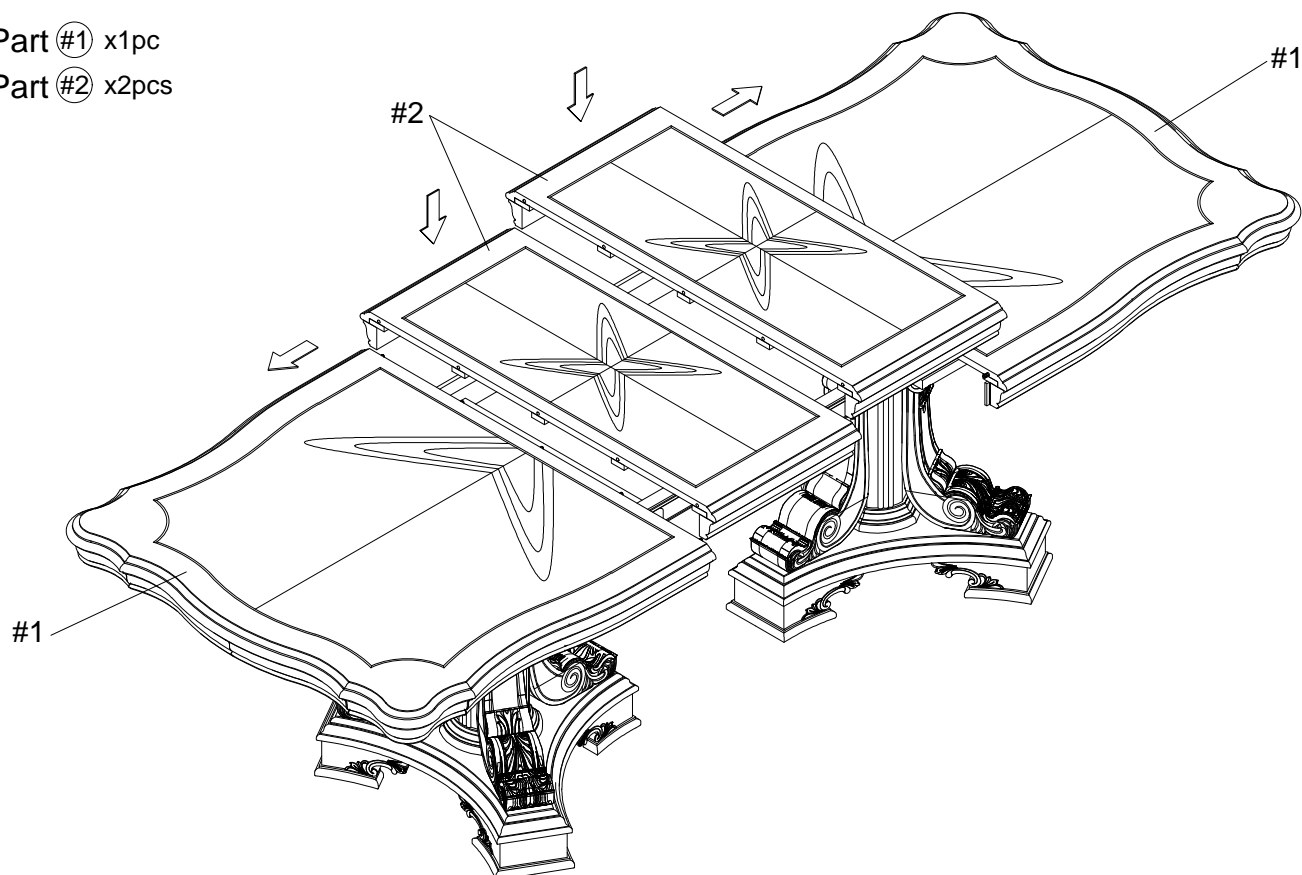

ASSEMBLY INSTRUCTIONS

10

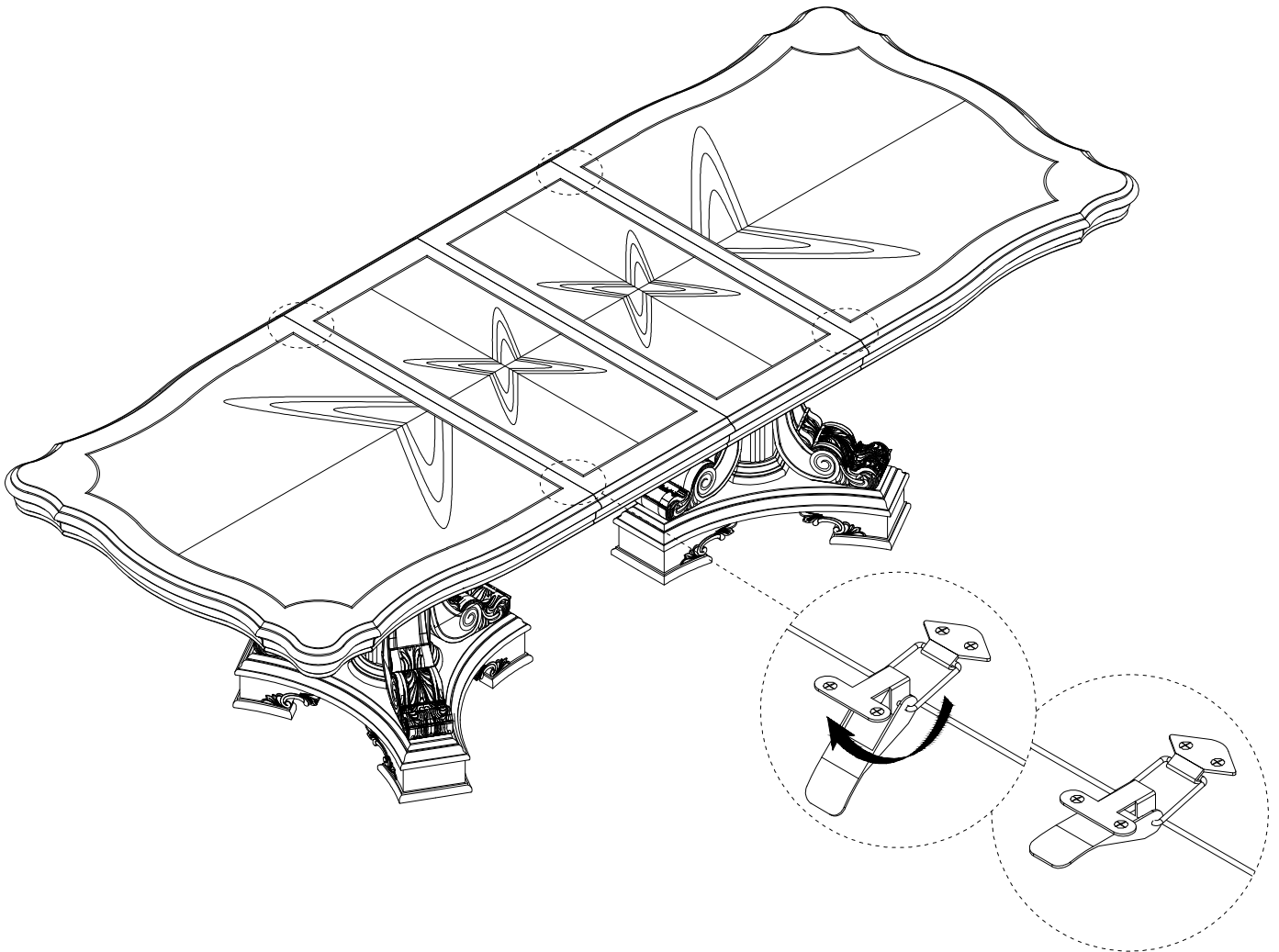

ASSEMBLY COMPLETED



Please ensure the furniture rests on an even and flat surface. If the product wobbles or feels loose, double-check all bolts and/or screws are properly tightened and secured.



Keep this handy!

Please retain this instruction manual and any order-related information for future reference.



Lift, don't drag!

To avoid damage to product please always LIFT the product when transporting or adjusting the placement.

This product is intended for RESIDENTIAL USE ONLY and not for commercial use.