

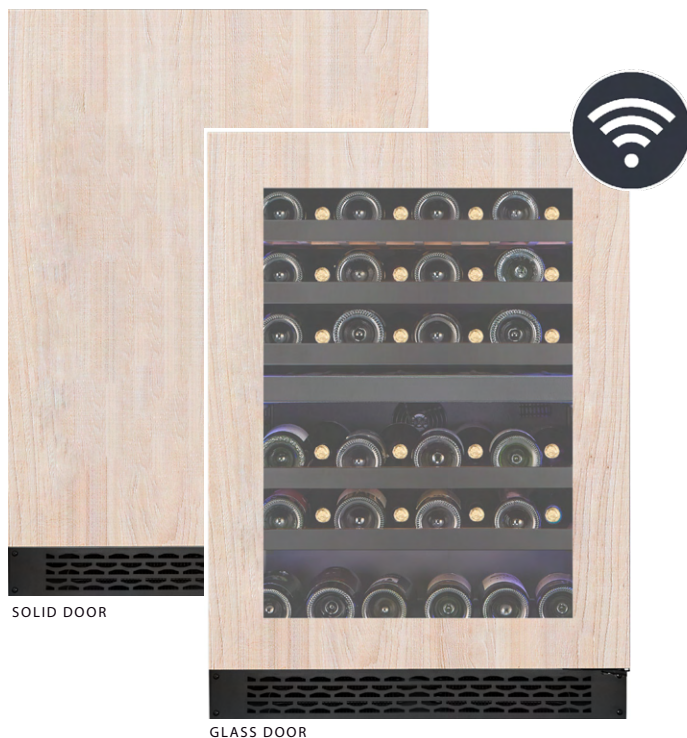

WINE CELL'R™

Titanium



5-YEAR WARRANTY ON
COMPRESSOR AND
EVAPORATOR



MODEL

WC46DZPRV1

PANEL READY

TECHNICAL FEATURES

CAPACITY	46 bottles*
TEMPERATURE ZONE	2 zones
TEMPERATURE	Top 5-20°C / Bottom 5-20°C
DIMENSIONS	H 34 1/8" X W 23 13/16" X D 23 9/16" H 867mm X W 605mm X D 599mm
BUILT-IN DIMENSIONS	H 34 1/4" X W 23 15/16" X D 24 1/2" H 870mm X W 608mm X D 623mm
WEIGHT	141 lbs / 64 kg

SPECIFIC FEATURES

PROFESSIONAL USE	Yes
BUILT-IN OR FREE STANDING	Yes
CHARCOAL FILTER	Yes (2)
UV GLASS DOOR	Panel Ready technical door
REVERSIBLE DOOR	Yes
HINGES	100% flush-fit clearance
CONTROL	Electronic
WIFI CONNECTIVITY	Yes
LIGHTING	White and blue LED stripes
SHELVES	5 in wood
SHELVES FINITION	Glossy black aluminum fronts
SHELVES OPENING	90%
EXTENSIBLE BALL-BEARING SHELVES	Yes
CABINET COLOR	Black
VENTILATION GRILL	Black
COMPRESSOR	Embraco (Inverter)
EVAPORATOR	Double in copper
PART & LABOR WARRANTY	2 years
COMPRESSOR AND COPPER EVAPORATOR WARRANTY	5 years part only

* Capacities are approximate and calculated with bordeaux bottles type.



CAPACITY



IDEAL FOR
PROFESSIONAL



BUILT-IN



2 CHARCOAL
FILTERS



SECURITY
LOCK



LED
LIGHTING



EXTENSIBLE
SHELVES



AIR CIRCULATION
FAN



WIFI



BENEFITS OF THE WC46DZPRV1



CUSTOMIZABLE

- **Panel Ready™ door:** Create a unique wine cellar! Customize the finish of your door (glass or solid) for a look that perfectly complements your cabinets. **(Wood panel not included)**
- **Ventilation grid:** Perfect integration guaranteed! Choose our classic black metal grille, or customize it to match your cabinets for a touch of elegance.
- **LED strips:** Enhance your wine cellar! Choose from 5 color intensities (blue or white) to create a sophisticated, personalized ambience.

ADVANCED TECHNOLOGY

- **Dual copper evaporators:** For fast and even cooling. In addition, each compartment has an independent charcoal filter for unsurpassed air purity.
- **WIFI connectivity:** Control your cellar remotely with Wi-Fi connectivity. Adjust the temperature and lighting to suit your preferences.
- **Embraco Inverter compressor:** For reduced energy consumption. Energy Star certified.



DESIGN

- **46-bottle 2-zone wine cellar:** Taste to your heart's content! Our 2 independent temperature zones preserve your red and white wines to perfection.
- **Ball-bearing shelves:** Access your entire collection in the blink of an eye. Our shelves glide smoothly, revealing approximately 90% of your bottles.
- **Control panel:** Simplicity and safety. Set the temperature precisely with our intuitive digital panel.



On the EMBRACO compressor & copper evaporator



Parts & labor

DIMENSIONS

FRONT

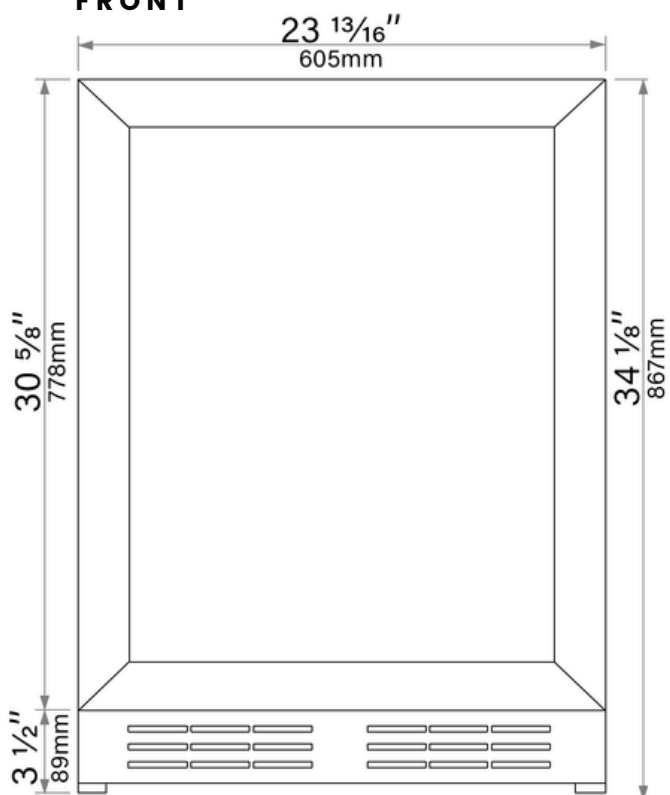

TOP

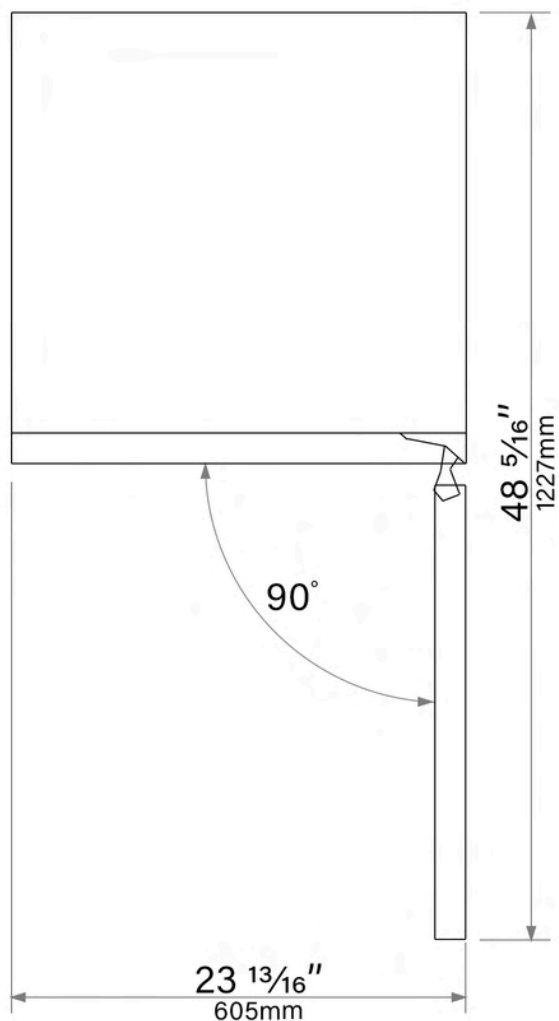

SIDE

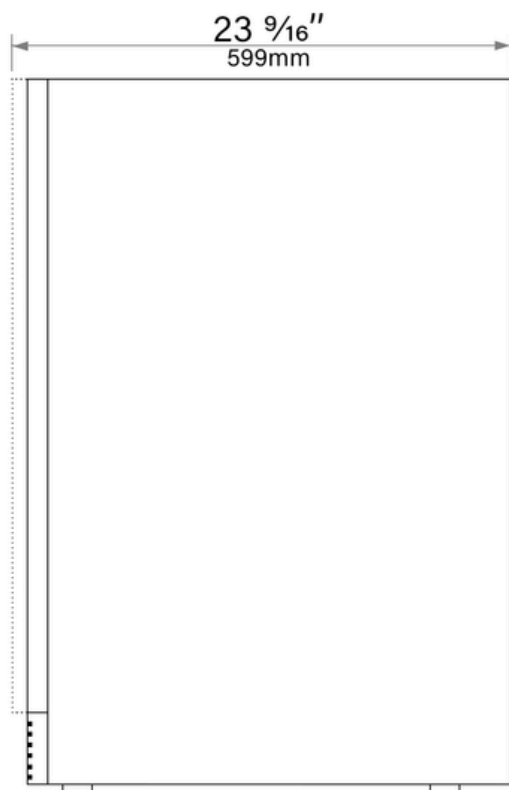

"PANEL READY" FRAME

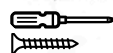
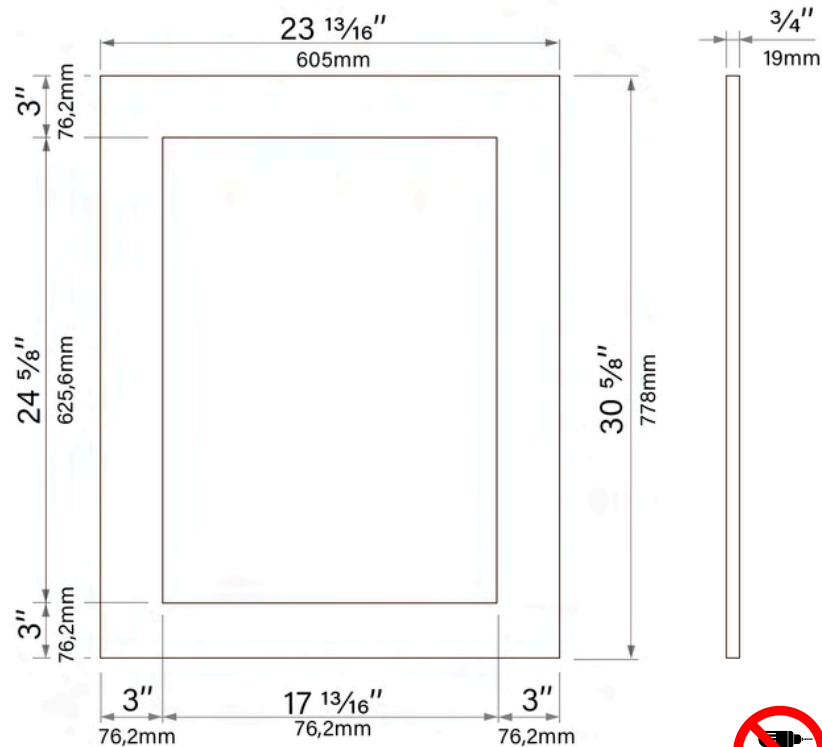

*Six (6) $1 \frac{3}{8}"$ screws required for panel installation.



