

# ASSEMBLY INSTRUCTION

MODEL : 38165 TRUNDLE BED (990 x 1880)MM

ACME FURNITURE

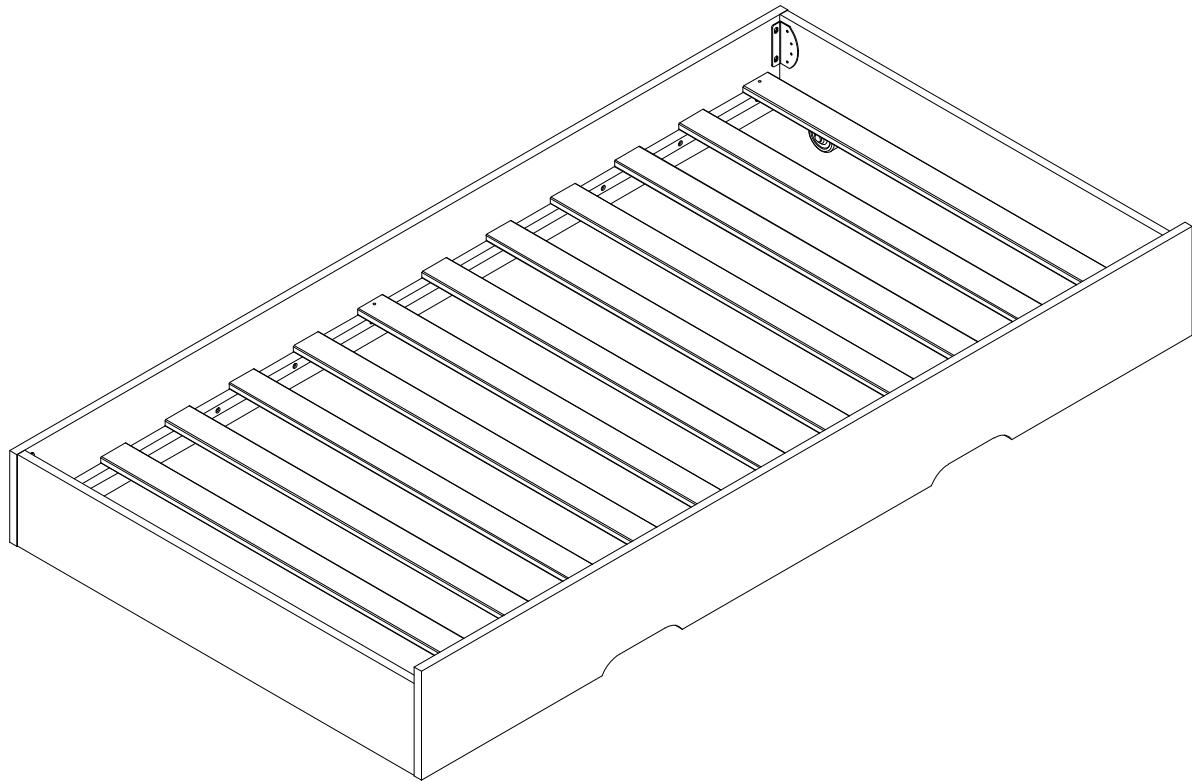

## HARDWARE LIST

A

8 PCS



JCBB BOLT (M8 x 16MM)

B

6 PCS



CSK C/B SCREW (M4 x 32MM)

C

1 PC

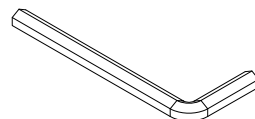

ALLEN KEY (M5 x 60MM)



*Do not recommend the use of power drills/drivers for inserting bolts/screws as this could damage the unit.*

**Tools Required :**  
Crosshead Screw Driver

## PART LIST

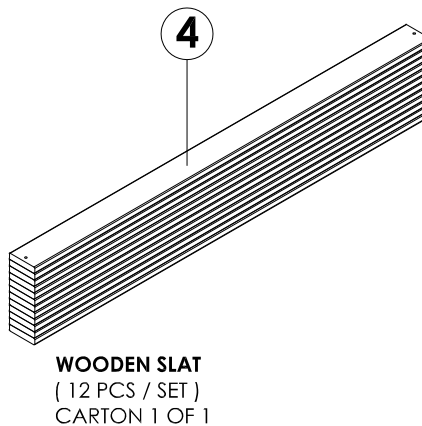
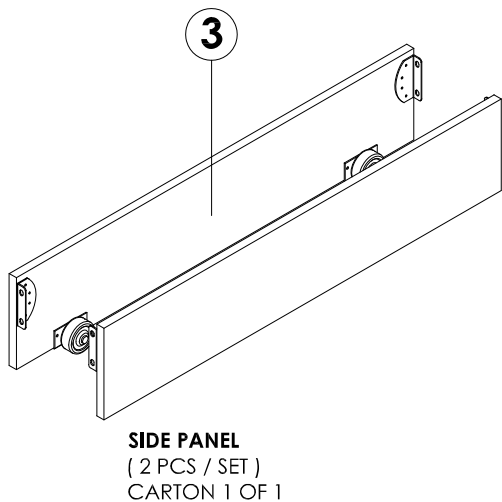
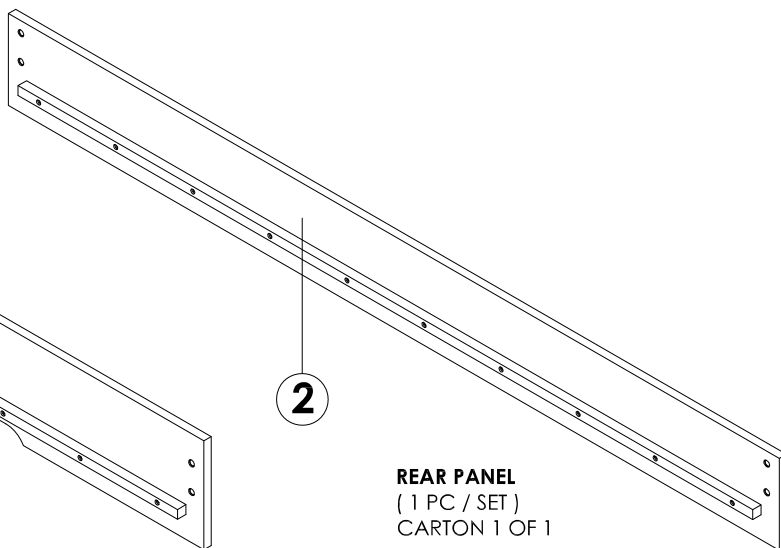
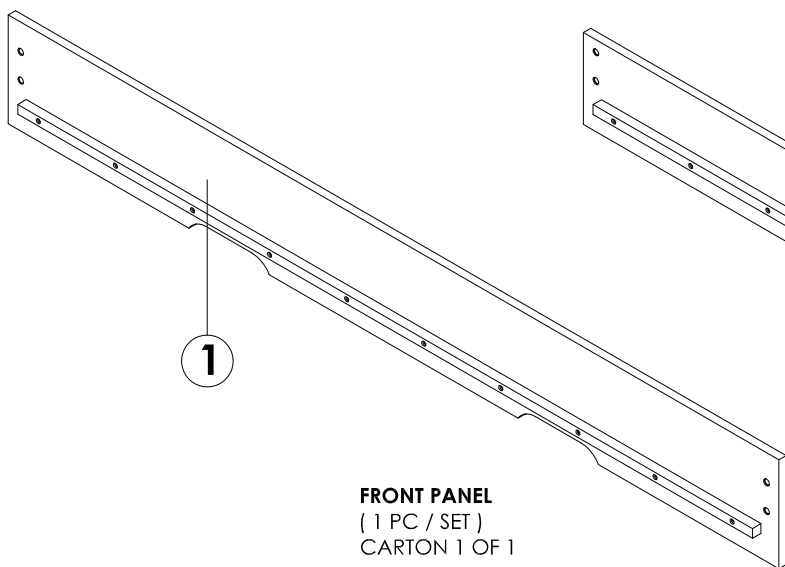

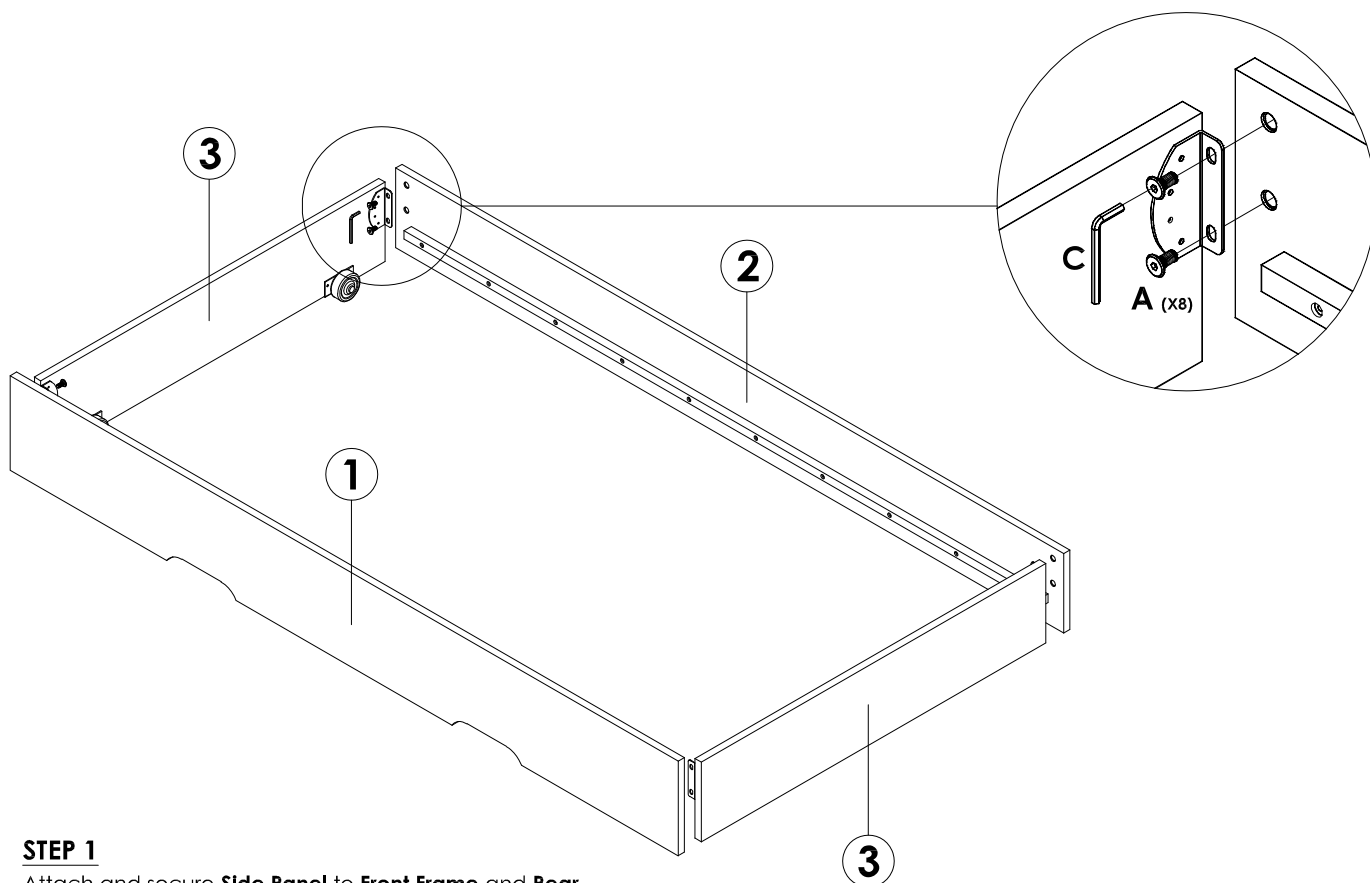

### STEP 1

Attach and secure **Side Panel** to **Front Frame** and **Rear Frame** by using hardware **(A)**, tighten it up by using **(C)**.

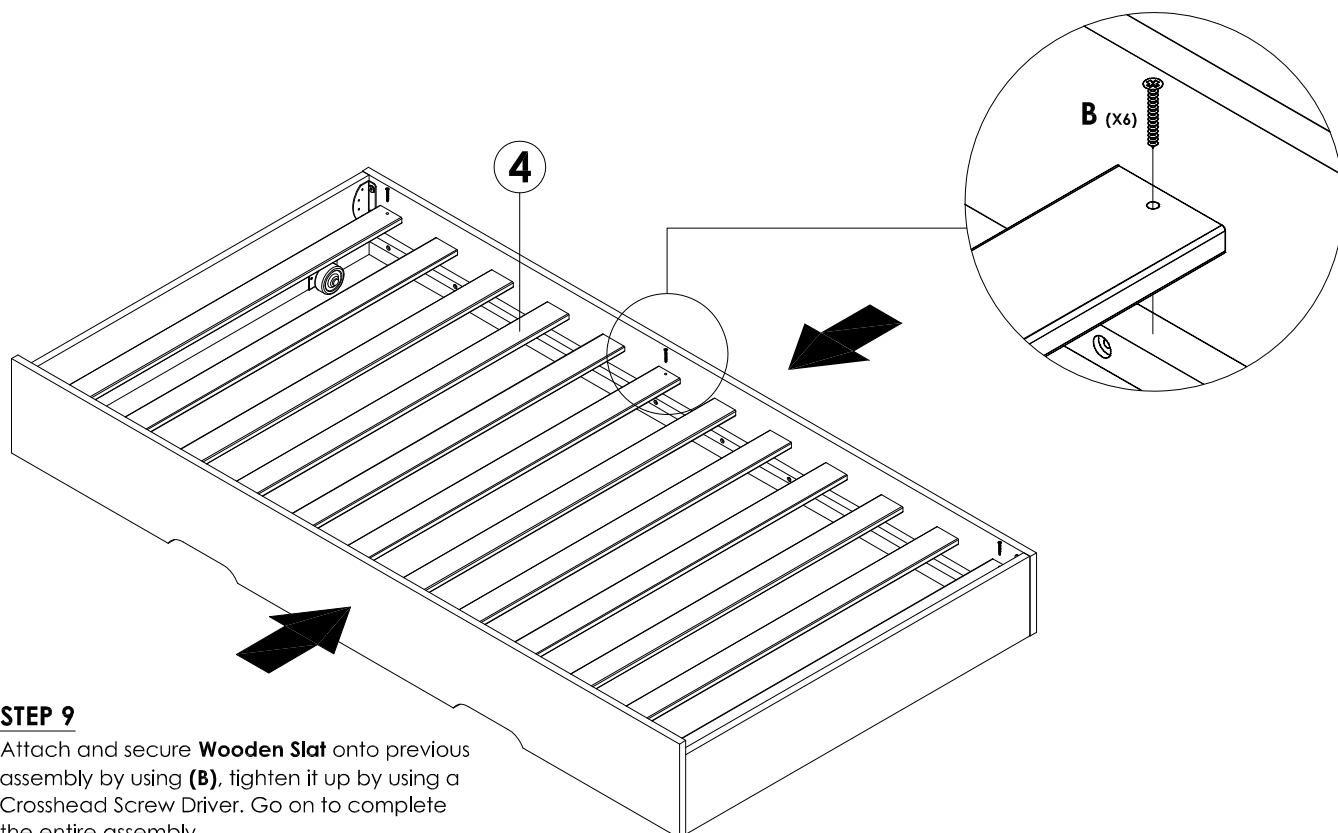

### STEP 9

Attach and secure **Wooden Slat** onto previous assembly by using **(B)**, tighten it up by using a Crosshead Screw Driver. Go on to complete the entire assembly.

\* Align both **Front Frame** and **Rear Frame** before tightening the screws.