

# CLA-5423-101-121 QUEEN / KING BED

## CARACOLE CLASSIC

### ASSEMBLY INSTRUCTIONS

TWO (2) PEOPLE AND SCREWDRIVER REQUIRED

PLEASE UNPACK ALL PARTS AND CHECK AGAINST PARTS LIST ON THIS INSTRUCTION SHEET BEFORE DISCARDING PACKING AND CARTON!!

- 1) Connect the side rails (3) and headboard (1)/ footboard (2) by bolt (F) , using the curved washer (A), lock washer (B), flat washer (C) and nut (D) tighten with wrench provided (E), as shown in Diagram A . (On inside face of Headboard and Side rails notice A and B , need assembly correct position A-A , B-B)
- 2) We can take out or assemble the adjustable wooden " U " cleat on HB & FB and the adjustable cleat on side rail (3) for suitable for use purpose ,through the lower holes and the upper holes loosen then tighten by Allen Wrench provided (G), as shown in DiagramB1,B2,B3.  
(Note: HB/FB adjustable wooden " U " cleat , loosen then tighten by Allen Wrench provided
- 3) On inside face of both Headboard (1) and footboard (2) are pre-installed wooden cleat for center support rail (5).  
Set the support slat (5) on the wooden brackets, as shown in Diagram C.
- 4) On inside face of both side rails (3) are cavities designed to hold the slats (4). Set the slats (4) on both sides of the side rails (3) using short screws (G) tighten by the screwdriver (not included), as shown in Diagram D.

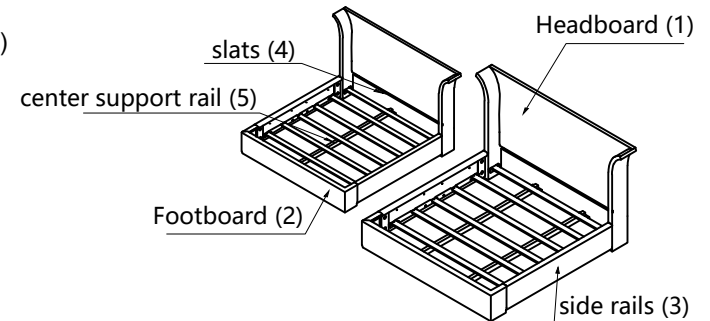

\*\*\* NOTE KEEP THIS SHEET!!! \*\*\*

In the unlikely event that you would need a replacement part for your furniture, please contact your local authorized Caracole International dealer. If you need replacement hardware quickly, it could be purchased from your local hardware store.

Part Description	CLA-5423-101		CLA-5423-121	
	QN BED		KG BED	
Part No.	QTY	Part No.	QTY	
1 Headboard	CLA-5423-101-H 1 (pc)	CLA-5423-121-H	1 (pc)	
2 Footboard	CLA-5423-101-F 1 (pc)	CLA-5423-121-F	1 (pc)	
3 Side rail	CLA-5423-101-R 2 (pcs)	CLA-5423-121-R	2 (pcs)	
4 Slats	CLA-5423-101-3067 5 (pcs)	CLA-5423-121-3067	5 (pcs)	
5 Center Support Rail	CLA-5423-101-30447 1 (pc)	CLA-5423-101-30447	2 (pcs)	
6 Assembly Hardware (1)	CLA-5423-101-3001 1 (pc)	CLA-5423-101-3001	1 (pc)	
7 Adjustable Wooden Bracket	CLA-5423-101-30441 8 (pc)	CLA-5423-121-30441	8 (pc)	

RTA Hardware (1) For Side rail and slats of KB and QB		
NO.	Hardware List	Qty
A	Curved Washer(5/16" Ø28x15x76mm)	8 (pcs)
B	Lock Washer (5/16"x13mm)	8 (pcs)
C	Flat Washer (5/16"x16x2mm)	8 (pcs)
D	Nut (5/16"x12mm)	8 (pcs)
E	Wrench (5/16") 88x12mm	1 (pc)
F	Bolt (5/16"x90mm)	8 (pcs)
G	Allen Key (59x23x4mm)	1 (pc)
H	Screws(#8x1-1/8")	10 (pcs)

Created on: 2023-06-28

## Step 1.

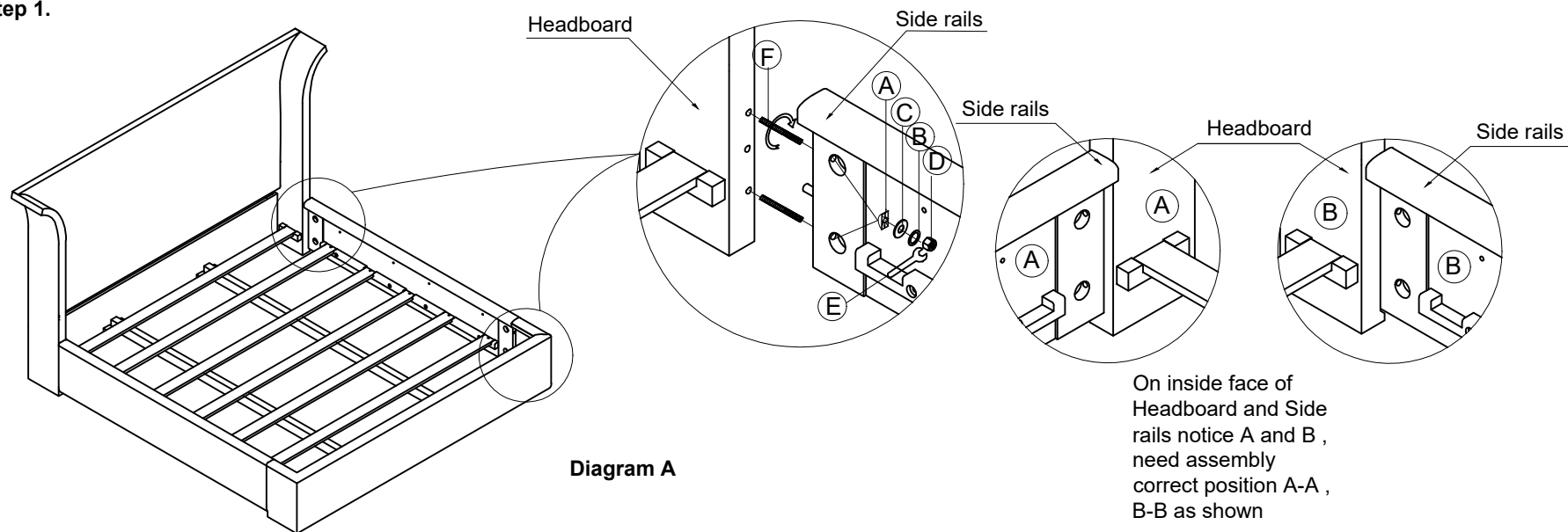

## Step 2.

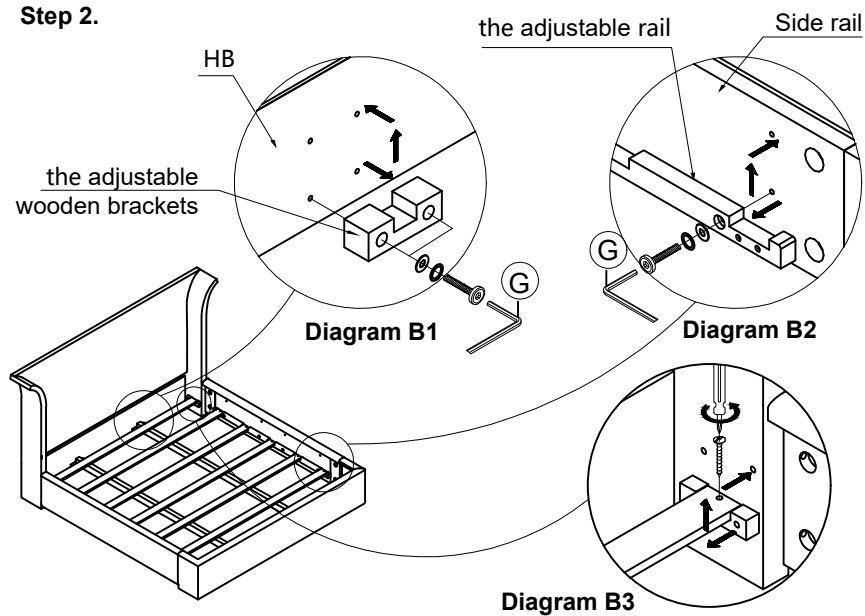

## Step 3.

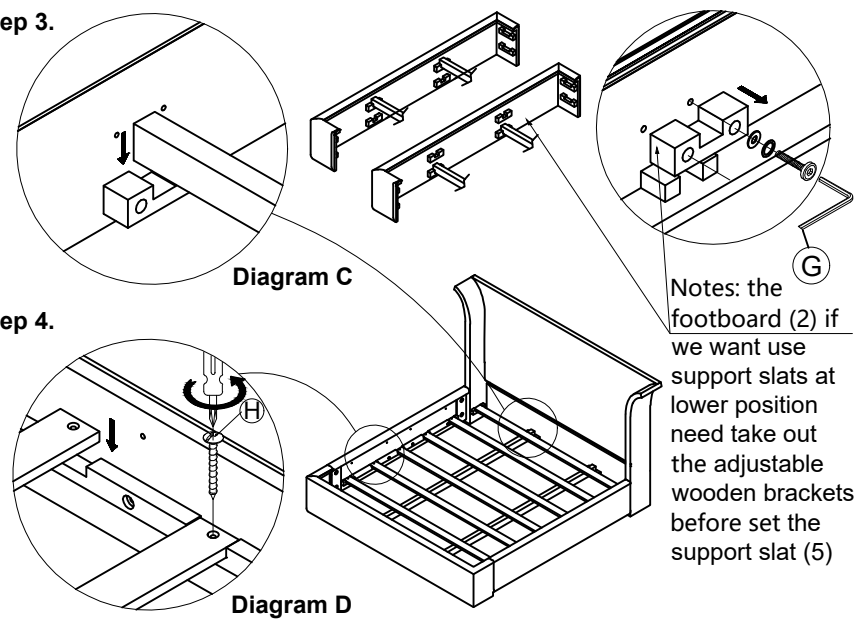

## Step 4.

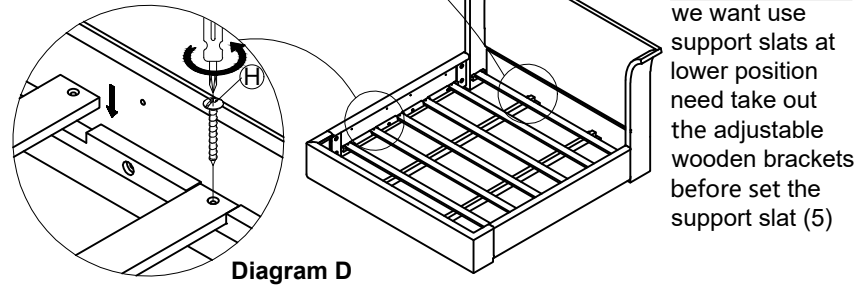

# BED MATTRESS DIAGRAM

## BEDDING SPECIFICATIONS

**CLA-5423-101** Dimension of the true mattress opening:  $81\frac{3}{4}" \times 62"$

Bed slats:  $64\frac{1}{2}" \times 3\frac{1}{4}" \times \frac{3}{4}"$

**CLA-5423-121** Dimension of the true mattress opening:  $81\frac{3}{4}" \times 78"$

Bed slats:  $80\frac{1}{2}" \times 3\frac{1}{4}" \times \frac{3}{4}"$

Side rail width:  $2\frac{3}{4}"$

Height from the floor to bottom of the side rail:  $1\frac{1}{2}"$

Height from the floor to top of slat: 6" (for low setting) or 12" (for high setting)

Height from the top of slats to top of side rail:  $9\frac{1}{2}"$  (for low setting) or  $3\frac{1}{2}"$  (for high setting)

Height from the top of side rail to bottom of headboard pad: 0

Be sure to adhere to these BEDDING SPECIFICATIONS in order to avoid the possibility of faling or entrapment THESE SPECIFICATIONS MUST BE STRICTLY ADHERE TO!

