

# Installation Guide

Professional Wall Oven Accessory - Flush Mount Kit  
P301FTSSS | P301FTDSS

## Removing Existing Trim

1. Before the existing trim can be removed, the oven door must be removed and the oven removed from the cabinetry cutout for safe removal and installation of trim.

**NOTE:** See this appliance's installation guide for correct flush mount trim cabinet dimensions, blocking platform dimensions, and proper door removal instructions.

**CAUTION:** Make sure to use the included Door Hinge Pins. Not using the pins to hold the door hinge in place will result in severe injury.

2. Remove the existing side trim pieces from the oven. There should be one trim piece on each side of the oven.
3. There will be a trim piece at the top and bottom of the oven that will need to be removed. The door will need to be removed prior to removing the lower vent trim and putting on the new trim.

**NOTE:** Keep the screws that are noted after removing the existing side trim pieces. These screws will be used to install the flush mount accessory trim pieces.

### Single Oven

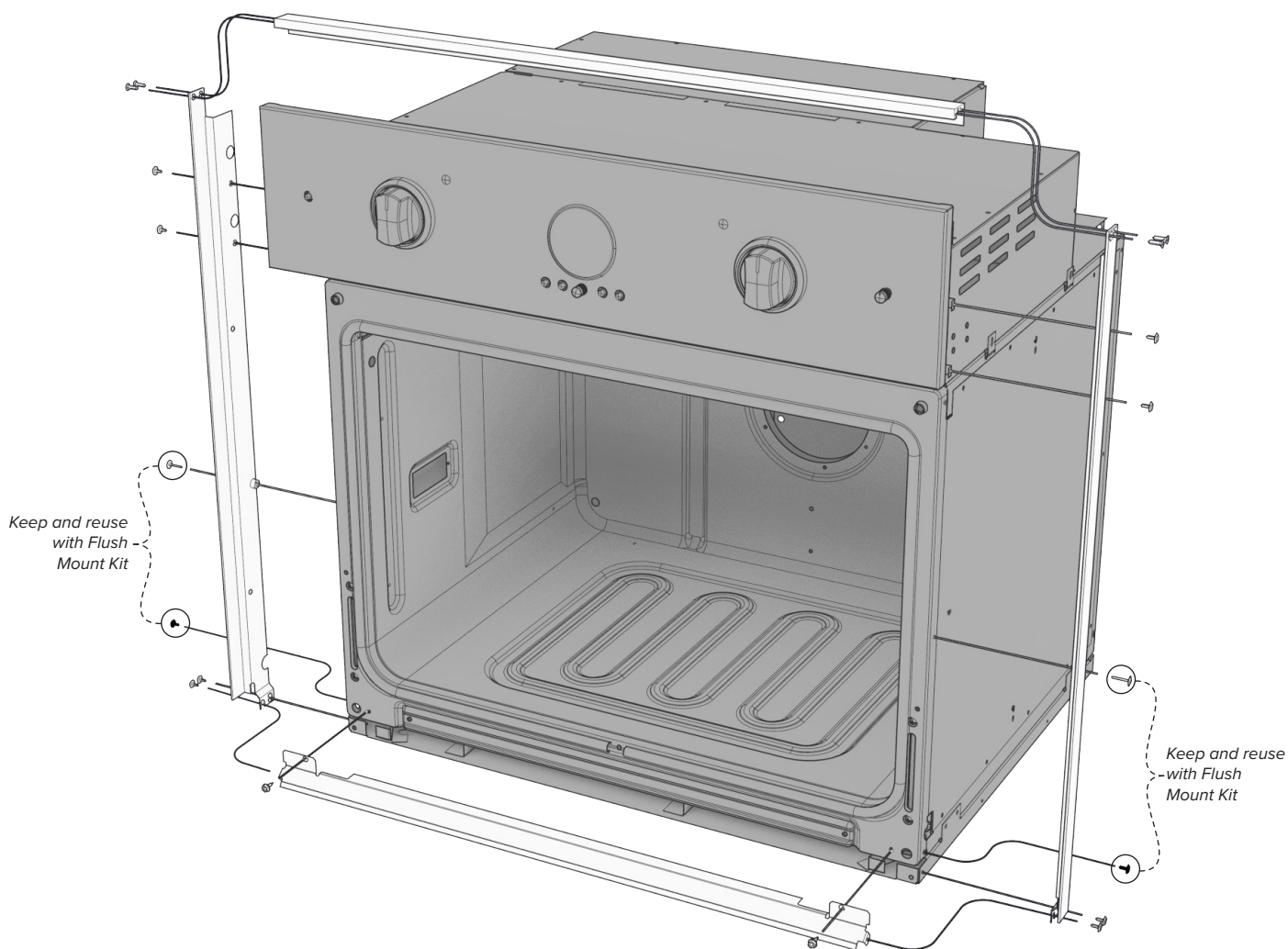

## Double Oven

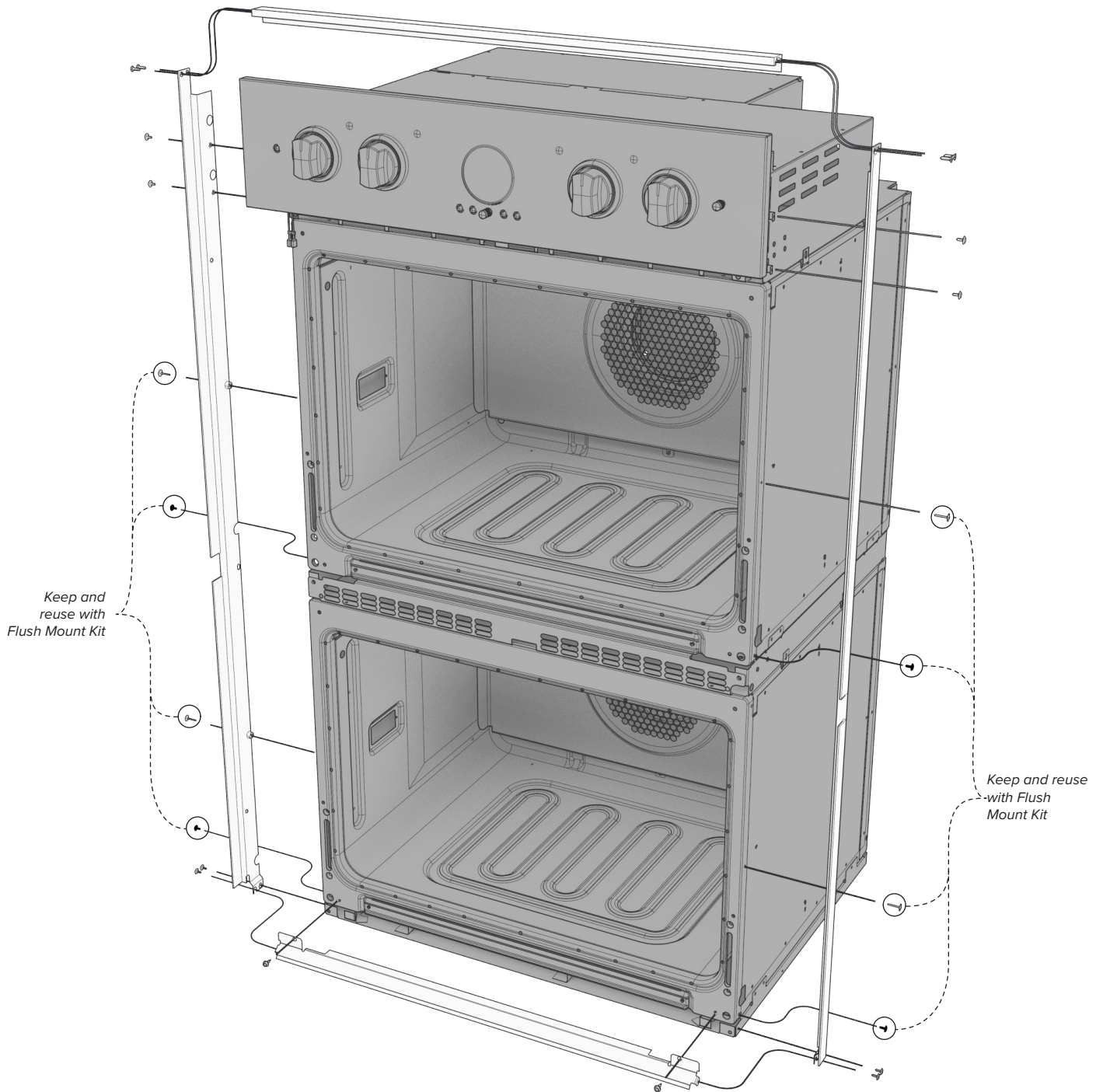

# Installing Flush Mount Trim

After removing the existing side pieces, install the flush mount trim pieces to the oven.

1. Remove the protective plastic from the flush mount trim pieces.
2. With the provided screws, attach the top trim to the two side trim pieces. (see diagram)
3. Place the assembled trim onto the oven. The trim is located by sliding the trim cutouts onto the tabs by the control panel on the oven. **NOTE: The left and right hand trim are not interchangeable. Install the corresponding trim piece on the correct side.**
4. Secure the left and right side trim in place with the screws kept from the previous trim kit.
5. Attach the bottom vent trim to the side trim and the oven chassis using the provided screws.
6. After installing the flush mount trim pieces, the oven can be reinstalled into the cabinet cutout.

**NOTE: Please make sure to refer to the appliance's installation guide for cabinet cutout and blocking platform dimensions for Flush Trim installations.**

7. Once the oven is reinstalled into the cabinet cutout, the door can be reinstalled onto the oven by following the removal directions in reverse order.

## Single Oven

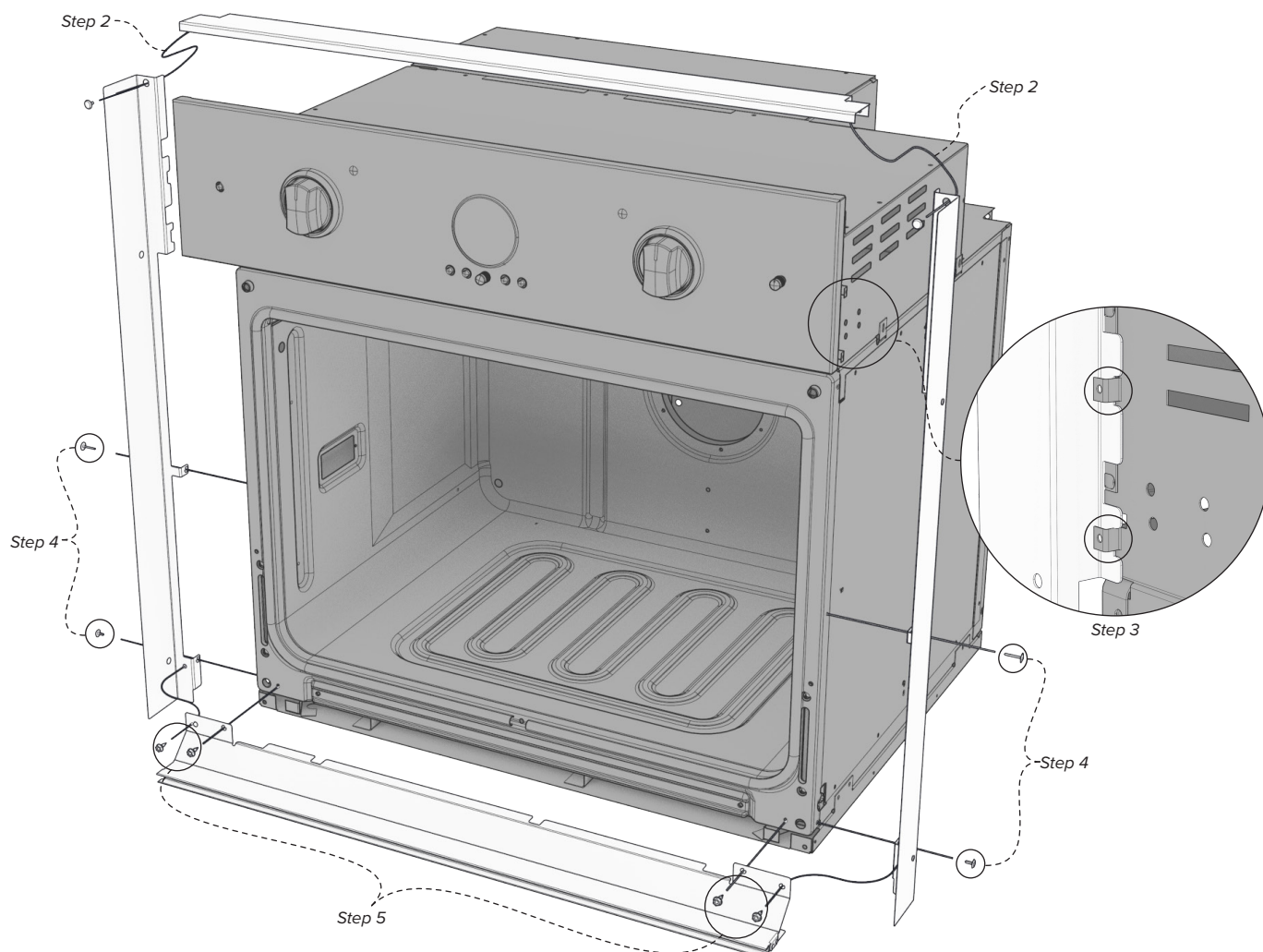



## Double Oven

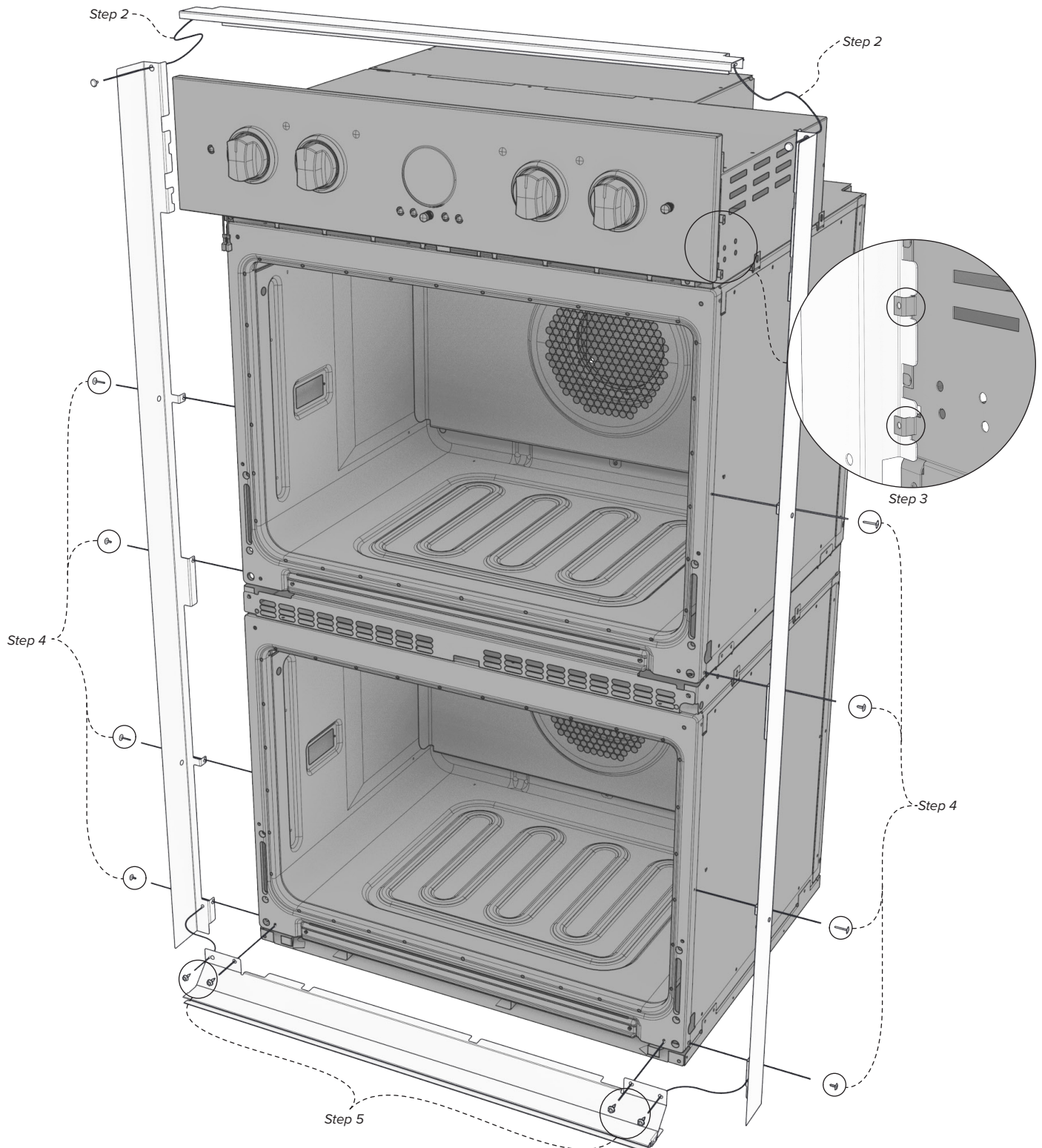

# CABINET DETAILS

## 30" Double Oven Flush Mount Installation

**NOTE:** French Door Models (VDOF301) cannot be installed as a flush mount due to needed allowance for door swing clearance.

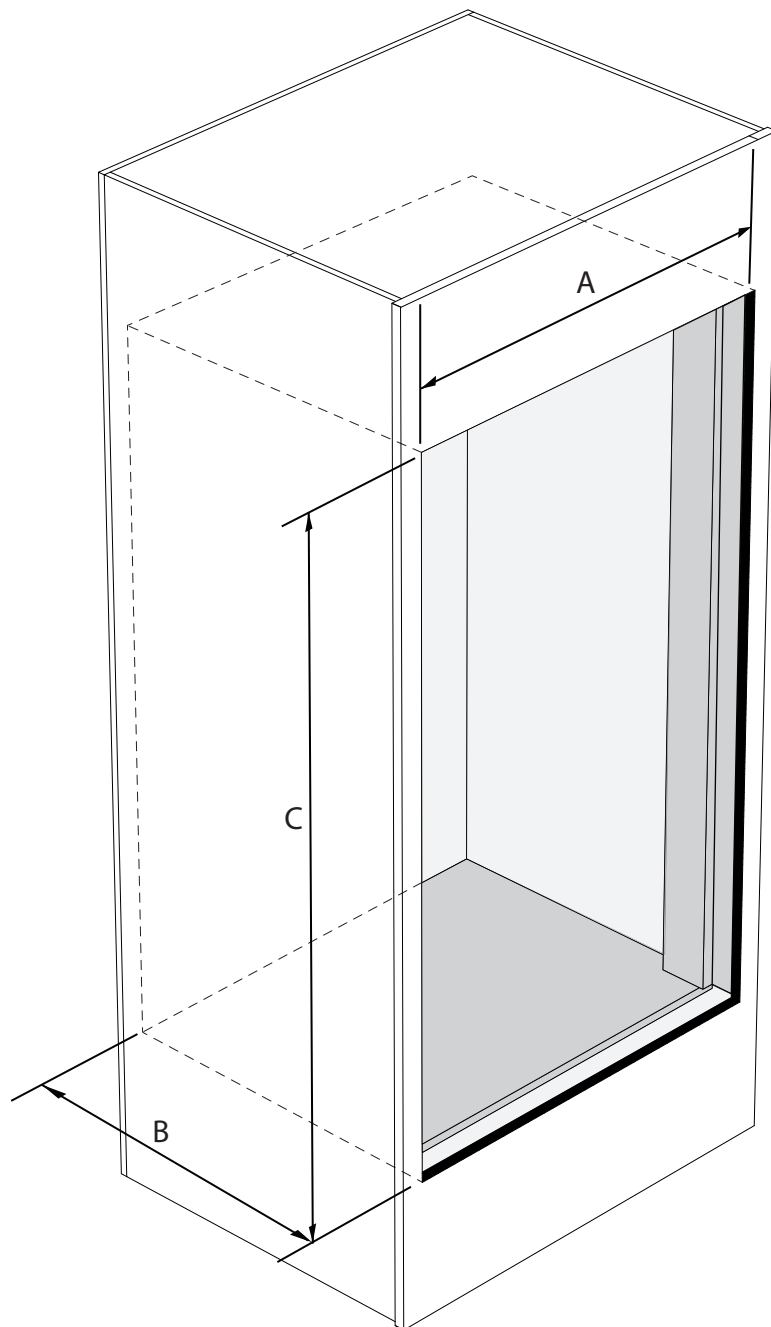

### Legend



Blocking



Finished Surfaces

### Double Oven Flush Cutout

A	29-15/16" (76.0 cm)
B	26" (66.0 cm)
C	52-13/16" (134.1 cm)

**NOTE:** To install the professional custom oven in a flush mount application the flush mount accessory kit is required.

## 30" Single Oven Flush Mount Installation

**NOTE:** French Door Models (VDOF301) cannot be installed as a flush mount due to needed allowance for door swing clearance.

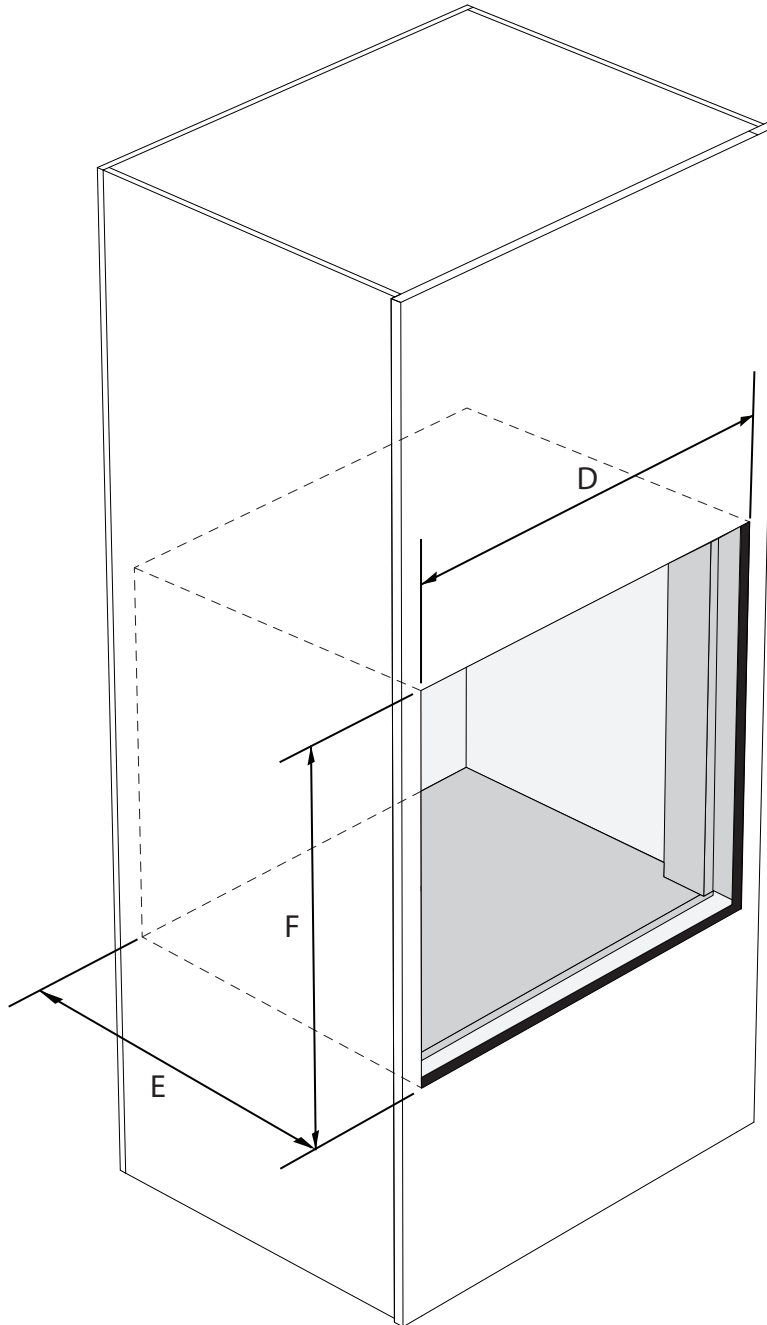

### Legend



Blocking



Finished Surfaces

### Single Oven Flush Cutout



D	29-15/16" (76.0 cm)
E	26" (66.0 cm)
F	30-5/16" (77.0 cm)

**NOTE:** To install the professional custom oven in a flush mount application the flush mount accessory kit is required.

# 30" Oven Flush Mount Installation

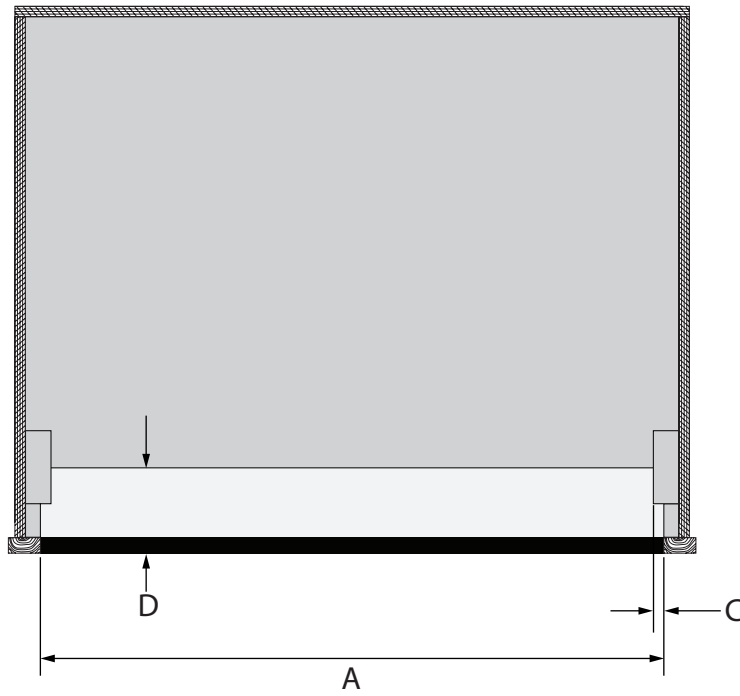
Top View



Legend	
	Blocking
	Finished Surfaces

Side View

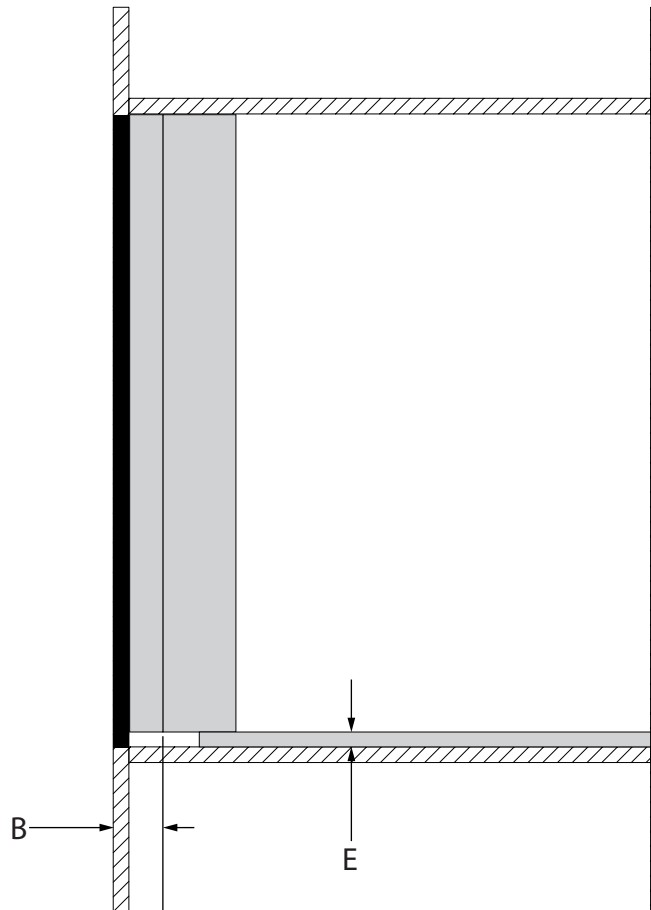

Critical Dimensions	
A	29-15/16" (76.0 cm)
B	2-5/8" (6.7 cm)
C	1/2" (1.3 cm)
D	3" (7.6 cm)
E	3/4" (1.9 cm)



# 30" Oven Flush Mount Installation

Top View

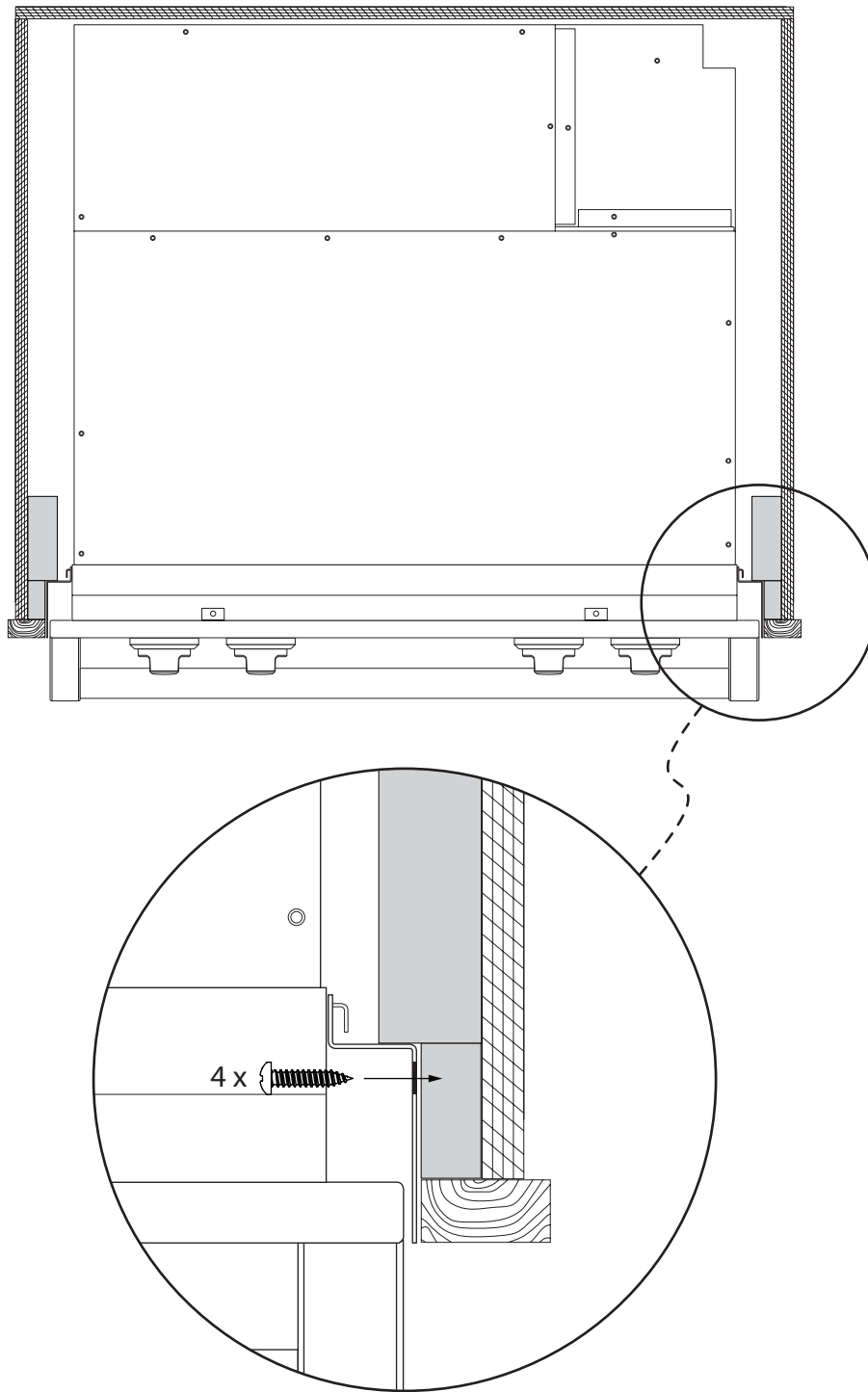

Secure the unit as shown above with the 4 included mounting screws through the mounting holes in the left and right side trim.

## Service Information

If service is required, call your authorized service agency.

Have the following information readily available.

- Model number
- Serial number
- Date purchased
- Name of dealer from whom purchased

Clearly describe the problem that you are having. If you are unable to obtain the name of an authorized service agency, or if you continue to have service problems, contact Viking Range, LLC at 1-888-845-4641, or write to:

**Viking Range, LLC**  
**PREFERRED SERVICE**  
**111 Front Street**  
**Greenwood, Mississippi 38930 USA**

Make a note of the information below. You'll need it if service is ever required.

Model no. \_\_\_\_\_ Serial no. \_\_\_\_\_

Date of purchase \_\_\_\_\_ Date installed \_\_\_\_\_

Dealer's name \_\_\_\_\_

Address \_\_\_\_\_

---

If service requires installation of parts, use only authorized parts to insure protection under the warranty.

## Notes

Viking Range, LLC  
111 Front Street  
Greenwood, Mississippi 38930 USA  
(662) 455-1200

For product information, call 1-888-845-4641  
or visit our website at [vikingrange.com](http://vikingrange.com)