

MP-WP110-B

Media Presentation Wall Plate - Mini-DIN S-Video w/RCA Stereo Audio, Black

Media Presentation Wall Plates complete the total Crestron® package, ensuring end-to-end Crestron quality for every installation. A range of wall plates is offered to support all types of analog and digital video, audio, and control signals. The MP-WP110 model features one (1) gold-plated 4-pin mini-DIN connector and two (2) gold-plated RCA connectors, color-coded and labeled for S-Video and stereo audio. Bulkhead type feed-thru connectors are used, providing female mini-DIN and RCA connections at the rear of the wall plate, facilitating installation using standard S-Video and RCA cables.

ACCESSORIES

CBL-KAUDIO-RCAM2-L-P-50:

CBL-AUDIO-RCAF-0.5:

CBL-RCA2-1.5:

CBL-RCA2-12:

CBL-RCA2-3:

CBL-RCA2-6:

CONN-MCOAX-BNC-50:

CONN-MCOAX-RCA-50:

FP-G1-A-S:

FP-G1-B-S:

FP-G1-W-S:

Notes:

1. Wall box not included. 3-1/2" extra-deep wall box or mud-ring recommended. Some cables and connectors may necessitate additional mounting depth.

This product may be purchased from an authorized Crestron dealer.

To find a dealer, please contact the Crestron sales representative for your area. A list of sales representatives is available online at www.crestron.com.

MP-WP110-B

Media Presentation Wall Plate - Mini-DIN S-Video w/RCA

Media Presentation Wallplates

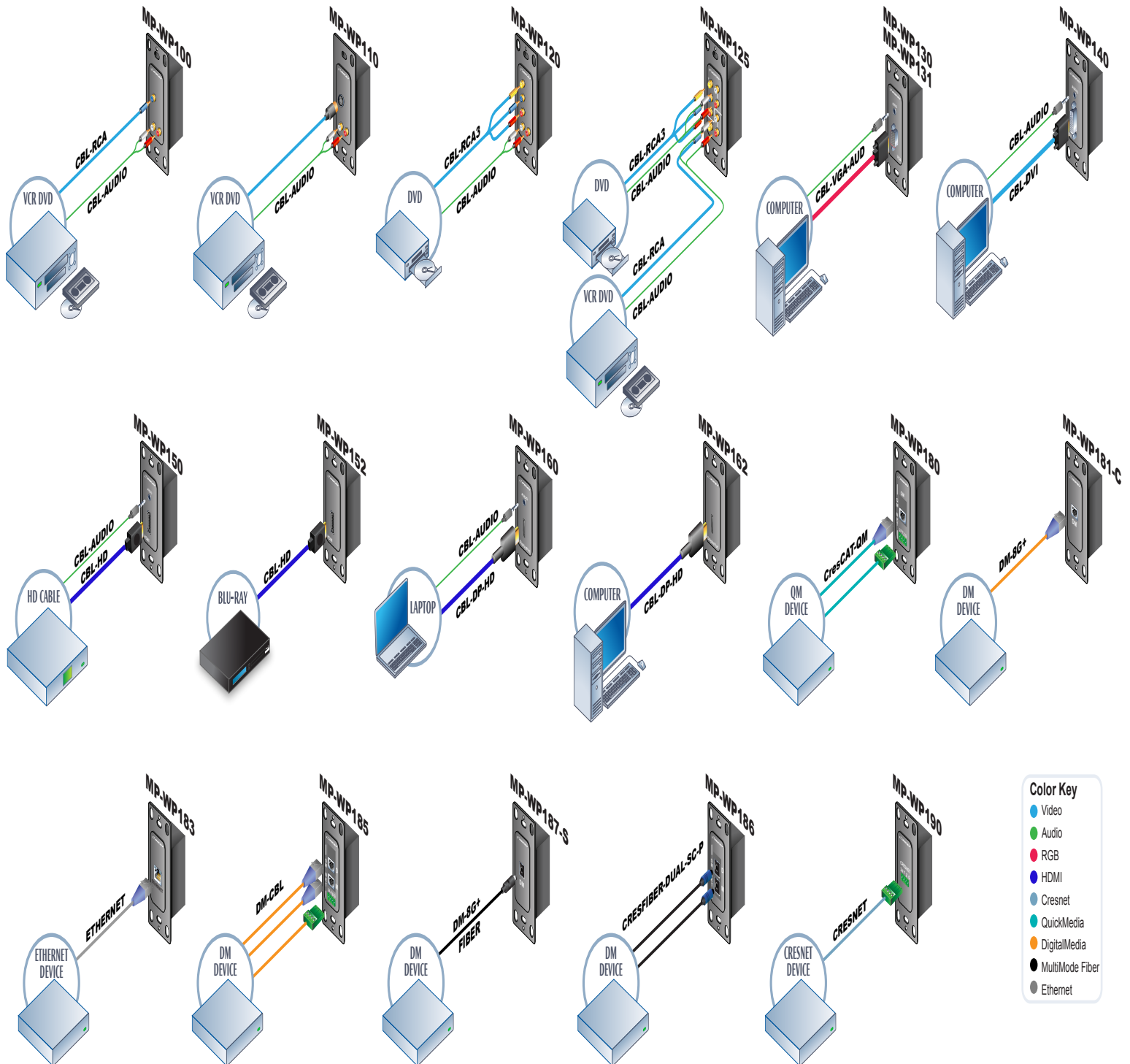

MP-WP110-B

Media Presentation Wall Plate - Mini-DIN S-Video w/RCA

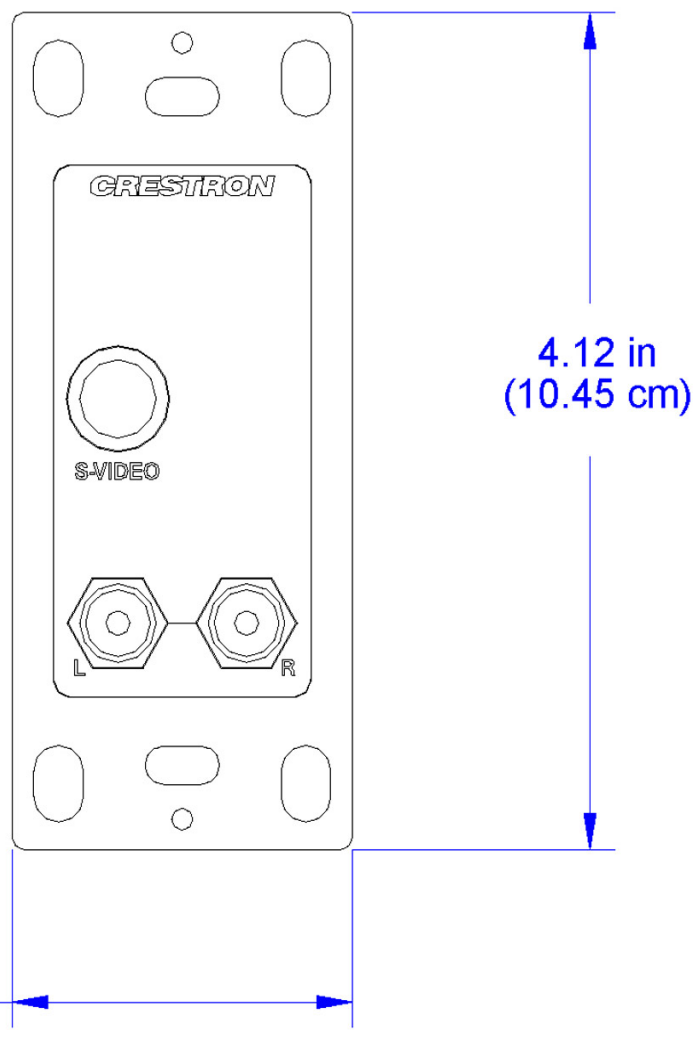
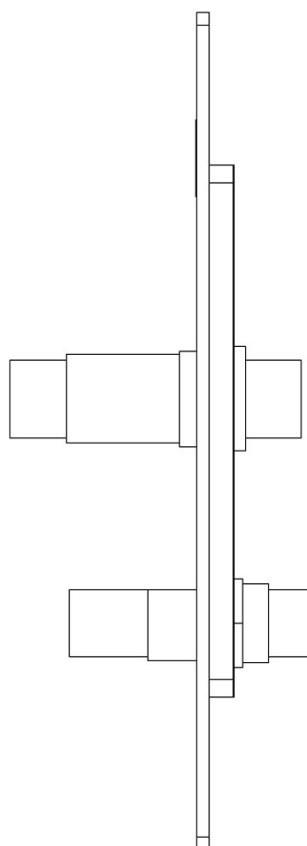
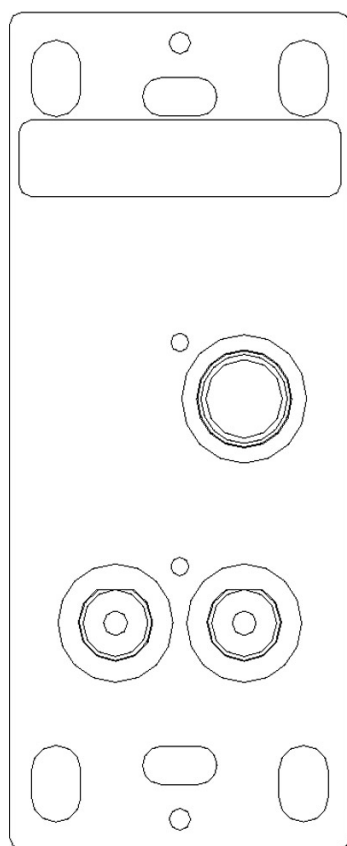
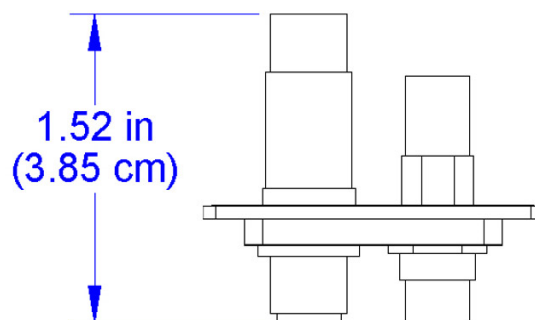

MP-WP110-B

Media Presentation Wall Plate - Mini-DIN S-Video w/RCA

