

## ASSEMBLY INSTRUCTION

MADE IN MALAYSIA

## U3043 ACCENT CHAIR

**Thank you for purchasing this quality product. Be sure to check all packing materials carefully for small parts that may have come loose inside the carton during shipment.**

**Before you start assembly:** Please read all instructions carefully before beginning the assembly process. It is recommended that 2 people work together during assembly to prevent personal injury and to ensure that heavy or cumbersome parts are not damaged during the process.

**CAUTION:** For your safety, this product requires two people to lift.

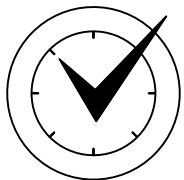
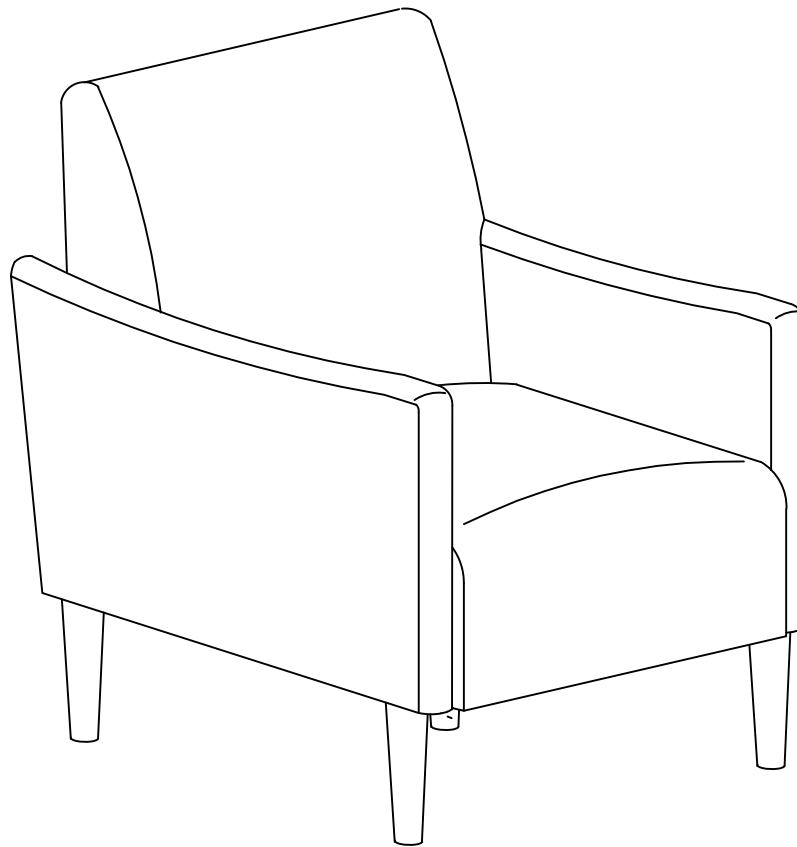

15 minute

APPROXIMATE ASSEMBLY TIME

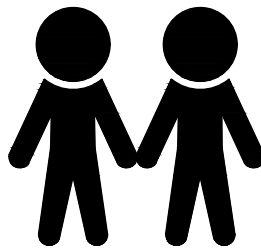

2 PERSON

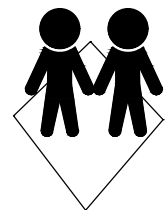

REQUIRED ASSEMBLY SPACE

## PART LIST

NO	PARTLIST	QTY
A	BACKREST	1 PC
B	SEAT	1 PC
C	LEG	4 PCS

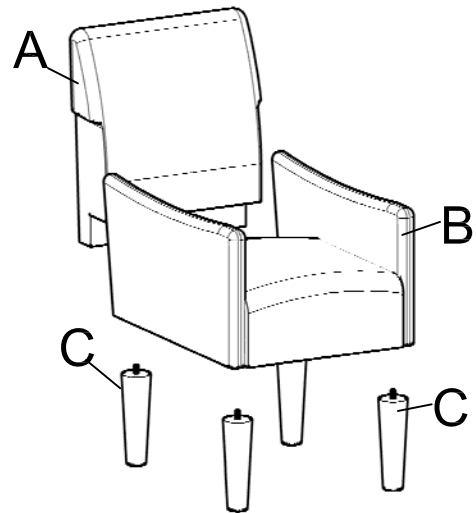

## HARDWARE LIST

- 1)  M6 X 60mm FLAT HEAD HEX BOLT x4
- 2)  2mm FLAT WASHER x4
- 3)  5/16" SPRING WASHER x4
- 4)  M4 ALLEN KEY x1
- 5)  47MM X 3MM LEG POST PLASTIC STOPPER x4

## STEP1

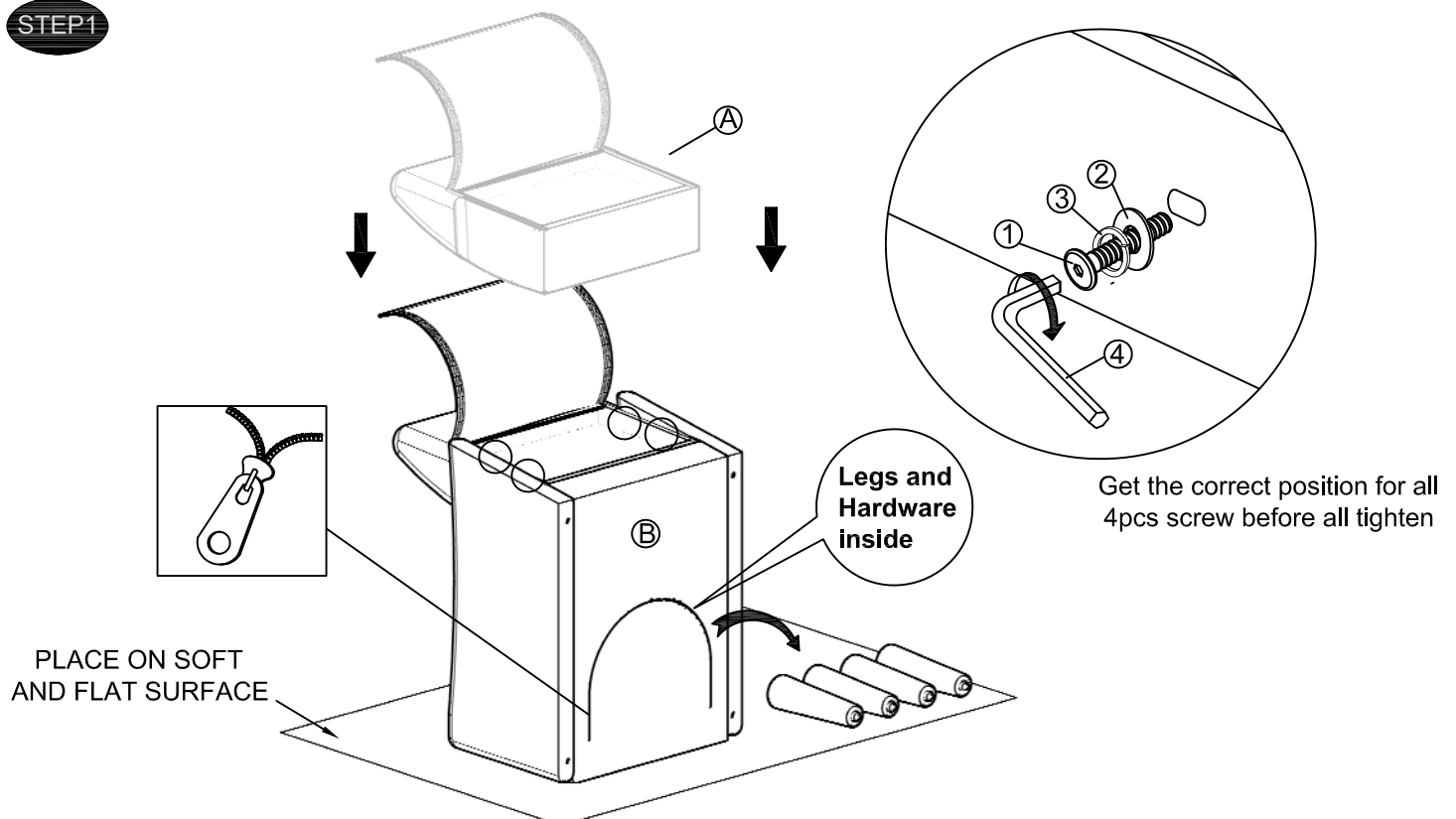

STEP2

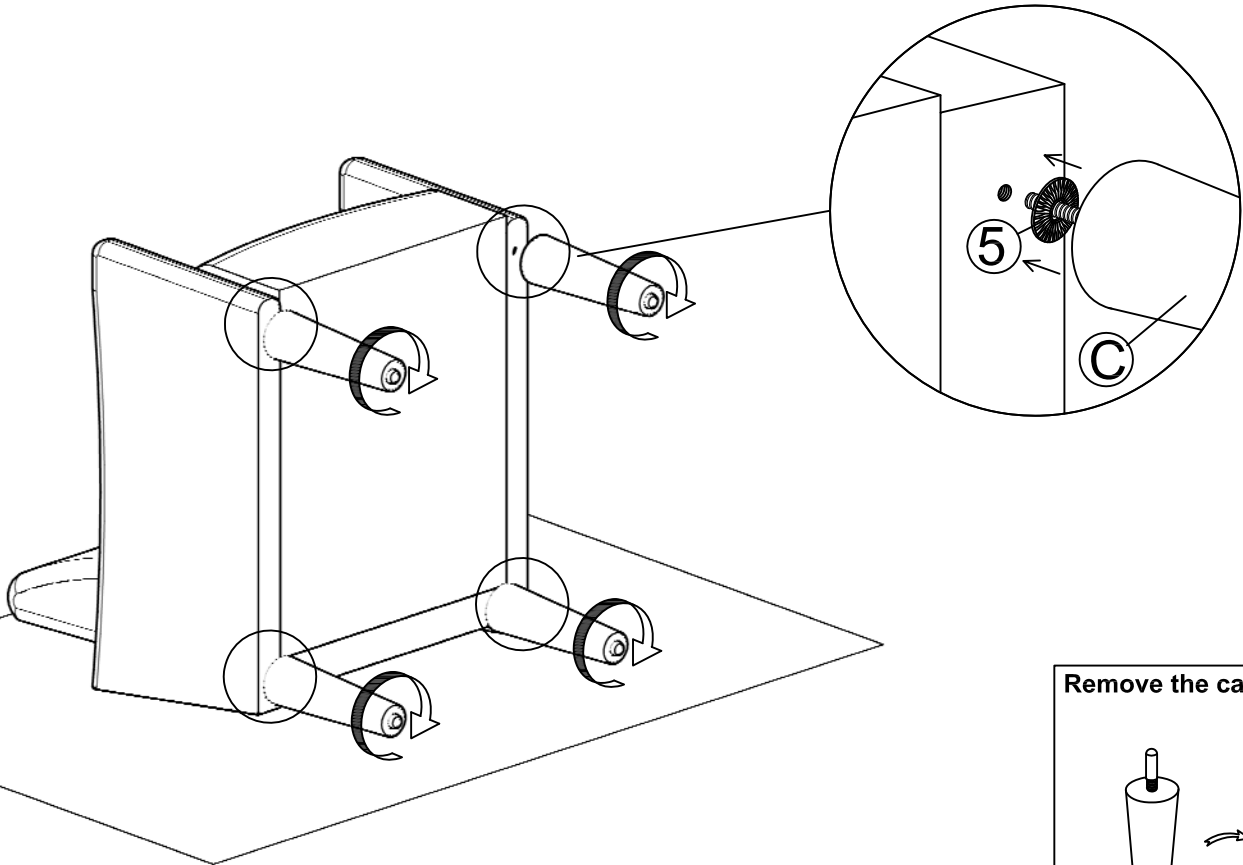

STEP2

