

FEATURES

- Designed to match Wolf professional products.
- Standard or flush inset installation.
- Can be located undercounter or in a corner.
- Large-capacity interior.
- Touch control panel with interactive visual display and 10 preset power levels.
- One-touch drawer opening.
- Sensor cooking to monitor and adjust settings.
- Popcorn, beverage, reheat, keep warm, melt, soften, Gourmet and defrost settings.
- Auto start and multiple sequence cooking features.
- Interior light and window in drawer.
- Full-extension drawer glides.
- Control panel lock.

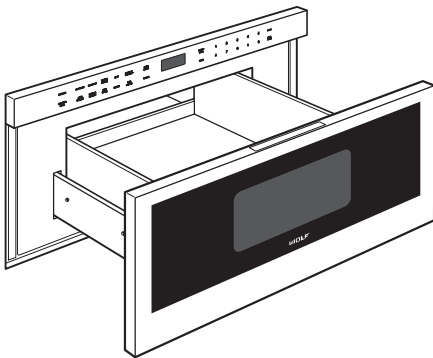

Model MD30PE/S

MODEL

Professional

MD30PE/S

ACCESSORIES

- Air vent for flush inset installations.

Accessories available through an authorized Wolf dealer. For local dealer information, visit the find a showroom section of our website, wolfappliance.com.

SPECIFICATIONS

PRODUCT

Dimensions 29⁷/₈" W x 15¹/₈" H x 21⁷/₈" D
Weight 96 lb

OVEN INTERIOR

Capacity 1.2 cu ft
Dimensions 17⁵/₁₆" W x 7¹/₈" H x 16⁹/₁₆" D

ELECTRICAL

Supply 120 VAC, 60 Hz
Service 15 amp circuit
Power Cord 4'

POWER RATING

Maximum 950 W

DIMENSIONS

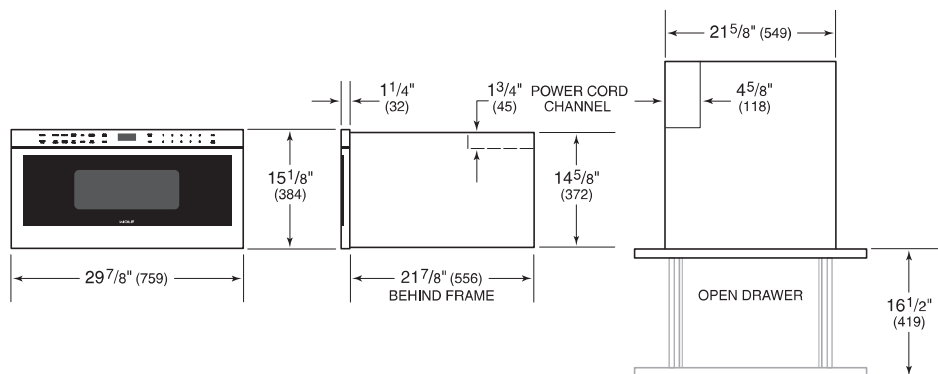

Specifications are subject to change without notice. Visit wolfappliance.com/specs for the most up-to-date information.

Dimensions may vary $\pm 1/8$ " (3). Dimensions in parentheses are millimeters unless otherwise specified.

STANDARD INSTALLATION

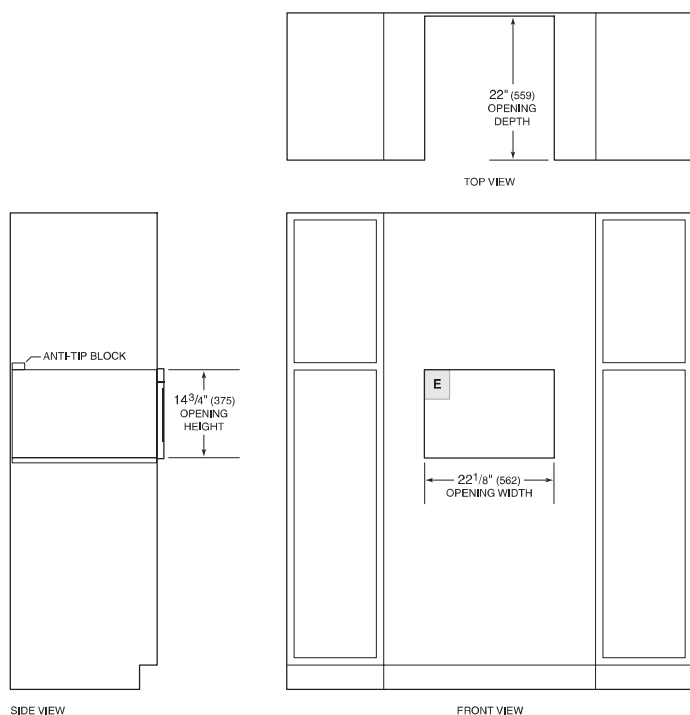

NOTE: All drawer microwave ovens require the same opening dimensions.

FLUSH INSET INSTALLATION

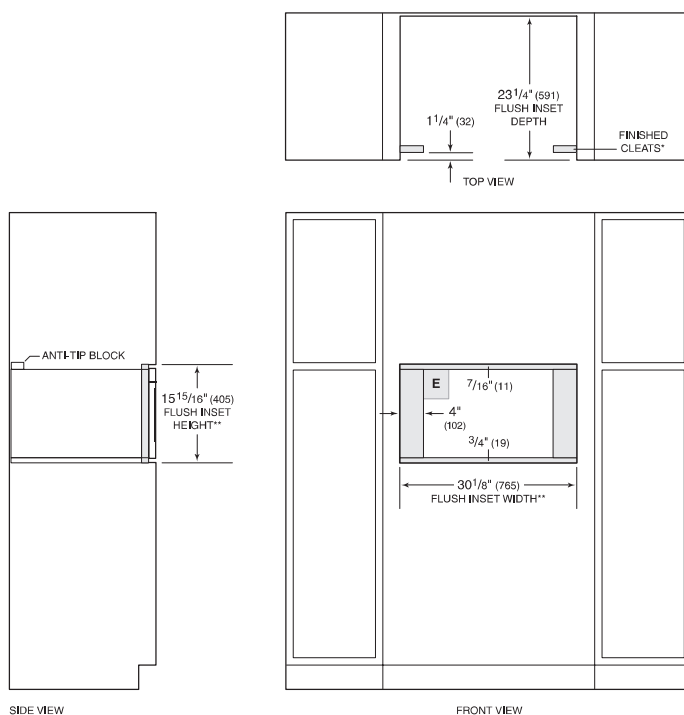

*Will be visible and should be finished to match cabinetry.
**Dimension provides minimum reveals.