

C022-417-281**AVONDALE****ASSEMBLY INSTRUCTIONS****TWO (2) PEOPLE AND PHILIP WRENCH REQUIRED**

PLEASE UNPACK ALL PARTS AND CHECK AGAINST PARTS LIST ON THIS INSTRUCTION SHEET BEFORE DISCARDING PACKING AND CARTON!!

- 1) Assemble four legs and the seat frame using flat washers (B) , lock washers (C) and bolt (A) as shown in (Drawing A).
- 2) Turn the chair to upright position then tighten all of the bolts by wrench provided (D).

***** NOTE KEEP THIS SHEET!!!! *****

In the unlikely event that you would need a replacement part for your table, please contact your local authorized Schnadig International dealer. If you need replacement hardware quickly, it could be purchased from your local hardware store.

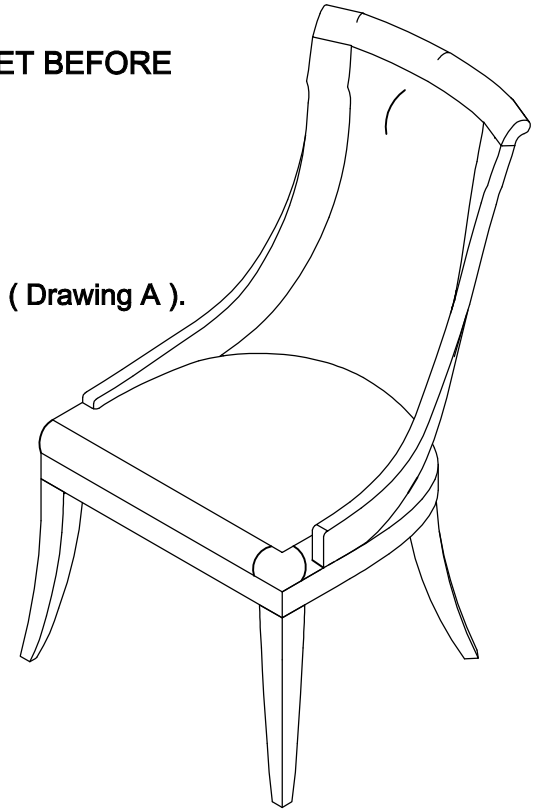

C022-417-281		
SIDE CHAIR		
Part Description	Part No.	QTY
Back&seat Assembly(1)	C022-417-281-4061	1
FRONT LEG (2)	C022-417-281-4019	2
BACK LEG (3)	C022-417-281-4020	2
RTA Hardware	C022-417-281-4001	1
Nail-in Floor Glide	C022-417-281-4086	4

NO	Hardware List			Q'ty
A		Bolt	5/16"x2-1/4"	8
B		Flat Washer	5/16"	8
C		Lock Washer	5/16"	8
D		Wrench	5/16"	1

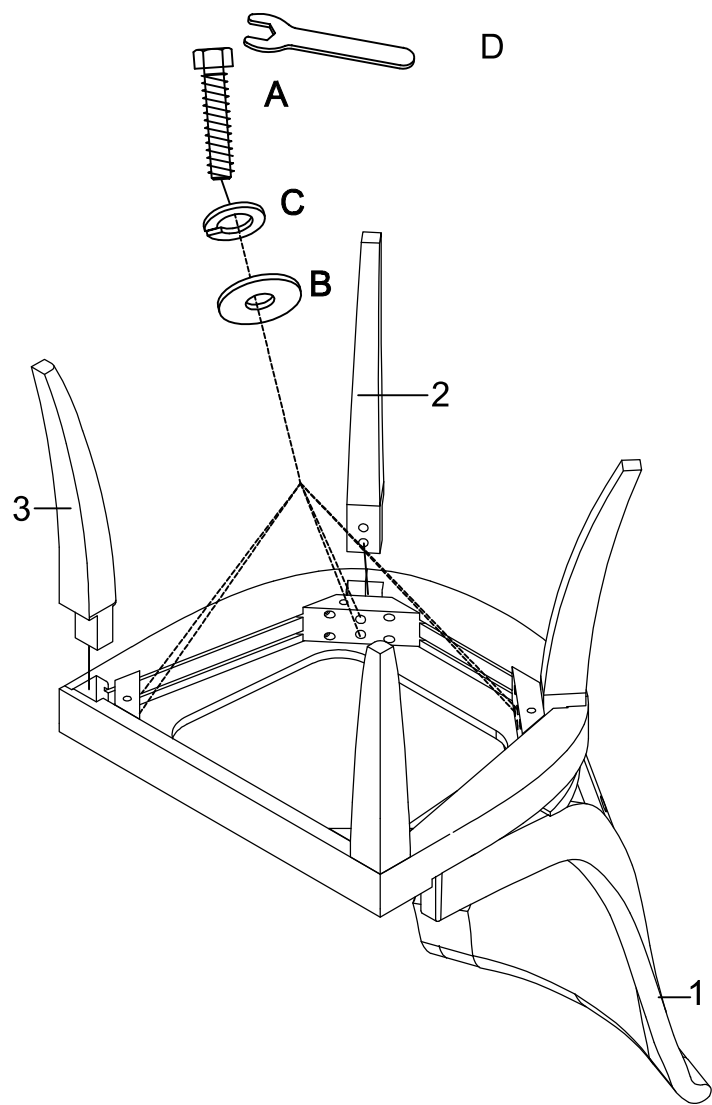

Drawing A