

ASSEMBLY INSTRUCTION FOR 6-DRAWER DRESSER N-15940-5-DR

Caution: Please read instructions thoroughly before unpacking assembly parts. Sharp, exposed staple tips can cause injury, therefore, for your protection, please remove any exposed staples used in packing.

1. We recommend that you should assemble this product with the assistance of another person; this will make assembly easier, and will help to eliminate damage to the product or injury to persons during assembly.
2. Be sure to check all packing materials carefully for small parts that may have come loose inside the carton during shipment.
3. Please do not over tighten screws or bolts.
4. Please put all parts on a non-abrasive floor before assembly, and follow the assembly steps to assemble your newly purchased product correctly and efficiently.

PART LIST FOR DRESSER			
No.	Part Description	Code.	Q'ty
A	Dresser		1
B	Legs	PN-15940-5-DRLEG1	4
C	Middle Leg	PN-15940-5-DRLEG2	1

HARDWARE LIST FOR DRESSER			
No.	Hardware Description		Q'ty
1		Spring Washer 3/8*3/4*1/8"	8
2		Spring Washer 3/8"	8
3		Hexagon 5/16*1/2"	8
4		Wrench 1/2"	1

Only tighten all bolts when all bolts aligned with bolt inserts.

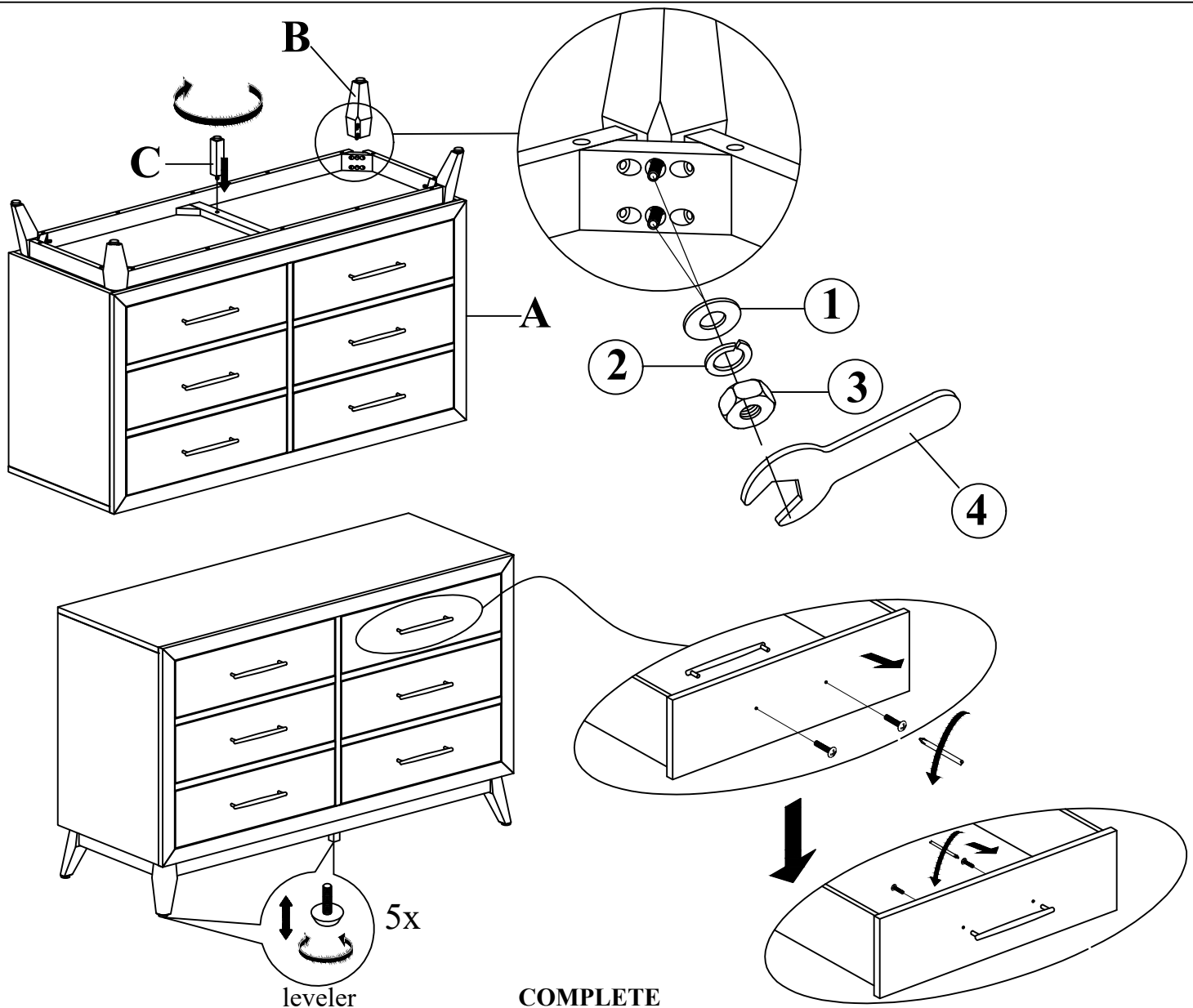

ASSEMBLY INSTRUCTION FOR 6-DRAWER DRESSER N-15940-5-DR

PART LIST FOR ANTI-TIP KIT

No.	Part Description	Code.	Q'ty
A	Dresser		1

HARDWARE LIST FOR ANTI-TIP KIT

No.	Hardware Description	Code.	Q'ty
1	 Anti-Tip Kit Metal (Set)	P-ATKNCH-M	1

 Only tighten all bolts when all bolts aligned with bolt inserts.

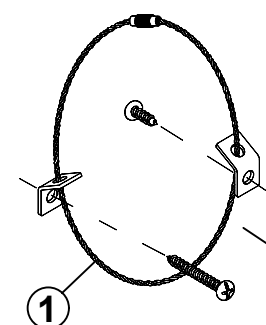

Anti-Tip Kit - Metal

Remark: Please be note that the safety bracket set with instruction is attached at the right first drawer.

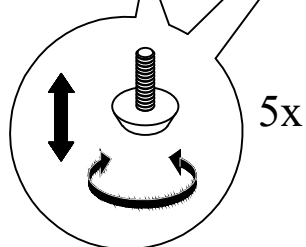
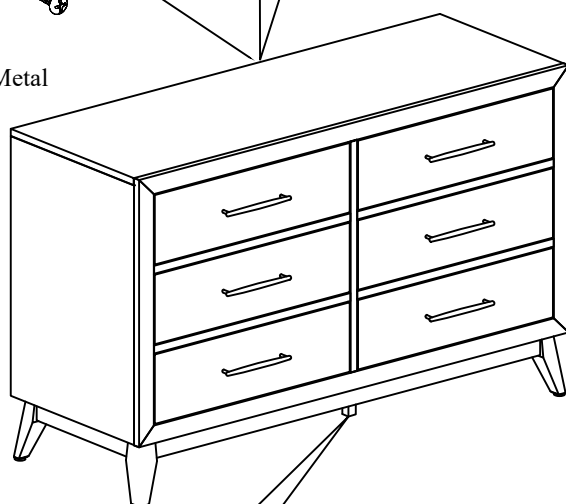

leveler

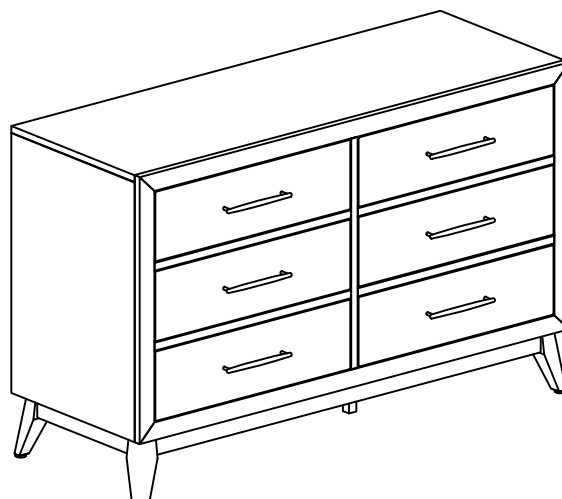

COMPLETE