

## Description

Savant's IDC-2000 transforms the Apple® iPad® and iPad2® into a cost-effective wired in-wall touch panel providing a new and exciting touch interface option.

The IDC-2000 is comprised of an in-wall docking station with a low-profile magnetically attached bezel.

The iPad is powered via the dock, and its touch screen is used for wired navigation and control of Savant automation and control solutions.

The IDC-2000 is specifically designed as a fixed docking solution and is not intended to be removed.

The iPad is placed in the docking station and mechanically held with a locking fastener. In addition, it includes a removal notification feature, which is useful for custom alerts in the event of the iPad being removed without permission..

## Feature Summary

- In-wall control and charging dock (iPad® not included)
- Transforms an iPad into a fixed wired in-wall touch panel
- Easy to install and effortlessly placed in strategic installations
- Portrait or landscape installation options
- Removable magnetically attached bezels
- Bezels available in white, black, almond or paintable primer finish
- Removal notification via contact closure
- Cost-effective solution that is simple to install—ideal for retrofits
- Configured and customized using RacePoint Blueprint™



Front View of IDC-2000 (iPad® not included)

## Dimensions

The next figures show the dimensions of the IDC-2000.

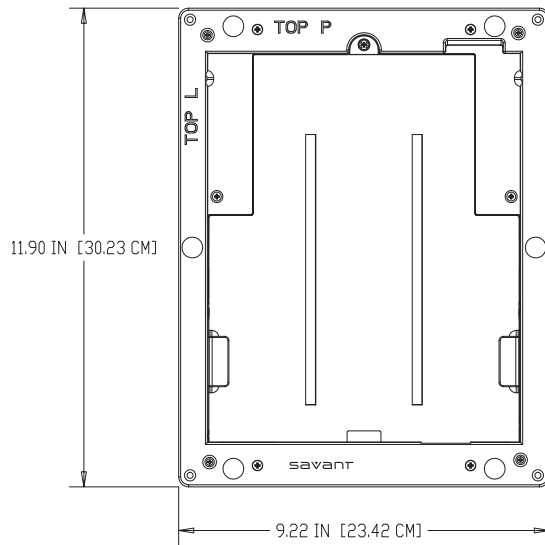

NO BEZEL

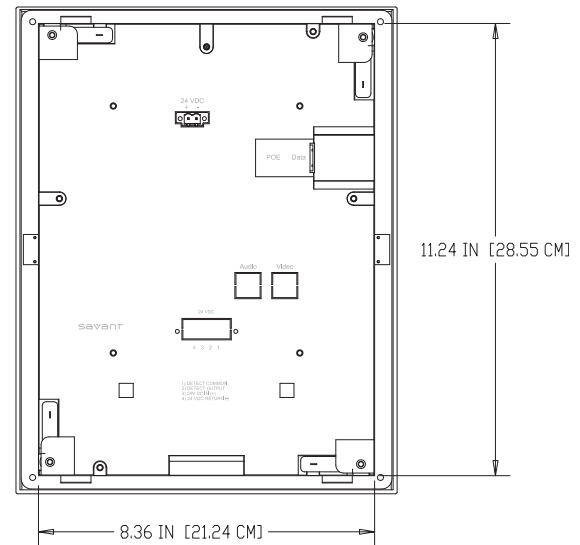

**Rear Views of IDC-2000 (above)**

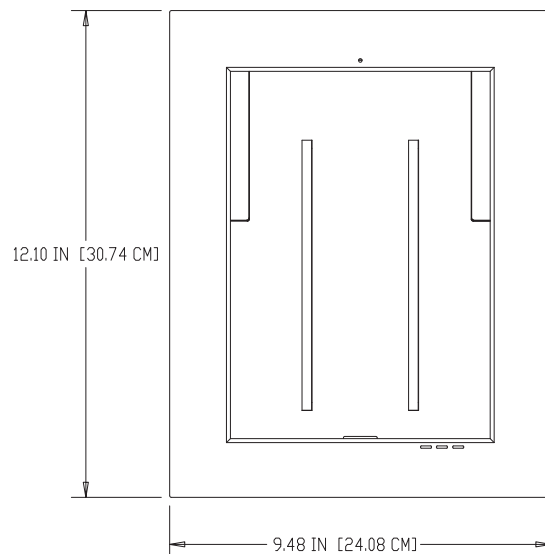

WITH BEZEL

**Front View of IDC-2000**

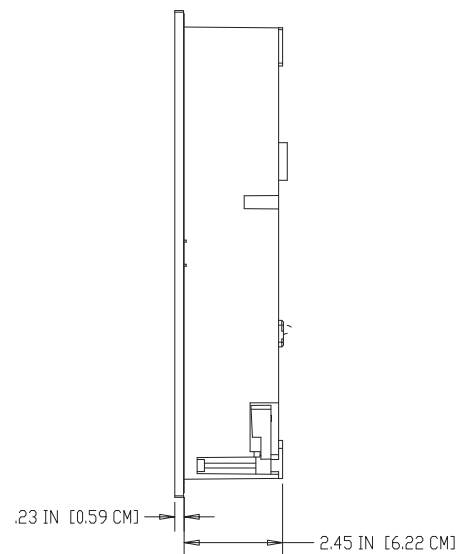

**Side View of IDC-2000**

## Specifications

Environmental	
Temperature	32° to 104° F (0° to 40° C)
Humidity	10% to 90% RH (non-condensing)
Dimensions and Weight	
Height (with bezel)	12.10 in/30.74 cm
Width (with bezel)	9.48 in/24.08 cm
Depth	2.45 in/6.22 cm plus .23 in/ .59 cm for bezel
Weight	0.5 lb (0.26 kg)
Power	
Supply	24V DC 120-230V AC, 50/60 Hz
Maximum Power Draw	16 Watts
Power Cable	Typically distributed over two-conductor twisted pair: 300 ft maximum (AWG 22)
Compliance	
Safety and Emissions	FCC Part 15 CE Mark C-Tick
RoHS	Compliant

## Wiring to Dock

The charging dock iPad detect signal is designed to connect to one of the Savant Controller GPIO input connections. The IDC-20000 charging dock will pull the GPIO input low when an iPad is inserted into the dock.

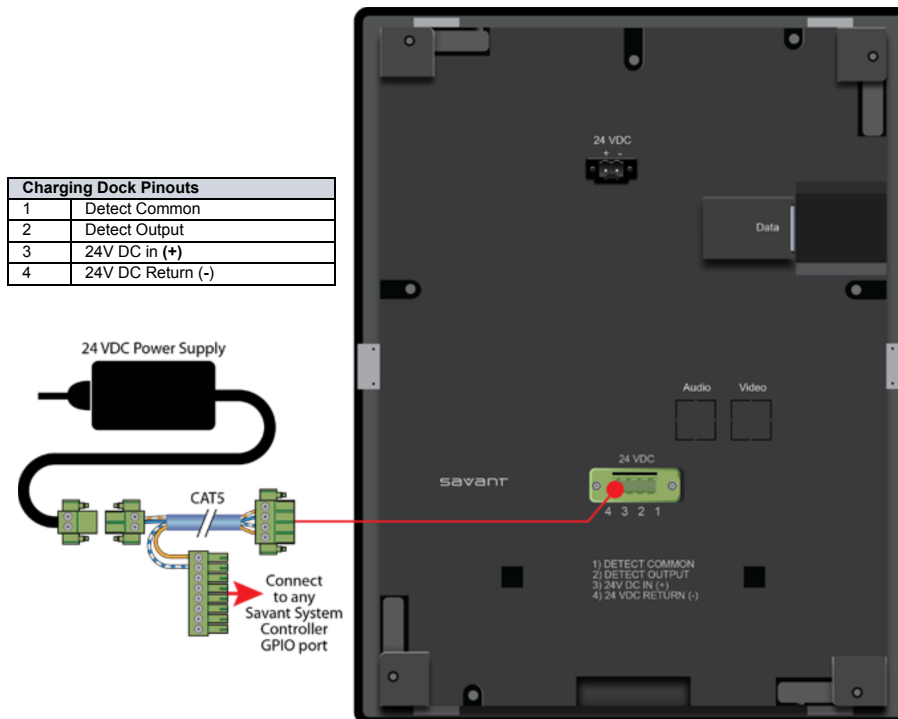

## Included Items

The items included with the IDC-2000 are outlined in the next table.

Description	Quantity
Power Cord appropriate for location (North American is 2 feet)	1
Power supply 24 volt, 60 watt	1
2-position screw down connector	1
4-position screw down connector	1
#8-32 X 2.25 Phillips Pan Screws	4
#6 X 1.5 Phillips Flat Screws	4
Cut-out Template	1
Adaptor for the iPad2	1
Instructions for iPad2 Adaptor	1
Quick Reference Guide	1

## Required System Components

The system components required for use with the IDC-2000 are outlined in the next table.

Description	Model Number
Host Controller	HST-4001, HST-4002, SVR-4100 or SVR-4100s
Ethernet Network	Enterprise-grade network deployment

## Optional Accessories

The optional accessories available for use with the IDC-2000 are outlined in the next table.

Description	Model Number
Pre-construction box	RIB-IWCD
Black In-Wall bezel for iPad (single pack)	BZB-1IPAD
White In-Wall bezel for iPad (single pack)	BZW-1IPAD
Almond In-Wall bezel for iPad (single pack)	BZA-1IPAD
Paintable Primer Finish In-Wall bezel for iPad (single pack)	BZP-1IPAD
Black In-Wall bezel for iPad (five pack)	BZB-5IPAD
White In-Wall bezel for iPad (five pack)	BZW-5IPAD
Almond In-Wall bezel for iPad (five pack)	BZA-5IPAD
Paintable Primer Finish In-Wall bezel for iPad (five pack)	BZP-5IPAD

Copyright © 2012 Savant Systems, LLC. SAVANT and RacePoint Blueprint are trademarks of Savant Systems, LLC.  
 All brand names, product names and trademarks are the property of their respective owners.  
 Savant Systems, LLC reserves the right to change product specifications without notice.