

# 1 SERIES MOTORIZED



## GAMMA WHITE 1.1 (4K)

SUGGESTED SPECIFICATIONS:  projection screen(s),  (H) x  (W). With our 1 Series external mounting system, you can find the perfect spot to mount your screen. The simple process has been designed to accommodate a one person installation with minimum effort. 1 Series Motorized locks into place guaranteeing safety. We now include the latest Somfy quiet-motor technology in all of our 1 series motorized screens.

### Theater HDTV (16:9) Format Dimensions (External Only)

Viewing Area H x W (C X B)		Standard Diagonal (A)		Overall Width (F)		Approx. Ship. Wt.	
in.	cm.	in.	cm.	in.	cm.	Lbs.	Kg
39" X 70"	100 X 177	80"	203	80"	203	47	21
45" X 80"	115 X 204	92"	234	92"	233	51	23
49" X 87"	124 X 221	100"	254	99"	251	55	25
52" X 92"	132 X 235	106"	269	104"	264	57	26
54" X 96"	137 X 244	110"	279	108"	273	61	28
59" X 105"	149 X 266	120"	305	117"	296	65	29
65" X 116"	166 X 294	133"	338	128"	324	73	33
78" X 139"	199 X 354	160"	406	152"	386	85	39

### PRODUCT NOTES

- All screens standard with 24" of black-drop at the top.
- All screens standard with wall switch, IR Remote, and low voltage trigger.
- For dimensions not listed, please see our online screen calculator: <http://www.screeninnovations.com/tools/screen-calculator/>

### MATERIAL INFORMATION

- All surfaces will be seamless.

### WHEN ORDERING, MARK APPROPRIATE SELECTIONS

1. Select Size from Charts.
2. Select Screen Material
  - ☐ Gamma White 1.1 (4K)
3. Screen options:
  - ☐ 220v Motor
  - ☐ RS232/485 Control & Cable

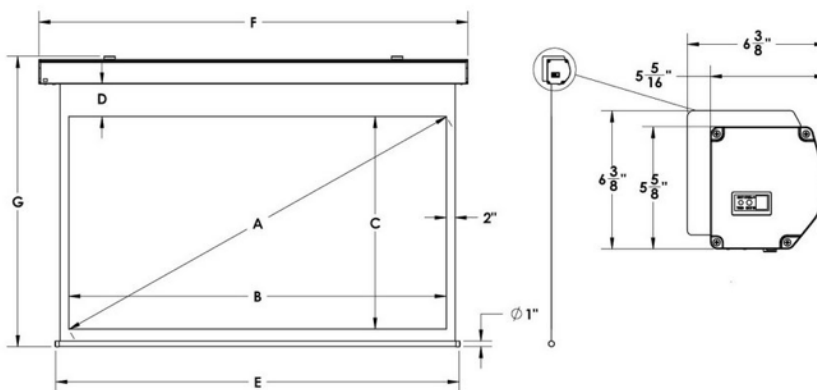

Project Name: \_\_\_\_\_

Architect: \_\_\_\_\_

Contractor: \_\_\_\_\_ Phone \_\_\_\_\_

Reseller: \_\_\_\_\_ Phone \_\_\_\_\_



9715-B BURNET RD. SUITE 400, AUSTIN, TX 78758

Call 512-832-6939 or visit [www.screeninnovations.com](http://www.screeninnovations.com) for more information.