

MOTOMOTION
FASHION. FORWARD. FURNITURE.

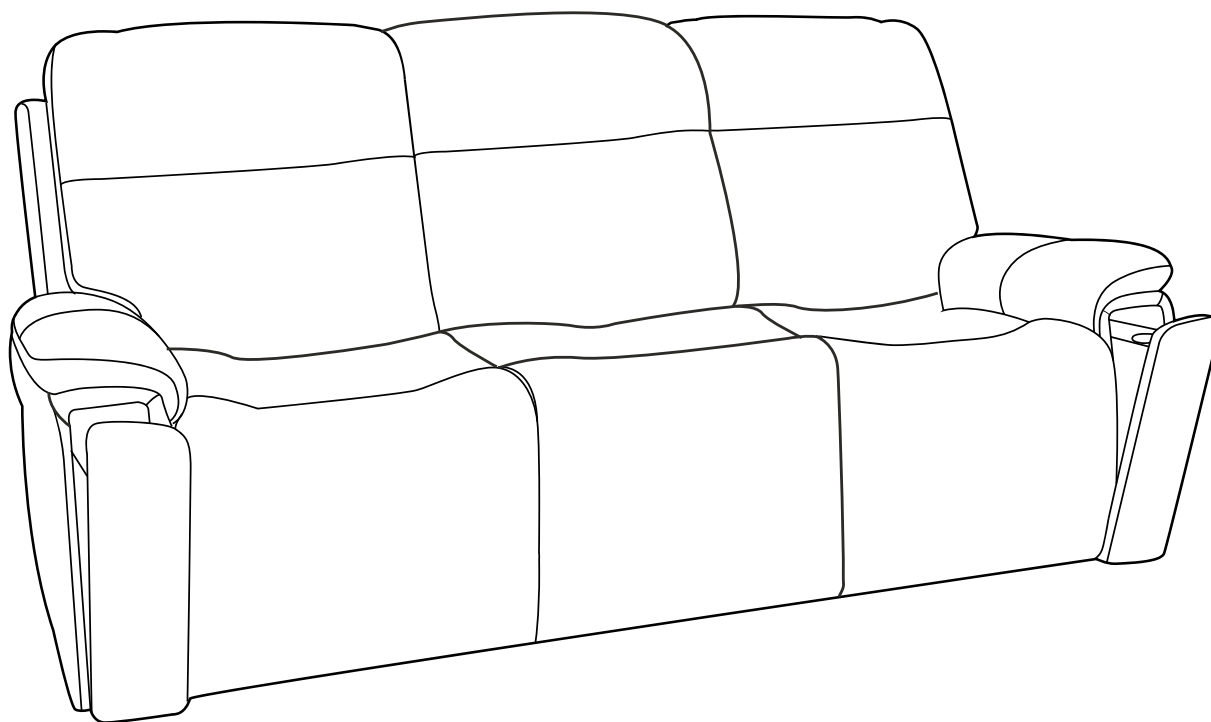

USER'S MANUAL

IMPORTANT SAFETY INSTRUCTIONS

READ ALL INSTRUCTIONS BEFORE USE.

WARNING: To reduce the risk of burns, fire, electric shock, or injury:

1. DANGER: Unplug the unit before cleaning to reduce the risk of electric shock.
2. Unplug before installing or removing parts.
3. Close supervision is necessary when used by or near children or individuals with disabilities.
4. Use this product only as described in these instructions. Do not use attachments not recommended by the manufacturer.
5. Do not operate the unit if the power cord or plug is damaged, if it is not functioning properly, if it has been dropped, or if it has been immersed in water.
6. Keep the power cord away from heated surfaces.
7. Never drop or insert objects into any opening.
8. Do not use outdoors. For indoor residential use only.
9. To disconnect, set all controls to the **OFF** position, then remove the plug from the outlet.
10. WARNING: Risk of injury. Keep children away from the extended footrest.
11. WARNING: Risk of injury. Do not use this equipment to support video devices such as TVs or computer monitors.

DOUBLE INSULATION MAINTENANCE

A double-insulated product has two separate insulation systems and does not require grounding. No grounding is provided on such a product, and none should be added. Any service or repair on a double-insulated product requires great care and should be performed only by qualified personnel. Replacement parts must be identical to the original parts.

KEEP THESE INSTRUCTIONS.

Assembly Instructions— Sofa with Fold-Down Table & Audio Console

Thank you for purchasing this quality product. Please check all packaging carefully, as some parts may have come loose into the box during transport.

The box contains two bags with the sides of the sofa. Keep them aside for assembly.

Read the following instructions carefully before beginning assembly.

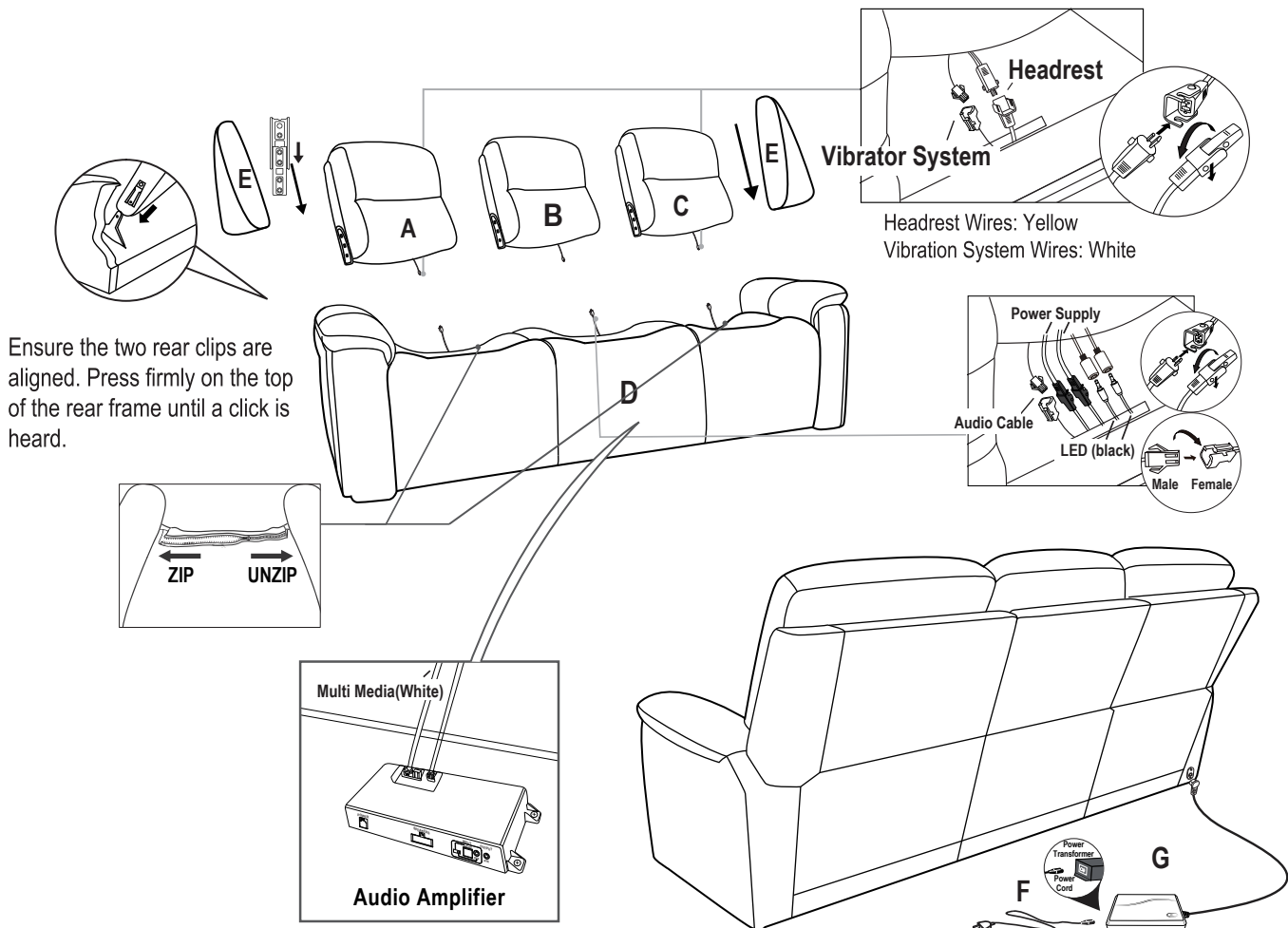
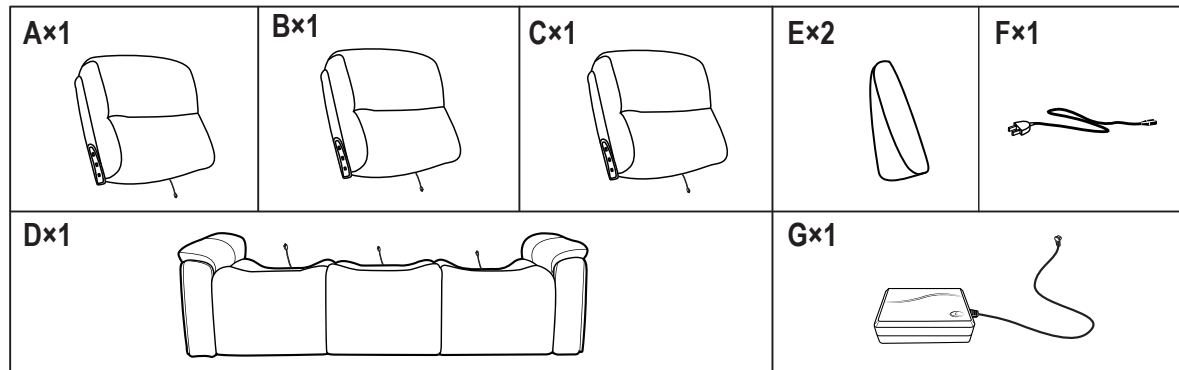

Do not plug the power cord into an outlet until the unit is fully assembled and set in place.

NOTE:

- 1) To avoid electric shock or damage to the product, plug the power cord only into a grounded outlet.
- 2) Read the instruction manual carefully before using the product.

IMPORTANT NOTE:

- Dispose of all plastic bags to avoid suffocation hazards for children or pets.
- For optimal performance, check all screws regularly and tighten if necessary.

Assembly Instructions— Sofa with Fold-Down Table & Audio Console

TOUCH-SENSITIVE LED LIGHTS

Tap the centre of the lamp to turn it on. A second tap increases brightness. A third tap turns it off.

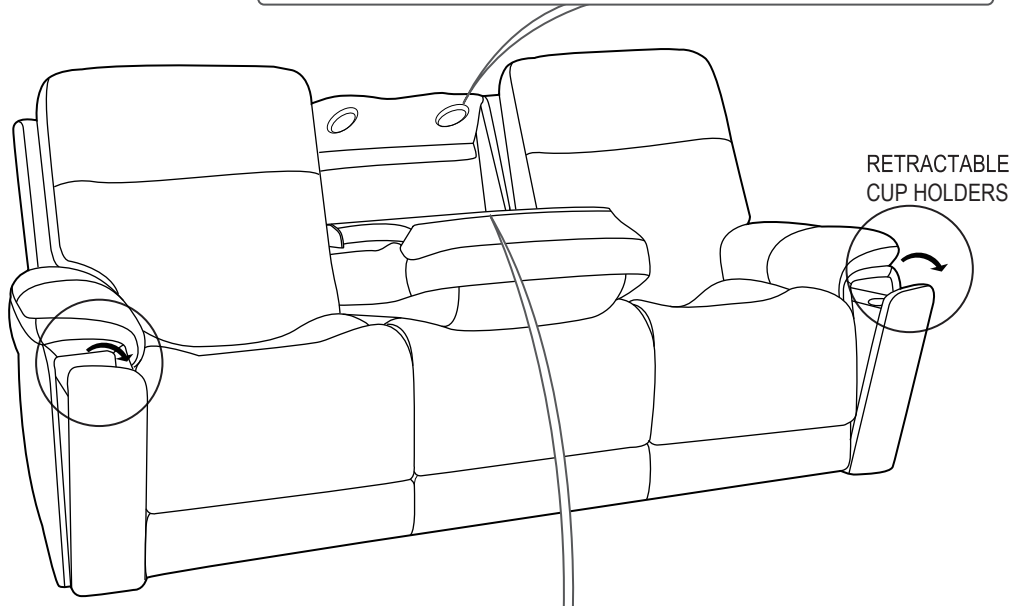

RETRACTABLE
CUP HOLDERS

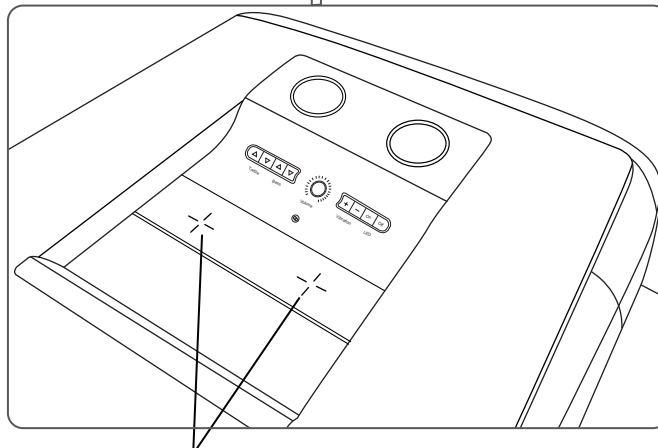

2×WIRELESS CHARGING TRAYS

FCC INSTRUCTIONS

CAUTION: Any changes or modifications not approved by the party responsible for compliance could void the user's authority to operate this equipment.



NOTE: This equipment has been tested and found to comply with the limits for a Class B digital device, as specified in Part 15 of the FCC Rules. These limits are designed to provide reasonable protection against harmful interference in a residential environment. This device generates, uses, and can radiate radio frequency energy. If not installed and used according to the instructions, it may cause harmful interference to radio communications. However, there is no guarantee that interference will not occur in a particular installation. If this equipment does cause harmful interference to radio or television reception, which can be determined by turning the device off and on, the user is encouraged to try to correct the interference by one or more of the following measures:

- Reorient or relocate the receiving antenna.
- Increase the distance between the equipment and receiver.
- Connect the equipment into an outlet on a circuit different from that to which the receiver is connected.
- Consult the dealer or an experienced radio/TV technician for help.

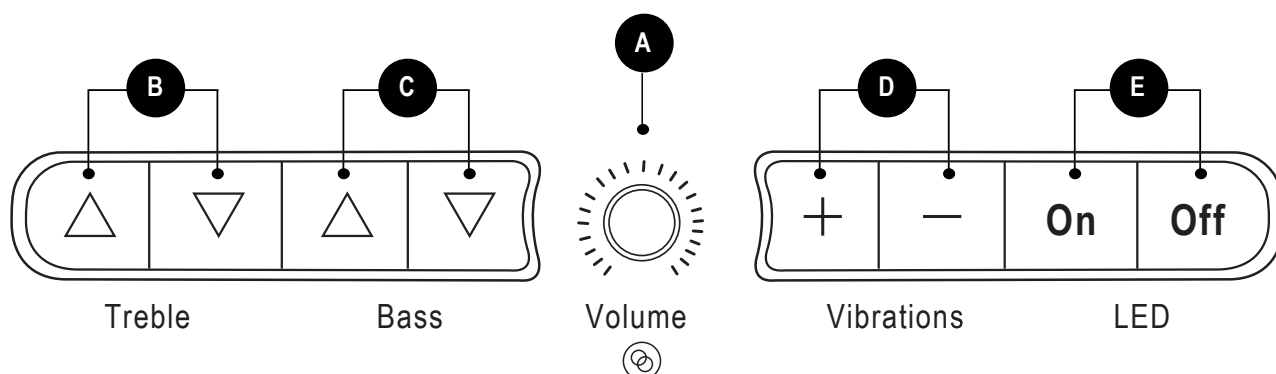
WARNING: Read the instructions below carefully before operating this motorized unit.
This equipment must not be used or operated by children.





A PAIRING MODE

1. Press and hold the button to turn the amplifier control box ON or OFF.
2. Press and hold the  button to enter or exit pairing mode. The blue light on the  will flash during this process. Then, search for the wireless connection **Moto Media System** or **Moto Immersive Audio** on your mobile phone. Once connected, the blue light on the  will remain steady.



HOW TO USE THE BROADCAST MODE

1. Double-click the  button to enable or disable the broadcast function. A steady red light on the button indicates the broadcast function is active.
2. Rotate the knob forward or backward to adjust the volume.

B TREBLE

To increase treble intensity, press on the  icon of the function switch.
To decrease treble, press on the  icon.

C BASS

To increase bass intensity, press on the  icon of the function switch.
To decrease bass, press on the  icon.

D VIBRATION SYSTEM

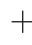
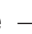
To increase vibration intensity, press on the  icon on the function switch.
To decrease vibration intensity, press on the  icon.

E LED

The LED emits a 5 V blue light. LED buttons control all light strips.

NOTE: Adjustments to Treble/Bass/Vibration System/Volume are shown on the light bar above the control switches.

- Increasing intensity: the light bar gradually illuminates from left to right.
- Decreasing intensity: the light bar dims from right to left.
- When the bar is fully lit, the setting is at maximum level.

WARNING: Avoid maximum sound levels as it will help prolong the lifespan of the sound system.

WARNING: Read the instructions below carefully before operating this motorized unit.
This equipment must not be used or operated by children.

Audio Amplifier

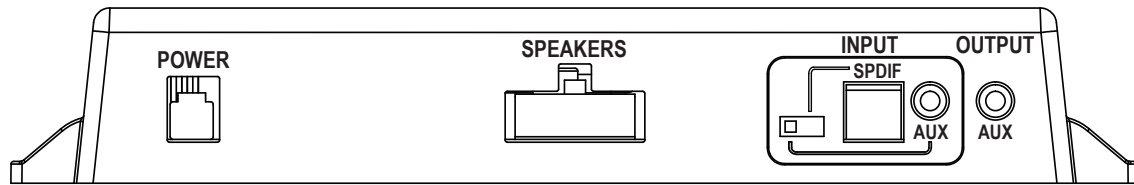

Located under the sofa console, the audio amplifier includes one AUX input, one AUX output, and one S/PDIF port. Multiple devices can be connected using 3.5 mm AUX cables: connect the audio source to the AUX input, then connect the AUX output to the AUX input of the next amplifier. 3.5 mm AUX cables are sold separately.

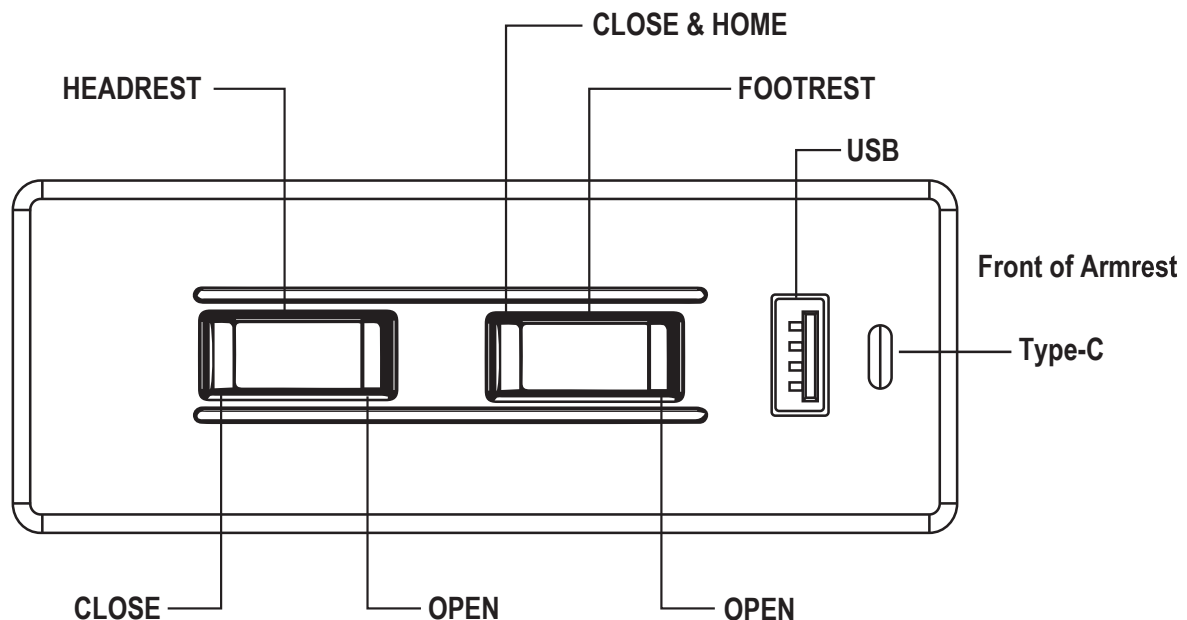

Ensure there are no obstacles in the path of the mechanism before or during operation.

To Recline: Sit on the chair and press the front of the button near the footrest to raise it smoothly and recline the chair to the desired position. To return the footrest to vertical position, press the back of the same button.

To Adjust the Headrest: Press the front of the button near the backrest to raise the headrest smoothly and set it to the desired position. To lower it and return it to the original position, press the back of the same button.

To Close All Functions: To simultaneously return the headrest, footrest, and lumbar support to their original positions, press and hold the back side of the button closest to the footrest.

TROUBLESHOOTING

PROBLEM	CAUSE	SOLUTION
The power light does not turn on.	The AC cable is not connected.	Connect the AC power cable to another working outlet.
The recliner opens or closes unevenly.	<ul style="list-style-type: none"> The supporting frame is deformed. Intermittent stops occur when opening the backrest or footrest. The motor sensor may be defective. 	<ul style="list-style-type: none"> Replace the frame. Replace the motor.
The side switch does not work or the USB port does not charge.	<ul style="list-style-type: none"> The backrest or footrest is in an intermediate position, or a clicking sound is heard while the product is not operating. The USB port does not charge. 	<ul style="list-style-type: none"> Replace the switch and control box. Replace the switch.
The LED strip lights up only partially.	The LED bulbs are damaged.	Replace the entire light strip.
The volume knob is not turned, but the sound keeps increasing.	Audio control panel failure (defective encoder control).	Replace the audio control panel.

MOTOMOTION

FASHION. FORWARD. FURNITURE.

Customer Service

For any questions regarding the use of this product, or if it requires servicing, please contact your dealer.