

# ASSEMBLY INSTRUCTION

## MADE IN VIETNAM

U4315-22 OTTOMAN - LIGHT GREY

Thank you for purchasing this quality product. Be sure to check all packing materials carefully for small parts that may have come loose inside the carton during shipment.

Before you start assembly: Please read all instructions carefully before beginning the assembly process. It is recommended that 2 people work together during assembly to prevent personal injury and to ensure that heavy or cumbersome parts are not damaged during the process.

**CAUTION:** For your safety, this product requires two people to lift.

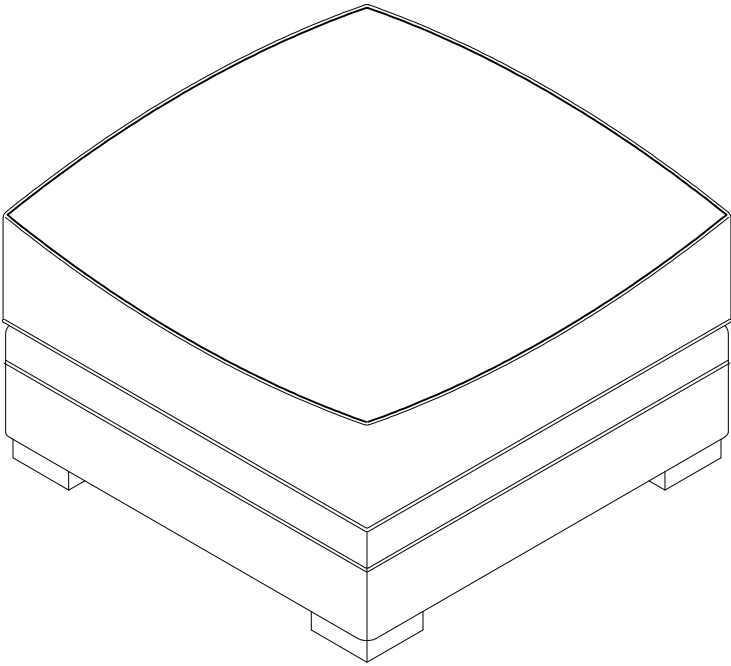

**20 MINUTES**

APPROXIMATE ASSEMBLE TIME

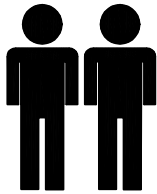

2 PERSON

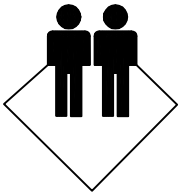

REQUIRED ASSEMBLY SPACE

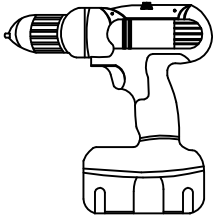

RECOMMENDED ASSEMBLY TOOLS

NOT  
PROVIDED

ITEM NO. :U4315-22 OTTOMAN - LIGHT GREY

PART LIST

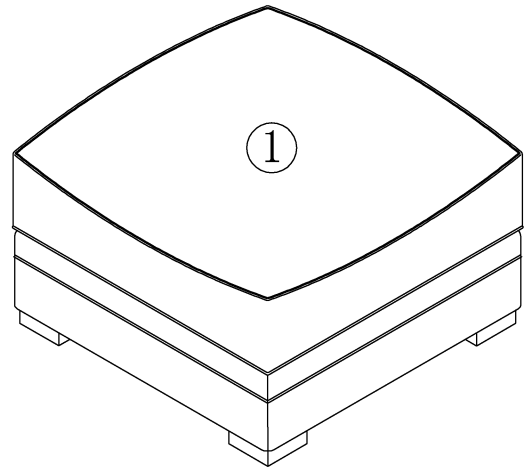
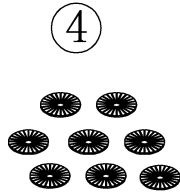
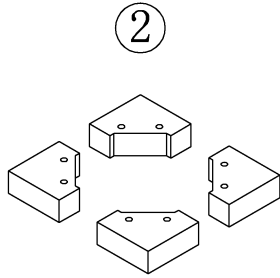

NO.		PART LIST	Q.TY
(1)		Body EHF # N/A	1
(2)		Leg EHF # PU4315-90LEG	4
(3)		Plastic Glide EHF # PURECL-FTGDPLSTC	8
(4)		Plastic Washer EHF # PURECL-LEGWASHER	8

ITEM NO. :U4315-22 OTTOMAN - LIGHT GREY

**HARDWARE LIST**

EHF # PU4315-13AHDWR

**A**

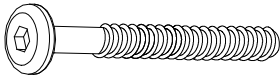

**8X**  
**Ø 5/16"\*60mm**  
**LONG BOLT**

**B**



**8X**  
**Ø 5/16"\*12\*2mm**  
**SPRING WASHER**

**C**

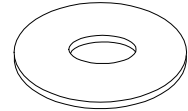

**8X**  
**Ø 5/16"\*19\*2mm**  
**FLAT WASHER**

**D**

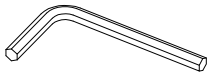

**1X**  
**M4\*59mm**  
**"L" ALLEN KEY**

**E**



**1X**  
**M4\*100mm**  
**"STRAIGHT" ALLEN KEY**

ITEM NO. :U4315-22 OTTOMAN - LIGHT GREY

STEP 1

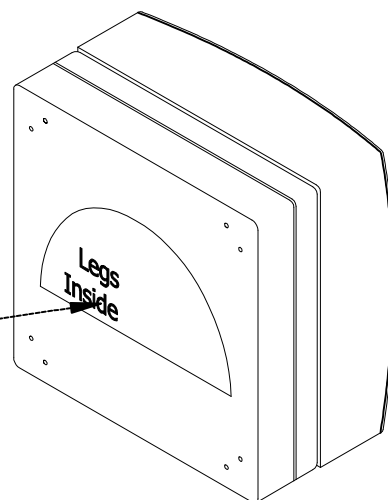
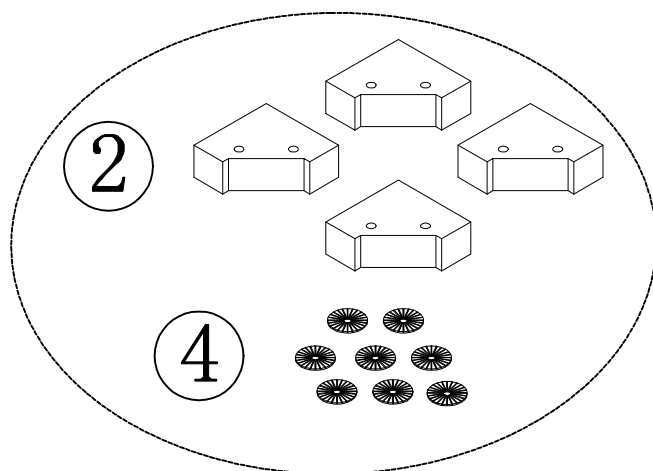

STEP 2

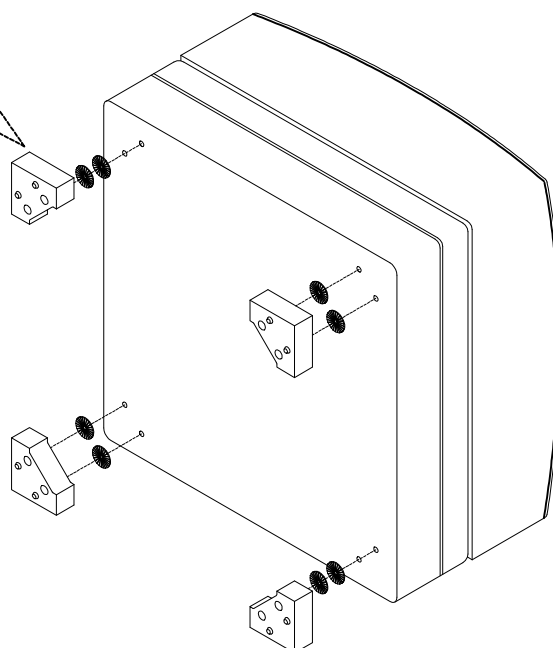
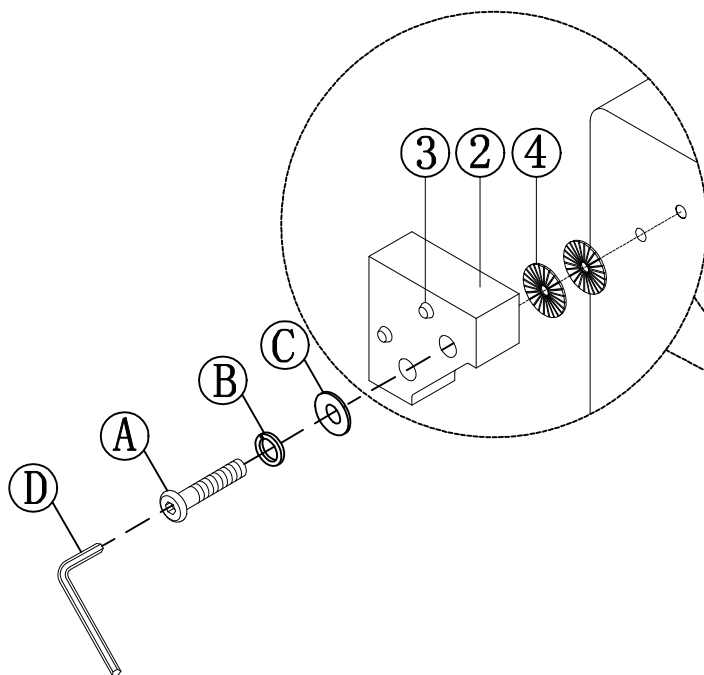
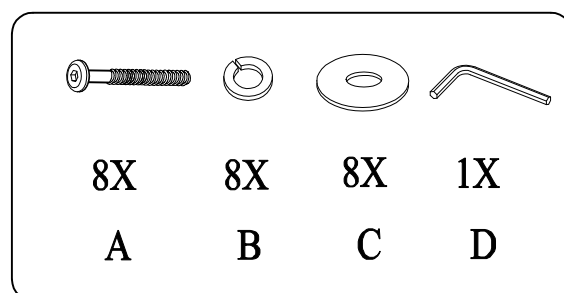

ITEM NO. :U4315-22 OTTOMAN - LIGHT GREY

STEP 3

