



## BLAZE GRILL CART ASSEMBLY



### CALIFORNIA PROPOSITION 65 WARNING

WARNING: This product can expose you to chemicals including Chromium (hexavalent compounds), which are known to the State of California to cause cancer and birth defects or other reproductive harm. For more information go to:

[www.P65Warnings.ca.gov](http://www.P65Warnings.ca.gov)

### WARNING:

**Do not use power tools to assemble. Only use hand tools, as power tools can damage or loosen the nutsert.**

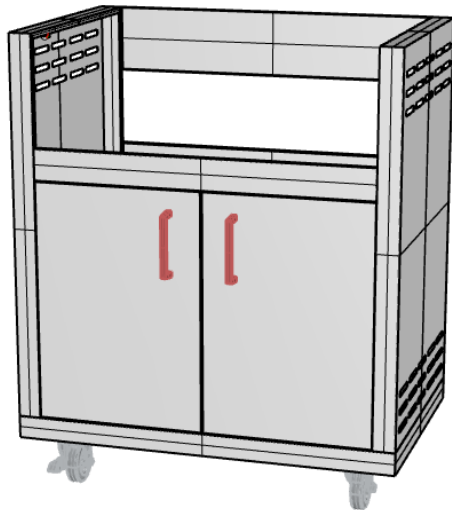

Tools Needed: #2 Phillips Head Screw Driver – “Not Included”

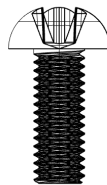

M5 x 12 mm

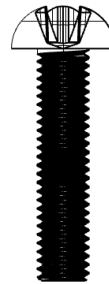

M5 x 24 mm

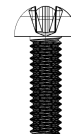

M5 washer



M5 lock washer

### Before getting started:

- Unpack and lay out all of the included parts. Most of the stainless steel pieces come with a protective film. Remove all of the plastic film and pay no attention to the print on the film as it has nothing to do with the assembly instructions.
- Take caution with the stainless steel components as to not scratch them during the assembly process. Use a non-aggressive surface and protect the stainless steel as best as possible.
  - (16) M5 x 12 mm screw will be paired with a M5 lock washer. Use M5 flat washer and lock washer for installing the casters to the base. All other connections will be made with a screw only.
  - **NOTE** - screws for the door handles are smaller and those are packaged with the handles them self.
  - (2) M5 x 24 mm - are to used last and are for securing BBQ to cart.
- The parts diagram has the parts labeled in the order in which they are used. Use the diagram as a reference, while following the steps below.

1. Bottom Cart Panel - Flip the panel upside down on a protected surface exposing the four locations where the casters attach. There are two runners on the bottom cart panel bottom with 4 nutserts (female threaded inserts which a screw goes into) on each end of each runner. This is the location where the casters install. (see figure A)
2. Attach the four casters - Use the locations described above and tighten completely. Once complete, lock the locking casters and then turn the bottom panel right side up. (see figure B)

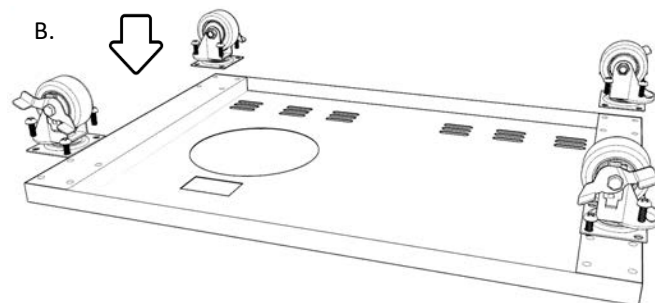
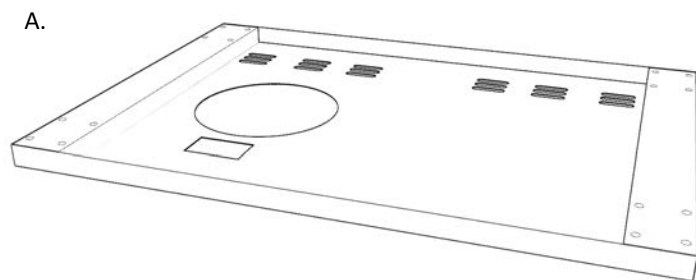

3. Attach the LP tank Support - This piece gets installed on the underneath side of the cart with the two screws going into it from the top of the bottom cart panel. The large bolt on the LP tank support threads into the LP tank's lower ring to hold it firmly onto the cart bottom. Install the LP tank support with two screws and tighten. (see figure C)

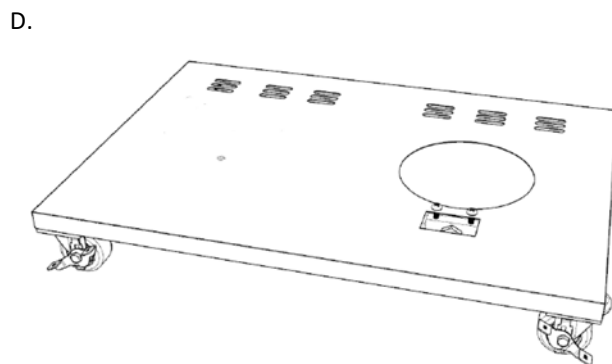
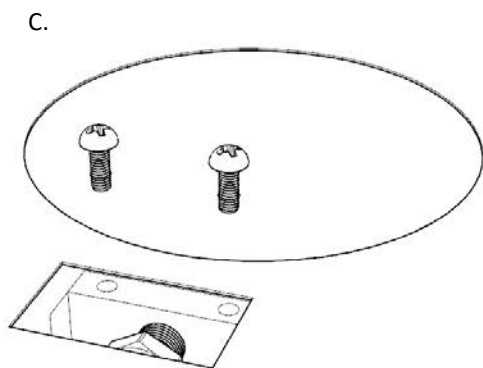

**For the remainder of the grill cart assembly, the use of a second person is recommended and will make for an easier time assembling**



4. Attach the right and left side cart panels - The right and left side panel can be identified as follows. The top rail of each side cart panel is a solid surface with no openings for anything to screw downward into it. The bottom sides have three openings per panel for screws which are used to attach to the bottom cart panel. The Front side of each cart panel has a cluster of three nutserts within 1.5" of each other which attach the front strut assembly. Attach both the left and right side panels to the bottom cart panel using three screws per side. **Do not completely tighten.**

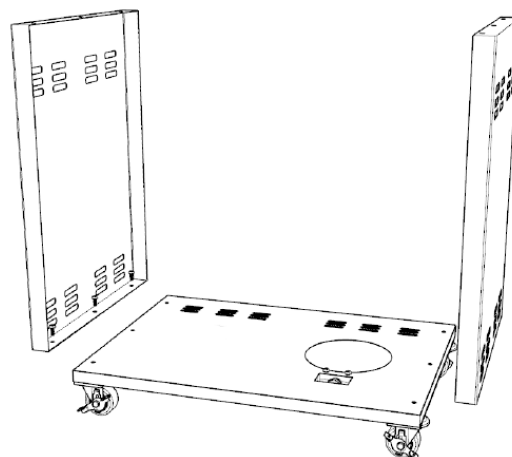
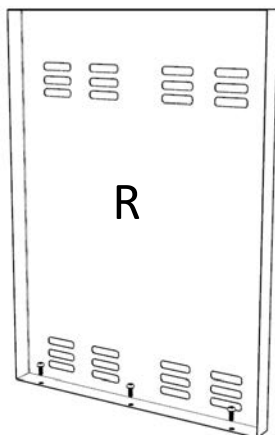
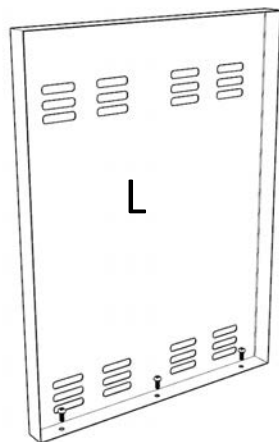

5. Attach Bottom Back Panel - The bottom back panel first gets secured to the Bottom Cart Panel with screws (The bottom of the panel has openings for screws to go through, see diagram). The amount of screws used vary by the size of the grill cart you are assembling. **Attach but to not tighten.** Next secure the Bottom Back Panel to the right and left side panels. Three screws get used per side. **Attach but do not tighten.**

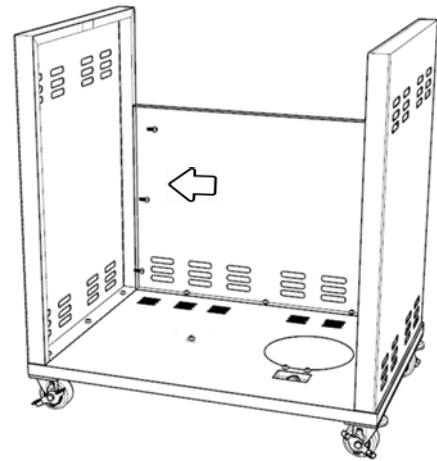
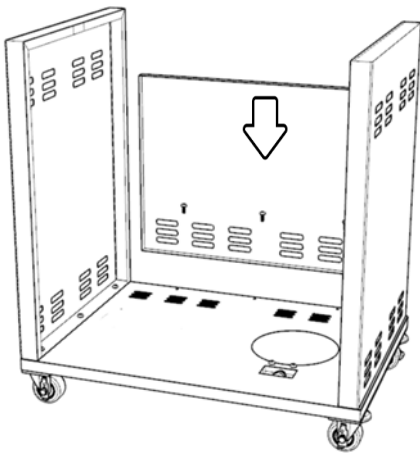

6. Attach Upper Back Panel - This panel gets attached to the left and right panel with 2 screws per side. **Attach but do not tighten.** Attach the Tank Interference Bracket - (Not included for a 3 burner cart model). This pieces are to intended interfere with a second LP tank being stored inside the grill cart which is not permitted. Using 4 screws, attach and tighten the Tank Interference bracket to the 4 nutserts adjacent to the large circular cutout for the LP tank (see figure D)

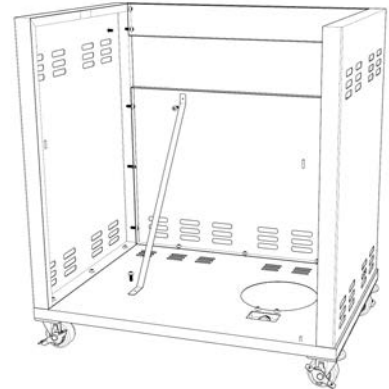
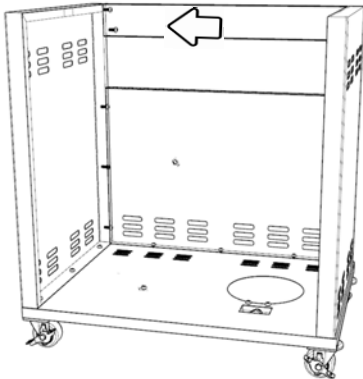

7. Attach Door Handles to the Doors - The door handles and hardware come packaged separately from the rest of the hardware. Two screws (M6x8) hold each handle to the door. Take care as to not scratch the doors by laying them on a soft surface. Hint: While on a soft surface on a work area like a table, hang the door off the edge just to the point where the holes are exposed for door handle. Place the screw in your screw driver then guide the screw into the hole on the door. Once in place, move the handle to the screw and get it started a small amount. This gives flexibility when attaching the second screw. Once both screws are in place, **tighten completely.**

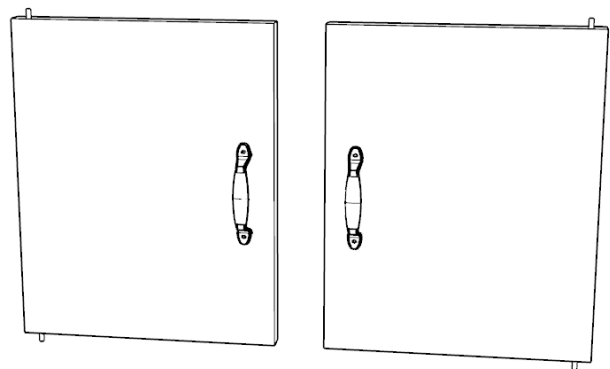
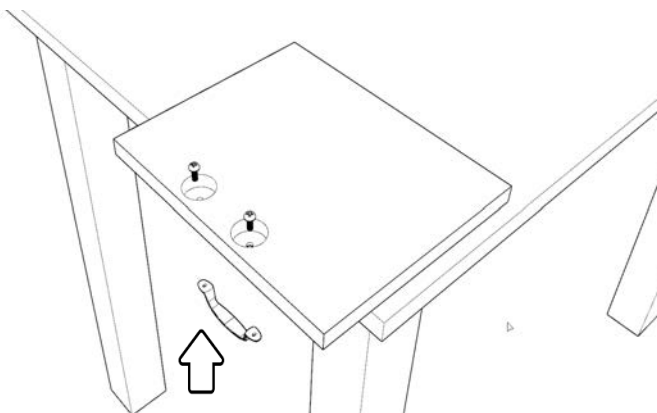

8. Attach the front doors & The Front Strut Assembly - The door hinge pins are supported by the opening on the top of the bottom cart panel and at the bottom of the Front Strut assembly. On the larger 4+ 5 burner carts, the doors are large enough to accommodate a paper towel holder on one side. The L shaped wire to hold the paper towels are positioned towards the top of the door which allows you to identify the left and right hand door. Using your helper, place the door hinges first into the top of the bottom cart panel then into the bottom of the front strut. While your partner holds everything in place, attach the front Strut to the left and right hand side panels using three screws per side. **At this point, all screws from the earlier steps can be completely tightened.**

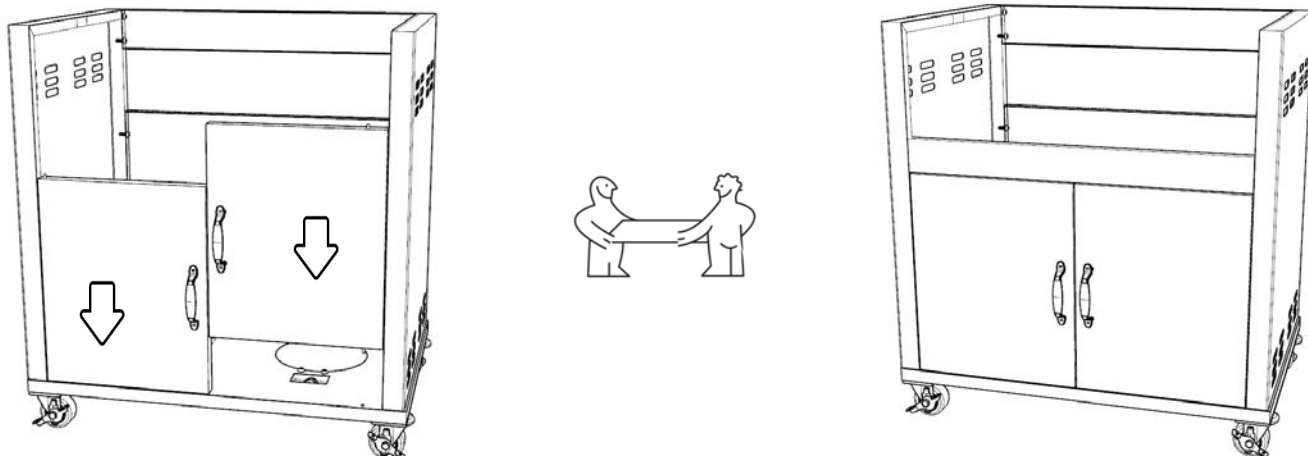

9. Attach lower magnetic catch - Two screws hold the catch to the bottom cart panel. Place the lower magnetic catch in place and attach with the two screws. Both the top and bottom magnetic catches can be moved forwards and backwards in order to allow the doors to stop at a flush position with the cart frame. Adjust if necessary.

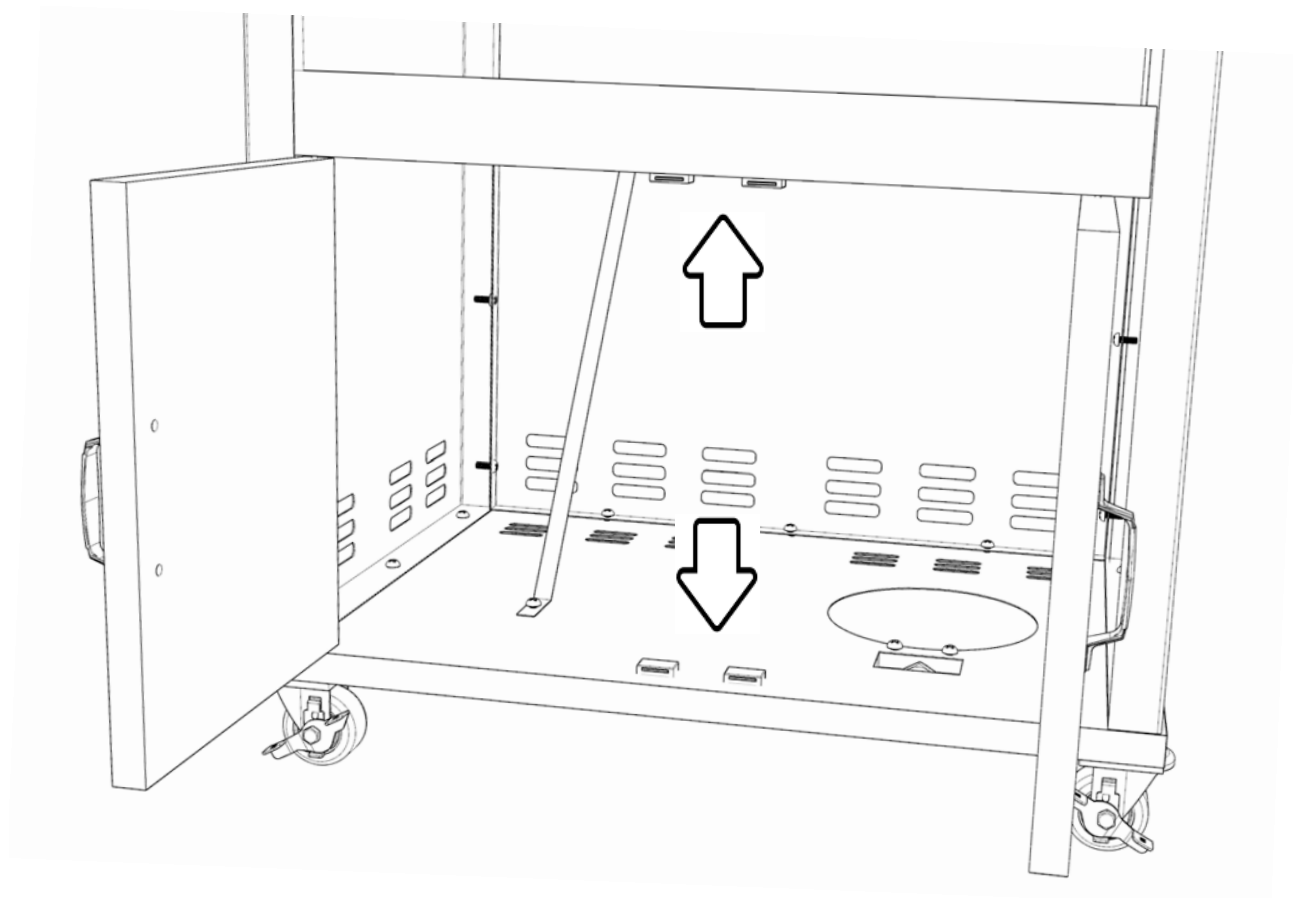

10. Attach soft close hinge - please follow below instructions

**Side adjustment**

Rotate front screw to increase or decrease door overlay ( $\pm 2$  mm).

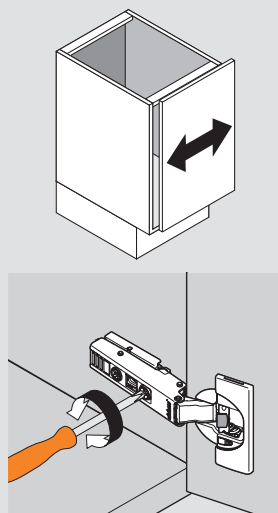

**Height adjustment**

Rotate cam screw on mounting plate to adjust door position ( $\pm 2$  mm).

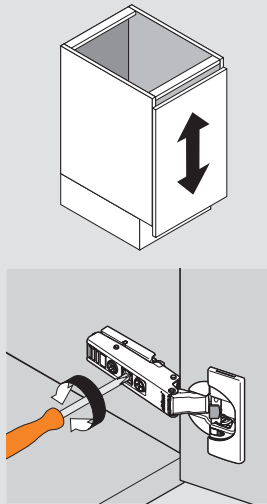

On non-cam mounting plates, loosen screws, adjust door and retighten screws.

**Depth adjustment**

Rotate rear spiral tech cam screw to adjust door gap (+3 mm, -2 mm).

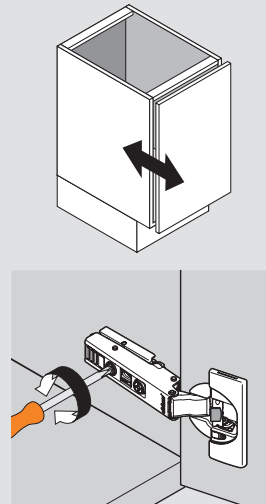

11. Adjusting door close tension.

For small or light doors, the BLUMOTION can be deactivated on one of the hinges.

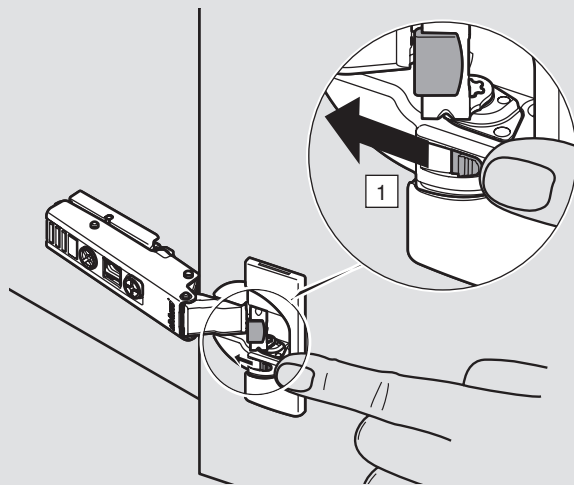

Door must be closed once for the deactivation to be complete. To reactivate, move switch back to original position.

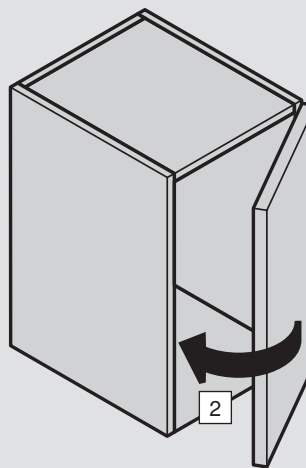

12. Attach Side Shelves - Four screws per shelf are used to attach to the right and left side panels. Both shelves are exactly the same and can be used on either side. Start all 4 screws into the side panel as the shelf can then simply be placed over the screws and pushed downward in place. Once in place, tighten completely.

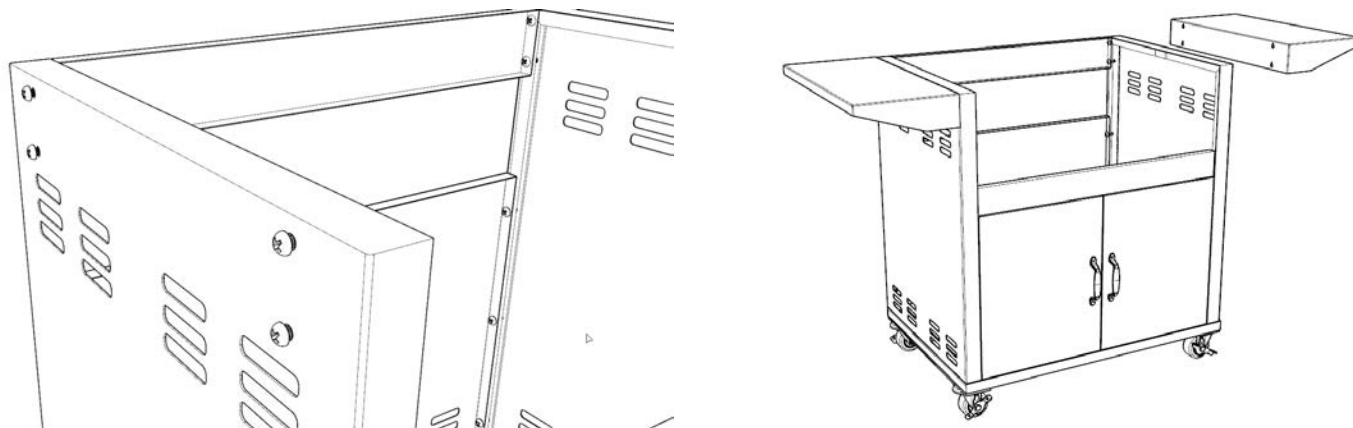

13. The grill gets placed into the grill cart and attached with two screws. Always use a partner when lifting the grill, and removing the inside parts above the burners can reduce the weight of the grill and make it easier to lift. With the cooking grids still removed, you will see an opening towards the front left and right hand side on the inside of the grill body. One screw per side goes through the inside of the grill and attaches to the grill cart. Tighten these screws but do not over tighten.

