

Product: 36-inch French Door Built-in Refrigerator
Model Number: XRF3619BFP

FEATURES & BENEFITS

- Flush Hinge Installation Benefits:** Seamlessly integrates with cabinetry for a polished look, enhancing kitchen aesthetics.
- Digital Display:** Conveniently monitor settings and temperatures at a glance for precise control and food preservation.
- Soft-close Drawers:** Ensures gentle and silent closing, preventing slamming and reducing wear and tear over time.
- Customized Modes:** Tailor refrigerator operation with Sabbath, Holiday, and ECO modes, optimizing energy usage and functionality.
- Interior Water Dispenser:** Provides easy access to clean and fresh water, especially convenient for units equipped with an ice maker.
- Height-adjustable Shelves:** Offers flexibility in organizing storage space, accommodating items of various sizes with ease.
- Spill-proof Glass Shelves:** Facilitates easy cleaning and maintenance, preventing spills from reaching other parts of the refrigerator.
- LED Interior Lighting:** Illuminates the interior for better visibility, making it easier to locate items and enhancing the overall user experience.
- Ultra-quiet Operation:** Operates at an ultra-quiet 43 dB(A) for a peaceful kitchen environment without compromising performance.
- Appliance Leveling Capability:** Front-leveling capability ensures optimal stability and alignment, preventing issues related to uneven surfaces.
- Easy Door Panel Alignment:** Simplifies the adjustment of door panels for a polished and cohesive appearance in the kitchen.

TECHNICAL DETAILS

Total Capacity (cu. ft.)	19.6
Refrigerator Capacity (cu. ft.)	14
Freezer Capacity (cu. ft.)	5.6
Amperage or Current (A)	3
Volts (V)	120
Frequency (Hz)	60
Plug Type	3-Prong Grounding Plug
Power Cord Length (in.)	86.6
Energy consumption	589 kwh/yr



WARRANTY: 2 YEARS PARTS AND LABOR





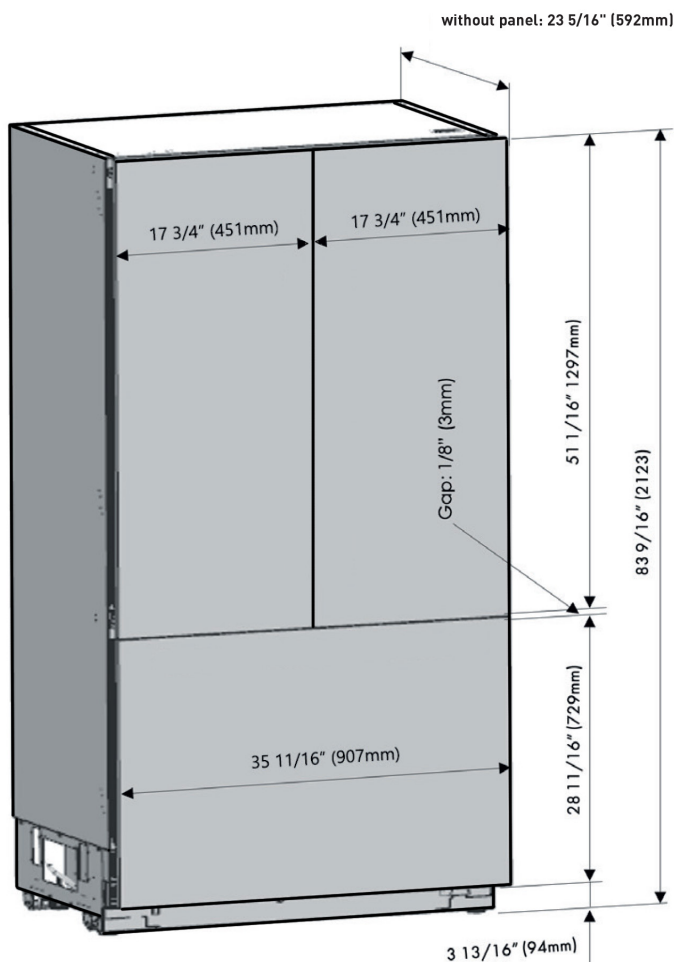

GENERAL PROPERTIES

Number Of Doors	3
Number Of Shelves	3
Number Of Freezer Baskets	2
Number of Door Bins	6 (5 + 1 Gallon Bin)
Adjustable Racks & Removable Shelves	3
Shelf Material	Glass
Reversible Door Swing	No
Soft Closing Drawer Feature	No
Water Filter	Yes
Lighting	LED
Freezer Defrost Process	Automated Defrosting
Refrigerator Adjustable Temp	+36°F(2°C) to +46°F(8°C)
Chiller Zone Adjustable Temp	+30°F(-1°C) to +41°F(5°C)
Freezer Adjustable Temp	+5°F(-15°C) to -11°F(-24°C)

PRODUCT DIMENSIONS & WEIGHTS

Product Dimensions (WxHxD) (in.)	83 9/16 x 35 3/4 x 23 5/16
Package (WxHxD) (in.)	90 9/16 x 38 3/16 x 26 3/8
Product Extra Width Clearance with Door Open 90 Degrees (in.)	42
Product Height to Top of Refrigerator (in.)	83-9/16 (+1)
Cutout Dimensions (WxHxD) (in.)	84 x 36 x 25
Product Weight (lbs)	355
Packed Weight (lbs)	400

STAINLESS STEEL DOOR PANELS WITH HANDLE SET FOR XRF3619BFP (DKXRF3619BFP-SS)

Fridge Door Dimensions (WxHxD) (X2)	17-11/16 x 51-1/16 x 3/4
Weight (lbs.) (X2)	21.8
Freezer Door Dimensions (WxHxD)	35-3/4 x 28-11/16 x 3/4
Weight (lbs.)	23.8

Replacement Water Filter: WFX200BM

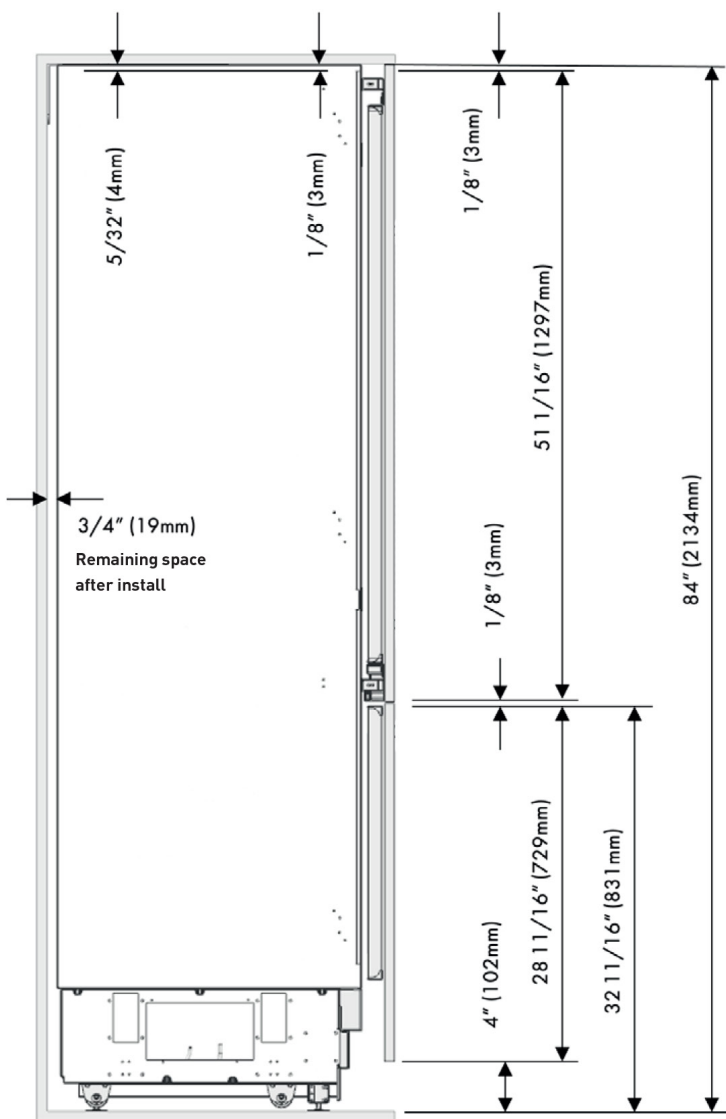

Plumbing

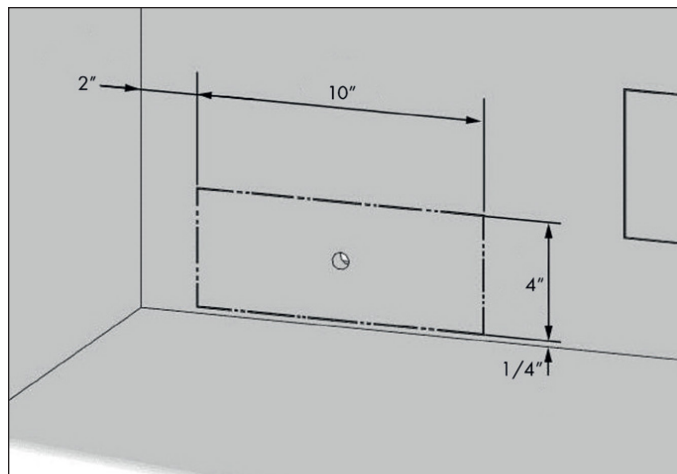

Electrical

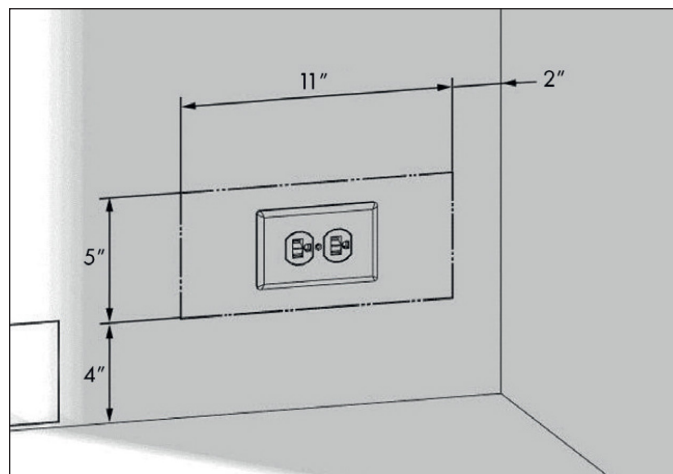

Water pressure

- The water pressure of the cold water supply must be between 25-80 psi (1.7-5.5 Bar)
- If the water pressure exceeds 80 psi (5.5 Bar), install a pressure limiting device or water impact protector to the water inlet valve
- Do not install or operate the appliance if the water pressure exceeds 120 psi (8.3 Bar)
- If there are issues with the water pressure, contact a qualified plumber.