

MASTERBUILT®

Control Panel Instruction Sheet

Control Panel GF34G1M



CAUTION



- Make sure your fryer has fully cooled to avoid burns.
- Some components may have sharp edges. Use caution to avoid injury.

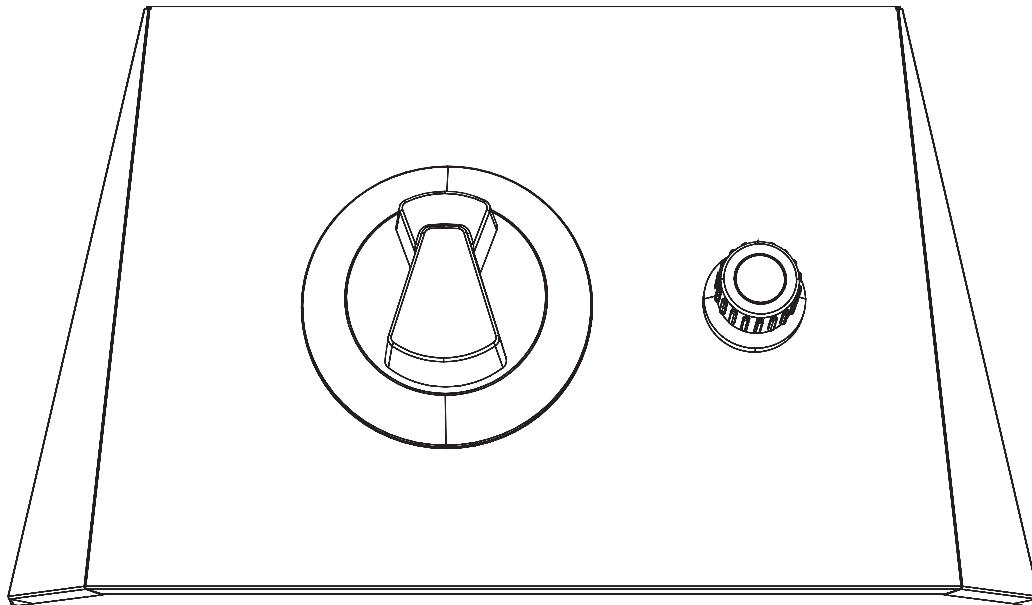

Some models have an access panel that makes valve removal unnecessary. Remove the access panel above the valve and go to step 5.

1



Tools Needed: 10mm Allen Wrench, Crescent Wrench, and Phillips Head Screw Driver.

2

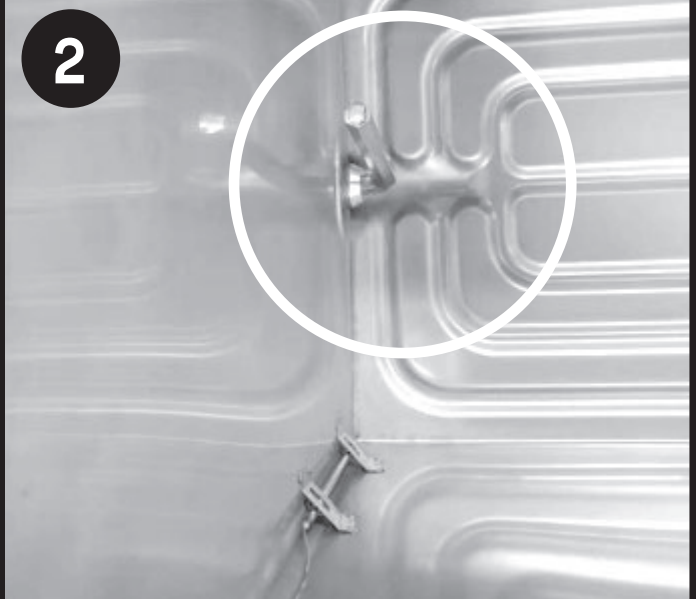

For valve removal, use 10mm Allen Wrench on the inside of the pot.

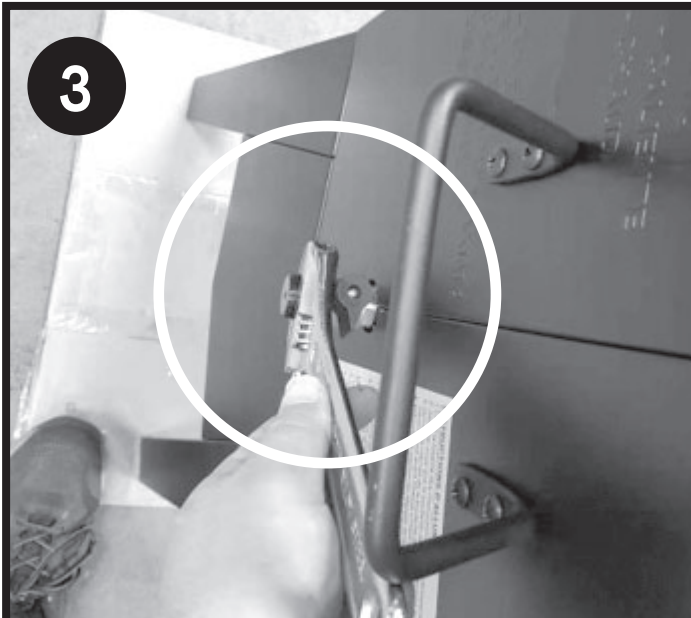

For spicket removal, use Cresent Wrench on the outside of valve.

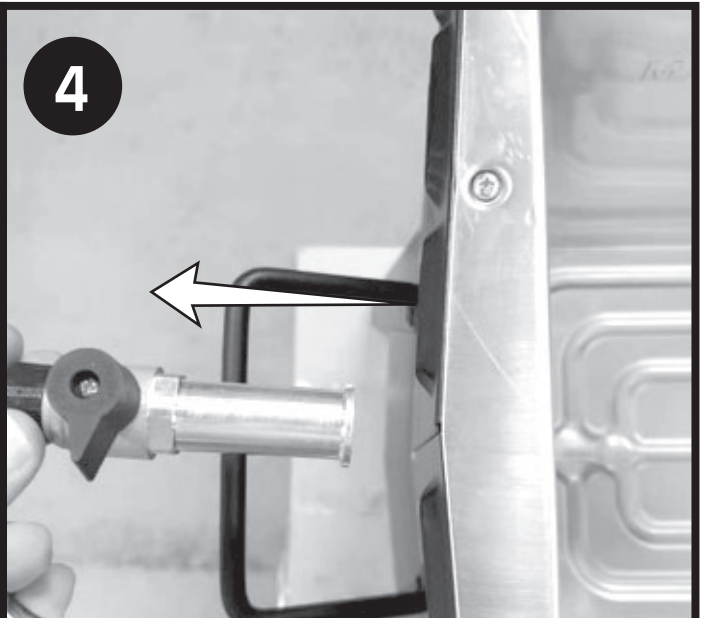

Remove the valve.

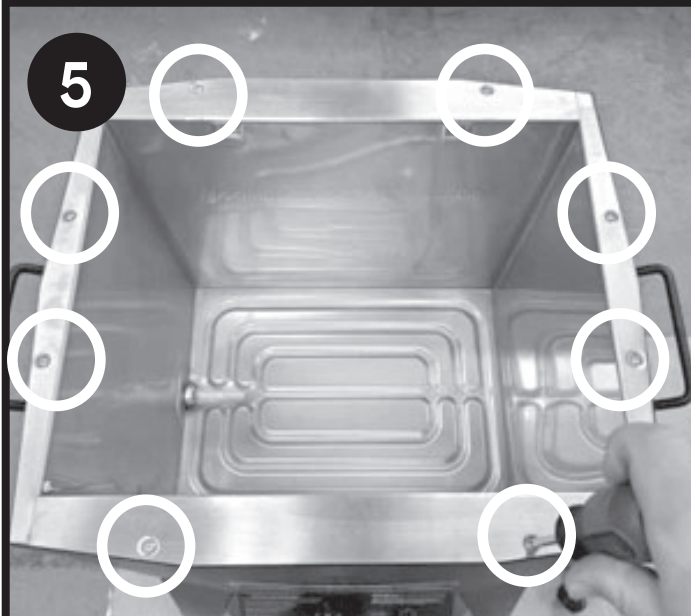

Remove eight (8) Screws from the oil pot.

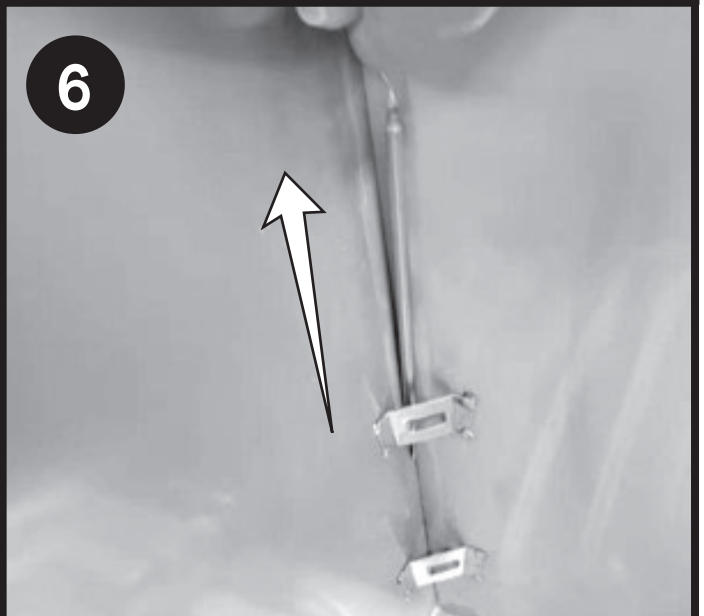

Remove oil capillary.

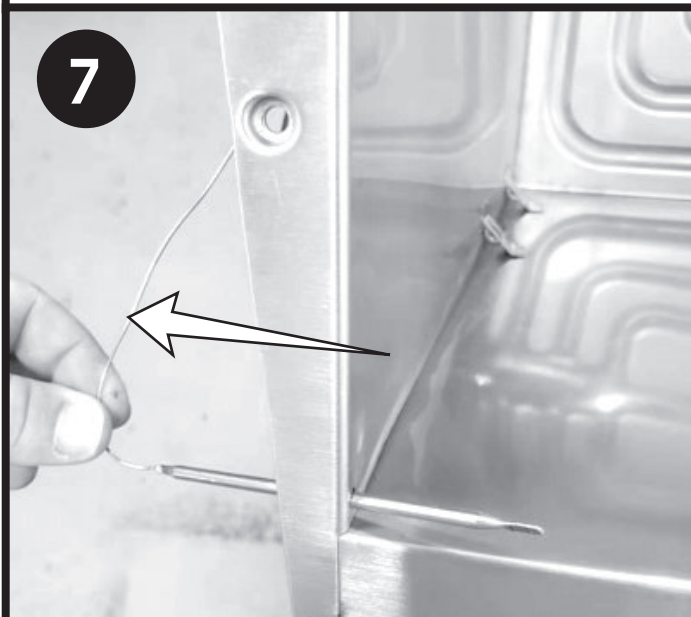

Remove oil capillary from the pot.

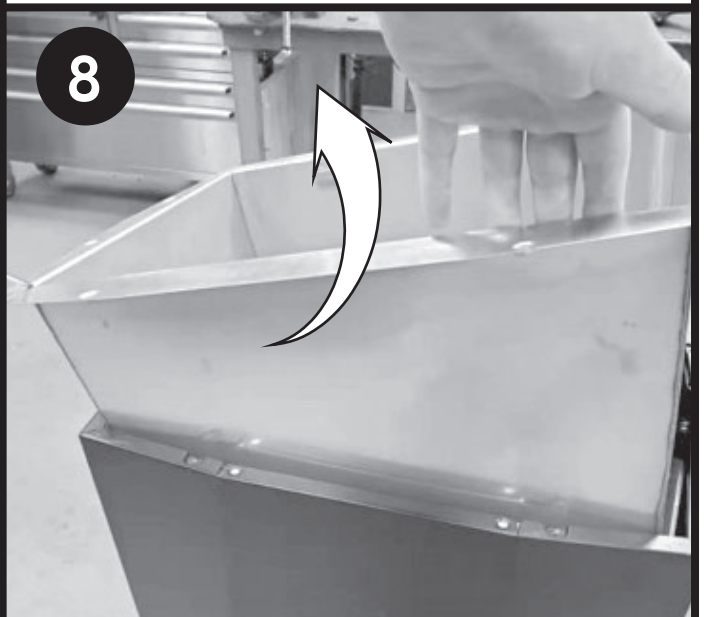

Remove the pot.

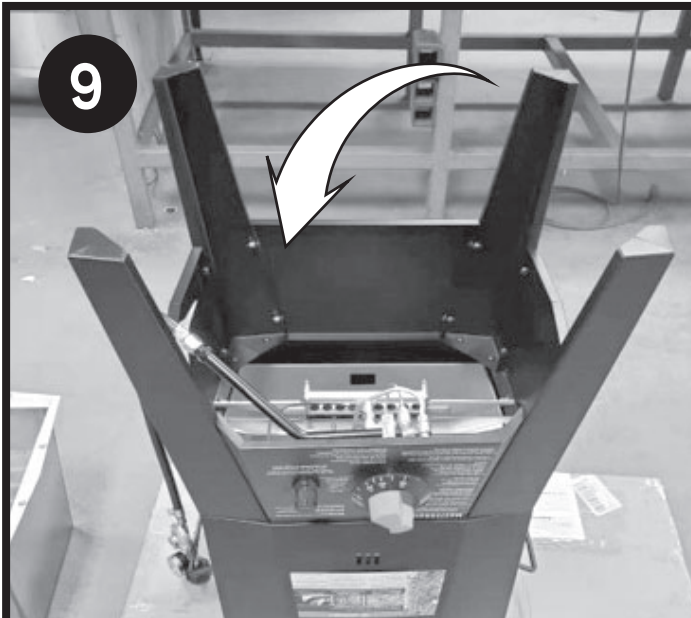

Turn the fryer body upside down.

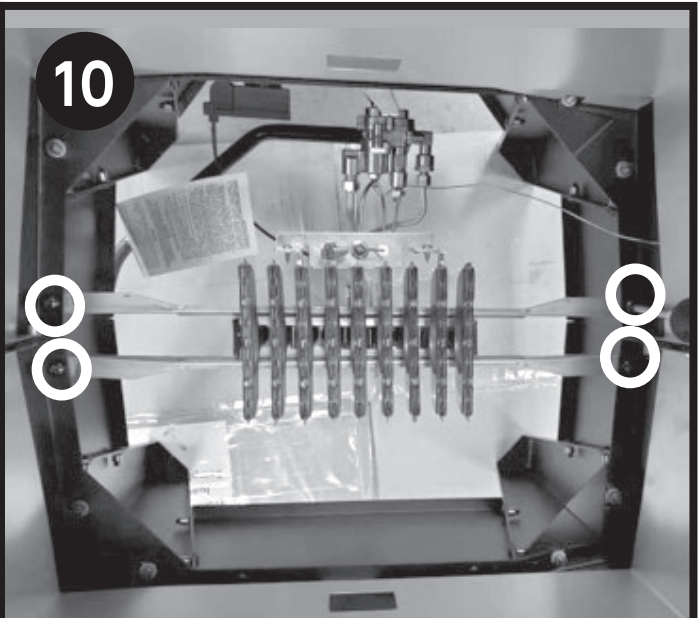

Remove the four (4) Screws holding the bracket.

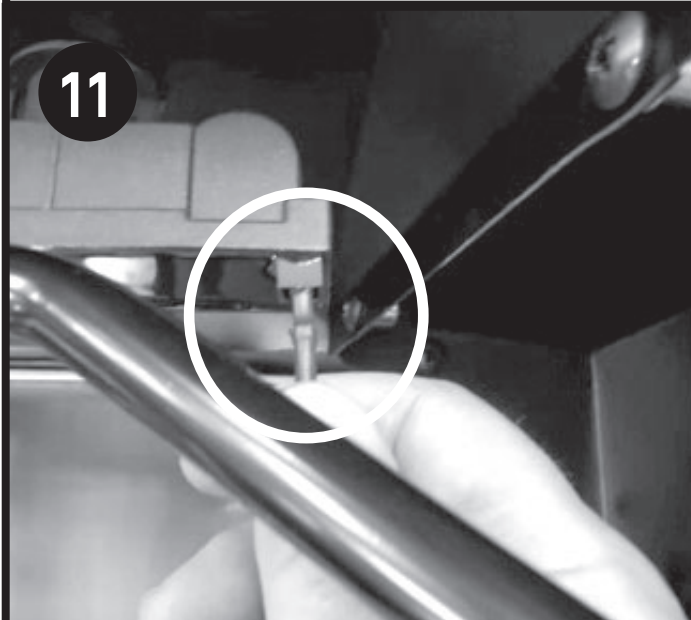

Unplug the wire from the ignitor.

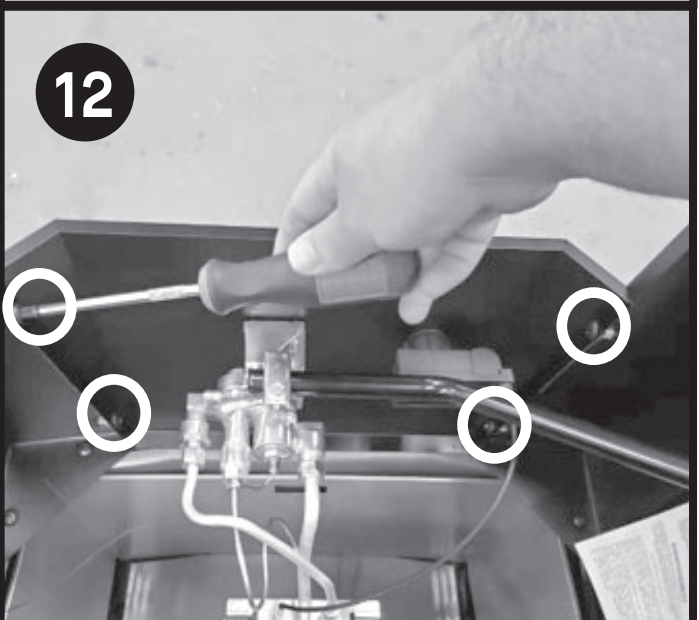

Remove four (4) Screws from control panel and remove the component.

INSTALLATION:

- Follow steps in reverse order 12-2.
- Replace the control panel with (4) Screws (see step 12).
- Plug in the wire to the ignitor (see step 11).
- Screw in the (4) Screws that hold the bracket (see step 10).
- Return the fryer to upright position.
- Install the pot.
- Install the oil capillary (see steps 6-7).
- Secure the oil pot with (8) Screws (see step 5).
- Replace the valve (see steps 2-4).



MASTERBUILT®

Rest assured, we're here to help.
Rassurez-vous, nous sommes là pour vous aider.
Tenga la seguridad de que estamos aquí para ayudarlo.

Customer Service
Service à la clientèle
Servicio de atención al cliente

masterbuilt.com/contact-us
masterbuilt.com/warranty
masterbuilt.com/collections/parts

@masterbuilt



masterbuilt.com

