

## TECHNICAL DRAWING

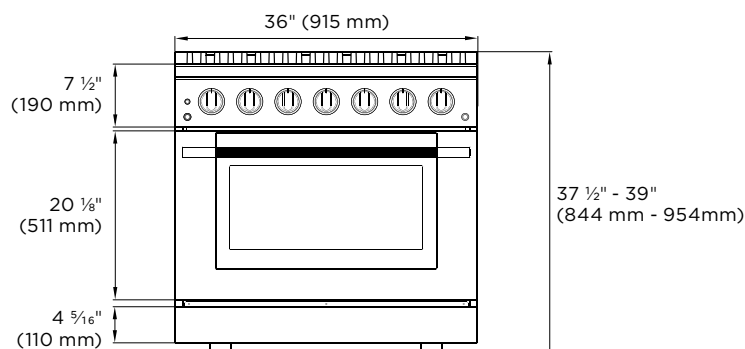

FRONT

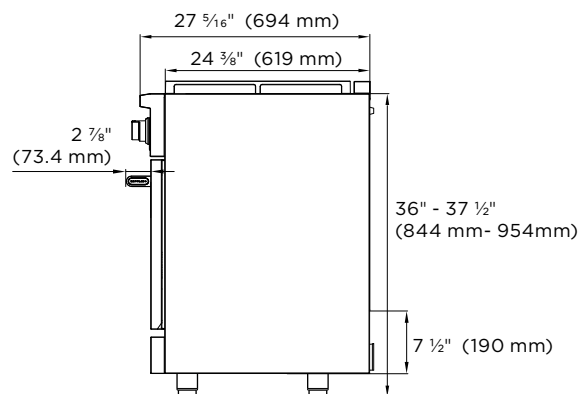

SIDE

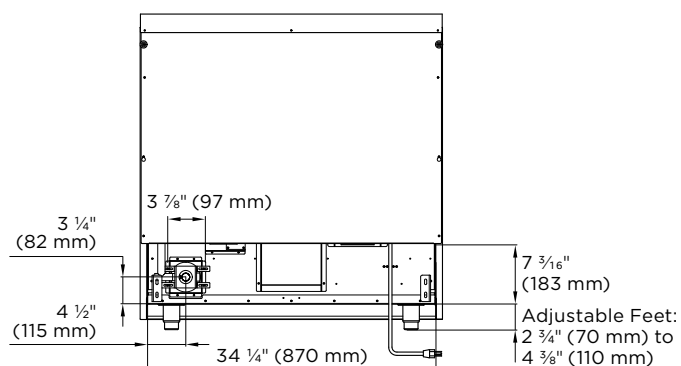

BACK

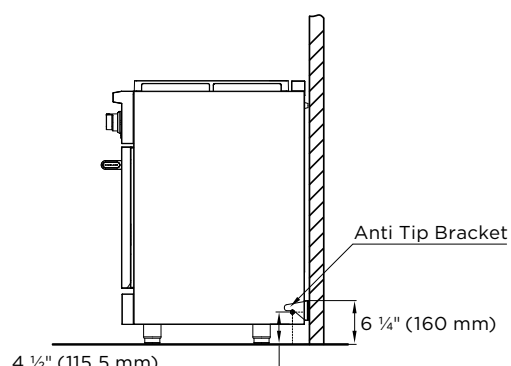

ANTI TIP

## RANGE PLACEMENT MEASUREMENTS

<b>W</b>	<b>CABINET CUT OUT DIMENSIONS (WxDxH)</b>	36 1/4" x 24 3/4" x 36"
<b>1</b>	<b>STANDARD DEPTH OF CABINET ABOVE COOKTOP</b>	13" (330 mm)
<b>2</b>	<b>DEPTH FROM REAR OF CHASSIS TO FRONT OF CONTROL PANEL</b>	27 5/16" (694 mm)
<b>3</b>	<b>MINIMUM CLEARANCE (COUNTERTOP TO CABINET, BOTH SIDES OF RANGE)</b>	18" (457 mm)
<b>4</b>	<b>COOKTOP SIDE TO CABINET CLEARANCE (ADJACENT WORKING AREAS)</b>	6" (152 mm)
<b>5</b>	<b>MINIMUM CLEARANCE FROM COOKTOP TO VENTILATION HOOD</b>	30" - 36" (762 - 914 mm) Depending on Your Hood Model
<b>6</b>	<b>COOKTOP HEIGHT FROM FLOOR (TO COOK SURFACE)</b>	37 1/2" to 39" (953 - 991 mm) Depending on Leveling and Installation Height
<b>7</b>	<b>GAS AND ELECTRICAL CONNECTION AREA (MAXIMUM DEPTH)</b>	Max Depth of Gas / Electric Rough-in Area: 2 13/16" (71 mm) from the Rear Wall

<b>8</b>	<b>GAS &amp; ELECTRICAL ZONE (WIDTH)</b>	28" (Approx.)
<b>9</b>	<b>GAS AND ELECTRICAL CONNECTION AREA (MAXIMUM HEIGHT)</b>	Vertical Space from Floor to Gas / Electric Rough-in Area: 4 1/2" (114 mm) from the Floor
<b>A</b>	<b>GAS AND ELECTRICAL HOOKUP ZONE (WxH)</b>	36 1/4" x 21"

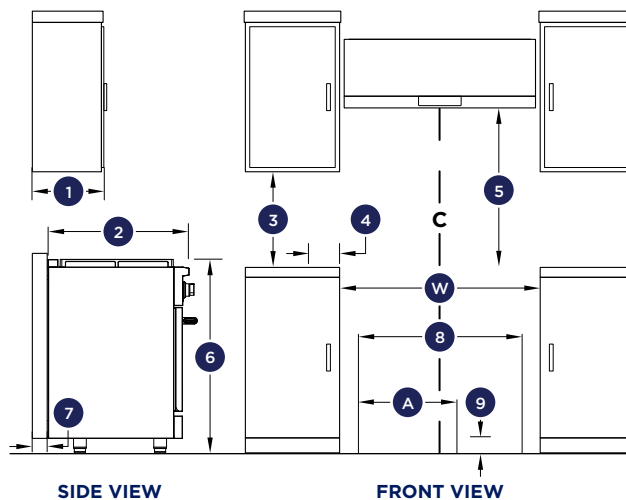

## TECHNICAL DRAWING

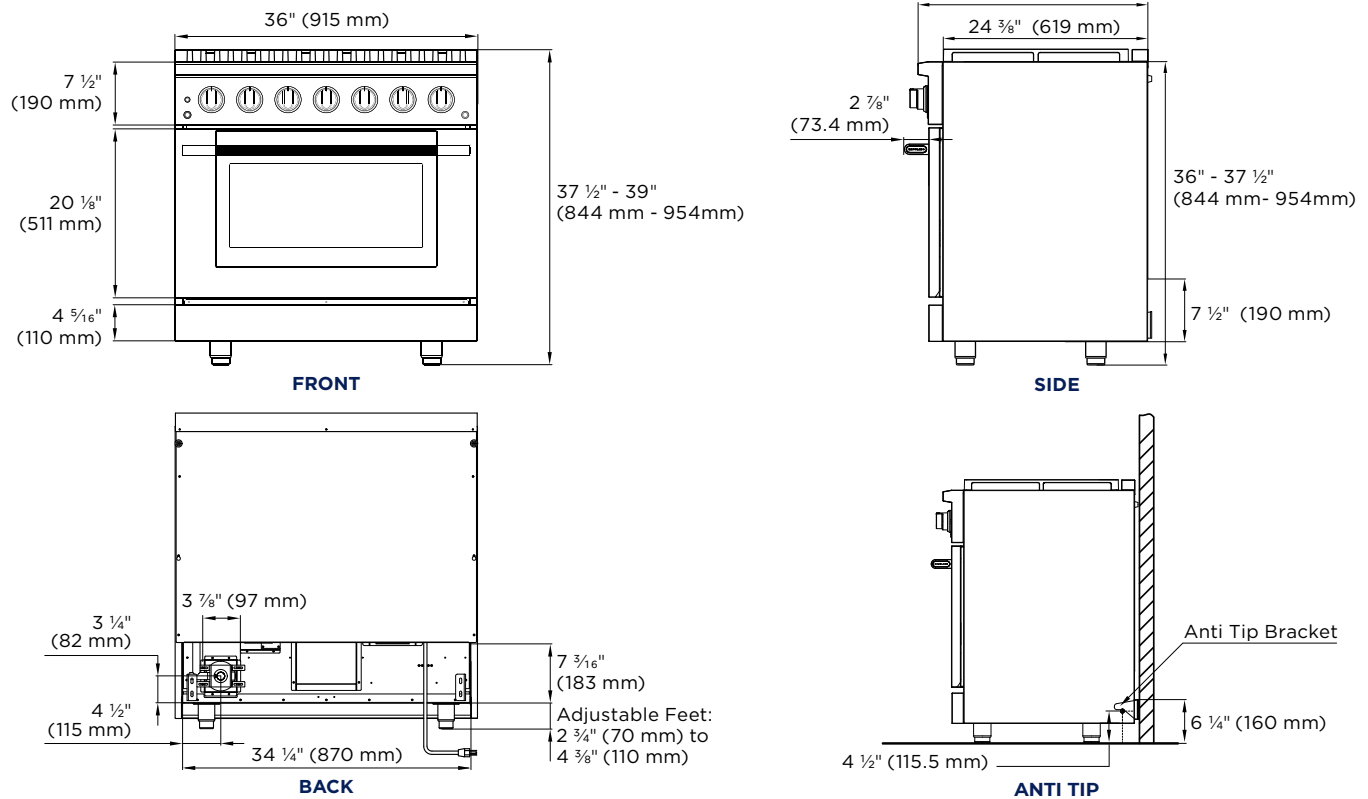

## RANGE PLACEMENT MEASUREMENTS

<b>W</b>	<b>CABINET CUT OUT DIMENSIONS (WxDxH)</b>	36 1/4" x 24 3/4" x 36"
<b>1</b>	<b>STANDARD DEPTH OF CABINET ABOVE COOKTOP</b>	13" (330 mm)
<b>2</b>	<b>DEPTH FROM REAR OF CHASSIS TO FRONT OF CONTROL PANEL</b>	27 5/16" (694 mm)
<b>3</b>	<b>MINIMUM CLEARANCE (COUNTERTOP TO CABINET, BOTH SIDES OF RANGE)</b>	18" (457 mm)
<b>4</b>	<b>COOKTOP SIDE TO CABINET CLEARANCE (ADJACENT WORKING AREAS)</b>	6" (152 mm)
<b>5</b>	<b>MINIMUM CLEARANCE FROM COOKTOP TO VENTILATION HOOD</b>	30" - 36" (762 - 914 mm) Depending on Your Hood Model
<b>6</b>	<b>COOKTOP HEIGHT FROM FLOOR (TO COOK SURFACE)</b>	37 1/2" to 39" (953 - 991 mm) Depending on Leveling and Installation Height
<b>7</b>	<b>GAS AND ELECTRICAL CONNECTION AREA (MAXIMUM DEPTH)</b>	Max Depth of Gas / Electric Rough-in Area: 2 13/16" (71 mm) from the Rear Wall

<b>8</b>	<b>GAS &amp; ELECTRICAL ZONE (WIDTH)</b>	28" (Approx.)
<b>9</b>	<b>GAS AND ELECTRICAL CONNECTION AREA (MAXIMUM HEIGHT)</b>	Vertical Space from Floor to Gas / Electric Rough-in Area: 4 1/2" (114 mm) from the Floor
<b>A</b>	<b>GAS AND ELECTRICAL HOOKUP ZONE (WxH)</b>	36 1/4" x 21"

