



810 WEST WASHINGTON BOULEVARD
CHICAGO, IL 60607

8566 KRUM AVENUE
GALESBURG, MI 49053

KALAMAZOOGOURMET.COM
+1.800.868.1699

AFPO-B Artisan Fire Pizza Oven



PRODUCT FEATURES

- 24" x 18" ceramic cooking deck
- Natural gas, bulk propane or propane cylinder
- Battery-powered electronic ignition
- Masonry installation, 6" gas vent (grease duct) required
- Full extension glides extend oven from enclosure for cleaning
- Stainless steel access door available
- Marine-grade stainless steel available

Overall Width / Installation Width	32.94 in (837 mm) / 31.13 in (790 mm)
Overall Depth / Installation Depth	32 in (814 mm) / 28.5 in (725 mm)
Overall Height / Counter Height	23.13 in (588 mm)
Approximate Product Weight	150 lb (68 kg)
Gas Requirements	Natural Gas: 3/8" (10 mm) male NPT connection. 12 ft. (366 cm) gas hose with quick disconnect provided. Gas service line to deliver 7 i.w.c. at grill location. See BTU information below for pipe sizing.
	Bulk Propane: 3/8" (10 mm) male NPT connection. 12 ft. (366 cm) gas hose with quick disconnect provided. Gas service line to deliver 11 i.w.c. at grill location. See BTU information below for pipe sizing.
	Propane Cylinder: 20 lb (9.1 kg) cylinder. 6 ft. (153 mm) gas hose with dual regulator provided.
Electrical Requirements	1.5V "AAA" battery x 1
Total BTUs	36,000 BTU propane / 43,500 BTU NG

Ensure proper gas pipe sizing. Diameter and length of the supply pipe may limit the pressure and BTU delivery.

For outdoor use only. For installation within a non-combustible structure. Maintain at least 5 inches (127 mm) of clearance between the sides and back of the oven and the interior of the structure in which it is installed. 24 inches (610 mm) is required above. Access below the oven within the structure is required.

6-inch (153 mm) ventilation duct work required (not included). Mounting colklar for easy connection to Metal-Fab Inc. G-Series provided. See NFPA 54 and your local gas codes for specifications for venting your project.

High altitude kit available.

WARNING: This product can expose you to chemicals including nickel, which are known to the State of California to cause cancer, and lead, which is known to the State of California to cause birth defects or other reproductive harm. For more information go to www.P65Warningsca.gov



810 WEST WASHINGTON BOULEVARD
CHICAGO, IL 60607

8566 KRUM AVENUE
GALESBURG, MI 49053

KALAMAZOOGOURMET.COM
+1.800.868.1699

AFPO-B Artisan Fire Pizza Oven

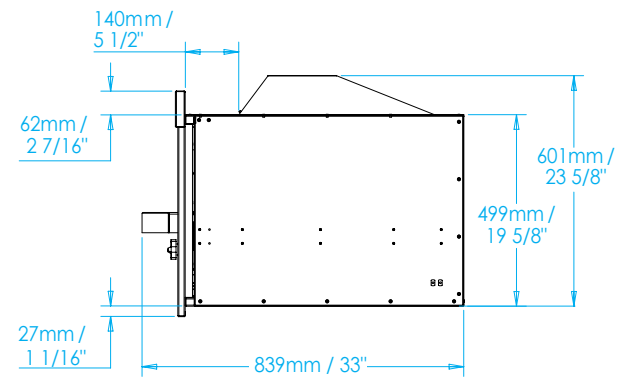
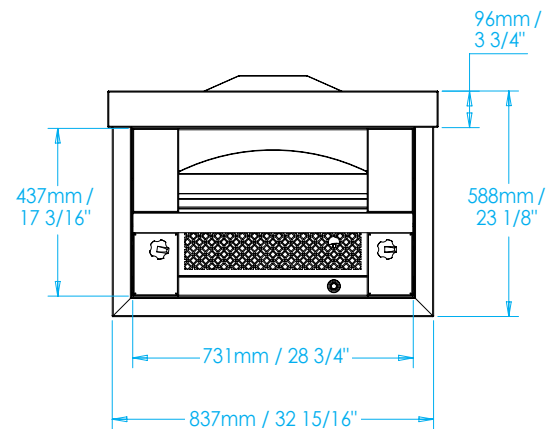
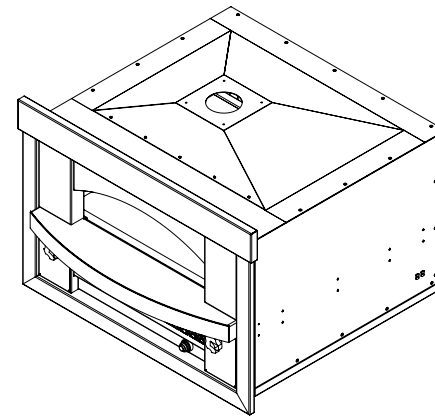
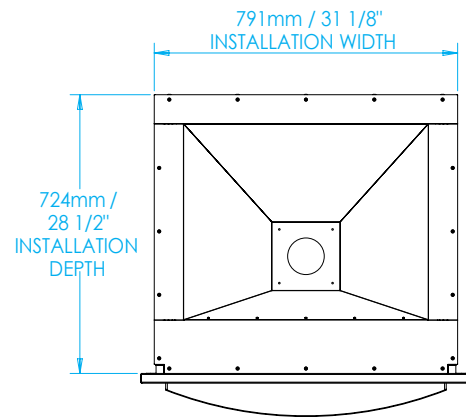



810 WEST WASHINGTON
BOULEVARD CHICAGO, IL 60607

8566 KRUM AVENUE
GALESBURG, MI 49053

KALAMAZOOGOURMET.COM
+1.800.868.1699

AFPO-B Artisan Fire Pizza Oven

ACD-AFPO-L/R

Access Door for Built-In Pizza Oven

Available in 304 grade or 316L Marine Grade

Stainless Steel

