

The Savant® In-Wall Wireless Charging Dock (IDC-T000) Quick Reference Guide provides the information necessary to install the In-Wall Charging Dock for Apple iOS devices.



### Box Contents

- (1) In-Wall Wireless Charging Dock Assembly (IDC-T000)
- (1) Cut out template (009-0245-xx)
- (1) Installation Kit (075-0065-xx)
  - (1) 24V DC 60 Watt Power Supply (025-0046-xx)
  - (1) Power Cable (2 ft) (064-0048-xx) or appropriate international cord
  - (1) 2-position Phoenix Connector (028-9160-xx)
  - (1) 4-position Phoenix Connector (028-0359-xx)
  - (4) #6 x 1.5 Screw (039-0173-xx)
  - (4) #6-32 x 2.25 Screw (039-0209-xx)
- (1) Quick Reference Guide (this document)

### Accessories

- (1) In-Wall Bezel for iPod 1-Pack (BZB/W/A/P-1iPod-xx) Black/White/Almond/Primer
- (1) In-Wall Bezel for iPod 5-Pack (BZB/W/A/P-5iPod-xx) Black/White/Almond/Primer (Single color per 5-Pack)
- (1) Construction Box for In-Wall Dock (RIB-IT00)

### Specifications

Environmental	
Operating Temperature	32° to 104° F (0° to 40° C)
Operating Humidity	10% to 90% Non-condensing
In-Wall Dock – Dimensions and Weight	
Dimensions (H x W x D)	6.3 in x 3.6 in x 2.5 in (16. cm x 9.1 cm x 6.4 cm)
Weight	1.0 lb/0.45 kg
In-Wall Dock Bezel – Dimensions and Weight	
Dimensions (H x W x D)	6.4 in x 3.7 in x 0.14 in (16.3 cm x 9.4 cm x 0.35 cm)
Weight	0.25 lb/0.11 kg
Power	
Supply	24V DC, 120-230V AC, 50/60Hz
Maximum Power Draw	5.5 watts
Power cable length	300 ft maximum AWG 22
Compliance	
Safety and Emissions	FCC Part 15/CE Mark/C-Tick
RoHS	Compliant

**⚠ SURGE PROTECTION:** Use a surge-protected circuit for all components requiring 120/230V AC, 50/60 Hz source power.

**⚠ ELECTRICAL DISCONNECT:** The 120/230V AC, 50/60 Hz source power outlet and input power sockets should be easily accessible in the event of an electrical hazard or malfunction condition.

**⚠ ELECTRICAL DISCONNECT:** Remove power before working on the dock.

### Wiring to Dock

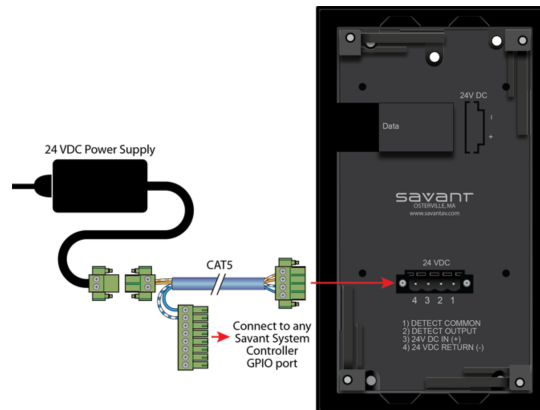

Charging Dock Pinouts	
1	Detect Common
2	Detect Output
3	24V DC in (+)
4	24V DC Return (-)

The charging dock iPod Detect signal is designed to connect to one of the Savant Controller GPIO input connections. The charging dock will pull the GPIO input low when an iPod is inserted into the dock.

### Installation without RIB-IT00 Construction Box

**Note:** The iPod dock can be installed in either landscape or portrait orientation.

1. Plug the AC power source to the Power Strip (surge protected).
2. After making the connections to In-Wall Dock, position the unit in the opening and secure with the four rotating mounting tabs.
3. Turn the tab screws clockwise; the tabs will grab the interior wall. Tighten until snug. **Do not over tighten.**

**Caution:** Do not use a powered screwdriver to tighten the tabs; the tabs can be easily over tightened.

**Note:** The In-Wall Dock also has optional screw mounting holes for optional stud mounting.

4. Position the bezel over the In-Wall Dock and press, ensuring that the wall plate seats properly.
5. Configure the installation using RacePoint Blueprint™.

**Note:** The In-Wall Dock also has optional screw mounting holes for optional stud mounting.

### Optional Pre/Post-Construction Box

**Note:** The In-Wall Dock Assembly is not a weather resistant unit. Do not locate in a damp or humid area.

The IDC-T000 can be installed with or without an in-wall construction box. The in-wall construction box for the iPod (RIB-IT00) is optional and can be used pre-or post-construction to save the space required for the ICC-T000 and to terminate the roughed in wires.

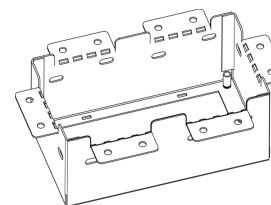

**⚠ Important:** Always locate the studs and utilities (electrical wires, ducts, water and gas pipes) before cutting an opening in the wall. Ensure all required power and control cables have been routed to the site of construction box.

### Installing the In-Wall Dock into the RIB-IT00

1. Remove Retainer caps (4) from the back of the IDC-T000 with pliers.
2. Remove tabs (4) by removing the screws.
3. Place the IDC-T000 into the RIB-IT00 and use the 8-32 screws (4) to attach.

**Caution:** Do not use a powered screwdriver to tighten the tabs; the tabs can be easily over tightened.

Copyright©2012 Savant Systems LLC, SAVANT and RacePoint Blueprint are trademarks of Savant Systems, LLC.

Apple®, iTunes®, iPad, iPad2, iPod touch®, iPod® Classic and iPod nano® are registered trademarks or trade names of Apple Inc.

All brand names, product names and trademarks are the property of their respective owners.

Savant Systems, LLC reserves the right to change product specifications without notice.

45 Perseverance Way, Hyannis, MA 02601 Phone 508.683.2500 Fax 508.683.2600 SavantSystems.com

Savant Confidential and Proprietary  
031512

### Install the iPod touch into the In-Wall Dock

1. Position the iPod into the In-wall dock as shown below.
2. Ensure the iPod slides through the brackets and is inserted fully.
3. Tilt the iPod back until it stops.
4. Secure the iPod to the In-Wall dock with the captive screw.
5. Attach bezel.

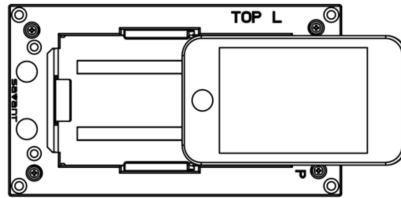
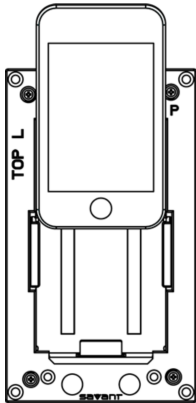

### Additional Documentation

For more documentation, go to [SavantSystems.com](http://SavantSystems.com) and navigate as follows:

> **Dealer Login** > **Knowledge Base** > **Products**

- Refer to the **Construction Box for On-Wall Dock (RIB-IT00) Quick Reference Guide**
- Refer to the **RacePoint Blueprint™ Programming Guide**

Made for



iPod



iPhone

### Install the Bezel

1. Position the bezel over the iPod in the In-Wall Dock.
2. Ensure the bezel seats properly.