

Icemaker Installation

E

Before you begin

Read each step thoroughly before proceeding.

CAUTION – Unplug the Refrigerator. To eliminate the danger of electric shock during installation, you must unplug the refrigerator from its electrical outlet.



Tools you will need



Flat blade and Phillips screwdrivers



Pliers

Parts Included

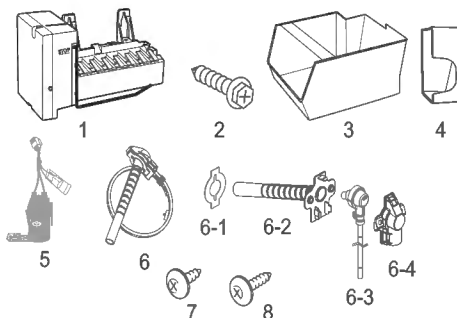

| No. | Part Name | Q'ty/Unit |
|-----|------------------------|-----------|
| 1 | CASE ICE MAKER | 1 |
| 2 | SPECIAL C/T BOLT | 2 |
| 3 | BOX ICE | 1 |
| 4 | GUIDE I/WATER | 1 |
| 5 | VALVE WATER AS | 1 |
| 6 | GUIDE CAB W/TUBE A1 AS | 1 |
| 6-1 | GUIDE CAB W/TUBE A1 | 1 |
| 6-2 | SEAL W/TUBE A1 | 1 |
| 6-3 | GUIDE CAB W/TUBE A2 AS | 1 |
| 6-4 | COVER GUIDE CAB W/TUBE | 1 |
| 11 | SCREW TAPPING | 2 |
| 12 | SCREW TAPPING | 2 |

Remove the outlet cover

Go to the back of the refrigerator. Find the small label in the upper right corner and remove it off. Then discard the label.

Remove the white connector from the upper left corner of the bottom of the freezer.

Remove and discard the white plug from the lower left back corner of the freezer wall.

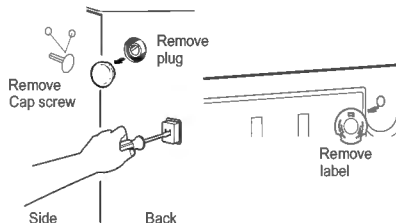

Remove the cover

Use a Phillips head screwdriver to remove the compressor compartment access cover. This requires removing six screws which attach the cover to the back of the refrigerator case.

Be sure to save the screws as the access cover must be reinstalled later to ensure your refrigerator will function properly.



Install Guide Cab W/Tube A1

Remove one side of the seal paper for the water fill tube, slide the seal through the tube and adhere it to the back edge of the water tube inlet.

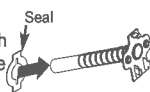

Connect the water line

Make sure there is enough plastic water line to extend from the water valve to well into the water tube inlet. Cut off any excess tubing.



Icemaker Installation

E

Hold the Guide Cab W / Tube A1 and insert the Guide Cab W / Tube A2 connector onto the entrance on the flat part.

Then cover the previous assembly with the Cover Guide Cab W / Tube, ensuring that it fits correctly into the guides on the flat side of the Guide Cab W / Tube A1.



Insert and slide the tube over the center hole at the top, at the back of the refrigerator. Press the same one firmly on the entrance so that it is adjusted to the refrigerator.

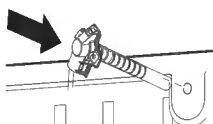

Fix the Water tube to the refrigerator

Press the Guide Cab W / Tube A1 assembly as soon as it is inserted into the back of the refrigerator. Insert the screws into the holes in the Cover Guide Cab using the T1 4x16 mm screws. Keep the fixed pipe by applying cotton tape over the plastic pipe, approximately 1 1/2 (40mm)

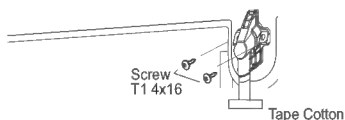

Route and attach the plastic water line

Attach the plastic water pipe to the back of the cabinet with the cotton adhesive tape, separating as shown to tighten the pipe.

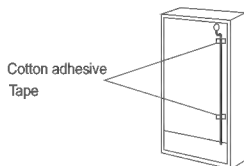

Install the water valve

Locate the male connector plug on the valve. Locate and insert the female connector on the bottom of the refrigerator. Observe the correct way to connect both connectors.

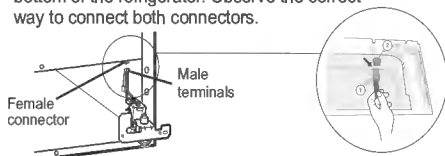

Attach the water valve to the cabinet by inserting the T1 4x14 mm Phillips head screw from the kit into the hole in the base of the cabinet.

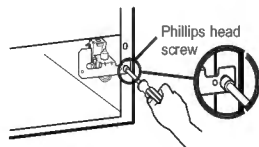

Prepare for Installation

Inside the freezer, loosen the two mounting screws, but do not screw them all the way out. If your model does not have the screws already in the freezer wall, look for two plug buttons. Remove the plug buttons and insert the two phillips head screws. The screws should extend approximately 1/2" (13mm) out from the freezer wall.

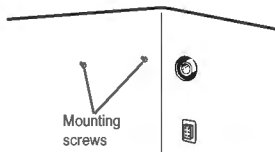

Set feeler arm to STOP position.

Move the feeler arm to the STOP (up) position until the refrigerator is connected to the water supply to prevent premature operation.

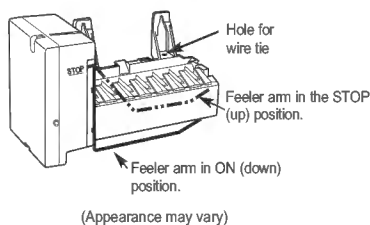

Install the Icemaker Fill Cup

Install the icemaker fill cup (side-mounted) into the icemaker as shown.

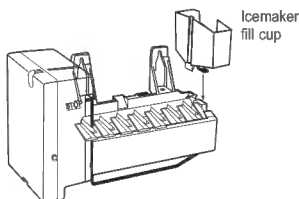

Icemaker Installation

E

Plug in the Icemaker

Holding the icemaker in place, insert the icemaker power cord plug into the socket on the back wall, making sure the prongs and holes are matched. Press the plug firmly into the socket. Lock the plug in place by clipping the restraints onto each side of the plug. Make sure the restraints click into place.

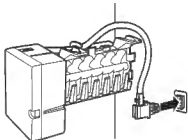

Mount the Icemaker

Lift the icemaker so the fill tube extension fits in the fill cup opening. Hang the icemaker on the two screws.

Make sure:

The power cord is still firmly in the socket.

The fill tube extension extends into the fill cup opening at the back of the icemaker. (Check the rear of the refrigerator to make sure the fill tube has not been pushed out of the back of the refrigerator).

The icemaker mounting screws are located in the uppermost position of the mounting slots.

Then securely tighten the icemaker mounting screws.

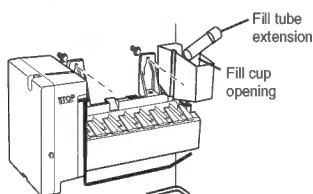

Install the Ice Bucket

Place the ice bucket under the icemaker. Make sure the icemaker power switch is in the O (off) position.

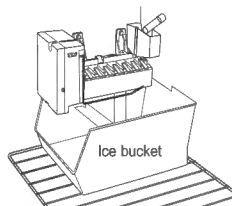

Water Valve Installed

After water line installation is completed, set the icemaker power switch to I (on).

The icemaking cycle will not begin until the icemaker and freezer compartment reach operating temperature.

Installing the water line

BEFORE YOU BEGIN

This water line installation is not warranted by the refrigerator or icemaker manufacturer. Follow these instructions carefully to minimize the risk of expensive water damage.

Water hammer (water banging in the pipes) in house plumbing can cause damage to refrigerator parts and lead to water leakage or flooding. Call a qualified plumber to correct water hammer before installing the water supply line to the refrigerator.

To prevent burns and product damage, do not hook up the water line to the hot water line.

If you use your refrigerator before connecting the water line, make sure the icemaker power switch is in the O (off) position (on power switch models) or the feeler arm is in the STOP (up) position (on feeler arm models).

Do not install the icemaker tubing in areas where temperatures fall below freezing.

When using any electrical device (such as a power drill) during installation, be sure the device is double insulated or grounded in a manner to prevent the hazard of electric shock, or is battery powered.

All installations must be in accordance with local plumbing code requirements.

WHAT YOU WILL NEED



- Refrigerator copper tubing 1/4" outer diameter to connect the refrigerator to the water supply. If using copper, be sure both ends of the tubing are cut square.

To determine how much tubing you need: Measure the distance from the water valve on the back of the refrigerator to the water supply pipe. Then add 8' (2.4 m). Be sure there is sufficient extra tubing to allow the refrigerator to move out from the wall after installation.

- A cold water supply. The water pressure must be between 20 and 120 p.s.i. (1.4–8.1 bar).

Icemaker Installation

E

- Power drill.
- 1/2 " or adjustable wrench.
- Straight and Phillips blade screwdriver.

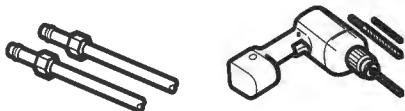

- Two 1/4 " outer diameter compression nuts and 2 ferrules (sleeves)—to connect the copper tubing to the shutoff valve and the refrigerator water valve.
- If your existing copper water line has a flared fitting at the end, you will need an adapter (available at plumbing supply stores) to connect the water line to the refrigerator OR you can cut off the flared fitting with a tube cutter and then use a compression fitting.

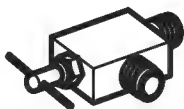

- Shutoff valve to connect to the cold water line. The shutoff valve should have a water inlet with a minimum inside diameter of 5/32 " at the point of connection to the cold water line. Saddle-type shutoff valves are included in many water supply kits. Before purchasing, make sure a saddle-type valve complies with your local plumbing codes.

Install the shutoff valve on the nearest frequently used drinking water line.

Shut off the main water supply

Turn on the nearest faucet long enough to clear the line of water.

Choose the valve location

Choose a location for the valve that is easily accessible. It is best to connect into the side of a vertical water pipe. When it is necessary to connect into a horizontal water pipe, make the connection to the top or side, rather than at the bottom, to avoid drawing off any sediment from the water pipe.

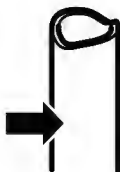

Drill the hole for the valve

Drill a 1/4 " hole in the water pipe (even if using a self-piercing valve), using a sharp bit. Remove any burrs resulting from drilling the hole in the pipe. Take care not to allow water to drain into the drill. Failure to drill a 1/4 " hole may result in reduced ice production or smaller cubes.

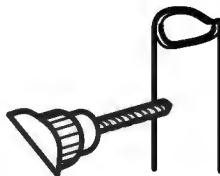

Fasten the shutoff valve

Fasten the shutoff valve to the cold water pipe with the pipe clamp.

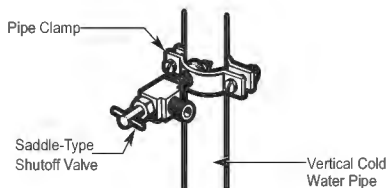

NOTE: Commonwealth of Massachusetts Plumbing Codes 248CMR shall be adhered to. Saddle valves are illegal and use is not permitted in Massachusetts. Consult with your licensed plumber.

Tighten the pipe clamp

Tighten the clamp screws until the sealing washer begins to swell.

NOTE: Do not overtighten or you may crush the tubing.

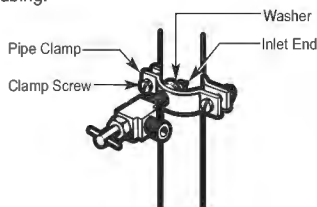

Icemaker Installation

E

Route the tubing

Route the tubing between the cold water line and the refrigerator.

Route the tubing through a hole drilled in the wall or floor (behind the refrigerator or adjacent base cabinet) as close to the wall as possible.

NOTE: Be sure there is sufficient extra tubing to allow the refrigerator to move out from the wall after installation.

Connect the tubing to the valve

Place the compression nut and ferrule (sleeve) for copper tubing onto the end of the tubing and connect it to the shutoff valve.

Make sure the tubing is fully inserted into the valve. Tighten the compression nut securely.

For plastic tubing, insert the molded end of the tubing into the shutoff valve and tighten compression nut until it is hand-tight; then tighten one additional turn with a wrench. Overtightening may cause leaks.

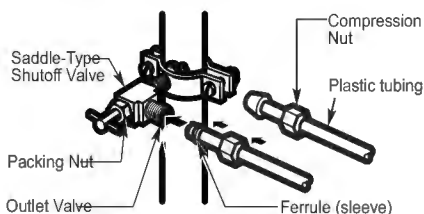

NOTE: Commonwealth of Massachusetts Plumbing Codes 248CMR shall be adhered to. Saddle valves are illegal and use is not permitted in Massachusetts. Consult with your licensed plumber.

Flush out the tubing

Turn the main water supply on and flush out the tubing until the water is clear.

Shut the water off at the water valve after about one quart (1 liter) of water has been flushed through the tubing.



Connect the tubing to the refrigerator

NOTES:

- Before making the connection to the refrigerator, be sure the refrigerator power cord is not plugged into the wall outlet.
- We recommend installing a water filter if your water supply has sand or particles that could clog the screen of the refrigerator's water valve. Install it in the water line near the refrigerator.

Remove the screws holding the right side of the access cover. Fold back the cover.

Remove the plastic flexible cap from the water valve (refrigerator connection).

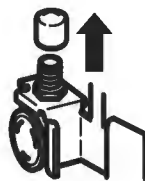

Place the compression nut and ferrule (sleeve) onto the end of the tubing as shown.

Insert the end of the tubing into the water valve connection as far as possible. While holding the tubing, tighten the fitting.

For plastic tubing, insert the molded end of the tubing into the water valve connection and tighten compression nut until it is hand-tight; then tighten one additional turn with a wrench. Overtightening may cause leaks.

Fasten the tubing into the clamp provided to hold it in a vertical position. You may need to pry open the clamp.

One of the illustrations below will look like the connection on your refrigerator.

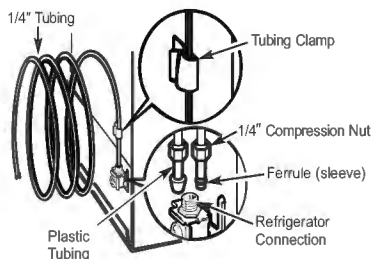

Icemaker Installation

Turn the water on at the shutoff valve

Tighten any connections that leak.



Reattach the access cover.

Plug in the refrigerator

Arrange the coil of tubing so that it does not vibrate against the back of the refrigerator or against the wall. Push the refrigerator back to the wall.

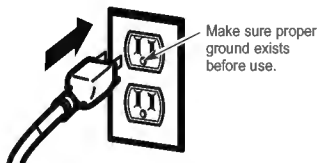

Important: Please read carefully for personal safety, this appliance must be properly grounded

The power cord of this appliance is equipped with a 3-prong (grounding) plug that mates with a standard 3-prong (grounding) wall receptacle to minimize the risk of electric shock hazard from this appliance. The customer should have the wall receptacle and circuit checked by a qualified electrician to make sure the receptacle is properly grounded.

Where a standard two-prong wall receptacle is encountered, it is the personal responsibility and obligation of the customer to have it replaced with a properly grounded 3-prong wall receptacle.

Do not, Under any circumstances, cut or remove the third (ground) prong from the power cord.

Start the Icemaker

Move the feeler arm to the ON (down) position. The icemaker will not begin to operate until it reaches its operating temperature of 15°F (-9°C) or below. It will then begin operation automatically.

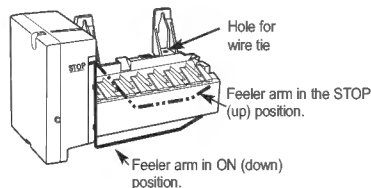

NOTE: In lower water pressure conditions, the water valve may turn on up to 3 times to deliver enough water to the icemaker.