

PRODUCT IMAGE SHOWN IS FOR ILLUSTRATIVE PURPOSES ONLY, SHOULD NOT BE TAKEN AS REFERENCE POINT

INSTRUCTIONS (A)

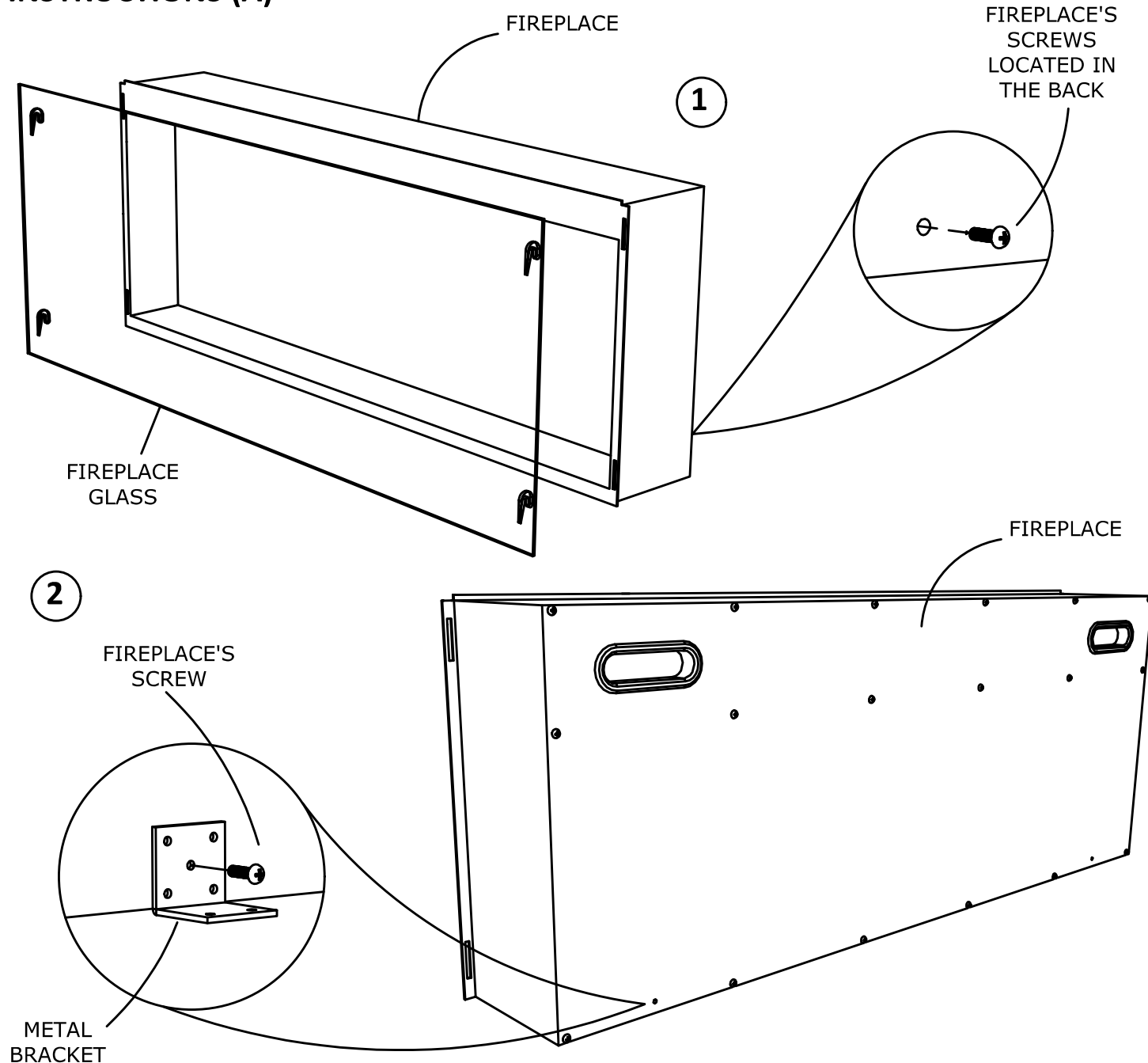

INSTRUCTIONS:

- BEFORE START ASSEMBLING THE FIREPLACE, YOU MUST TAKE OUT THE GLASS OF THE FIREPLACE AND THE SCREWS, YOU WILL USE THEM LATER.
- SCREW THE METAL BRACKETS TO THE FURNITURE FLOOR WITH THE TEMPLATE.



ASSEMBLY INSTRUCTIONS

I-EFP-C002

2/2

PRODUCT IMAGE SHOWN IS FOR ILLUSTRATIVE PURPOSES ONLY, SHOULD NOT BE TAKEN AS REFERENCE POINT

INSTRUCTIONS (B)

FIREPLACE

3

FLAT HEAD
SCREW 6 x 3/4"

4

FIREPLACE
GLASS

FIREPLACE

HARDWARE

DESCRIPTION	# PCS
FLAT HEAD SCREW 6 x 3/4"	4

INSTRUCTIONS:

- WITH SOMEONE HELP, PUT THE FIREPLACE UNTIL YOU CAN SCREW THE METAL BRACKET WITH THE FIREPLACE, AND SCREW THEM.
- PUT THE GLASS PANEL IN THE FIREPLACE.