



# Classic Series Panel Mounting Kit *Installation Guide*



SPECIFICATIONS, INSTALLATION,  
AND MORE



## Contents

- 3 Classic Series Panel Mounting Kit
- 4 Mounting Instructions
- 5 Single Installation
- 13 Dual Installation

Features and specifications are subject to change at any time without notice. Visit [subzero.com/specs](http://subzero.com/specs) for the most up-to-date information.

## Important Note

To ensure this product is installed and operated as safely and efficiently as possible, take note of the following types of highlighted information throughout this guide:

**IMPORTANT NOTE** highlights information that is especially important.

**CAUTION** indicates a situation where minor injury or product damage may occur if instructions are not followed.

**WARNING** states a hazard that may cause serious injury or death if precautions are not followed.

**IMPORTANT NOTE:** Throughout this guide, dimensions in parentheses are millimeters unless otherwise specified.

## Classic Series Panel Mounting Kit

### OVERLAY AND FLUSH INSET PANELS

The panel mounting kit consists of stock lengths of PVC cleats, self-drilling mounting screws, and offset gauges for correctly locating the mounting cleats on the back of custom panels (overlay and flush inset). Each Classic Series model has a page in this guide which provides the cut length of each cleat and the offset required for mounting. This kit works for all Classic Series models except glass door models (no kit available). Dual installations require two mounting kits for sufficient cleat stock and screws.

Be sure the custom panels have sufficient thickness where screws will be installed. If not, use the alternate hole pattern in the cleat or locate a new pattern. Use the longer  $\frac{3}{4}$ " (19) screws wherever possible, especially along the bottom of the panels and next to a custom handle where most of the load will be.

When panel construction permits, use the existing hole pattern closest to the outer edge of the cleat. The screws can be driven through the cleat where there are no clearance holes. This is recommended near the door handle and on the bottom cleat of custom panels greater than  $\frac{3}{4}$ " (19) thick to support the extra weight.

### PANEL MOUNTING KIT CONTENTS

- (8) 65" (1651) lengths of PVC cleat stock
- (50) #8 x  $\frac{5}{8}$ " zip-in screws
- (50) #8 x  $\frac{3}{4}$ " zip-in screws
- Set of two offset gauges (two offsets per gauge)

## Mounting Instructions

- 1 Determine the location and mounting method of the custom door handle if one will be used. Decide the best way to modify the cleat for the handle if necessary (cut the cleat completely or notch it to fit). Also, determine the best sequence for installing the handle and cleat. The panel needs to overhang the work surface if the handle is installed before cleating.
- 2 Provide surface protection and lay the custom panel on a flat work surface with the finished side down.
- 3 Locate the page of these instructions that applies to your specific Classic Series model and installation (single or dual). Circle the panel illustration for your application (overlay or flush inset) for reference as you proceed.
- 4 Check the dimensions of the custom panels against the panel illustration to be sure they are exactly the right size.
- 5 Cut the mounting cleats to length according to the chart. Measure and cut the longest cleats first. Horizontal cleats for the panel bottoms should be cut to include as many holes as possible. Use a general purpose blade in any type of carpentry saw.
- 6 Using the offset gauges provided, reference the panel illustration to arrange the cleats on the panel. Keep in mind that you are working on the back side of the panel. Horizontal cleats should extend to the outside of the vertical cleats for maximum screw count.
- 7 Double check the cleat offset locations. Attach the cleats initially with screws in the slotted holes of the cleats. Using quick clamps helps with accurate cleat placement while driving the screws. Start on one end of the cleat and work along the length as you install the screws. This makes it easier to maintain the proper offset if there is any bow in the cleat.

### ⚠ WARNING

**Make sure the Classic Series unit is secured in place with anti-tip brackets to prevent tip over when the panel weight is added to the open doors.**

- 8 Install the panel assemblies on the door(s) and grille of the Classic Series unit. Refer to the Classic Series Refrigeration installation guide for this procedure. Note any fine adjustments needed. Remove the panel assemblies from the unit and adjust the cleats as required for proper panel alignment. Attach the remainder of the screws in the round holes. Add extra screws in the bottom cleat if the panel is thicker than  $\frac{3}{4}$ " (19).
- 9 If there is flex in the center of the panel, install short pieces of the leftover cleat stock to the back of the panel to maintain spacing from the door.
- 10 Reinstall the panel assemblies and replace the door trim.

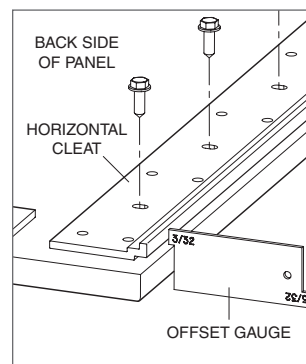

Offset gauge

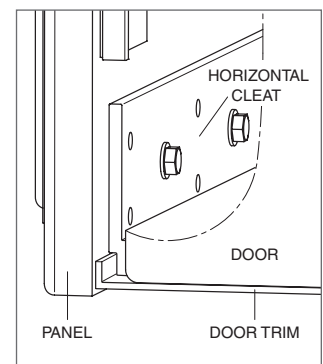

Panel mounting

Model CL3650R / CL3650F

SINGLE INSTALLATION

The mounting kit is not intended for use with a glass door model. The illustrations below provide panel dimensions and mounting cleat offsets for overlay and flush inset panels. Check the dimensions of the actual panels against the illustration for your panel application.

**IMPORTANT NOTE:** The panels are viewed from the front to show the finished elevation. The cleats will be attached to the back of the panels.

Cut the mounting cleats to length according to the chart. The cut lengths will be the same for overlay and flush inset panels. Vertical cleats must be centered between the two horizontal cleats. There will be approximately 3/4" (19) gap between the vertical and horizontal cleats. Horizontal cleats for the panel bottoms should be cut to include as many holes as possible. Refer to page 4 for mounting instructions.

CLEAT CUT LENGTH	HORIZONTAL	VERTICAL
Grille Panel	35" (889)	None
Door Panel	35" (889)	65" (1651)*

\*No cut required.

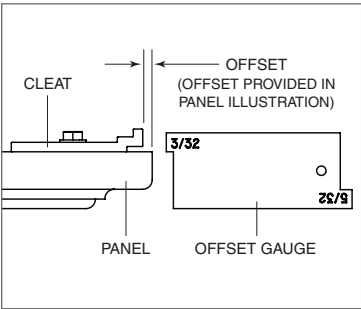

Mounting cleat offset detail

OVERLAY PANELS

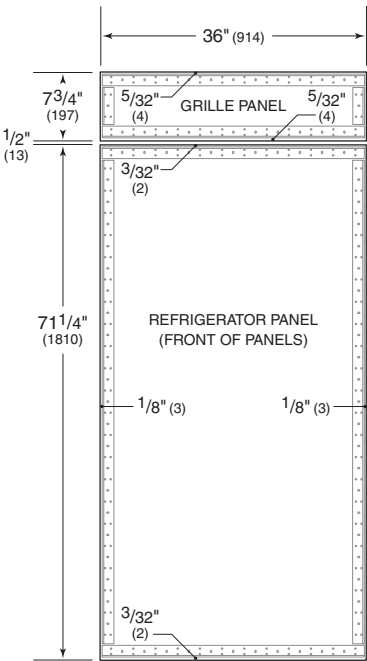

FLUSH INSET PANELS

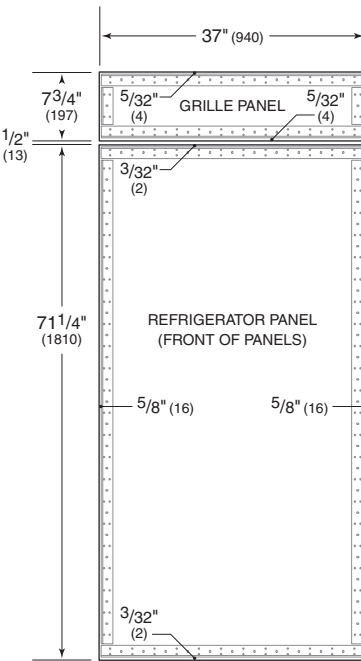

Model CL3050U

SINGLE INSTALLATION

The mounting kit is not intended for use with a glass door model. The illustrations below provide panel dimensions and mounting cleat offsets for overlay and flush inset panels. Check the dimensions of the actual panels against the illustration for your panel application.

**IMPORTANT NOTE:** The panels are viewed from the front to show the finished elevation. The cleats will be attached to the back of the panels.

Cut the mounting cleats to length according to the chart. The cut lengths will be the same for overlay and flush inset panels. Horizontal cleats for the panel bottoms should be cut to include as many holes as possible. Refer to page 4 for mounting instructions.

CLEAT CUT LENGTH	HORIZONTAL	VERTICAL
Grille Panel	29" (737)	None
Refrigerator Panel	29" (737)	46½" (1181)
Freezer Panel	29" (737)	14½" (368)

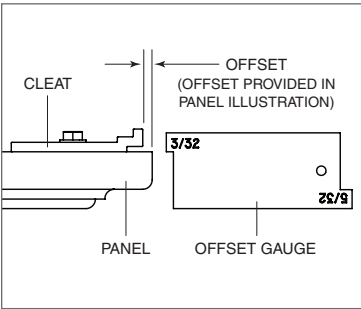

Mounting cleat offset detail

OVERLAY PANELS

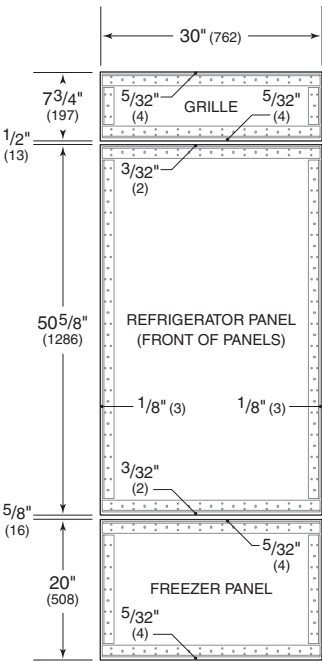

FLUSH INSET PANELS

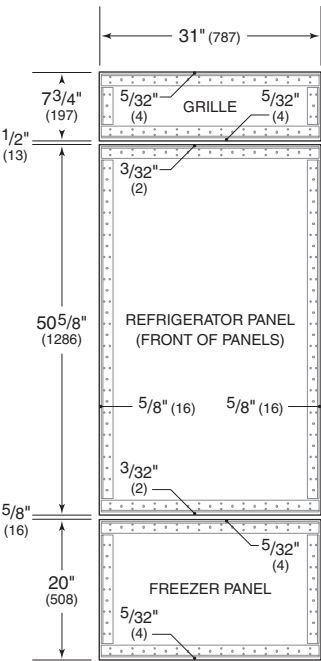

Model CL3650U

SINGLE INSTALLATION

The mounting kit is not intended for use with a glass door model. The illustrations below provide panel dimensions and mounting cleat offsets for overlay and flush inset panels. Check the dimensions of the actual panels against the illustration for your panel application.

**IMPORTANT NOTE:** The panels are viewed from the front to show the finished elevation. The cleats will be attached to the back of the panels.

Cut the mounting cleats to length according to the chart. The cut lengths will be the same for overlay and flush inset panels. Horizontal cleats for the panel bottoms should be cut to include as many holes as possible. Refer to page 4 for mounting instructions.

CLEAT CUT LENGTH	HORIZONTAL	VERTICAL
Grille Panel	35" (889)	None
Refrigerator Panel	35" (889)	46½" (1181)
Freezer Panel	35" (889)	14½" (368)

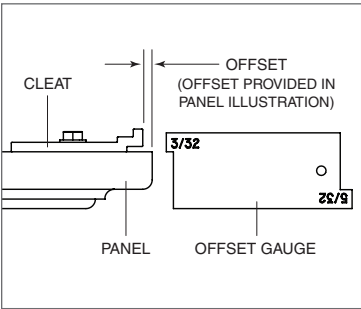

Mounting cleat offset detail

OVERLAY PANELS

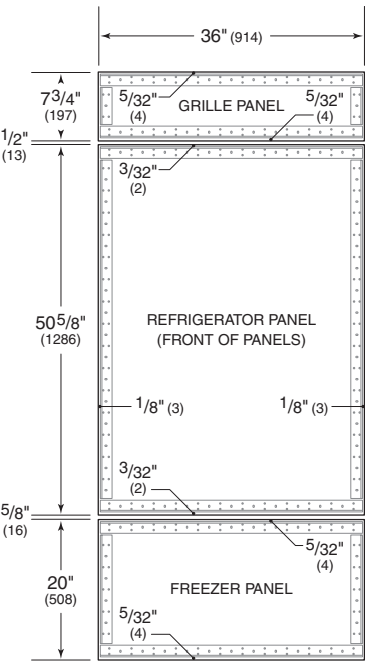

FLUSH INSET PANELS

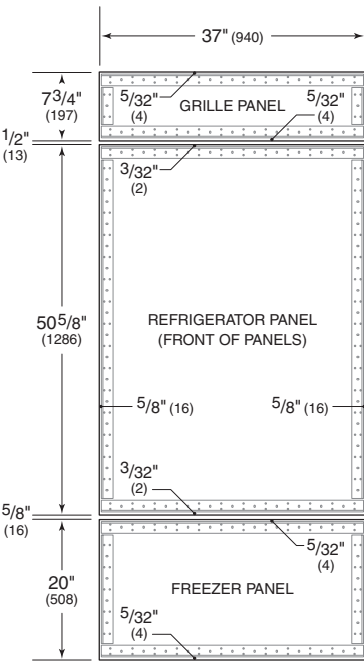

Model CL3650UFD

SINGLE INSTALLATION

The illustrations below provide panel dimensions and mounting cleat offsets for overlay and flush inset panels. Check the dimensions of the actual panels against the illustration for your panel application.

**IMPORTANT NOTE:** The panels are viewed from the front to show the finished elevation. The cleats will be attached to the back of the panels.

Cut the mounting cleats to length according to the chart. The cut lengths will be the same for overlay and flush inset panels. Horizontal cleats for the panel bottoms should be cut to include as many holes as possible. Refer to page 4 for mounting instructions.

CLEAT CUT LENGTH	HORIZONTAL	VERTICAL
Grille Panel	35" (889)	None
Refrigerator Panels (2)	17" (432)	46½" (1181)
Freezer Panel	35" (889)	14½" (368)

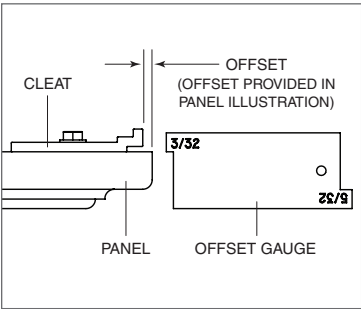

Mounting cleat offset detail

OVERLAY PANELS

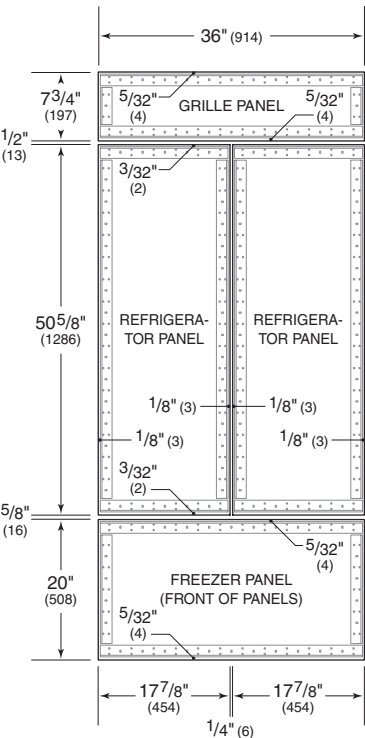

FLUSH INSET PANELS

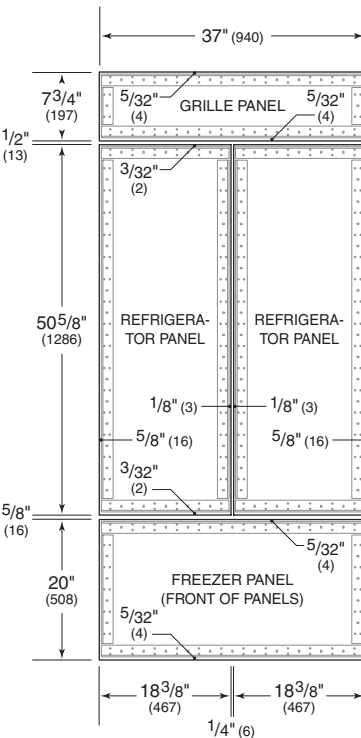



Model CL4250UFD

SINGLE INSTALLATION

The illustrations below provide panel dimensions and mounting cleat offsets for overlay and flush inset panels. Check the dimensions of the actual panels against the illustration for your panel application.

**IMPORTANT NOTE:** The panels are viewed from the front to show the finished elevation. The cleats will be attached to the back of the panels.

Cut the mounting cleats to length according to the chart. The cut lengths will be the same for overlay and flush inset panels. Horizontal cleats for the panel bottoms should be cut to include as many holes as possible. Refer to page 4 for mounting instructions.

CLEAT CUT LENGTH	HORIZONTAL	VERTICAL
Grille Panel	41" (1041)	None
Refrigerator Panels (2)	20" (508)	46½" (1181)
Freezer Panel	41" (1041)	14½" (368)

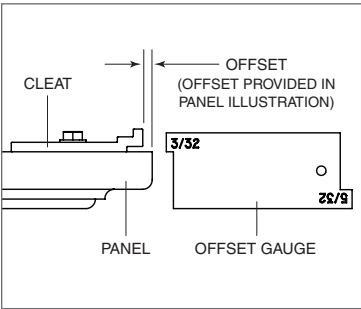

Mounting cleat offset detail

OVERLAY PANELS

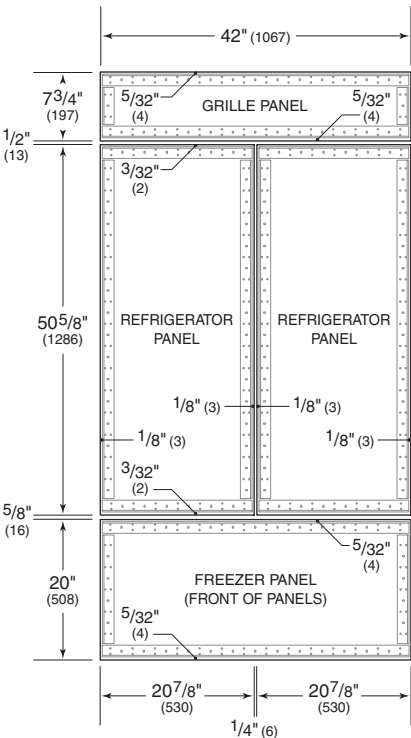

FLUSH INSET PANELS

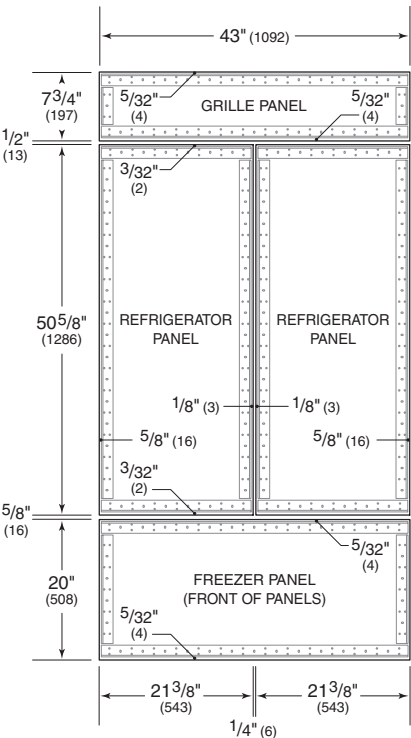

Model CL4850UFD

SINGLE INSTALLATION

The illustrations below provide panel dimensions and mounting cleat offsets for overlay and flush inset panels. Check the dimensions of the actual panels against the illustration for your panel application.

**IMPORTANT NOTE:** The panels are viewed from the front to show the finished elevation. The cleats will be attached to the back of the panels.

Cut the mounting cleats to length according to the chart. The cut lengths will be the same for overlay and flush inset panels. Horizontal cleats for the panel bottoms should be cut to include as many holes as possible. Refer to page 4 for mounting instructions.

CLEAT CUT LENGTH	HORIZONTAL	VERTICAL
Grille Panel	47" (1194)	None
Refrigerator Panels (2)	23" (584)	46½" (1181)
Freezer Panel	47" (1194)	14½" (368)

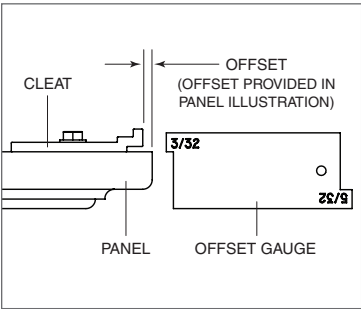

Mounting cleat offset detail

OVERLAY PANELS

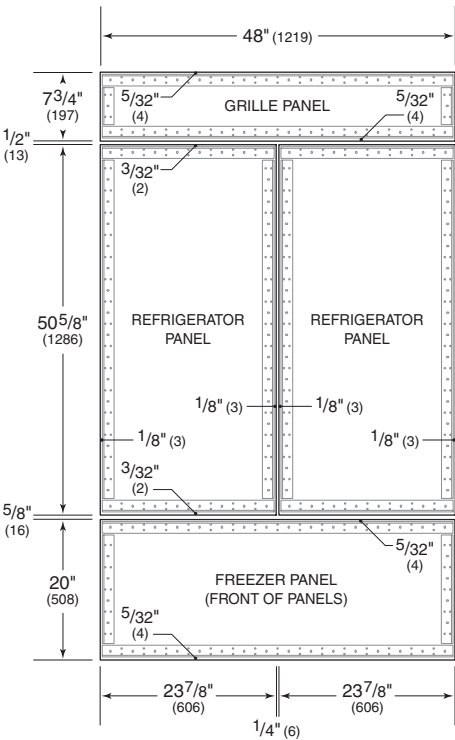

FLUSH INSET PANELS

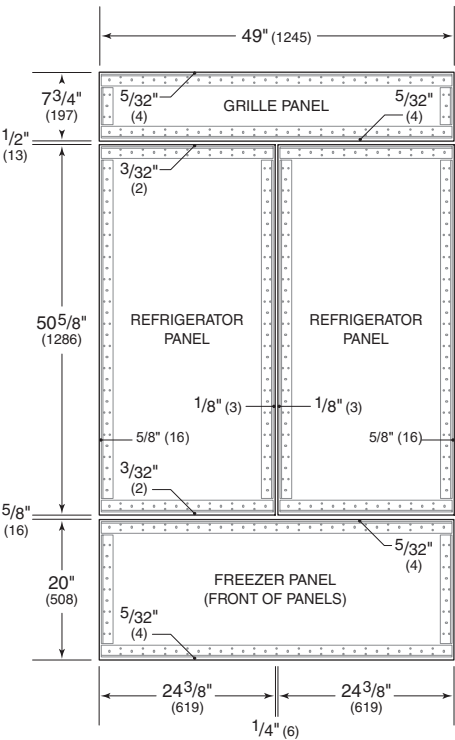



Model CL4850S / CL4850SD

SINGLE INSTALLATION

The illustrations below provide panel dimensions and mounting cleat offsets for overlay and flush inset panels. Check the dimensions of the actual panels against the illustration for your panel application.

**IMPORTANT NOTE:** The panels are viewed from the front to show the finished elevation. The cleats will be attached to the back of the panels.

Cut the mounting cleats to length according to the chart. The cut lengths will be the same for overlay and flush inset panels. Vertical cleats must be centered between the two horizontal cleats. There will be approximately 3/4" (19) gap between the vertical and horizontal cleats. Horizontal cleats for the panel bottoms should be cut to include as many holes as possible. Refer to page 4 for mounting instructions.

CLEAT CUT LENGTH	HORIZONTAL	VERTICAL
Grille Panel	47" (1194)	None
Refrigerator Panel	28" (711)	65" (1651)*
Freezer Panel	18" (457)	65" (1651)*

\*No cut required.

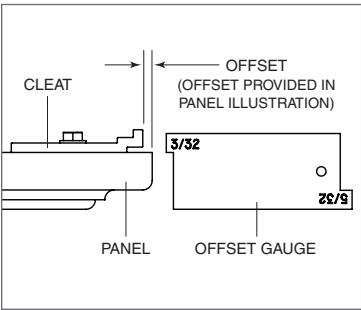

Mounting cleat offset detail

OVERLAY PANELS

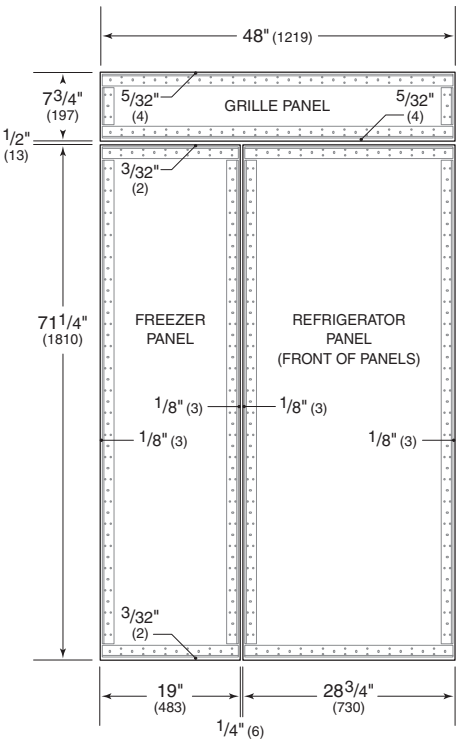

FLUSH INSET PANELS

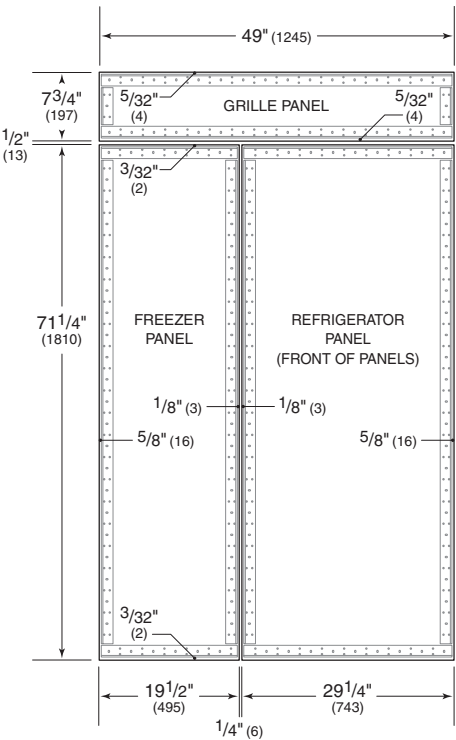

## Dual Installation

## Model CL3650R / CL3650F

## DUAL INSTALLATION WITH SEPARATE GRILLES

The mounting kit is not intended for use with a glass door model. The illustrations below provide panel dimensions and mounting cleat offsets for overlay and flush inset panels. Check the dimensions of the actual panels against the illustration for your panel application.

**IMPORTANT NOTE:** The panels are viewed from the front to show the finished elevation. The cleats will be attached to the back of the panels.

Cut the mounting cleats to length according to the chart. The cut lengths will be the same for overlay and flush inset panels. Vertical cleats must be centered between the two horizontal cleats. There will be approximately 3/4" (19) gap between the vertical and horizontal cleats. Horizontal cleats for the panel bottoms should be cut to include as many holes as possible. Refer to page 4 for mounting instructions.

CLEAT CUT LENGTH	HORIZONTAL	VERTICAL
Grille Panel	35" (889)	None
Door Panel	35" (889)	65" (1651)*

\*No cut required.

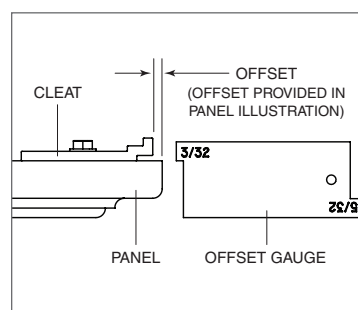

### Mounting cleat offset detail

## OVERLAY PANELS

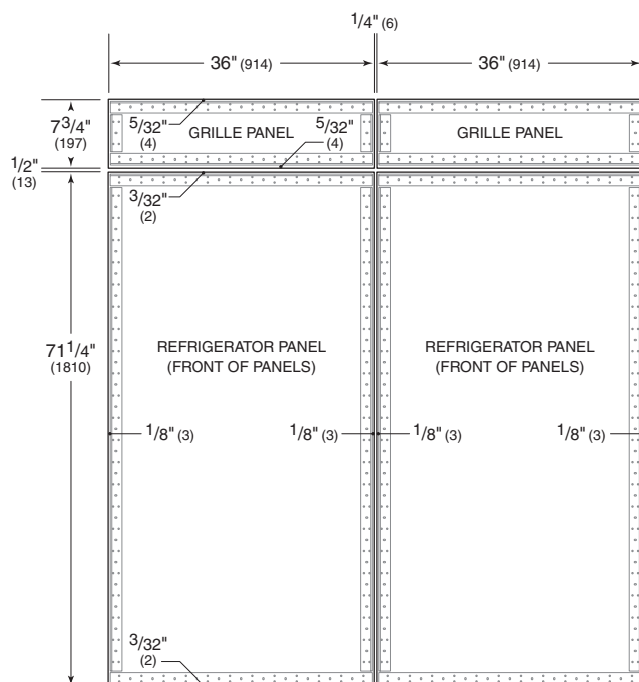

## FLUSH INSET PANELS

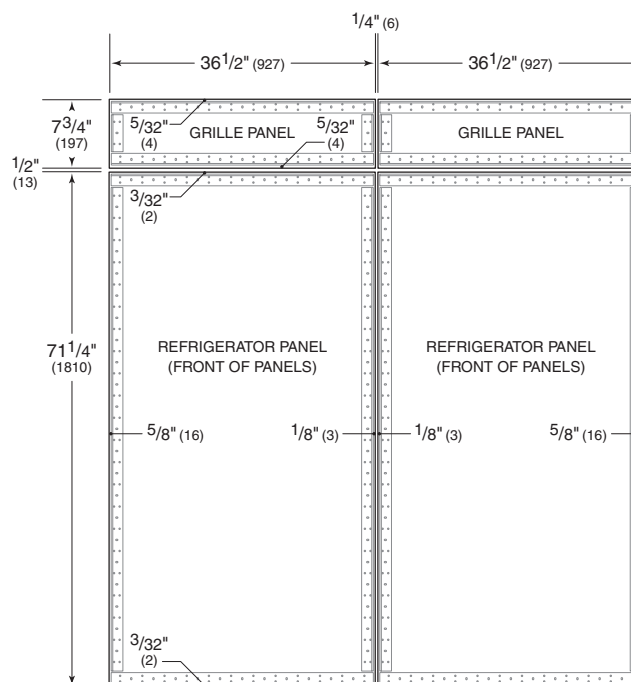

Model CL3650R / CL3650F

DUAL INSTALLATION WITH DUAL WIDE GRILLE

The mounting kit is not intended for use with a glass door model. The illustrations below provide panel dimensions and mounting cleat offsets for overlay and flush inset panels. Check the dimensions of the actual panels against the illustration for your panel application.

**IMPORTANT NOTE:** The panels are viewed from the front to show the finished elevation. The cleats will be attached to the back of the panels.

Cut the mounting cleats to length according to the chart. The cut lengths will be the same for overlay and flush inset panels. Vertical cleats must be centered between the two horizontal cleats. There will be approximately 3/4" (19) gap between the vertical and horizontal cleats. Horizontal cleats for the panel bottoms should be cut to include as many holes as possible. Refer to page 4 for mounting instructions. Dual installations require two mounting kits.

CLEAT CUT LENGTH	HORIZONTAL	VERTICAL
Grille Panel	71½" (1816)	None
Door Panel	35" (889)	65" (1651)*

\*No cut required.

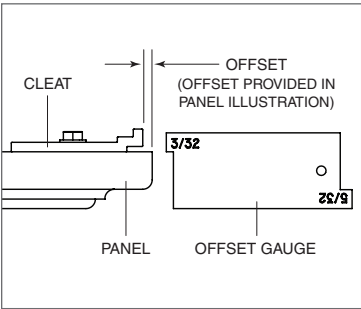

Mounting cleat offset detail

OVERLAY PANELS

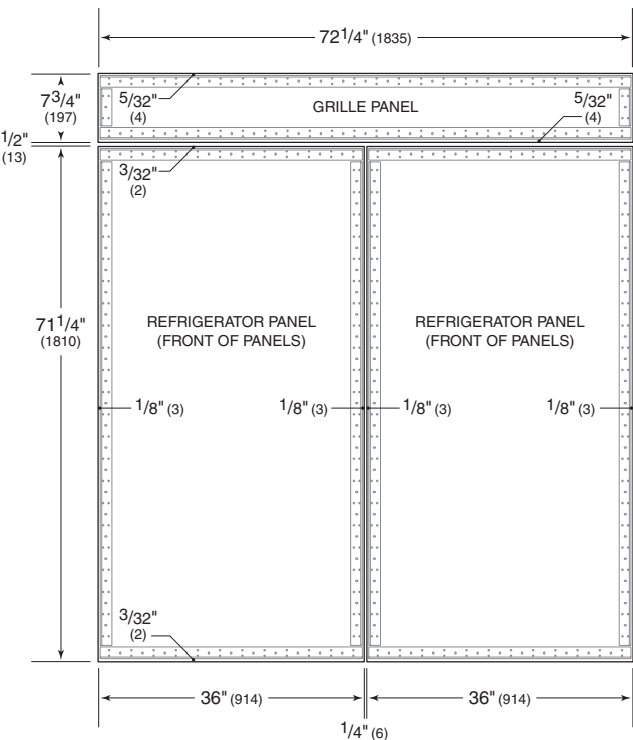

FLUSH INSET PANELS

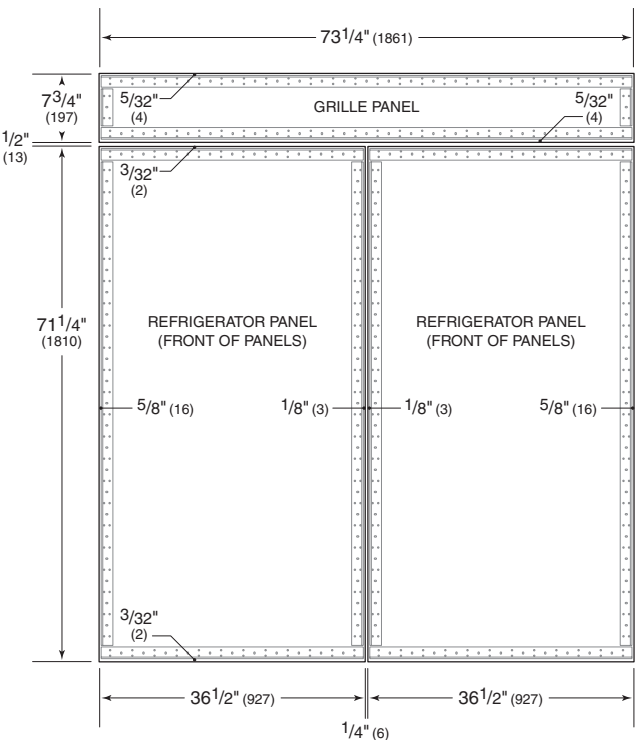

Model CL3050U

DUAL INSTALLATION WITH SEPARATE GRILLES

The mounting kit is not intended for use with a glass door model. The illustrations below provide panel dimensions and mounting cleat offsets for overlay and flush inset panels. Check the dimensions of the actual panels against the illustration for your panel application.

**IMPORTANT NOTE:** The panels are viewed from the front to show the finished elevation. The cleats will be attached to the back of the panels.

Cut the mounting cleats to length according to the chart. The cut lengths will be the same for overlay and flush inset panels. Horizontal cleats for the panel bottoms should be cut to include as many holes as possible. Refer to page 4 for mounting instructions. Dual installations require two mounting kits.

CLEAT CUT LENGTH	HORIZONTAL	VERTICAL
Grille Panel	29" (737)	None
Refrigerator Panel	29" (737)	46½" (1181)
Freezer Panel	29" (737)	14½" (368)

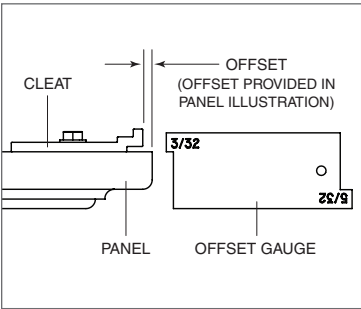

Mounting cleat offset detail

OVERLAY PANELS

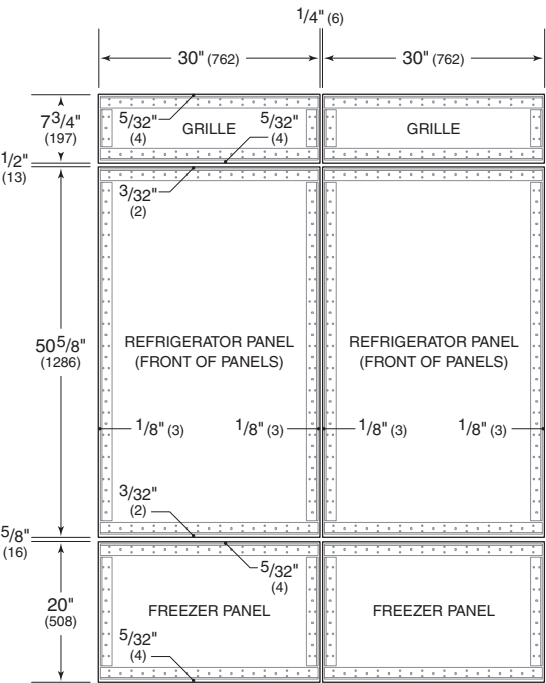

FLUSH INSET PANELS

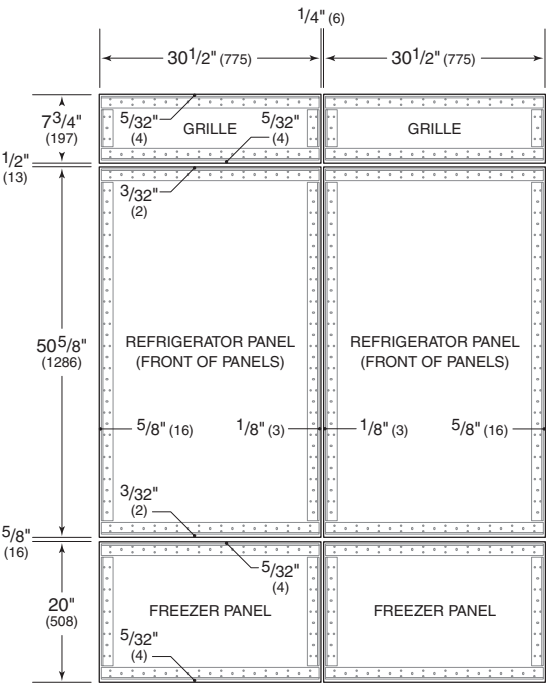

Model CL3050U

DUAL INSTALLATION WITH DUAL WIDE GRILLE

The mounting kit is not intended for use with a glass door model. The illustrations below provide panel dimensions and mounting cleat offsets for overlay and flush inset panels. Check the dimensions of the actual panels against the illustration for your panel application.

**IMPORTANT NOTE:** The panels are viewed from the front to show the finished elevation. The cleats will be attached to the back of the panels.

Cut the mounting cleats to length according to the chart. The cut lengths will be the same for overlay and flush inset panels. Horizontal cleats for the panel bottoms should be cut to include as many holes as possible. Refer to page 4 for mounting instructions. Dual installations require two mounting kits.

CLEAT CUT LENGTH	HORIZONTAL	VERTICAL
Grille Panel	59½" (1511)	None
Refrigerator Panel	29" (737)	46½" (1181)
Freezer Panel	29" (737)	14½" (368)

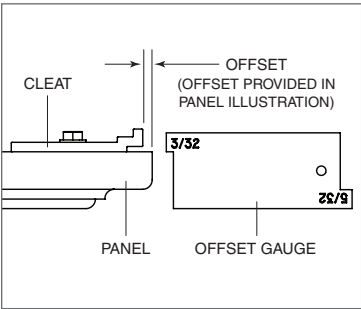

Mounting cleat offset detail

OVERLAY PANELS

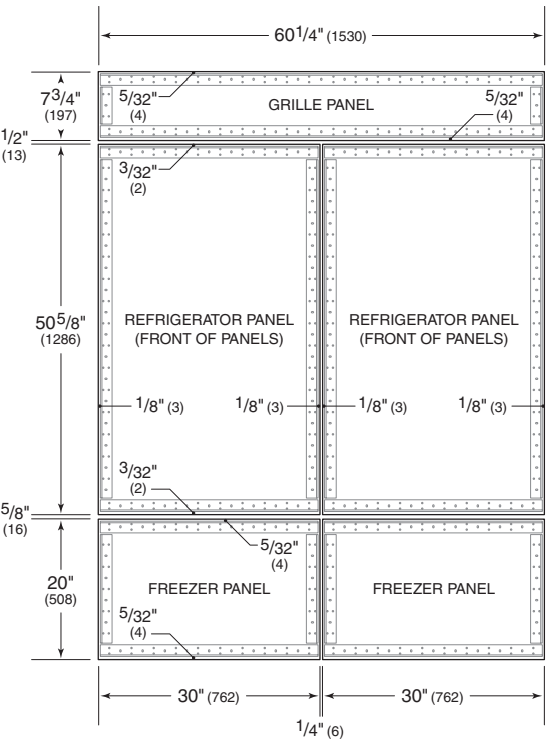

FLUSH INSET PANELS

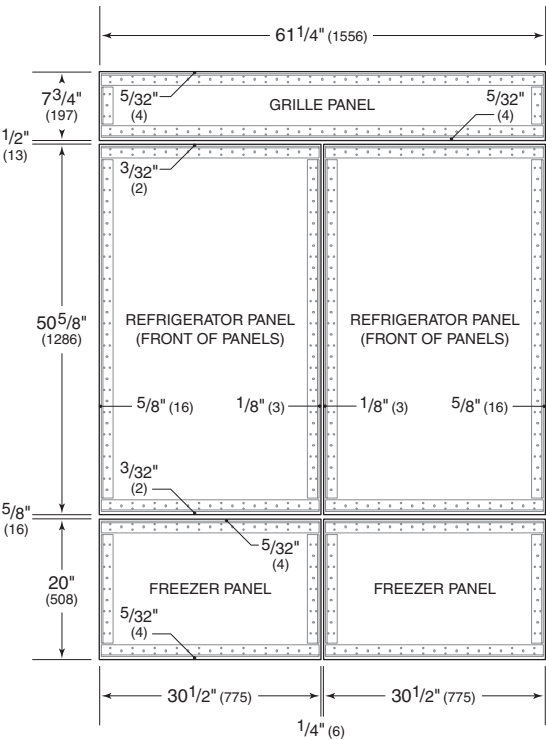



Model CL3650U

DUAL INSTALLATION WITH SEPARATE GRILLES

The mounting kit is not intended for use with a glass door model. The illustrations below provide panel dimensions and mounting cleat offsets for overlay and flush inset panels. Check the dimensions of the actual panels against the illustration for your panel application.

**IMPORTANT NOTE:** The panels are viewed from the front to show the finished elevation. The cleats will be attached to the back of the panels.

Cut the mounting cleats to length according to the chart. The cut lengths will be the same for overlay and flush inset panels. Horizontal cleats for the panel bottoms should be cut to include as many holes as possible. Refer to page 4 for mounting instructions. Dual installations require two mounting kits.

CLEAT CUT LENGTH	HORIZONTAL	VERTICAL
Grille Panel	35" (889)	None
Refrigerator Panel	35" (889)	46½" (1181)
Freezer Panel	35" (889)	14½" (368)

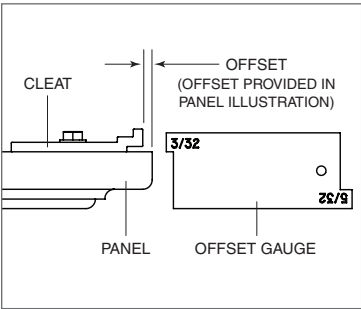

Mounting cleat offset detail

OVERLAY PANELS

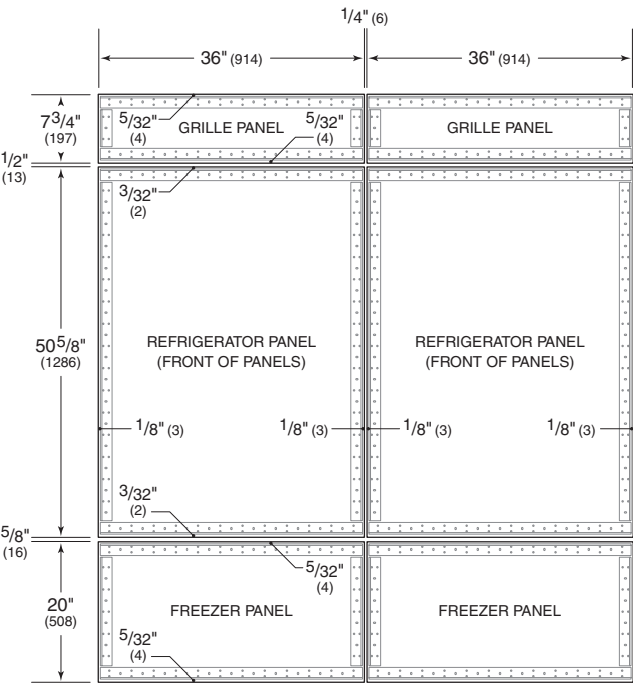

FLUSH INSET PANELS

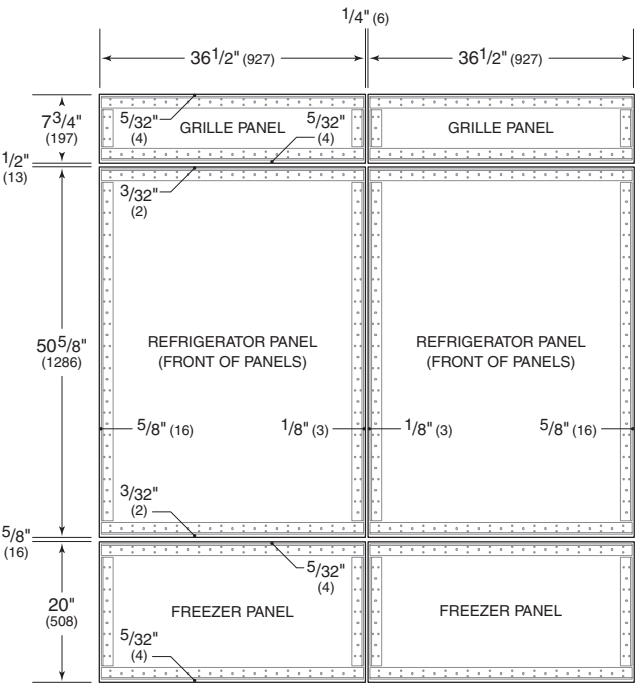

Model CL3650U

DUAL INSTALLATION WITH DUAL WIDE GRILLE

The mounting kit is not intended for use with a glass door model. The illustrations below provide panel dimensions and mounting cleat offsets for overlay and flush inset panels. Check the dimensions of the actual panels against the illustration for your panel application.

**IMPORTANT NOTE:** The panels are viewed from the front to show the finished elevation. The cleats will be attached to the back of the panels.

Cut the mounting cleats to length according to the chart. The cut lengths will be the same for overlay and flush inset panels. Horizontal cleats for the panel bottoms should be cut to include as many holes as possible. Refer to page 4 for mounting instructions. Dual installations require two mounting kits.

CLEAT CUT LENGTH	HORIZONTAL	VERTICAL
Grille Panel	71½" (1816)	None
Refrigerator Panel	35" (889)	46½" (1181)
Freezer Panel	35" (889)	14½" (368)

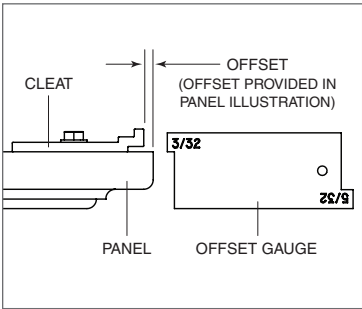

Mounting cleat offset detail

OVERLAY PANELS

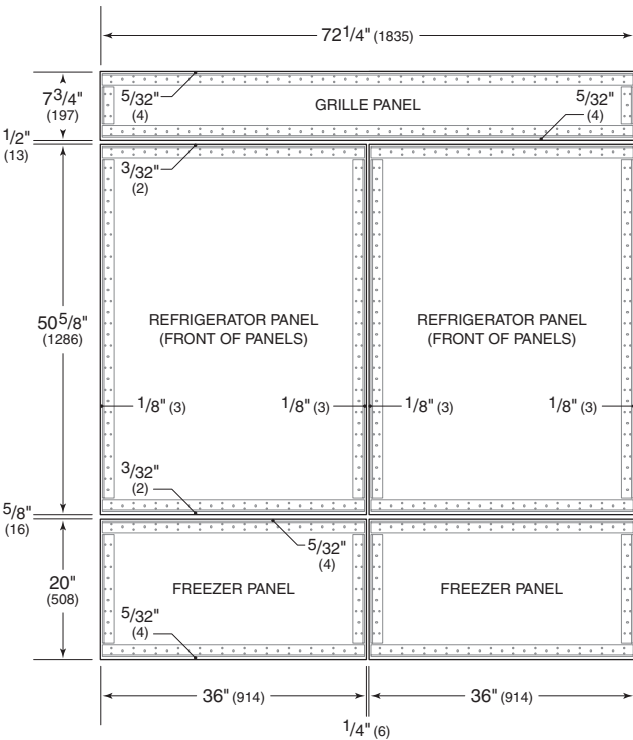

FLUSH INSET PANELS

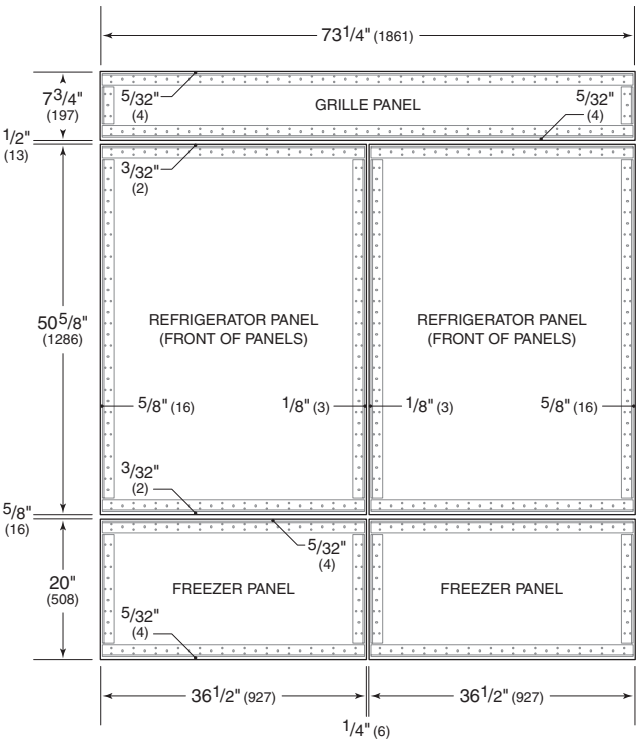

Sub-Zero, Sub-Zero & Design, Sub-Zero & Snowflake Design, Dual Refrigeration, The Living Kitchen, Great American Kitchens The Fine Art of Kitchen Design, Wolf, Wolf & Design, Wolf Gourmet, W & Design, red colored knobs, Cove, and Cove & Design are registered trademarks and service marks of Sub-Zero Group, Inc. and its subsidiaries. All other trademarks are property of their respective owners in the United States and other countries.



SUB-ZERO, INC. P.O. BOX 44848 MADISON, WI 53744 SUBZERO.COM 800.222.7820

9038610 REV-A

4/2020

