

PARTS FOR VD500WSV

COMPLETE HARDWARE #: PVD500WSVH

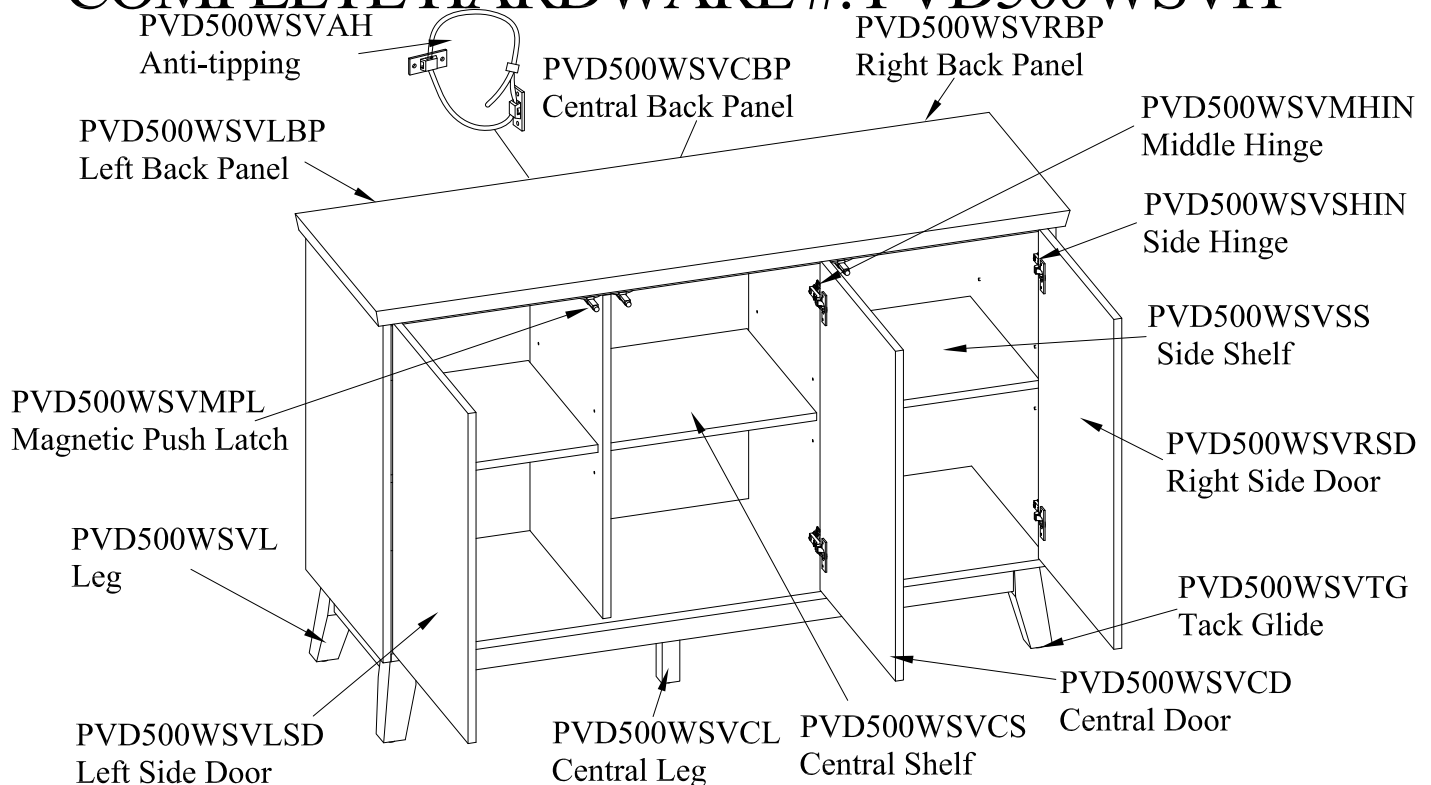

PRODUCT DETAILS

SERVER TOP	GUANG XI WHITE+PW CORE
TOP THICKNESS	35MM
MARBLE VENEER THICKNESS	7MM
SIDE SHELF	PB+ASH VENEER
CENTRAL SHELF	PB+ASH VENEER
LEG	RUBBERWOOD
CENTRAL LEG	LOCAL SOLIDWOOD
LEFT SIDE DOOR	MDF+ASH VENEER
RIGHT SIDE DOOR	MDF+ASH VENEER
CENTRAL DOOR	MDF+ASH VENEER
RIGHT BACK PANEL	MDF+ASH VENEER
LEFT BACK PANEL	MDF+ASH VENEER
TACK GLIDE	IRON+PLASTIC
MIDDLE HINGE/SIDE HINGE	IRON
MAGNETIC PUSH LATCH	IRON+PLASTIC
PRODUCT SIZE	54-1/2"x18-1/4"x35-7/8"
CARTON SIZE	57.75"x21.5"x34.75"
NET WEIGHT	71.8KG/157.96LBS
GROSS WEIGHT	81.4KG/179.08LBS
CU.FT.	24.96'

WARNING

- MARBLE/GRANITE IS NON-STAIN RESISTANT AGAINST FOODS AND ACIDIC OR OILY LIQUID
- IF ACIDIC OR OILY LIQUID SPILLS OVER THE MARBLE/GRANITE TABLE TOP, PLEASE IMMEDIATELY USE A DAMP SPONGES AND DETERGENT OR TOOTHPASTE TO WIPE MARBLE/GRANITE TABLE TOP UNTIL IT IS CLEAN
- COMMON OILY SUBSTANCES: COOKING OIL, OLIVE OIL
COMMON ACIDIC SUBSTANCES: KETCHUP, VINEGAR, GRAPE JUICE, LEMON JUICE
- MARBLE/GRANITE IS A NATURAL STONE PRODUCT. ANY VARIATIONS IN PATTERN, TEXTURE, AND COLOR ARE INHERENT IN THE MATERIAL AND ENHANCE THE NATURAL BEAUTY OF THE STONE.
- PLEASE DO NOT PLACE COLD OR HOT ITEMS DIRECTLY ON THE STONE

Made In China
Hecho en China
Fabriqué en Chine