



DO NOT RETURN TO RETAILER
IF YOU HAVE ANY
QUESTIONS OR CONCERNS
PLEASE CALL
KODIAK FURNITURE
AT 651-641-0281
MONDAY- FRIDAY 8AM TO 3:30 PM CST

OR EMAIL TO
info@kodiakfurniture.com
OR VISIT OUR WEBSITE AT
www.kodiakfurniture.com



Boho Trundle Bed

Assembly Instructions

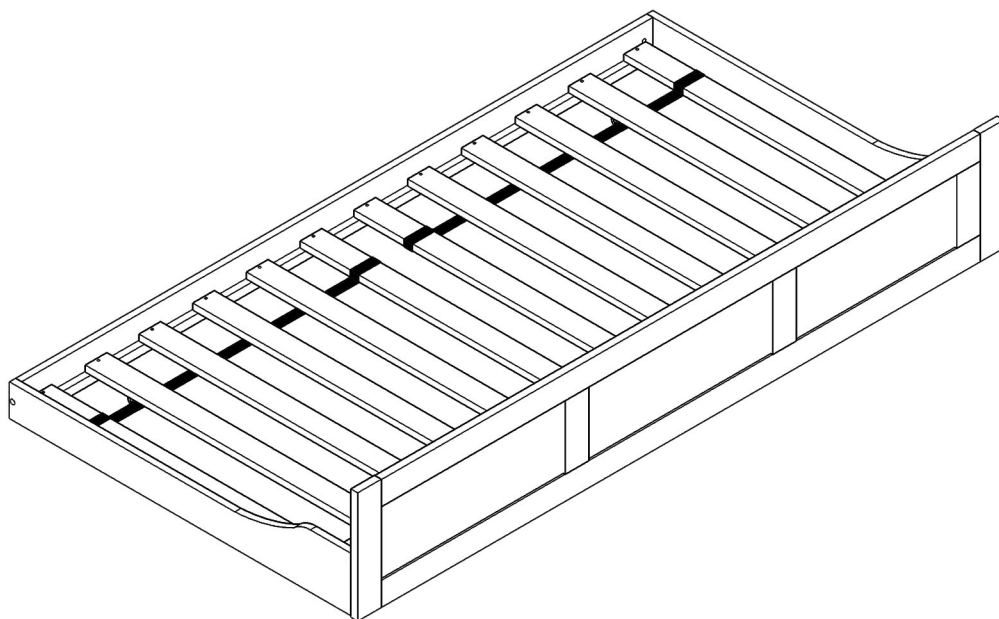

Required:

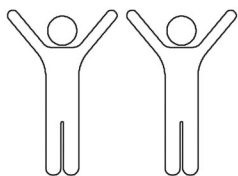

Tools Needed:



Allen Key provided

Please cover floor with corrugated cardboard / paper / carpet
to avoid scratches / damages to floor

Assembly Checklist

Please make sure that you have all of the below items before you start. If any are missing, please contact us for a replacement.



Parts supplied for assembly

Box A

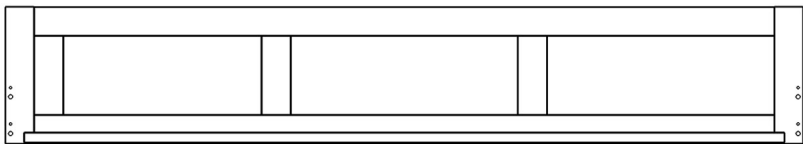

P12

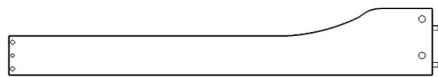

P14

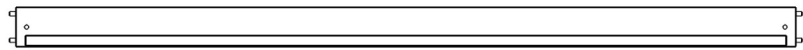

P13



P15

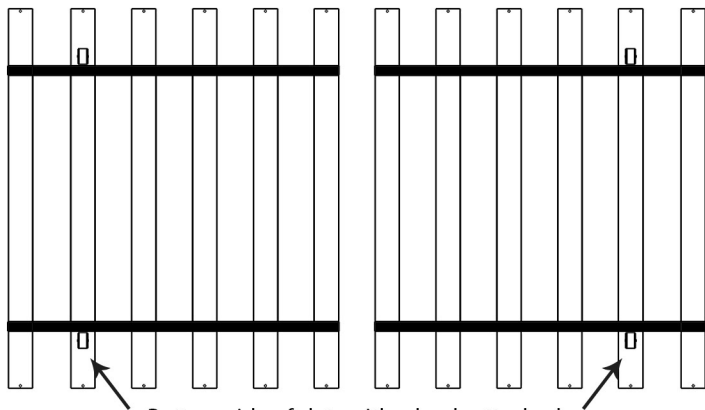

Bottom side of slats with wheels attached

P16

Hardware supplied for assembly



H2

x 24



H3

x 2



H4

x 2



H5

x 4



H6

x 4

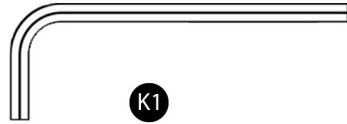

K1

x 1

Tools required for assembly:
- Allen Key (supplied)
- Screwdriver (not supplied)

Step 1: Attach P13 to P14 and P15 with hardware as shown

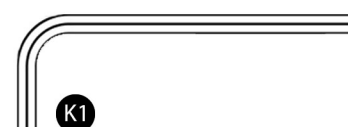
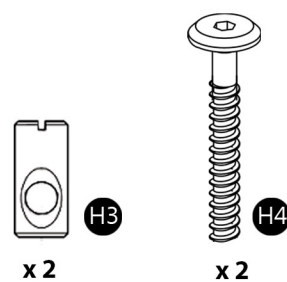
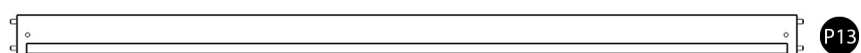
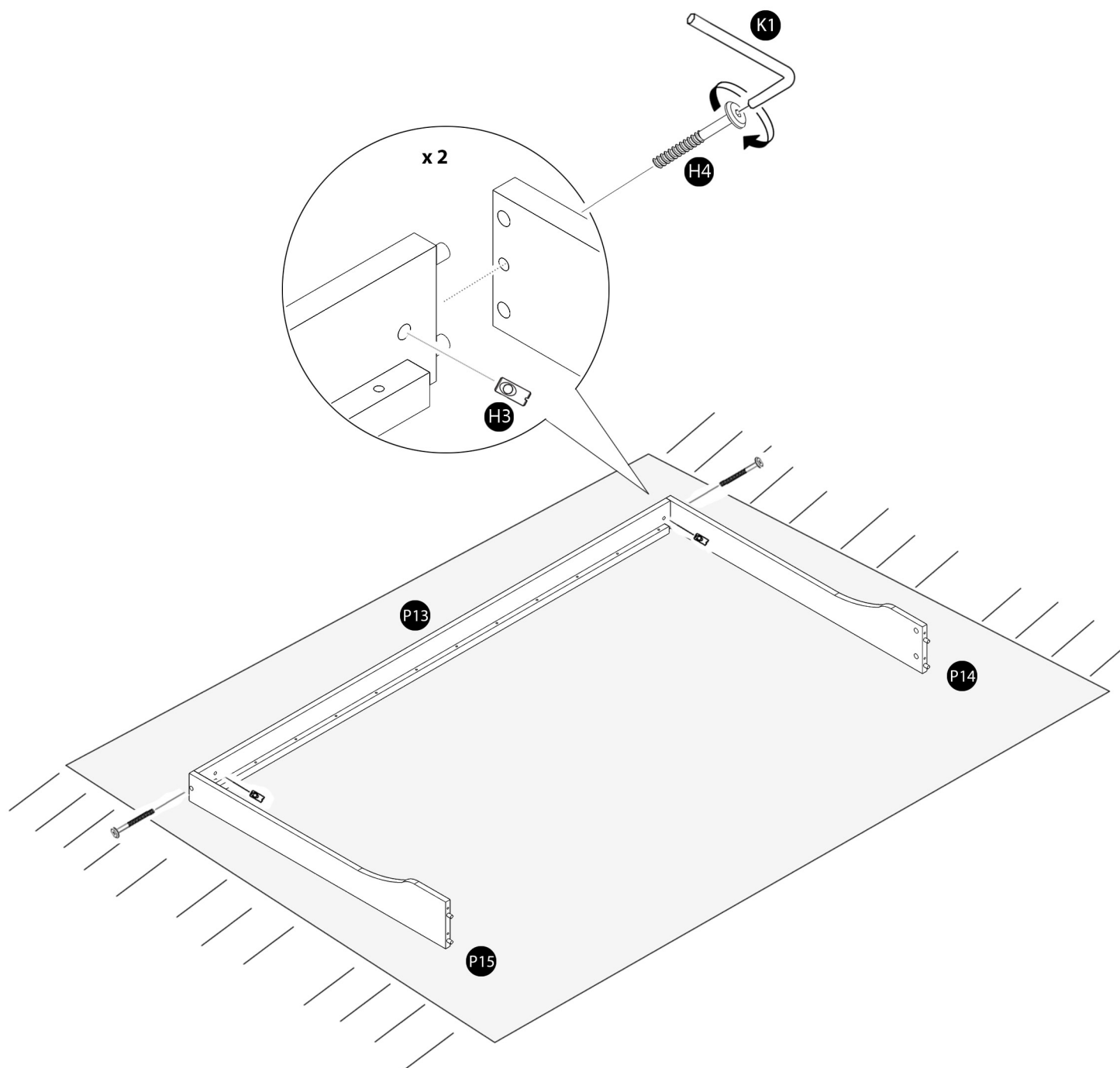

Step 2: Insert P12 with hardware as shown

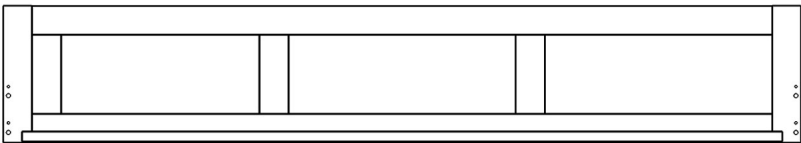
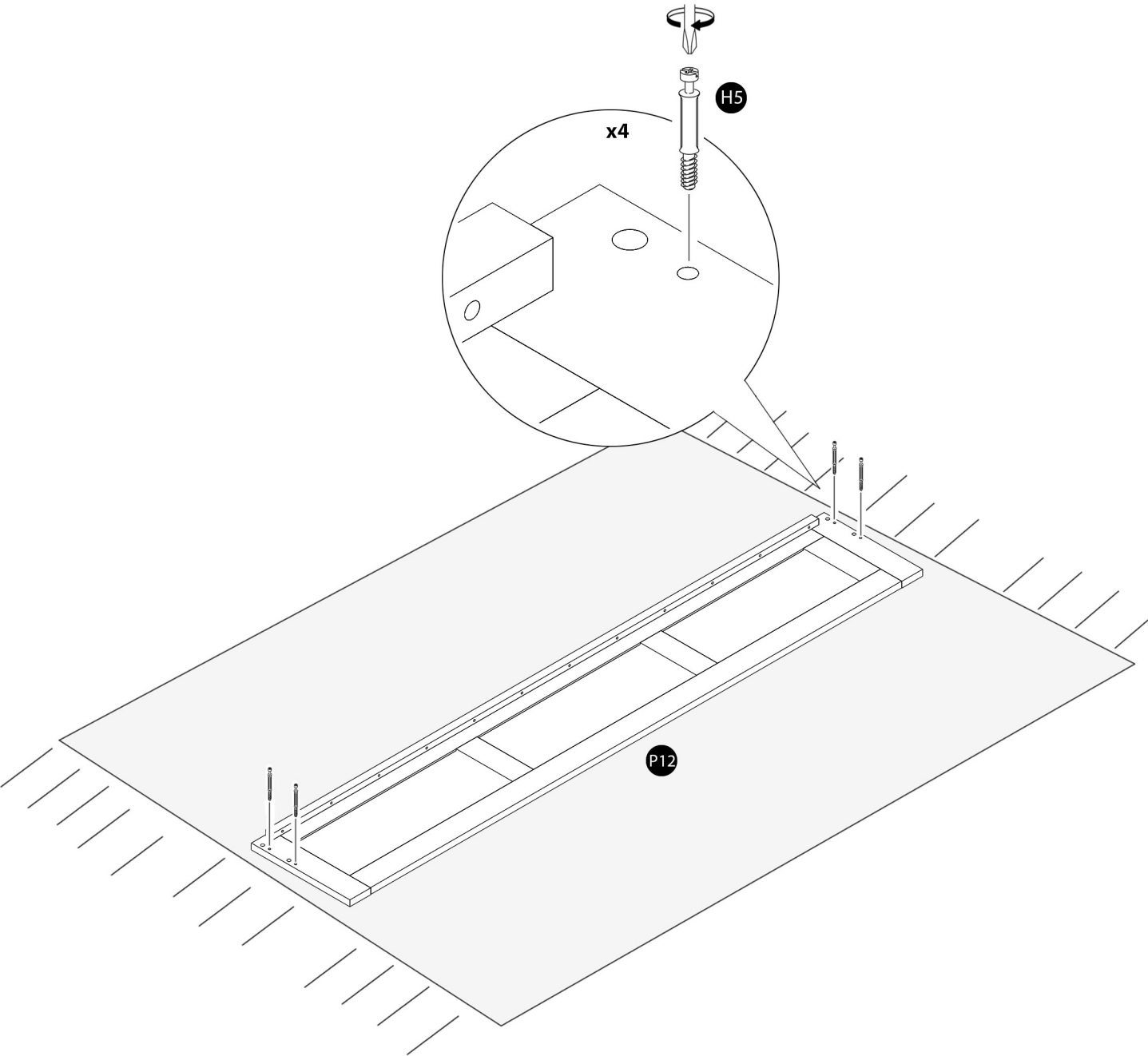

P12

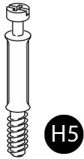

x 4

Step 3: Attach P14 and P15 to P12 with hardware as shown

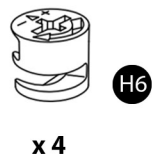
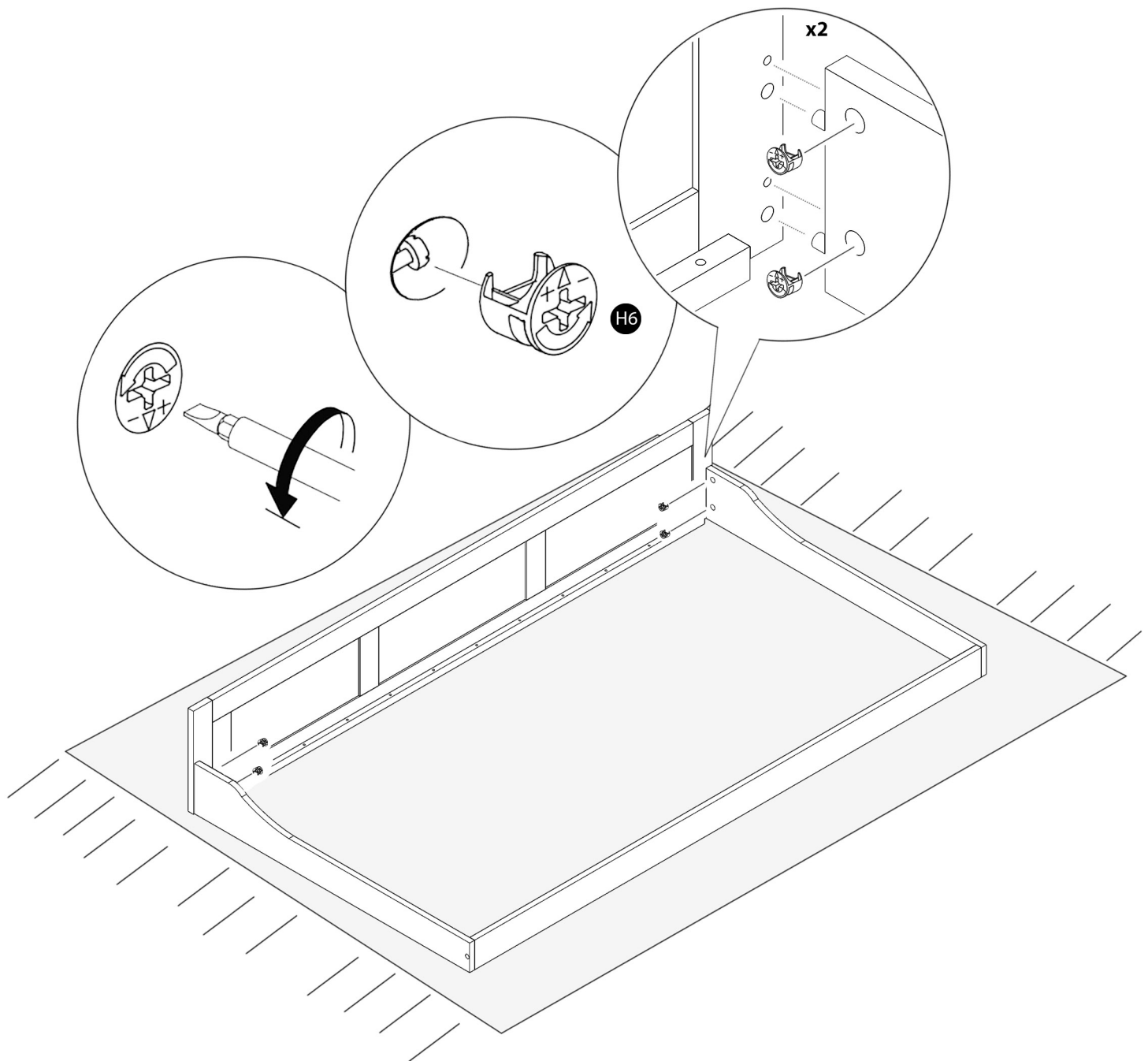

Step 4: Attach P16 with hardware as shown

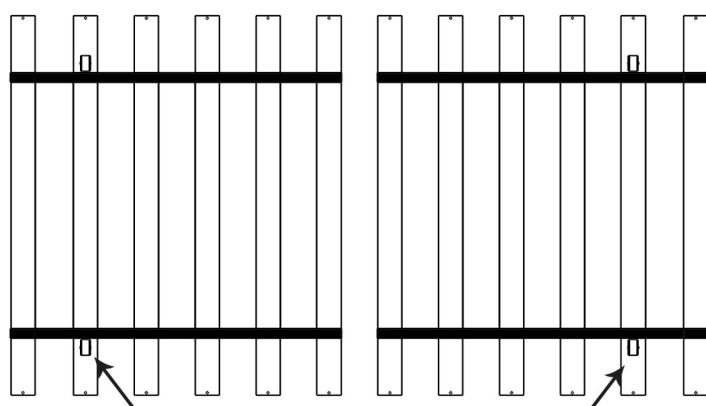
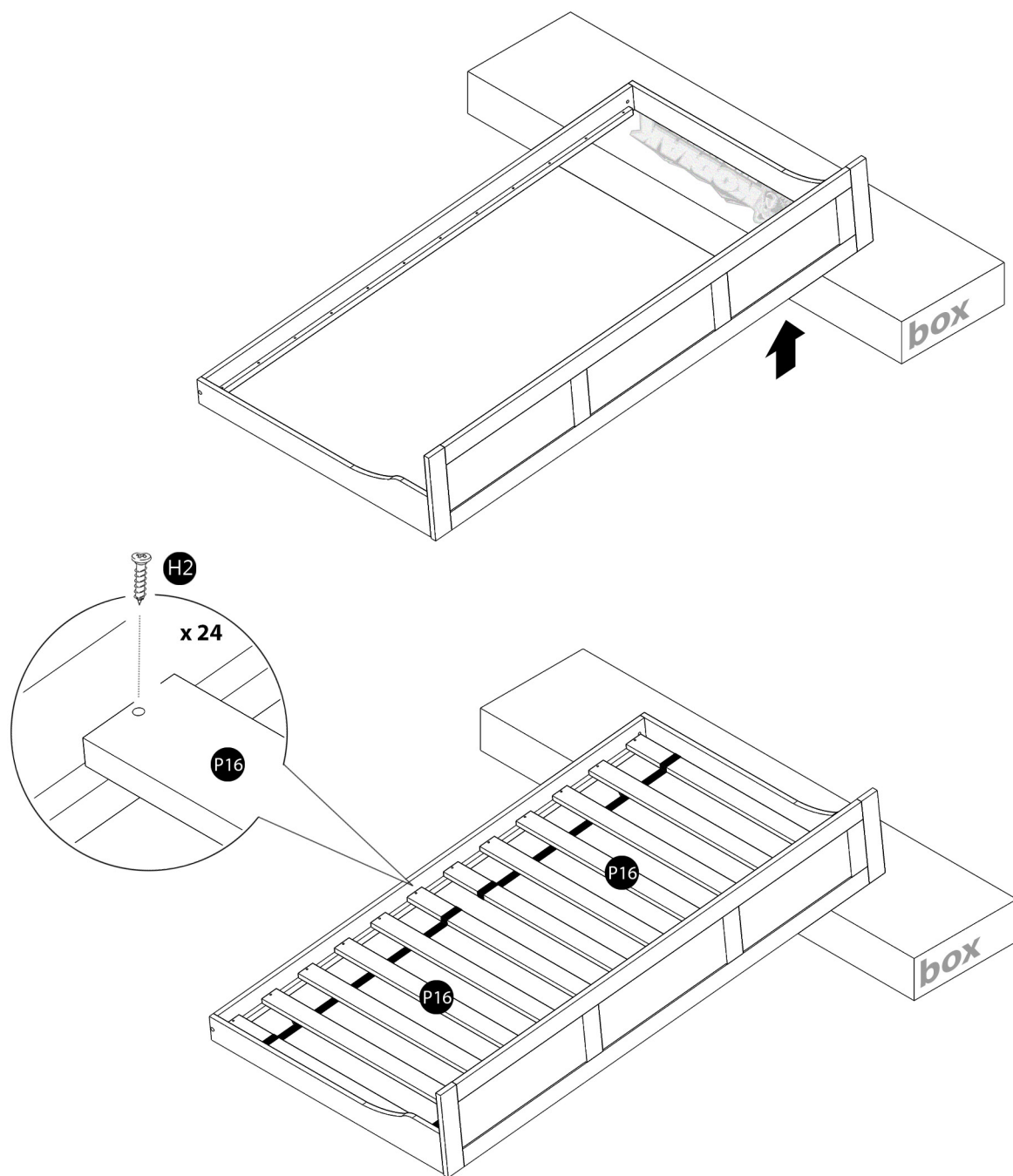

P16



x 24