

RVA428922

Door

RVA428922

- Door panels, dark brushed stainless steel, handleless.
 - For RY 497, panel thickness 19 mm.
 - Door panels, dark brushed stainless steel, handleless.
- For RY 497, panel thickness 19 mm.

Niche width 900 mm

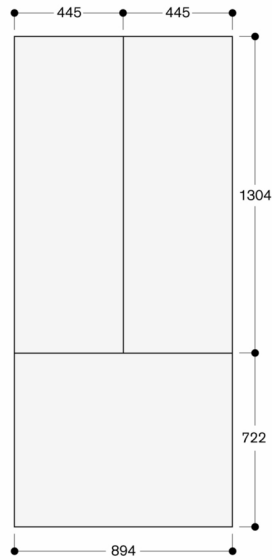

The door panel thickness is 19 mm

The maximum door panel dimensions are based on a clearance of 3 mm, based on a single niche

Measurements in mm

Niche width 35.5" (900 mm)

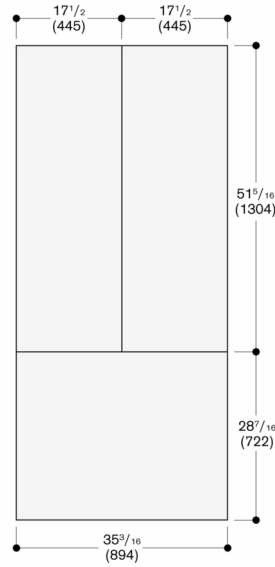

The door panel thickness is 3/4" (19 mm)

The maximum door panel dimensions are based on a clearance of 1/8" (3 mm), based on a single niche

Measurements in inches (mm)