



Assembly Instruction CELESTE COUNTER HEIGHT CHAIR D400-22

Thank you for purchasing this quality product. Be sure to check all packing materials carefully for small parts, which may have come loose inside the carton during shipment. Identify and count all items and compare with the parts list and/or hardware list shown below.

PARTS LIST			
No.	DESCRIPTION	SKETCH	Q'TY
A	CUSHION SEAT		2
B	CHAIRBACK		2
C	LEFT SIDE FACING (LSF) LEG		2
D	RIGHT SIDE FACING (RSF) LEG		2
E	FRONT STRETCHER		2
F	LEFT SIDE FACING (LSF) STRETCHER		2
G	RIGHT SIDE FACING (RSF) STRETCHER		2

HARDWARE LIST			
No.	DESCRIPTION	SKETCH	Q'TY
1	Long Bolt (5/16" x 3-1/4")		8
2	Medium Bolt (5/16" x 2-1/4")		8
3	Short Bolt (5/16" x 1-1/2")		4
4	Screw (1-3/8")		12
5	Spring Washer (5/16 ")		20
6	Flat Washer (5/16 ")		20
7	Allen key M5		2

DO NOT TIGHTEN LEGS UNTIL THE CHAIR IS FULLY ASSEMBLED

STEP 1: Place the chairback (B) on a soft and clean surface. Assemble the cushion seat (A) with the chairback (B) by using Allen Key (7) with hardware 3,5, and 6.
**Attention: DO NOT TIGHTEN THE BOLTS.

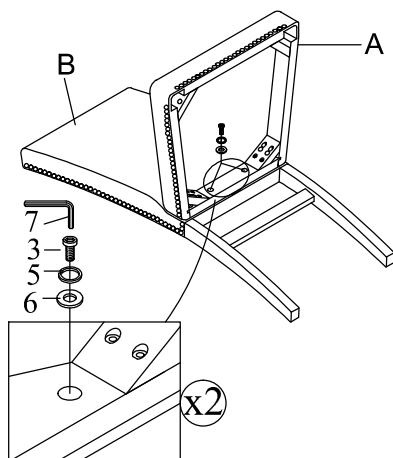

STEP 2: Assemble the cushion seat (A) with the back legs of the chairback (B) by using Allen Key (7) with hardware 1, 5, and 6.
**Attention: DO NOT TIGHTEN THE BOLTS.

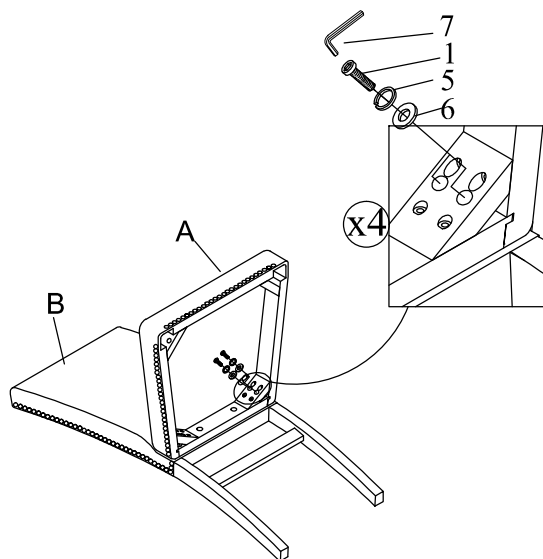

MADE IN VIETNAM

Assembly Instruction
CELESTE COUNTER HEIGHT CHAIR
D400-22

STEP 3 : Assemble the front legs (C & D) with the Cushion Seat (A) by using Allen Key (7) with hardware 2, 5, and 6.

****Attention: DO NOT TIGHTEN THE BOLTS**

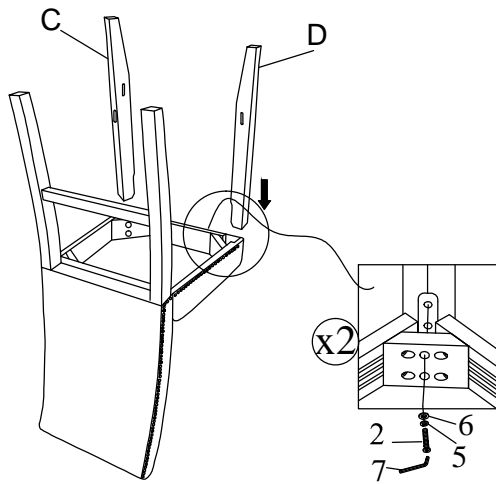

STEP 4: Install the front stretcher (E) between the front legs (C & D), then install the LSF stretcher (F) by inserting the end with the label "front" into the front LSF leg (C) and the RSF stretcher (G) by inserting the end with the label "front" into the front RSF leg (D).

Assemble the stretchers by using a screwdriver with hardware 4.

****Attention: DO NOT TIGHTEN THE SCREWS**

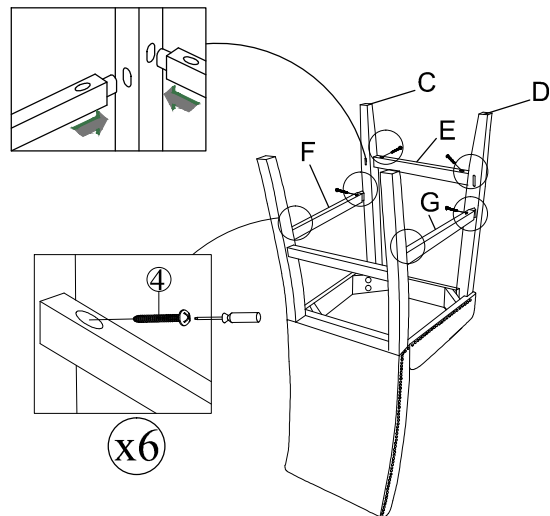

STEP 5: To level the chair, stand the chair up on a flat surface and tighten all the bolts by using Allen Key (7) and all the screws with a screwdriver.

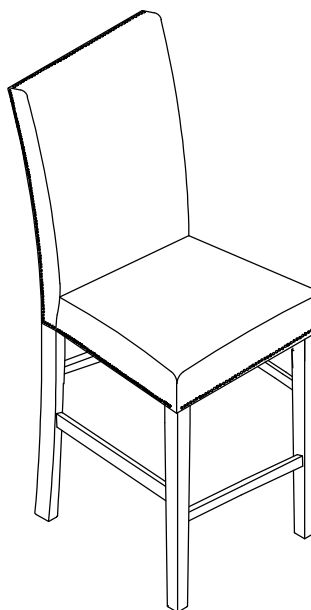

MADE IN VIETNAM