

CGA90WOK-F

AEG

36" Built-In Stainless Steel Gas Cooktop

FEATURES & BENEFITS

Stunning UltraFlat Design

This gas cooktop has been carefully designed to have a flat surface, so you can be confident in keeping it perfectly clean and ready to use at all times

Rotary Stainless Steel Control Knobs

Easy to use control knobs not only deliver precise adjustment of the flame intensity but also easy ignition by simply depressing the knob.

Cast Iron Support Grates

Continuous heavy duty cast iron grates keeps cookware stable for even heating.

Triple Wok Ring Burner

The triple wok high output burner located middle left of the cooktop produces high heat for wok cooking, intense frying or fast heating of large boiling pots.

Electronic Ignition

The gas is lit automatically when the control knob is pushed and turned in a single-handed operation.

For The Ultimate Level of Safety

The gas will automatically shut off from the source if the flame accidentally goes out.

Easy Clean Stainless Steel Cooktop

Wipe away spills with ease on the specially-coated surface, and keep your stainless steel cooktop looking like new.

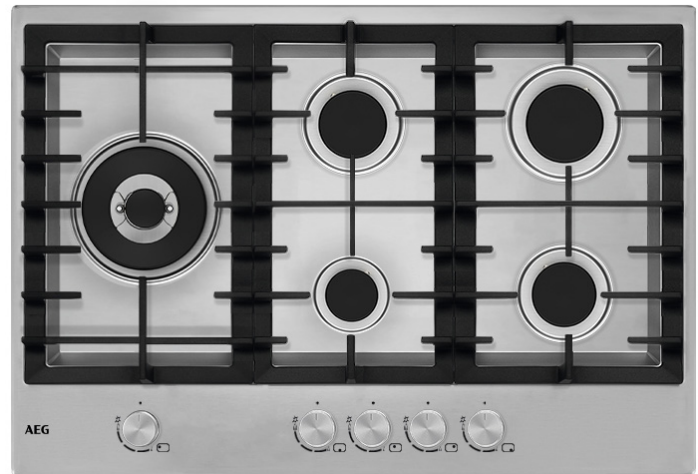

AVAILABLE COLOURS

Stainless Steel

GENERAL PROPERTIES

Installation Type	Built-In
Style	UltraFlat Design for Flush Install
Type	Gas Cooktop
Number of Burners	5
Cooking Surface	Matte Black Enamel
Fingerprint Resistant	Yes
Fuel Type	Natural Gas

COOKTOP FEATURES

Cooktop Burner Type	Continuous Cast Iron Support Grates
Number of Burners	5
Triple Ring Burner / BTU - Left Middle	17500/4750
Semi-Rapid Burner / BTU - Left Rear	8000/1390
Rapid Burner / BTU - Right Rear	11500/2380
Auxiliary Burner / BTU - Left Front	5000/940
Semi-Rapid Burner / BTU - Right Front	8000/1390
Electronic ignition	Yes
Flame Failure Safety System	Yes
Drawer Install / Below Oven Install	Yes

CONTROL

Cooktop Control Type	Stainless Steel Rotary Control Knobs
Control Location	Right Center

TECHNICAL DETAILS

Electrical Supply	115 V, 60Hz, 15 Amp
LPG Conversion Kit Included	Yes

DIMENSIONS

Product Dimensions (In / mm) (W / H / D)	35 ^{1/16"} / 2 ^{3/8"} / 20" (890mm / 60mm / 508mm)
Cut-Out Dimensions (In / mm) (W / H / D)	33 ^{7/8"} / min. 2 ^{1/2"} / 18 ^{7/8"} (860mm / min. 63mm / 480mm)

WARRANTY

Parts & Labor	2 Years
---------------	---------

Installation Details

PRODUCT DIMENSIONS		CUT-OUT DIMENSIONS	
In (W / H / D)	35 ¹ / ₁₆ " / 2 ³ / ₈ " / 20"	In (W / H / D)	33 ⁷ / ₈ " / min. 2 ¹ / ₂ " / 18 ⁷ / ₈ "
mm (W / H / D)	890mm / 60mm / 508mm	mm (W / H / D)	860mm / min. 63mm / 480mm

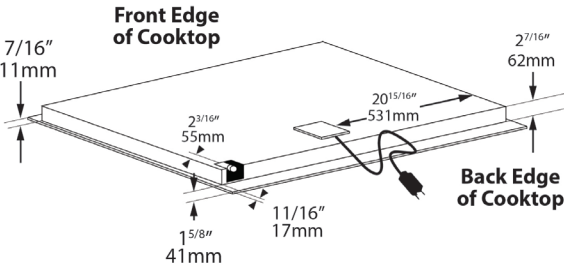
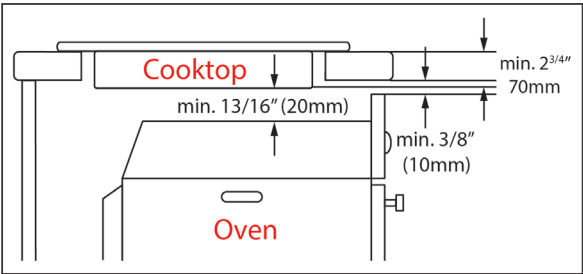
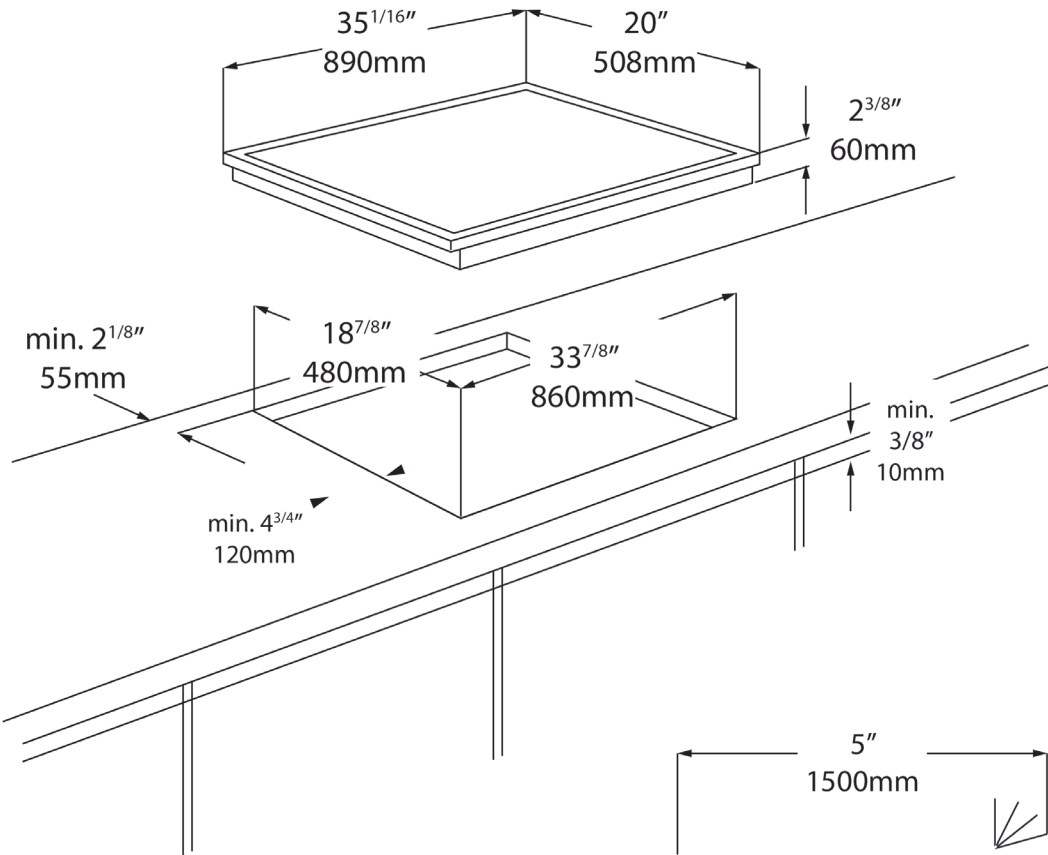

INSTALLING OVER BUILT-IN OVEN

1. There must be a minimum of 20mm (13/16") of space left between the bottom of the cooktop and the oven to allow air to flow.
2. There must be a minimum of 5mm (3/16") of space left between the counter top and the door panel of a built-in oven / drawer.
3. If sufficient air flow is not provided, the life of the appliance will be shortened.

ELECTRICAL REQUIREMENTS

Power Supply	115V ~ 60Hz
Amperage	15 Amp

Installation Details

RECOMMENDED CABINET DESIGN

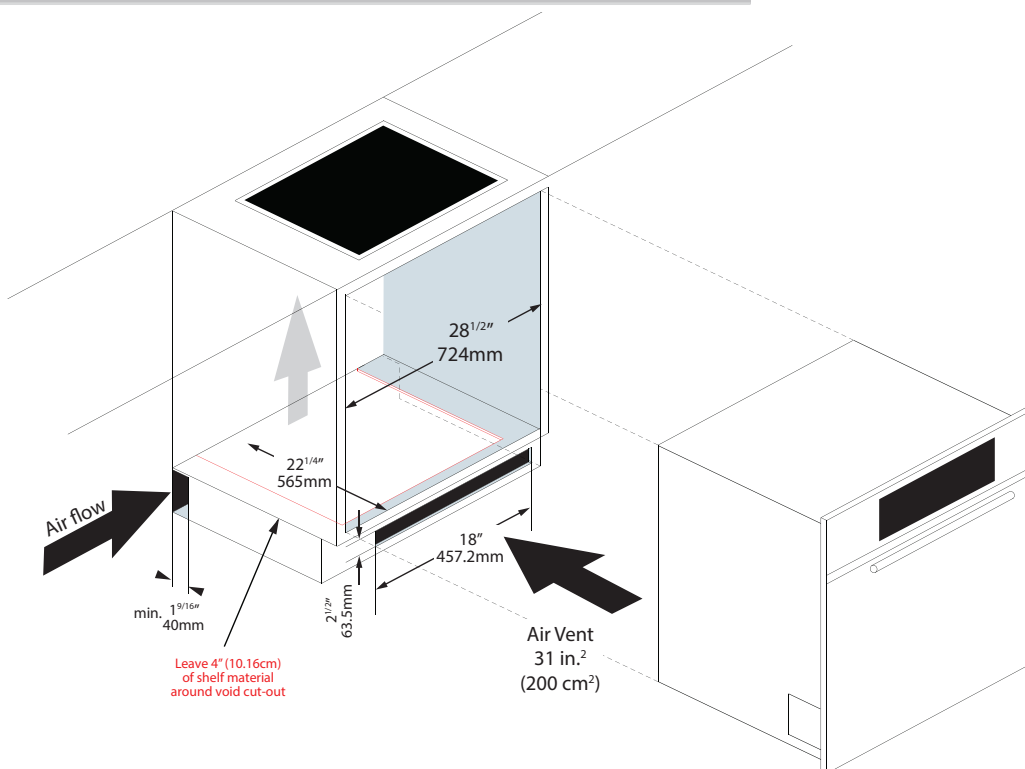

RECOMMENDED MINIMUM CLEARANCE

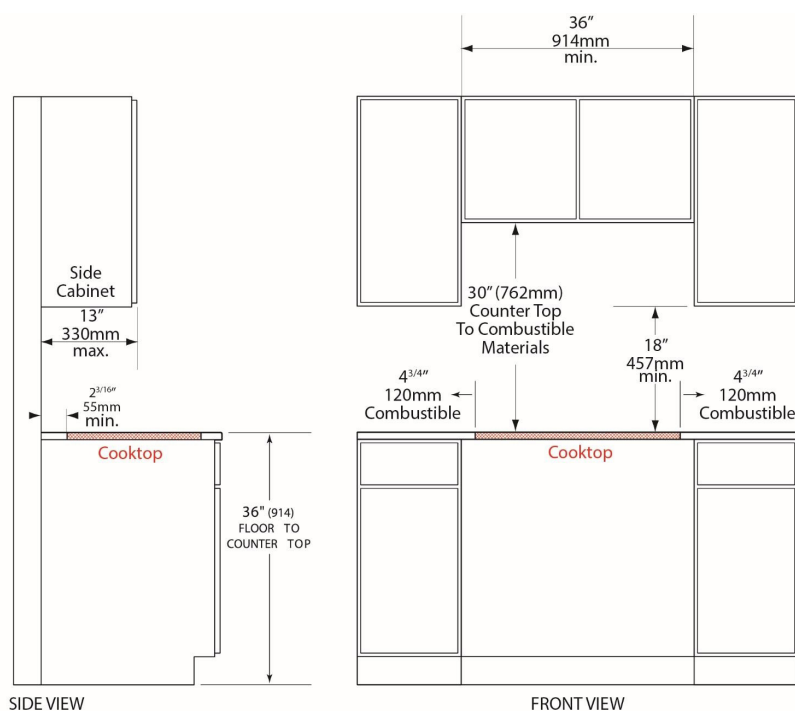



WARRANTY INFORMATION

AEG Appliances are designed and manufactured to the highest standards. Each appliance is covered by a comprehensive 2-year parts and labour warranty. Refer to product warranty policy for complete terms and conditions.

FOR PARTS & SERVICE

Euro-Parts & Service

39822 Belgrave Road, Belgrave, ON. N0G 1E0 1-800-561-4614
www.euro-parts.ca • parts@euro-parts.ca • service@euro-parts.ca

AEG appliances are imported and distributed in North America by Euro-Line Appliances Inc. For more information, please visit one of our showrooms or www.ela.ca

EURO-LINE APPLIANCES INC.

871 Cranberry Court
Oakville, ON L6L 6J7
Tell: 905.829.3980
Toll-Free: 1-800.421.6332
Email: info@ela.ca

EURO-LINE APPLIANCES INC.

101-1014 Homer Street
Vancouver, BC V6B 2W9
604.235.3980
1-855.352.9378
infowest@ela.ca