

#### Warning :

- Be sure to check all packing material carefully for small parts, which may have come loose inside the carton during shipment.
- To prevent possible scratches and damage, this furniture must be assembled on a soft surface such as a blanket or carpet.

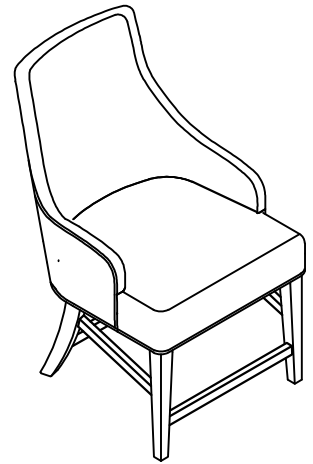

92605 / 06 / 07

Swoop Arm Uph Stool

#### Components and Hardware List

<b>Seat Frame</b>  1 pc.	<b>Back Leg (Left)</b>  1 pc.	<b>Back Leg (Right)</b>  1 pc.	<b>Front Leg (Left)</b>  1 pc.	<b>Front Leg (Right)</b>  1 pc.		
<b>Back Stretcher</b> 14-5/8" x 1-1/4" x 3/4"  1 pc.	<b>Front Stretcher</b> 20-3/8" x 1-1/4" x 3/4"  1 pc.	<b>Side Stretcher (Left)</b> 16-3/8" x 1-1/4" x 3/4"  1 pc.	<b>Side Stretcher (Right)</b> 16-3/8" x 1-1/4" x 3/4"  1 pc.	<b>Allen Head Bolt</b> Ø5/16" x 18 x 2-1/8"  8 pcs.	<b>Ø5/16" Spring Washer</b>  8 pcs.	<b>Ø5/16" Flat Washer</b>  8 pcs.
<b>4mm Allen Key</b>  1 pc.	<b>Wood Screw</b> Ø4x45 mm  8 pcs.	<b>Screw Driver</b> not included 				

STEP 1: Remove Velcro strips on the seat frame to assemble the legs.

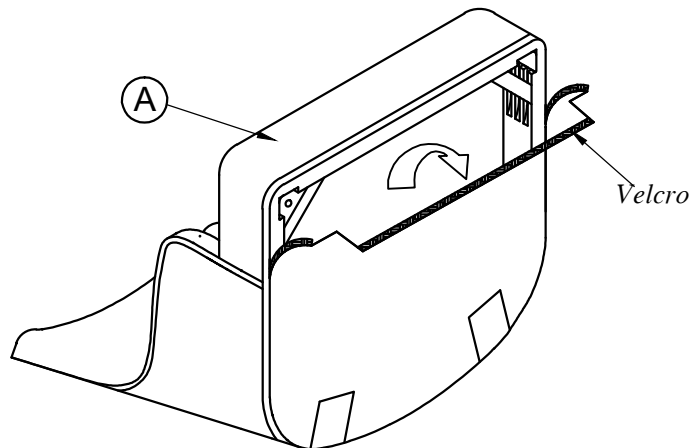

STEP 2: Do not fully tighten the screws.

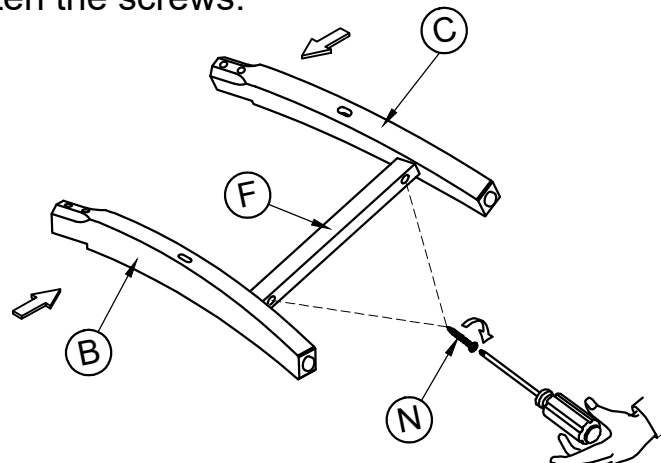

STEP 3: Do not fully tighten the bolts.

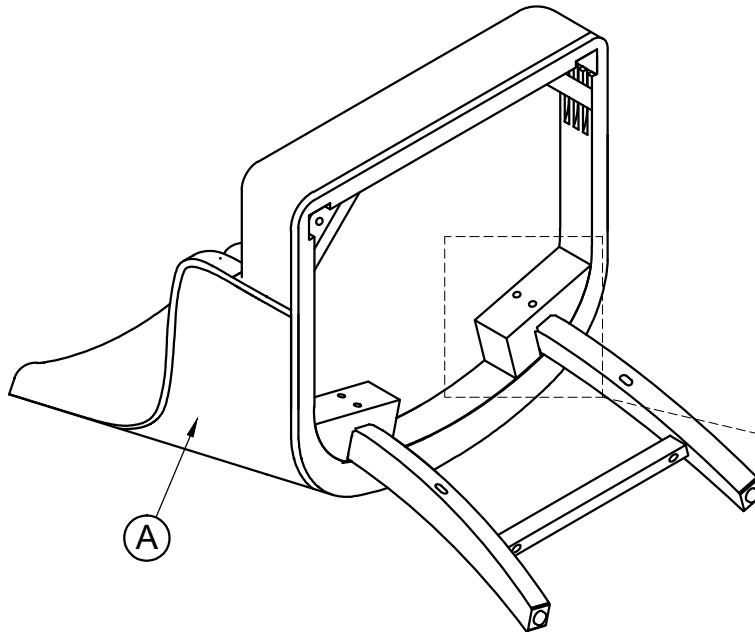

STEP 4: Do not fully tighten the screws.

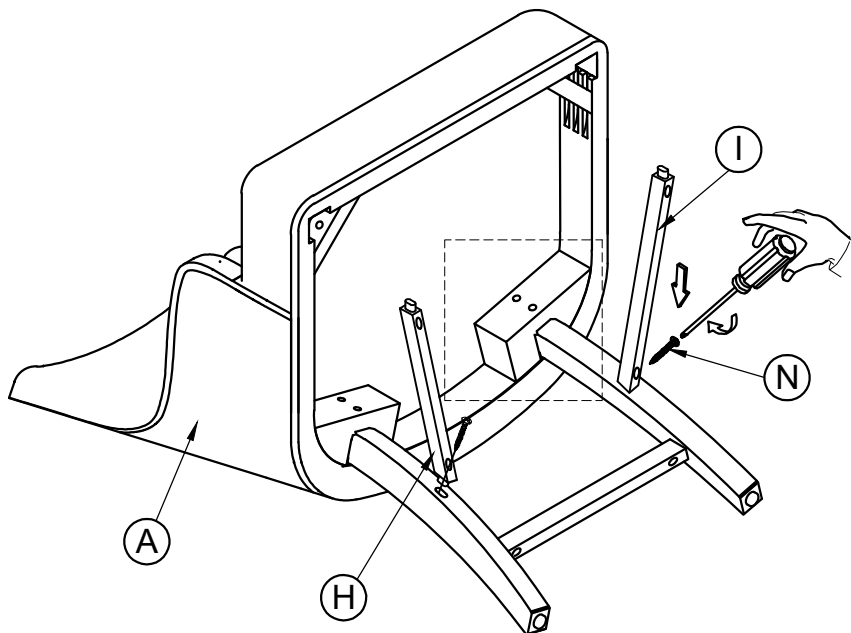

STEP 5: Do not fully tighten the screws.

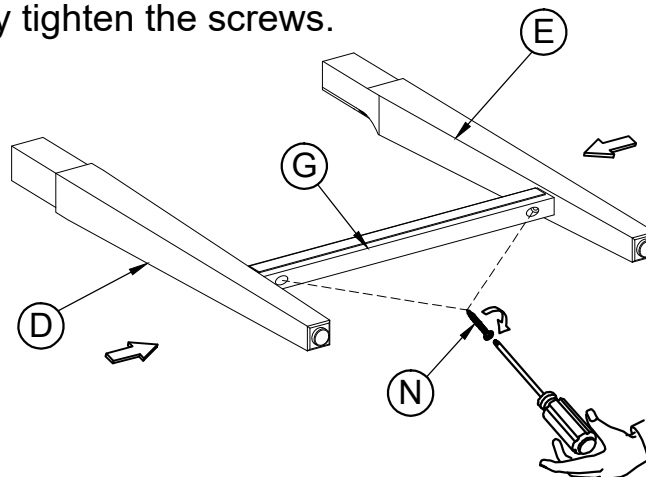

**STEP 5:** Using the Allen Key to tighten all bolts.

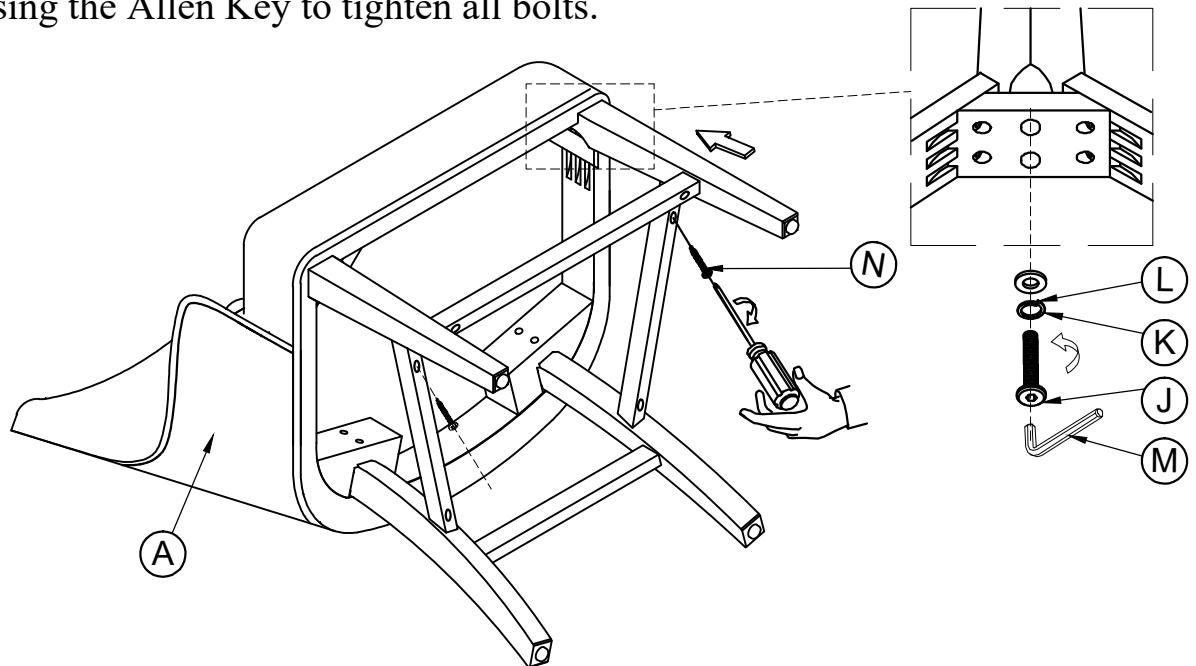

**STEP 7:** Using the Philips Head Screw driver to tighten all screws.

**STEP 8:** Attach all Velcro strips to the seat frame.

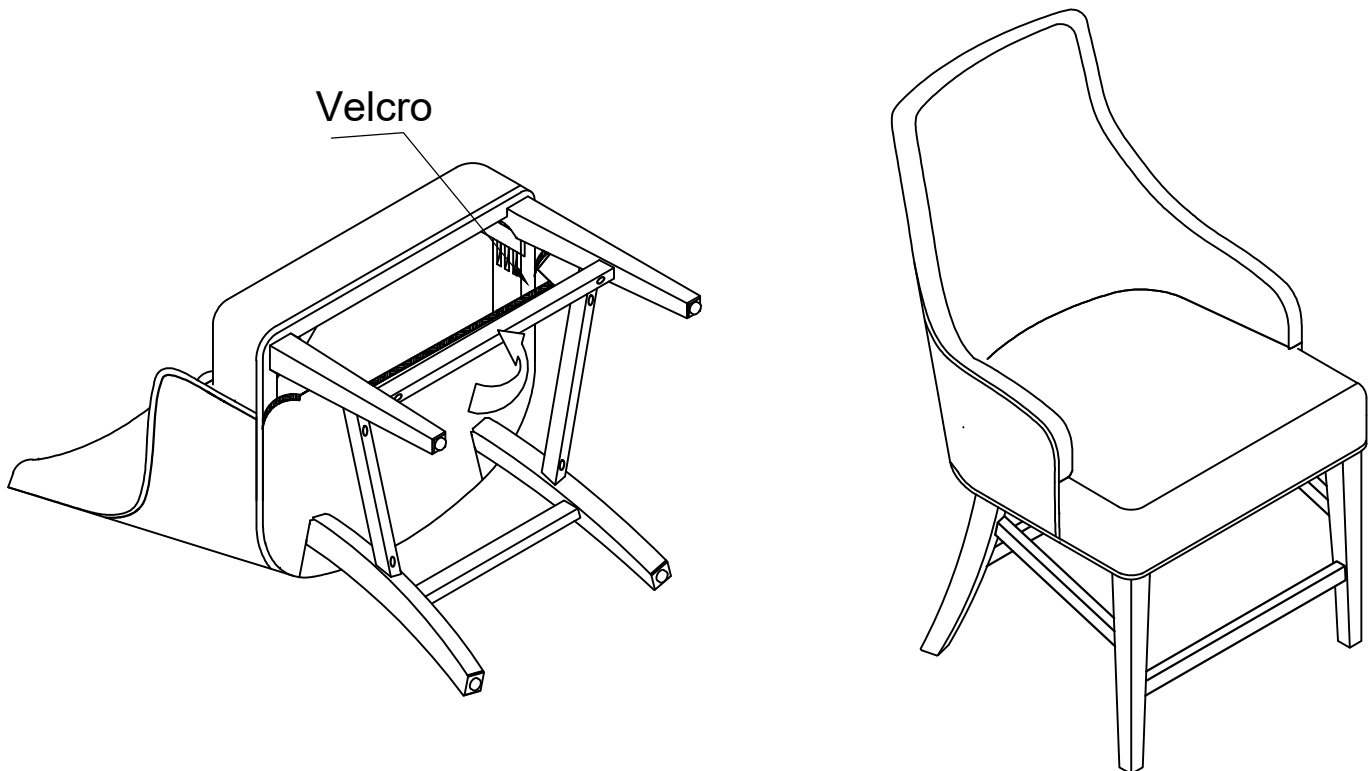

**COMPLETE**