

**EN** FRONT LOAD WASHER

FR LAVEUSE À CHARGEMENT FRONTAL

ES LAVADORA DE CARGA FRONTAL

USE & CARE GUIDE

GUIDE D'UTILISATION ET D'ENTRETIEN

GUÍA DE USO Y CUIDADO



**Electrolux**

## THANK YOU LETTER

Thank you for choosing us! Before using your new product, please read this manual thoroughly to ensure that you know how to operate the features and functions that your new appliance offers in a safe way.

# Contents

Thank You Letter.....	01
Safety and Precautions.....	02
Safety and precautions.....	02
Important safety instructions.....	03
Grounding instructions.....	05
Before operating this machine.....	05
Protecting the machine.....	05
Handling the Machine.....	05
Washing clothes.....	06
Installation Requirements.....	07
Installation requirements.....	07
Tools and parts.....	07
Location requirements.....	08
Installation clearances.....	08
Electrical requirements.....	08
Washer dimensions.....	09
Unpacking the washing machine.....	09
Installation Instructions.....	10
Dispose the packing materials.....	10
Remove transport foam and bolts.....	10
Select the location.....	10
Connect inlet pipe.....	10
Drain system options.....	11
Level the washer.....	12
Electrical connection.....	12
Operating Instructions.....	13
Operating Instructions.....	13
Prepare before washing clothes.....	13
Control panel.....	16
Special function.....	18
Washing clothes for the first time.....	19
Select the laundry cycle.....	19
Table of washing procedures.....	20
Maintenance Instructions.....	21
Troubleshooting Tips.....	25
Remove the Problems.....	26
Appendix.....	27
Technical Specifications.....	28
Limited Warranty.....	29



Read all instructions and explanations before use. Follow the instructions carefully. Keep the operation instructions handy for later use. If the appliance is sold or passed on then ensure that the new owner always receives these operation instructions.

You could download the electronic user manual from website too.  
<https://www.electrolux.com>

# Safety and Precautions

## Safety and precautions

This manual contains important information on the installation, use, and care of your appliance. Please read this manual carefully before installation and operation of this machine to prevent injury and property damage.

## WHAT YOU NEED TO KNOW ABOUT SAFETY INSTRUCTIONS

Warnings and important safety instructions in this manual DO NOT cover all possible conditions and situations that may occur. It is your responsibility to use common sense, caution and care when installing, maintaining and operating your washer.

## IMPORTANT SAFETY SYMBOLS AND PRECAUTIONS



### WARNING

This indicates that hazards or unsafe practices may cause serious personal injury or death.  
To reduce the risk of fire, explosion, electric shock, or personal injury when using your washer, these basic safety precautions SHOULD be followed.

## State of California Proposition 65 Warnings



### WARNING

The California Safe Drinking Water and Toxic Enforcement Act requires the Governor of California to publish a list of substances known to the State of California to cause cancer, birth defects, or other reproductive harm, and requires businesses to warn of potential exposure to such substances.  
This product contains a chemical known to the State of California to cause cancer, birth defects, or other reproductive harm. This appliance can cause low-level exposure to some of the substances listed, including lead, cadmium and phthalate.

**WARNING:** Risk of reproductive harm from exposure to Lead. See [www.P65Warnings.ca.gov](http://www.P65Warnings.ca.gov).

# Safety and Precautions

## Important safety instructions

SAVE THESE INSTRUCTIONS



### WARNING

**WARNING** - To reduce the risk of fire, electric shock, or injury to persons when using your appliance, follow basic precautions, including the following:

- Read all instructions before using the appliance.
- Do not wash articles that have been previously cleaned in, washed in, soaked in, or spotted with gasoline, dry-cleaning solvents, or other flammable or explosive substances, as they give off vapours that could ignite or explode.
- Do not add gasoline, dry-cleaning solvents, or other flammable or explosive substances to the wash water. These substances give off vapours that could ignite or explode.
- Under certain conditions, hydrogen gas may be produced in a hot-water system that has not been used for 2 weeks or more. **HYDROGEN GAS IS EXPLOSIVE.** If the hot-water system has not been used for such a period, before using a washing machine, turn on all hot-water faucets and let the water flow from each for several minutes. This will release any accumulated hydrogen gas. As the gas is flammable, do not smoke or use an open flame during this time.
- Always unplug the washing machine from the power supply before attempting any service. Disconnect the power cord by grasping the plug, not the cord.
- To reduce the risk of fire, clothes, cleaning rags, mop heads and the like which have traces of any flammable substance, such as vegetable oil, cooking oil, petroleum based oils or distillates, waxes, fats, etc. must not be placed in the washing machine. These items may contain flammable substances which, even after washing, may smoke or catch fire.
- Never place items in the washer that have been dampened with gasoline or any combustible or explosive substance. Do not wash or dry anything that has been soaked in or spotted with any type of oil (including cooking oils). Doing so can result in fire, explosion, or death.
- Risk of Suffocation and Injury from Entrapment: Do not allow children to play on or in the appliance. Close supervision of children is necessary when the appliance is used near children.
- Pets and kids may climb into the machine. Check the machine before every operation.
- Glass door or protector may be very hot during the operation. Keep kids and pets far away from the machine during the operation.
- This machine is not intended for use by persons (including kids) with reduced physical, sensory or mental capabilities, or lack of experience and knowledge, unless they have been given supervision or instruction concerning use of the machine by a person responsible for their safety.
- Kids should be supervised to ensure that they do not play with the machine.
- When children become old enough to operate the appliance, it is the legal responsibility of the parents or legal guardians to ensure that they are instructed in safe practices by qualified persons.

# Safety and Precautions

## Important safety instructions

SAVE THESE INSTRUCTIONS



### WARNING

- Do not machine wash fiberglass materials (such as curtains and window coverings that use fiberglass materials.) Small particles may remain in the washing machine and stick to fabrics in subsequent wash loads causing skin irritation.
  - Before the appliance is removed from service or discarded, remove the door and cut off the power cord.
  - Do not reach into the appliance if the tub or agitator is moving.
  - Do not install or store this appliance where it will be exposed to the weather.
  - Do not tamper with controls.
  - Do not repair or replace any part of the appliance or attempt any servicing unless specifically recommended in the user-maintenance instructions or in published user-repair instructions that you understand and have the skills to carry out.
  - Pull out its plug from the power socket before cleaning or maintenance.
  - Make sure that all pockets are emptied.
  - Sharp or rigid items such as coin, brooch, nail, screw or stone etc. may cause serious damages to this machine.
  - Pull out its plug and cut off water supply after the operation.
  - Please check whether the water inside the drum has been drained before opening its door. Please do not open the door if there is any water visible.
  - Do not try to repair the machine by yourself.
  - If the plug (power cord) is damaged, it shall be replaced by the manufacturer or a service agent to avoid any danger.
  - Take care that the power voltage and frequency shall be identical to those of the washing machine.
  - Do not use any socket with rated current less than that of the washing machine.
  - To ensure your safety, the power cord plug must be inserted into an grounded three-pole socket. Check carefully and make sure that your socket is properly and reliably grounded.
  - Never pull out the power cord plug with wet hands.
  - This machine shall be repaired only by an authorized service center and only authentic accessories can be used.
  - An appliance shall be clearly and permanently marked with a warning that the appliance is intended for use only with fabrics that have been washed with water as a cleaning agent.
  - Do not use replacement parts that have not been recommended by the manufacturer (e.g. parts made at home using a 3D printer).
  - If connected to a circuit protected by fuses, use time-delay fuses with this appliance.
  - Do not use fabric softeners or products to eliminate static unless recommended by the manufacturer of the fabric softener or product.
- The interior of the appliance should be cleaned periodically by qualified service personnel.

# Safety and Precautions

## Grounding instructions



### WARNING

- This appliance must be grounded. In the event of a malfunction or breakdown, grounding will reduce the risk of electric shock by providing a path of least resistance for the electric current. This appliance is equipped with a cord that has an equipment grounding conductor and a grounding plug. The plug must be plugged into an appropriate outlet that is properly installed and grounded in accordance with all local codes and ordinances.

**WARNING**-Improper connection of the equipment grounding conductor can result in electric shock. Connect to individual branch circuit. Check with a qualified electrician or serviceman if you are in doubt as to whether the washer is properly grounded.

Do not modify the plug provided with the appliance - if it will not fit the outlet, have a proper outlet installed by a qualified electrician.

## Before operating this machine



### WARNING

- Packing materials may be dangerous to children. Please keep all packing materials (plastic bags, foams etc) away from children.
- Washing machine shall not be installed in humid conditions or near flammable/explosive material.
- Make sure that the water and electrical devices are connected by a qualified technician in accordance with the manufacturer's instructions and local safety regulations.
- Remove all packaging and transport bolts from the machine. Otherwise, washing machine may be seriously damaged while washing the clothes.
- Before washing clothes for the first time, washing machine shall run Normal cycle and hot water with no clothes.
- This washing machine is for indoor use only.

## Protecting the Machine



### WARNING

- Do not climb up and sit on top of the machine.
- Do not lean against machine door.
- Please do not close the door with excessive forces. If it is found difficult to close the door, please check if the excessive clothes are put in or distributed well. Load the tub no more than 3/4 fill.

## Handling the Machine



### WARNING

- Transport bolts shall be reinstalled to the machine by a specialized person.
- The accumulated water shall be drained out of the machine.
- Handle the machine carefully. Never hold each protruded part on the machine while lifting.
- Do not use the door as a handle to lift the machine.

# Safety and Precautions

## Washing Clothes



### WARNING

- Connect cold water to the machine. Hot water may also be connected according to local regulations and availability in your home.
- Your washing machine is only for home use and is only designed for the textiles suitable for machine washing.
- Flammable and explosive or toxic solvents are forbidden. Gasoline and alcohol etc. shall not be used as detergents. Please only select the detergents suitable for machine washing, especially for front loading .
- Do not wash carpets with this machine.
- Be careful of burning when the washing machine drains hot washing water.
- Never refill the water by hand during washing.
- After the program is completed, please open the door after the bell or disconnect the power supply to the machine.
- Please remember to disconnect water and power supply immediately after the clothes are washed.
- Always follow the fabric care instructions recommended by the clothing manufacturer.
- Do not use the washing machine if it has a worn power cord or loose plug. Contact an authorized service agent.
- Do not operate the washing machine if any guards, panels and /or fasteners except transport fixing bolts have been removed. Check the fill hose connections on a regular basis to ensure that they are tight and not leaking.
- Do not operate the washing machine if parts are missing or broken.
- Do not touch the door if washing at high temperatures.

### Note:

- The important safeguards and warnings indicated in this manual do not cover all possible conditions which may occur. Common sense, caution and care must be exercised when installing, maintaining or operating the washing machine.
- Always contact your dealer, distributor, service agent or the manufacturer about any problems or conditions that you do not understand.

# Installation Requirements

## Installation requirements



1. This machine must be grounded properly. If there is any short circuit, grounding can reduce the danger of electrical shock.  
This machine is equipped with power cord, which includes plug, grounding wire at grounding terminal.
2. The washing machine shall be operated in a circuit separate from other electrical appliances. Otherwise, the power protector may be tripped or a fuse may be burned out.

**Failure to comply with these warnings could result in serious personal injuries.**

**Note:** Environmental Protection

- If you plan to dispose of this machine, please comply with the local waste disposal regulations. Cut off the power cord so that it will not be put into reuse.
- Remove the door so that kids and animals will not be trapped in the machine.
- Do not use an excessive amount of detergent.
- Decontaminant and bleach can be used to pre-treat the stains on the clothes only when very necessary.

## Tools and parts

Gather the required tools and parts before starting installation. The parts supplied are in the washer drum.

1/4" nut driver  
3/8" socket with ratchet  
3/8" open-end wrench  
Adjustable wrench or 7/16" socket with ratchet  
Adjustable wrench or 9/16" open-end wrench  
Channel-lock adjustable pliers  
Carpenter's level

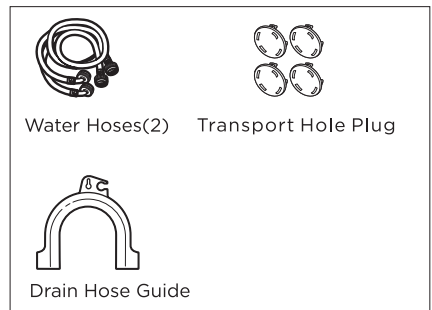

# Installation Requirements

## Location requirements

Selecting the proper location for your washer improves performance and minimizes noise and possible washer “walk.” Your washer can be installed under a custom counter, or in a basement, laundry room, closet, or recessed area. See “Drain System.” Companion appliance location requirements should also be considered. Proper installation is your responsibility.

### You will need

1. A water heater set to deliver 120°F (49°C) water to the washer.
2. A grounded electrical outlet located within 6 ft. (1.8 m) of where the power cord is attached to the back of the washer. See “Electrical Requirements.”
3. Hot and cold water faucets located within 4 ft.(1.2 m) of the hot and cold water fill valves, and water pressure of 20-100 psi (137.9-689.6 kPa).
4. A level floor with a maximum slope of 1" (25 mm) under entire washer. Installing the washer on soft floor surfaces, such as carpets or surfaces with foam backing is not recommended.
5. A sturdy and solid floor to support the washer, which has a total weight (water and load) of 200lbs.
6. Do not operate your washer in temperatures below 32°F (0°C). Some water can remain in the washer and can cause damage in low temperatures.

## Installation clearances

1. The location must be large enough to allow the washer door to be fully opened.
2. Additional spacing should be considered for ease of installation and servicing. The door opens more than 90°, and it is not reversible.
3. Additional clearances might be required for wall, door, and floor moldings.
4. Additional spacing of 25mm on all sides of the washer is recommended to reduce noise transfer.
5. Companion appliance spacing should also be considered.
6. This appliance can be installed in a closet and requires ventilation in the door. When installed in closet: Sides=1"(2.54cm), Rear=1"(2.54cm), Top=2"(5.08cm); Front=1"(2.54cm) Closet door ventilation openings required: 2 louvers each 60 square in.(387cm<sup>2</sup>), located 3"(7.6cm) from top and bottom of door.

## Electrical requirements



**⚠ WARNING**

**Electrical Shock Harzard**

Connect to grounded 3 prong outlet with an individual 15 amp branch circuit protected by a 15 amp circuit breaker.

Connect to individual branch circuit.

Do not remove ground prong.

Do not use an adapter.

Do not use an extension cord.

Failure to follow these instructions can result in electrical shock, fire, or death.

# Installation Requirements

## Electrical requirements

1. A 120V, 60 Hz, AC-only, 15- or 20-amp, fused electrical supply is required. Use a time-delay fuse or circuit serving only this appliance.
2. This washer is equipped with a power supply cord with a 3-prong grounding plug.
3. To minimize possible shock hazard, the cord must be plugged into a mating, mating, 3-prong, grounding type outlet, grounded in accordance with local codes and ordinances. If a mating outlet is not available, it is the personal responsibility and obligation of the customer to have the properly grounded outlet installed by a qualified electrician.
4. If codes permit and a separate ground wire is used, it is recommended that a qualified electrician determine that the ground path is adequate.
5. Do not ground to a gas pipe.
6. Check with a qualified electrician if you are not sure the washer is properly grounded.
7. Do not have a fuse in the neutral or ground circuit.

## Washer dimensions

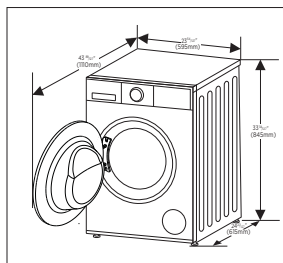

The dimensions shown are for the recommended spacing. Custom dercounter installation

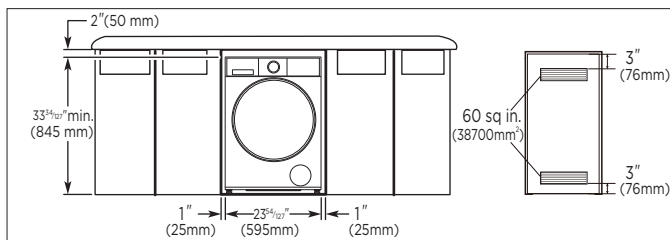

## Unpacking the washing machine

Unpack your washing machine and check if there is any damage during the transportation. Also make sure that all the items (as shown in "Tools and parts") in the attached bag are received. If there is any damage to the washing machine during the transportation, or any item is missing, please contact the local dealer immediately.

# Installation Instructions

## Dispose of the packing materials

The packing materials of this machine may be dangerous to kids. Please dispose them properly and avoid easy access by children. Please dispose of the related packing materials according to the relevant local regulations. Please do not throw the packing materials away together with other daily garbage.

## Remove transport foam and bolts

Remove all foam from the machine. On the bottom side of the unit, there is an additional small triangle of foam that must be removed. Check to see if the small triangle was removed with the foam on the bottom of the unit. If you do not see the triangle, lay the unit down on the side to remove the small triangle of foam manually.

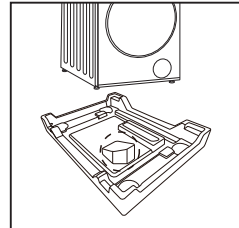

Before using the washing machine, the transport bolts must be removed from the backside of the machine. Please take the following steps to remove the bolts:

1. Loosen all bolts and plastic spacers (including rubber grommets) with a spanner, then remove them.
2. Cover the holes with the transport hole plugs.
3. Keep the transport bolts properly for future use.

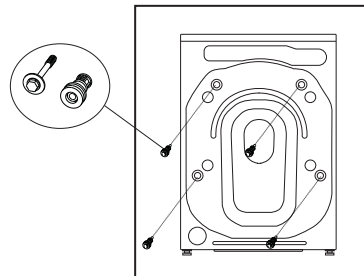

## Select the location

Please install the washing machine in a location with the following characteristics:

- Rigid, dry, and level surface (if not level, please see the Level the washer section for further instructions).
- Avoid direct sunlight.
- Sufficient ventilation.
- Room temperature above 5°C.
- Far away from heat sources such as coal or gas.

Make sure that the washing machine will not stand on power cord.

Do not install the washing machine on a carpeted floor.

## Connect inlet pipe

Connect the inlet pipe as indicated in the figure. If applicable, please connect the hot water valve to a hot water tap.

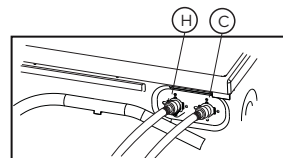

# Installation Instructions

## Connect inlet pipe

1. Connect the elbow of the inlet pipe to the tap and fasten it clockwise.
2. Connect the other ends of the inlet pipes to the inlet valves at the back of the washing machine. Fasten the pipe clockwise tightly.

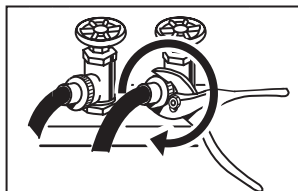

**Note:** If there is any leakage after connection, please repeat the steps above to ensure that the inlet pipe connections are tight. The provided inlet pipe should be compatible with the most common type of tap. If the tap is too square or too big to connect to the inlet pipe, please change the tap to a standard model.

## Drain system options

### Standpipe drain system - wall or floor (views A & B ).

The standpipe drain requires a minimum diameter standpipe of 2"(50 mm). The minimum carry-away capacity can be no less than 17 gal. (64 L) per minute. The top of the standpipe must be between 60-100 cm high (as measured from the bottom of the washer).

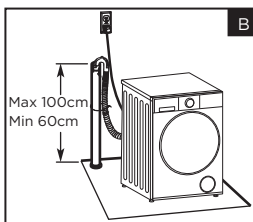
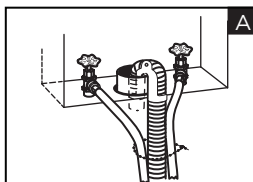

### Laundry tub drain system (view C).

The laundry tub needs a minimum 20 gal. (76 L) capacity. The top of the laundry tub must be at least 60cm above the floor.

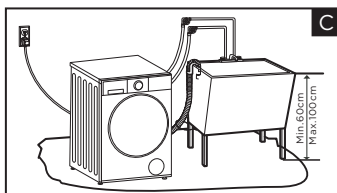

### Floor drain system (view D).

The floor drain system requires a siphon break that may be purchased separately. Please see **Tools and Parts** section for more information. The siphon break must be a minimum of 28" (710 mm) from the bottom of the washer. Additional hoses might be needed.

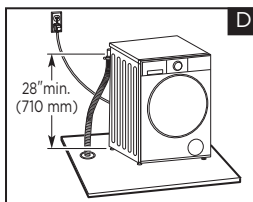

# Installation Instructions

## Level the washer

1. When positioning the washing machine, please first check if the legs are tightly attached to the washing machine cabinet. If not, please use your hands or a spanner to turn them to their original positions, then tighten the nuts again with a spanner.
2. After positioning the washing machine, check to see if the legs are stable by pressing each of the four corners of the machine. If the washing machine wobbles when you press down on one of the corners, adjust the leg for that corner.
3. Lock the washing machine legs in place. Loosen the lock nut with a spanner and turn the leg with your hand until it reaches the floor. Hold the leg stable with one hand as you tightly fasten the lock nut to the cabinet.
4. After all legs are locked, press the four corners of the machine again, one by one. If any of the corners are still unstable, repeat Steps 2 and 3.

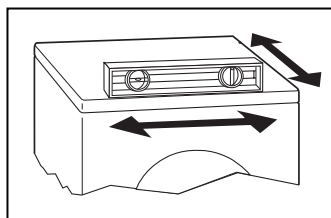
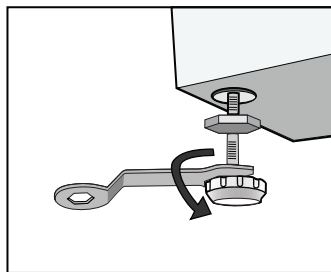

5. Put a solid cylinder (e.g. a soda can) at one edge of the top cover of the washing machine. Repeat with all four sides. If the cylinder stays stable, the washing machine is level. If it rolls downwards, the washing machine is not level. The cylinder will roll in the direction of lower ground. Raise the two legs in the direction the cylinder rolled towards until the washing machine is level. Repeat Steps 1-3 to make sure the bottom legs are flush against the ground and the lock nuts are tightly locked.

## Electrical connection

- As the maximum current through the unit is 12A when you are using its heating function, please make sure the power supply system (current, power voltage and wire) at your home can meet the normal loading requirements of the electrical appliance.
- Please connect the power to a socket which is correctly installed and properly grounded.
- Make sure the power voltage at your place is same as the voltage in the machine's rating label.
- The power plug must match the socket and cabinet must be properly and effectively grounded.
- Do not use a multi-purpose plug or socket as extension cord.
- Do not connect and pull out plug with wet hands.
- When connecting and pulling out the plug, hold the plug tightly and then pull it out. Do not pull the power cord forcibly.
- If the power cord is damaged or has any sign of being broken, a special power cord must be selected or purchased from its manufacturer or service center for replacement.

# Operating Instructions

## Operating instructions



### WARNING

**WARNING** – To reduce the risk of fire, electric shock, or injury to persons, read these **IMPORTANT SAFETY INSTRUCTIONS** before operating this appliance.

## Prepare before washing clothes

Please read these instructions carefully to avoid damage to your washing machine or clothes.

### Check if new clothes will lose their color.

Pour a teaspoon of liquid detergent onto a damp white towel. Rub a non-visible corner of the garment with the towel, then check to see if the towel is stained with the garment's original color.

Hand-wash scarves and other clothes could easily lose color separately before putting them in the washing machine.

Brush stains on collars, sleeves, and pockets gently with liquid detergent before machine-washing for the best results.

Wash temperature-sensitive clothes according to their laundry labels to prevent color changes or distortion.

### Keep in Mind:

Never leave clothes in the washing machine for a long period of time. If you do not wash clothes in time, the clothes may become moldy and develop spots.

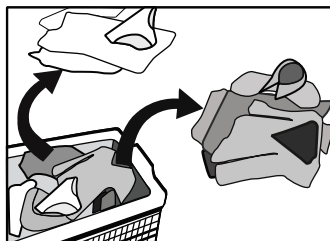

### Clothes that cannot be washed by washing machine.

Ties, waistcoats, suits, and jackets may shrink or become damaged if immersed in water.

Clothes made up of blended and synthetic fibers may also be affected by color bleed.

Please check laundry care labels before machine-washing clothes.

Ruffles and intentional wrinkles, embossed details, and resin in garments may be damaged when immersed in water. Silk, fur products, and fur decorations are also all easily damaged.

Clothes with many decorative details, long dresses, and traditionally-dyed clothing may all suffer from color bleeding.

Please do not wash clothes without laundry care labels and washing requirements.

Never wash clothes stained with chemicals such as gasoline, petroleum, benzene, paint thinner and alcohol.

# Operating Instructions

## Prepare before washing clothes

### **Please pay attention with regard to detergents**

Select low-foam detergent, washing powder, or special washing powder for drum washing according to fiber types (cotton, synthetic fiber, soft products and wool products), colors, washing temperatures, degrees of soil, and garment types. Choosing the wrong detergent can cause excessive foaming and overflow, along with other similar accidents.

Bleach is highly alkaline and can damage clothes. Please use as little bleach as possible.

Powder detergents can easily leave residue in clothes, which can cause bad odors, so please ensure they are sufficiently rinsed.

Detergent will not dissolve easily if there is too much detergent or too low of a water temperature.

Residual detergent can remain in clothes, pipes, and washing machines. Please ensure that you use the correct amount of detergent.

Detergent amount should be determined by clothing weight, clothing cleanliness, and local water hardness, as well as the recommendations from the detergent manufacturers. Please consult your local water company if you do not know your water hardness.

### **Note:**

Keep detergents and additives in safe and dry places, out of reach of children.

### **Please remove items from pockets.**

Please check the pockets of clothes to be washed and empty them of rigid items, such as decorations or coins, to prevent abnormal functioning or damage to the washing machine.

### **Separate laundry according to the following characteristics:**

**Fiber type:** Laundry care labels will use symbol types to represent cotton, blended fiber, synthetic fiber, silk, wool and artificial fiber.

**Color:** Separate white and colorful clothes. All new colorful clothes should be washed separately.

**Size:** Clothing articles of different sizes should be washed together for more effective washing.

**Sensitivity:** soft and delicate clothing should be washed separately. Select the **DELICATES** cycle for new pure wool garments, curtains, silks, and other delicate items.

Check the laundry care labels for all clothes.

Sort through clothes and remove all hooks from curtains before washing.

Clothing decorations may damage the washing machine. Turn clothes with buttons or embroidery inside-out before washing.

# Operating Instructions

## Prepare before washing clothes

### Tidy up fasteners:

Zip up zippers, tie loose bands or ribbons together, and close hooks, buttons, and other fastenings before washing.



### WARNING

Fasten all bra hooks, buttons, or zips and place bras in a closed delicates bag to prevent steel wires from damaging the machine.

Place especially delicate garments, such as laced curtains, straight jackets, and small articles (tights, handkerchiefs, ties etc.), into a delicates bag for washing.

When washing a single big and heavy garment, such as Turkish towels, jeans, wadded jackets etc., the washing machine may behave abnormally due to the lack of balance. Please add one or two more items of clothing and wash them together to ensure the machine drains smoothly.

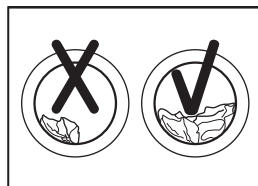
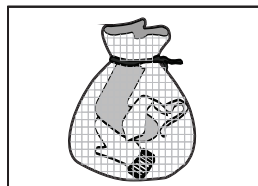

### Clean dust, stains, and pet hair before washing.

Excessive dust, stains, and pet hair can cause friction that damages clothing and prevents the washing machine from operating normally.

### To protect baby skin.

Baby articles (baby clothes and towels) including napkins shall be washed separately.

Baby clothes may become unsanitary if washed together with adults' clothes. Increase the rinsing time to ensure thorough rinsing and cleaning without detergent residue.

**For the best results, hand-wash clothing parts that are easily stained, such as white socks, collars, and sleeves, before machine-washing.**

Please use powder or liquid detergent. Soap could leave residue on clothing if used.

### Clothes that pill easily should be turned inside-out before washing.

Clothes that pill easily should be washed separately to avoid leaving threads and residue on other garments. Black clothes and cotton clothes should be washed separately, because they can easily pick up threads and fabric residue if washed together. Please check before washing.

### Do not wash waterproof materials (ski suits, placemats, shower curtains) with the washing machine.

Do not machine-wash clothes that cannot easily absorb water, or there may be a risk of overflow, abnormal vibration, or damage to your clothes while rinsing and draining. Do not wash placemats, raincoats, umbrellas, ski suits, car covers, or sleeping bags in the washing machine.

### Cautions during Draining.

Normally, water from washing is drained through the drain hole. If waterproof items are washed in the washing machine, water can gather or pool in a different direction, preventing draining and unbalancing the washing machine.

# Operating Instructions

## Control panel

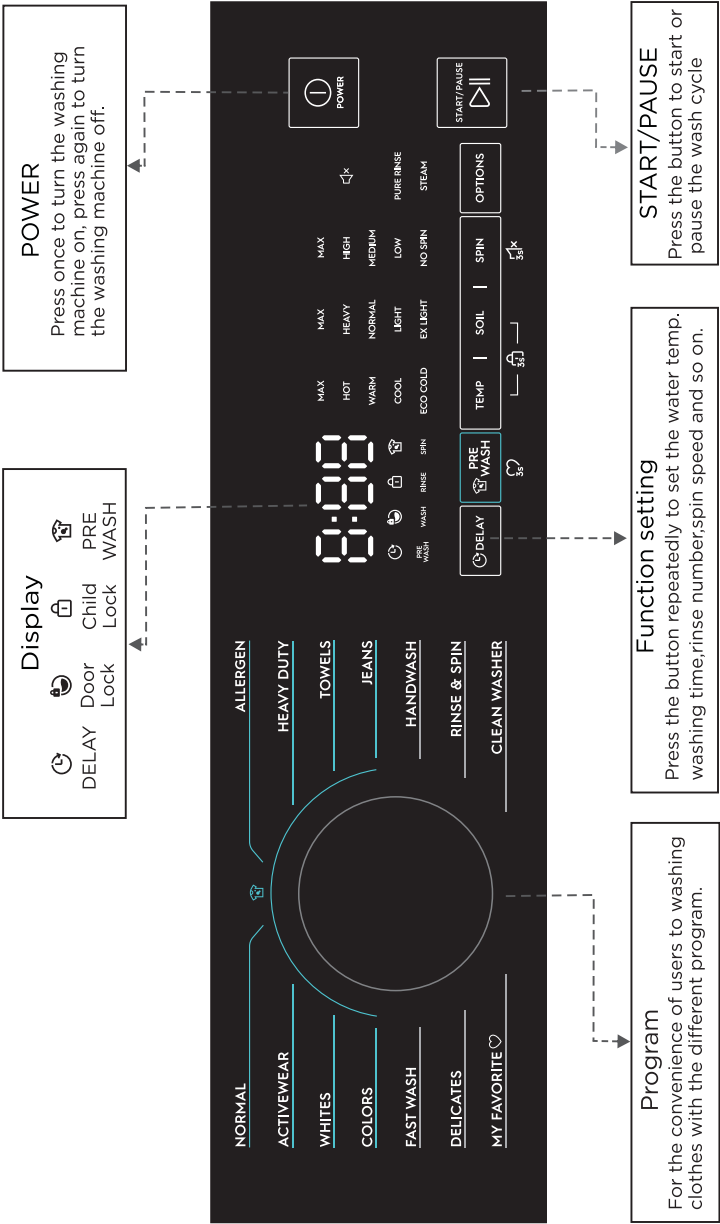

- Notes:**
1. The Control panel line chart is for reference only, Please refer to real product as standard.
  2. The Control panel could be changed without written notice. Please visit the website of Washing Machine or call up the service line for consultation.

# Operating Instructions

## Control panel

### View of the program

#### - NORMAL

Suitable for everyday fabrics like cotton, linen, towels, shirts, sheets, and denim. Handles normally soiled loads with standard wash action and medium temperatures.

#### - ALLERGEN

Effectively remove most of bacterium and allergens.

#### - HEAVY DUTY

Designed for heavily soiled, durable items such as towels, sportswear, and fabric tote bags. Uses aggressive wash action and high temperatures for deep cleaning.

#### - TOWELS

Ideal for towels and bulky bedding items such as comforters. Utilizes prolonged agitation and elevated water temperatures for deep cleaning.

#### - JEANS

Designed for heavily soiled, durable items such as jeans. Uses aggressive wash action and high temperatures for deep cleaning.

#### - HANDWASH

Suitable for small loads of lightly soiled, delicate fabrics. Employs minimal agitation, lower temperatures and reduced spin speeds to protect fabric integrity.

#### - RINSE & SPIN

Provides a cold water rinse or allows for fabric softener addition if missed during the main cycle. Also useful for refreshing items or removing moisture from swimwear.

#### - CLEAN WASHER

Maintains washer hygiene by cleaning and freshening the drum. Recommended monthly or every 50 cycles; the system automatically prompts the user.

#### - MY FAVORITE

A customizable cycle that allows you to save your preferred wash settings. Once configured, you can quickly select this cycle without having to manually adjust settings each time.

#### - DELICATES

For lightly soiled knits, delicates, and synthetic fabrics requiring gentle care. Applies gentle wash action and low temperatures.

#### - FAST WASH

Quick cycle for small loads of lightly soiled items (3-5 pieces). Uses standard wash action and medium temperatures.

#### - COLORS

Recommended for lightly soiled, dark, or highly dyed fabrics that may be prone to color fading. Uses standard wash action and low temperatures to preserve color integrity.

#### - WHITES

Ideal for white and lightly colored garments. Targets heavily to normally soiled white fabrics using standard wash action and high temperatures. For best results, use bleach.

#### - ACTIVEWEAR

Designed for heavily soiled, lightweight synthetic garments. Features extended agitation, gentle cleaning motion, and additional water during rinse to ensure thorough cleaning.

# Operating Instructions

## Special functions

### -DELAY

DELAY function can be set with this button, the delaying time is 0-12H.

Set the DELAY function:

1. Select a program;
2. Press the DELAY button to choose the time;
3. Press START/PAUSE to commence the DELAY operation.

Cancel the DELAY function:

Press the DELAY button until the display will be OH . It should be pressed before starting the program. If the program already started, should press the POWER button.

**Notes:** If there is any break in the power supply while the machine is operating, a special memory stores the selected program and when the power is restarted, press the START/PAUSE button the left time is continues.

**-PRE WASH** The PRE WASH function can get an extra wash before main wash, it is suitable for washing the dust rises to surface of the clothes; You need to put detergent into the Case(I) when select it.

**-TEMP** Press the button to regulate the temperature (from MAX to ECO COLD).

**-SOIL** It is suitable for different level of soil (from MAX to EX LIGHT).

The washing time will increase or decrease which depends on the soil level.

**-SPIN** Press the button to change the spin speed (from MAX to NO SPIN).

**-OPTIONS** Press [OPTIONS] to select "PURE RINSE" and "STEAM".

**-PURE RINSE** The laundry will undergo extra rinse once after you select it.

**-STEAM** STEAM is the function added before main wash, which will generate warm steam to sterilization and greater washing performance.

### -MY FAVORITE

Press PRE WASH for 3 seconds to setting the MY FAVORITE program. Save the program you require and the customised program settings.

The selectable program settings depend on the selected program.

The default program is NORMAL.

### -Child Lock

To avoid that the washing procedure cannot operate normally due to the mis operation by kids during the washing procedure, you can select this function, In this case, the other buttons except POWER button can not work, at this state ,the machine power off when press the key on/off.

Press [TEMP] and [SOIL] together 3 seconds during the running procedure, the buzzer will beep, START / PAUSE button as well as the rotary switch are locked. Press the two buttons for 3 seconds together and buzzer will beep to release to locking. Cut off the power supply , the kid's protection is also remembered.

The kid's protection will not be cancelled after all procedures are completed.

### -Mute the Buzzer

Press [SPIN] for 3 seconds to mute the buzzer. To act the buzzer function, press the button again for 3 seconds. The setting will be kept until the next reset.

### - Add a garment

This operation can be executed during the washing procedure. When the drum of the washing machine is still rolling and there is large amount of water with high temperature in the drum. The state is unsafe and the door cannot be opened forcefully. To press "START/PAUSE" for 3 seconds to reload, and start the clothes adding in the midway function . Please follow the steps as bellow:

1. Wait until the drum stops rotation.
2. The door lock is unlocked.
3. Close the door when the clothes needs are loaded and repress the "START/PAUSE" button.

**Notes:** Don't use the Reload function when the water surface over the edge of the inner tub and the temperature is higher.

# Operating Instructions

## Washing clothes for the first time

Before washing, please make sure that the machine is installed properly. Your appliance was thoroughly checked before it left the factory. To remove any residual water and to neutralize potential odors, it's recommended to clean your appliance before first use. For this reason, we recommend that you clean the inner drum by running the Tub Clean or another program with high temperature before using. Do not add laundry or detergent when running the **CLEAN WASHER** program.

**The drawer is divided into the following compartments:**

I: Pre-wash detergent or washing powder.

II: Detergent.

☼: Softener.

**Adding detergent to the washing machine:**

1. Pull out the drawer.
2. Add pre-wash detergent into Case I (if necessary).
3. Add detergent into Case II.
4. Add softener into Case ☼ (if necessary).

**Notes:**

- If the detergent is clumped or ropy, please dilute it with some water before adding it to the detergent box. This prevents the detergent box intake from becoming blocked and overflowing while adding water.
- Please use the correct type of detergent for the washing temperature for the best effect, including less water use, and minimal energy consumption.

### Start up washing machine

Connect the power supply. Check whether the water pipes are properly connected. Open the tap completely. Put the clothes to be washed into the machine and add the detergent. Then press the "Power" button, select the proper procedures and functions, and press the "Start/Pause" button.

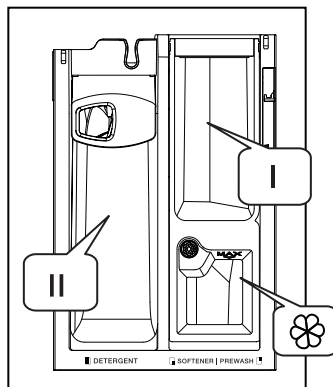

## Select the laundry cycle

The proper washing procedures should be selected based on the types, quantities, and level of soiling of the clothes to be washed, along with the washing temperature table (ranging from MAX to ECO COLD in five levels).

MAX	Maximum cleaning for heat-resistant fabrics and heavy dirt, such as work uniforms, kitchen towels, and baby clothes.
HOT	Strong cleaning for heavy fabrics and moderate to heavy dirt, such as towels, sportswear, and thick linens.
WARM	Standard cleaning for durable fabrics and moderate dirt, such as cotton shirts, bed sheets, and pillowcases.
COOL	Mild cleaning suitable for blended fabrics and light to moderate dirt, such as cotton blends and polyester.
ECO COLD	Gentle cleaning for delicate fabrics and light dirt, such as silk, wool, and lace.

# Operating Instructions

Table of washing procedures

		NORMAL	ALLERGEN	HEAVY DUTY	TOWELS	JEANS	HANDWASH	RINSE & SPIN	CLEAN WASHER	MY FAVORITE	DELICATES	FAST WASH	COLORS	WHITES	ACTIVEWEAR	
Default Time (h:min.)		0:55	2:18	1:35	1:03	1:45	0:59	0:20	1:28	0:55	0:48	0:26	1:09	1:07	1:02	
CYCLE SETTINGS	TEMP															
	MAX	<	<	<					<	<						
	HOT	<		<	<	<				<		<		<	<	
	WARM	<		<	<	<				<	<	<		<	<	
	COOL	<			<	<	<	<		<	<	<	<	<	<	
	ECO COLD	<		<	<	<	<			<	<	<	<	<	<	
	SOIL															
	MAX	<	<	<	<	<	<		DO NOT LOAD AND ITEMS IN DRUM DURING SYSTEM CLEAN CYCLE	<	<			<	<	
	HEAVY	<	<	<	<	<	<			<	<	<		<	<	
	NORMAL	<	<	<	<	<	<			<	<	<		<	<	
	LIGHT	<	<	<	<	<	<	<		<	<	<		<	<	
	EX LIGHT	<	<	<	<	<	<			<	<	<	<	<	<	
	SPIN															
	MAX	<	<	<	<	<		<		<	<	<		<	<	
	HIGH	<	<	<	<	<	<			<	<	<	<	<	<	
	MEDIUM	<	<	<	<	<	<	<		<	<	<	<	<	<	
	LOW	<	<	<	<	<		<		<	<	<	<	<	<	
	NO SPIN	<	<	<	<	<	<	<		<	<	<	<	<	<	
CYCLE OPTIONS	OPTIONS															
	DELAY	<	<	<	<	<		<	<	<	<	<	<	<	<	
	PRE WASH	<	<	<	<	<	<		<	<	<		<	<	<	
	PURE RINSE	<	<	<	<	<			<	<	<		<	<	<	
	STEAM	<	<	<	<	<				<			<	<	<	

✓ = Available selections. □ = Factory presets. ■ = Non-modifiable presets.

\*MY FAVORITE default program is NORMAL.

Energy test program: NORMAL, Temp:ECO COLD, Soil:NORMAL, Spin:MAX, Time:2:23.

Fill the tub with dry, unfolded clothes. Load the tub no more than 3/4 fill. For best performance, the maximum load size should be less than 7.94 lbs. (3.6 kg ).



## IMPORTANT

Do not mix liquids and powders.

- Never use both liquid and powder products at the same time.
- Add the recommended amount of high-efficiency powder detergent to the "MainWash" detergent chamber.



## Note!

- The parameters in this table are only for user's reference. The actual parameters maybe different with the parameters in above mentioned table.

# Maintenance Instructions

## Maintenance Instructions

Before you start, please do pull out the power plug or disconnect power and close the tap.



### WARNING

- Do not use solvents. Solvents may damage the washing machine or generate toxic, explosive gases..
- Never use water to sprinkle and wash the washing machine.
- Do not use detergents that contain PCMX to clean the washing machine.
- Certain internal parts are intentionally not grounded and may present a risk of electric shock only during servicing. Service Personnel-Do not contact the following parts while the appliance is energized: Water Inlet Valve, Drain Pump, Water Level Sensor and Door Lock

### Cleaning and Maintenance of Washing Machine Cabinet

Proper maintenance on the washing machine can extend its working life. The surface can be cleaned with diluted non-abrasive neutral detergents when necessary. If there is any water overflow, use a wet cloth to wipe it off immediately. No sharp items are allowed to strike the cabinet.

**Notes:** Do not use formic acid and its diluted solvents or equivalents.

### Clean Internal Drum

The rusts left inside the drum by metal articles shall be removed immediately with chlorine-free detergents.

Never use steel wool.

### Restoring a Frozen Washing Machine

If the temperature drops below zero and the water in your washing machine gets frozen, follow the directions below:

1. Disconnect the power supply for the washing machine.
2. Wash the tap with warm water to loosen the inlet pipe.
3. Take down the inlet pipe and immerse it in warm water.
4. Pour warm water into the washing drum and wait for 10 minutes.
5. Reconnect the inlet pipe to the tap and check whether the inlet and outlet are working normally.  
Repeat with the other inlet pipe (if applicable).

**Notes:** When the washing machine is reactivated, make sure the ambient temperature is above 0°C.

### Freezing prevention measures

If your washing machine is located in the room where it can get frozen easily, please drain the remaining water inside drain pipe and inlet pipe thoroughly.

Remove the remaining water in inlet pipe:

1. Close the tap.
2. Screw off the inlet pipe from tap and put its end into a container.
3. Start up any cycle except a single Wash or Drain cycle. Any water will drain out of the inlet within 40 seconds.
4. Reconnect the inlet pipe to the tap.

# Maintenance Instructions

## Maintenance Instructions

### Remove the remaining water in the drain pump



#### WARNING

To avoid burning, only do this after the hot water inside the machine cools down.

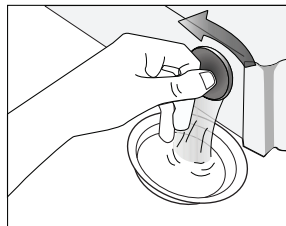

### Clean detergent drawer

1. Pull out the drawer and find the button A as shown in the right diagram.
2. Press down button A and take off the drawer along the direction of the arrow shown in the right diagram.
3. Clean the dispenser drawer and the softener cover under water.
4. Finish clean and push the drawer back into original position.

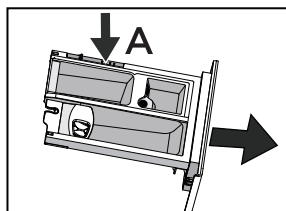

### Clean inlet filter

Clean the inlet filter if there is no water or an insufficient amount of water when the tap is opened.

#### Clean the tap filter:

1. Close the tap.
2. Select any cycle except for Wash or Drain.
3. Press the Start/Pause button and keep the laundry cycle running for about 40 seconds.
4. Remove the inlet pipe from the tap.
5. Use water to wash the filter.
6. Reconnect the inlet pipe.

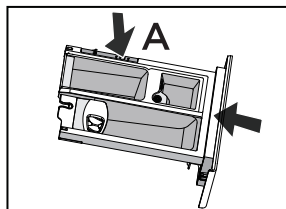
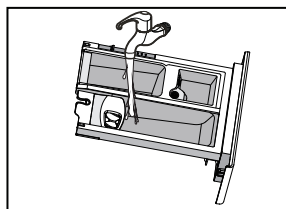

### Wash the washing machine filter:

1. Unscrew the inlet pipe from the backside of the machine.
2. Pull out the filter with long-nose pliers.
3. Wash the filter.
4. Reinstall the filter.
5. Open the tap and make sure there is no water leakage.
6. Close the tap.

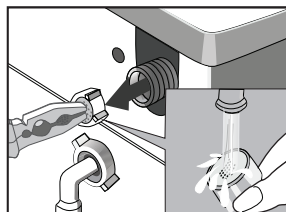

# Maintenance Instructions

## Maintenance Instructions



**WARNING**

Pull out the power plug to avoid electrical shock before cleaning the machine. After using the washing machine, pull out the power cord and close the door tightly to ensure child safety.

**Remove foreign matter**

**Drain Pump Filter:**

The drain pump filter can filter out stray threads and small objects from your laundry. Clean the filter periodically to ensure the normal operation of the washing machine.



**WARNING**

Inspect and clean the filter regularly, depending on how frequently you use the washing machine and the soil level of your clothes. Inspect the filter if the machine does not empty or spin. The machine may make unusual noises during draining due to objects such as safety pins, coins, etc. blocking the pump filter.

Clean the filter by following the instructions below:

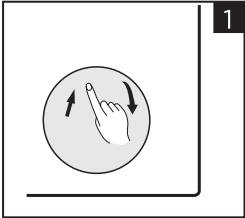

Open the lower cover cap.

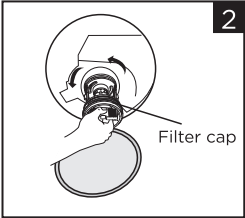

Turn the filter cap counterclockwise to remove the filter.

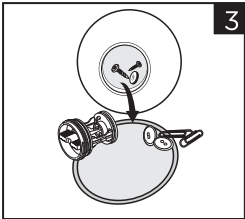

Remove extraneous matter.

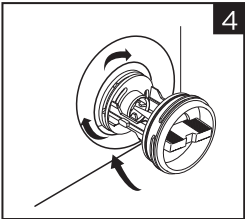

Replace the filter and turn it counterclockwise to lock it in place, then replace the lower cover cap.

**Warning!**

Depending on the laundry cycle selected, there may be hot water in the drain pump during the laundry cycle. Never remove the pump cover cap during a laundry cycle. Always wait until the cycle is complete and the appliance is empty. When replacing the filter and cover, make sure they are securely re-tightened.

# Maintenance Instructions

## Maintenance Instructions

### Emergency Door Release

In case of power failure or other circumstances where the door cannot be opened, there is an emergency door release.

Pull down the emergency pull cord in the filter door and replace it after opening the door.

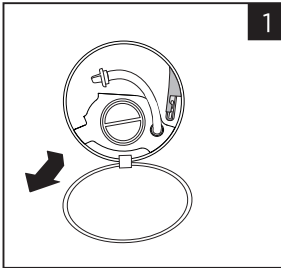

1. Open the filter door.

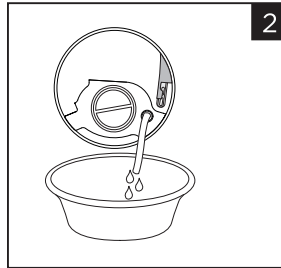

2. Drain the cooled water in the drum.

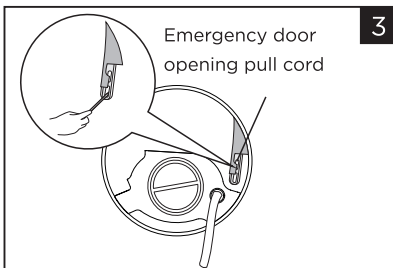

3. Insert a tool into the pull ring and pull it downward to unlock the washing machine door.

### Warning!

You cannot use the emergency door release during a laundry cycle. Open the door after the water has cooled to avoid getting burned by the residual high-temperature water in the machine tub.

# Troubleshooting Tips

## Troubleshooting Tips

If the washing machine does not start or stops during operation, try to find a solution in the table below. If your problem is still not resolved, call the service center for assistance.

Troubles	Proper reason	Solution
Washing machine cannot start up	Washing machine was not set up properly.	Check if the door is closed tightly. Check if power plug is inserted well. Check if the water supply tap is open. Check if the <b>POWER</b> button was pressed. Check if the <b>Start/Pause</b> button was pressed.
Door cannot be opened	Machine's safety protection design is active.	Disconnect the power and restart the machine.
Heating fault	NTC is damaged and/or the heating pipe is aging.	You can only wash clothes without heating the water. Contact the service center promptly to restore heating capabilities.
Water leakage	The inlet pipe, drain hose, tap, and/or washing machine are not tightly connected. Drain pipe in the room is blocked.	Check and fasten water pipes. Clean up drain hose and ask a specialist to repair it if necessary.
Water overflows from the bottom of the machine	The inlet pipe is not connected tightly. The drain hose has water leakage.	Fix the inlet pipe. Replace the drain hose.
Indicator or display does not light	Power is disconnected. PC board has problems. Harness has connection problem.	Check if the power is shut down and power plug is connected correctly. If that does not fix the issue, please call the service line.
Detergent residue in the box	Washing powder is dampened and clumps together.	Clean and wipe the box. Use detergent or special detergent for the drum.
Clothes are still dirty after washing	The clothes are too dirty. Insufficient detergent quantity.	Select the correct laundry cycle. Add the correct detergent quantity according to the instructions on the detergent package.
Abnormally loud noise and/or vibration	Inner drum is unbalanced.	Check if the transport bolts have been removed. Check if the cabinet is installed on a solid and level floor. Check if there are any barrettes or metal articles inside. Check if the legs in the washing machine are adjusted to be level.

# Remove the Problems

## Error Codes

Description	Proper reason	Solution
E30	Door is not closed properly	Restart after the door is closed Check if any clothes are stuck in the gap
E10	Water intake problem while washing	Check if the water pressure is too low Straighten the water pipe Check if the inlet valve filter is blocked
E21	Water draining taking too long	Check if the drain hose is blocked
E12	Water overflow	Restart the washer
EXX	Others	Please try again first. Call the service line if you still experience issues.





















### Note!

- After checking, reactivate the machine and retry your selected cycle. If the problem occurs again or the display shows an error code, call the service line for assistance.

# Appendix

## Appendix

### Care Label

Graphic Symbol	Illustration	Graphic Symbol	Illustration
	Hand Wash		No Machine Wash
	Washing (including Machine Wash and Hand Wash)		Do not Wash
	Dry Clean		No Dry Clean
	Warmly Dry Clean		No Wring
	Bleach		No Bleach
	Tumble dry		Do not Tumble Dry
	Iron		Do not Iron
	Steam Iron		Iron with Cloth
	Medium Temperature and Max. Temperature 150°C		Dry after Wash
	Line Dry		Line Dry in Shade

To avoid fire, electrical shock and other accidents, please remember the following reminders:

- Only the voltage indicated in power label can be used. If you are not clear of the voltage in your home, please contact the local power bureau.
- When you are using the heating function, the maximum current through the washing machine will reach 12A. Please make sure the power supply units (current, voltage and cable) can meet the normal load requirements for the machine.
- Protect the power cord properly. The power cord should be secured so that it does not get damaged or become a tripping hazard. Pay special attention when plugging the power cord into the socket and make sure it is secure.
- Do not overload a wall-mounted socket or use an extension cable. Overloading the wiring may cause fire or electrical shock. Do not pull out power plug with wet hand.
- To ensure your safety, power plug shall be inserted into an grounded three-pole socket. Carefully check and ensure that your socket is properly and reliably grounded.



# Technical Specifications

## Technical specifications

Parameter	
Power Supply	120V- , 60Hz
Dimension(W*D*H)	595*615*845mm
Net Weight	72kg (158.7lb)
Rated Current	11A
Standard Water Pressure	0.1-0.8MPa

Made in China

# Limited Warranty

Your appliance is covered by a one year limited warranty. For one year from date of delivery, Electrolux will pay all costs for repairing or replacing any parts of this appliance that prove to be defective in materials or workmanship when such appliance is installed, used and maintained in accordance with the provided instructions. The date of delivery establishes the warranty period, should service be required.

## Exclusions

This warranty does not cover the following:

1. Products with original serial numbers that have been removed, altered or cannot be readily determined.
2. Product that has been transferred from its original owner to another party or removed outside the USA or Canada.
3. Rust on the interior or exterior of the unit
4. Products purchased "as-is" are not covered by this warranty.
5. Products used in a commercial setting.
6. Service calls which DO NOT involve malfunction or defects in materials or workmanship, or for appliances not in ordinary household use or used other than in accordance with the provided instructions.
7. Service calls to correct the installation of your appliance or to instruct you how to use your appliance.
8. Expenses for making the appliance accessible for servicing, such as removal of trim, cupboards, shelves, etc., which are not a part of the appliance when it is shipped from the factory.
9. Service calls to repair or replace appliance light bulbs, air filters, water filters, other consumables, or knobs, handles, or other cosmetic parts.
10. Pickup and delivery costs; your appliance is designed to be repaired in the home.
11. Surcharges including, but not limited to, any after hour, weekend, or holiday service calls, tolls, ferry trip charges, or mileage expense for service calls to remote areas, including the state of Alaska.
12. Damages to the finish of appliance or home incurred during transportation or installation, including but not limited to floors, cabinets, walls, etc.
13. Damages caused by: services performed by unauthorized service companies; use of parts other than genuine Electrolux parts or parts obtained from persons other than authorized service companies; or external causes such as abuse, misuse, inadequate power supply, accidents, fires, or acts of God.

## DISCLAIMER OF IMPLIED WARRANTIES; LIMITATION OF REMEDIES

CUSTOMER'S SOLE AND EXCLUSIVE REMEDY UNDER THIS LIMITED WARRANTY SHALL BE PRODUCT REPAIR OR REPLACEMENT AS PROVIDED HEREIN. CLAIMS BASED ON IMPLIED WARRANTIES, INCLUDING WARRANTIES OF MERCHANTABILITY OR FITNESS FOR A PARTICULAR PURPOSE, ARE LIMITED TO ONE YEAR OR THE SHORTEST PERIOD ALLOWED BY LAW, BUT NOT LESS THAN ONE YEAR. ELECTROLUX SHALL NOT BE LIABLE FOR CONSEQUENTIAL OR INCIDENTAL DAMAGES SUCH AS PROPERTY DAMAGE AND INCIDENTAL EXPENSES RESULTING FROM ANY BREACH OF THIS WRITTEN LIMITED WARRANTY OR ANY IMPLIED WARRANTY. SOME STATES AND PROVINCES DO NOT ALLOW THE EXCLUSION OR LIMITATION OF INCIDENTAL OR CONSEQUENTIAL DAMAGES, OR LIMITATIONS ON THE DURATION OF IMPLIED WARRANTIES, SO THESE LIMITATIONS OR EXCLUSIONS MAY NOT APPLY TO YOU. THIS WRITTEN WARRANTY GIVES YOU SPECIFIC LEGAL RIGHTS. YOU MAY ALSO HAVE OTHER RIGHTS THAT VARY FROM STATE TO STATE.

## IF YOU NEED SERVICE

Keep your receipt, delivery slip, or some other appropriate payment record to establish the warranty period should service be required. If service is performed, it is in your best interest to obtain and keep all receipts. Service under this warranty must be obtained by contacting Electrolux at the addresses or phone numbers below.

This warranty only applies in the USA and Canada. In the USA, your appliance is warranted by Electrolux Consumer Products, Inc. In Canada, your appliance is warranted by Electrolux Canada Corp. Electrolux authorizes no person to change or add to any obligations under this warranty. Obligations for service and parts under this warranty must be performed by Electrolux or an authorized service company. Product features or specifications as described or illustrated are subject to change without notice.

**USA**  
**1.800.944.9044**  
Electrolux Consumer Products, Inc.  
10200 David Taylor Drive  
Charlotte, NC 28262



**Electrolux**

**Canada**  
**1.800.265.8352**  
Electrolux Canada Corp.  
5855 Terry Fox Way  
Mississauga, Ontario, Canada  
LSV 3E4