

4.5 cu. ft. Ultra Large Front Load Washer with AI Wash

- 4.5 cu.ft. Capacity
- AI Wash
- AI DD® Built-In Intelligence
- ColdWash™ Technology
- NeverRust™ Stainless Steel Tub
- TrueBalance® Anti-Vibration System



AVAILABLE COLORS



SUMMARY	
Type	Front Load Washer
Capacity	4.5 cu.ft
Matching Electric Dryer	DLE3420W
Matching Gas Dryer	DLG3421W
Color	White (W)
WASH PROGRAMS	
No. of Programs	10
Wash Programs	Normal, Perm. Press, Heavy Duty, Delicates, Cold Wash™, Quick Wash, Bedding, Tub Clean, AI Wash, Downloaded
No. of Options	8
Options	Pre-wash, Delay Start, Extra Rinse, Wi-Fi, Remote Start, Spin Only, Control Lock, Signal
WASH DETAILS	
No. of Wash/Rinse Temps	5
Wash/ Rinse Temps	Hot, Semi Warm, Warm, Cold, Tap Cold
No. of Spin Speed	5
Spin Speeds	Extra High, High, Medium, Low, No Spin
Water Levels	Load Sensing
No. of Soil Levels	3
APPEARANCE	
Control & Display	Electronic Control Panel with LED Display
Touch Buttons	Yes
Dial-A-Cycle®	Yes
FABRIC CARE FEATURES	
AI DD®	Yes
TurboWash® 360 Technology	No
TurboWash® 2.0 Technology	No
Steam Technology	No
Allergiene® Cycle	No
Sanitary Cycle	No
Cold Wash Option	Yes
Soil Level Sensor	No

CONVENIENCE FEATURES	
Vibration sensing (Cabinet Vibration sensor)	Yes
TrueBalance® Anti-Vibration System	Yes
4 Tray Dispenser	Prewash, Main Wash (with liquid detergent cup), Bleach, Fabric Softener
End of Cycle Signal	Yes
LoadSense	Yes
Control Lock	Yes
Auto Suds Removal	Yes
Leveling Legs	4 Adjustable Legs
Drumlight	No
Forced Drain System	Yes
Add Garment Indicator	Yes
Internal Water Heater	No
SMART FEATURES (ThinQ® TECHNOLOGY)	
Smart Diagnosis (v3.0)	Yes
Wi-Fi	Yes
NFC Tag On Technology	No
Energy Monitoring	Yes
Tub Clean Coach	Yes
MOTOR	
Motor Type	Inverter Direct Drive Motor
Max RPM	1300
Axis	Vertical
MATERIALS AND FINISHES	
NeveRust® Stainless Steel Drum	Yes
Cabinet	Painted Steel
Control Panel	Plastic
Top Plate	Painted Steel
Door / Rim	Glass/White Rim
Door Cover	Clear Round Cover
All Available Colors	White (W)

ENERGY	
ENERGY STAR® Most Efficient	Yes
ENERGY STAR® Certified	Yes
CEE Tier	2
IMEF	2.92
IWF	2.9
POWER SOURCE	
Ratings	UL Listed
Electrical Requirements	120 V, 60 Hz, 6 A
Type	Electric
Plug	Included
Plug Type	3 Prong
OPTIONS/ ACCESSORIES	
Pedestal	WDP6W
Pedestal (WxHxD)	27" x 13 5/8" x 28" (43 7/8" D with door open)
LG Sidekick® Pedestal Washer	WD300CW
LG Sidekick® Pedestal Washer (WxHxD)	27 x 14 1/8 x 30 3/4 (50 1/2 D with door open)
Stacking Kit	KSTK4
Water Supply Hoses (Hot & Cold) Included	No
LIMITED WARRANTY	
Parts and Labor	1 Year
Direct Drive Motor	10 Years
Drum	3 Years
UPC CODES	
WM3420CW	048231349895

DIMENSION / CLEARANCES

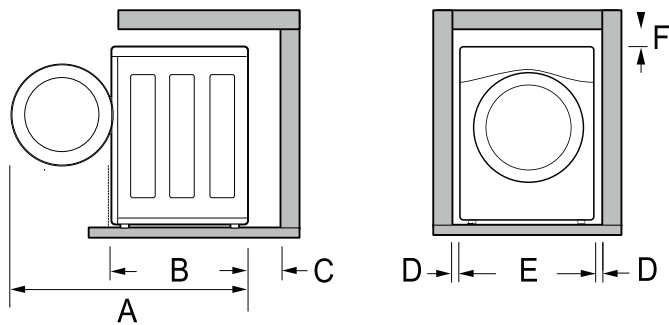

DIMENSIONS

Product (WxHxD)	27" x 39" x 30 1/4"
Depth with Door Open	55"
Carton Dimensions (WxHxD)	29 3/4" x 41 7/8" x 31 1/2"
Approx. Weight (Product / Carton)	185.2 / 198.4 lbs.
A	55" (139.6cm)
B	30 1/4" (77cm)
C	4" (10cm)
D	1" (2.5cm)
E	27" (70cm)
F	1/4" (0.5cm)

DIMENSION / CLEARANCES

To ensure sufficient clearance for water inlet hoses, drain hose and airflow, allow minimum clearances of at least 1" (2.5 cm) at the sides and 4" (10 cm) behind the appliance. Be sure to allow for wall, door, or floor moldings that may increase the required clearances.

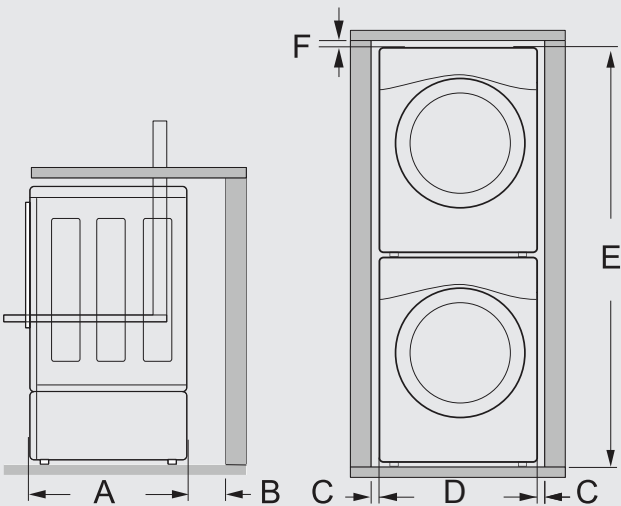

Stacking or Pedestal Installation

The washer can be stacked under a dryer or on top of a pedestal or pedestal washer.

- Refer to the instructions packaged with the optional pedestal kit before stacking appliance on pedestal.
- Do not use a drain pan with a pedestal or pedestal washer installation as it can block the drawer. Using a drain pan may result in increased vibration and noise during operation.

DIMENSIONS

A	30 1/4" (77cm)
B	4" (10cm)
C	1" (2.5cm)
D	27" (70cm)
E	77 1/2" (196.8cm)
F	1/4" (0.5cm)

CONNECTING THE WATER INLET HOSE

- Check the fittings and seals. Inspect the threaded fitting on each hose and make sure there is a rubber seal ❶ in place in both ends of each hose to prevent leaking.
- Connect the water inlet hoses to the hot and cold water faucets tightly by hand and then tighten another 2/3 turn with pliers.
- Connect the blue hose to the cold water faucet and the red hose to the hot water faucet.

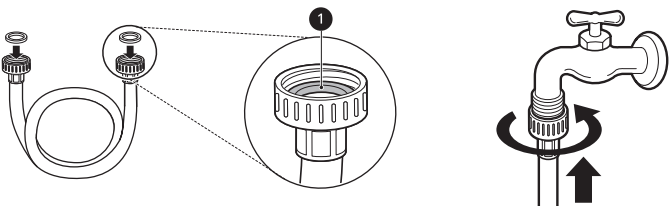

Flush out the inlet hoses.

- After the hoses are connected, turn on the water faucets and flush out any foreign substances such as dirt, sand, or sawdust. Foreign substances can damage washer inlets and lead to leakage.
- Let the water drain into a bucket, and check the water temperature to make sure you've connected the hoses to the correct faucets.

Attach the inlet hoses to the back of the washer.

- Attach the hot water inlet hose to the hot water inlet on the back of the washer. Attach the cold water inlet hose to the cold water inlet on the back of the washer.
- Tighten the fittings securely. Turn on both faucets all the way and check for leaks at both ends of the hoses.

